

E-FILE STAMP

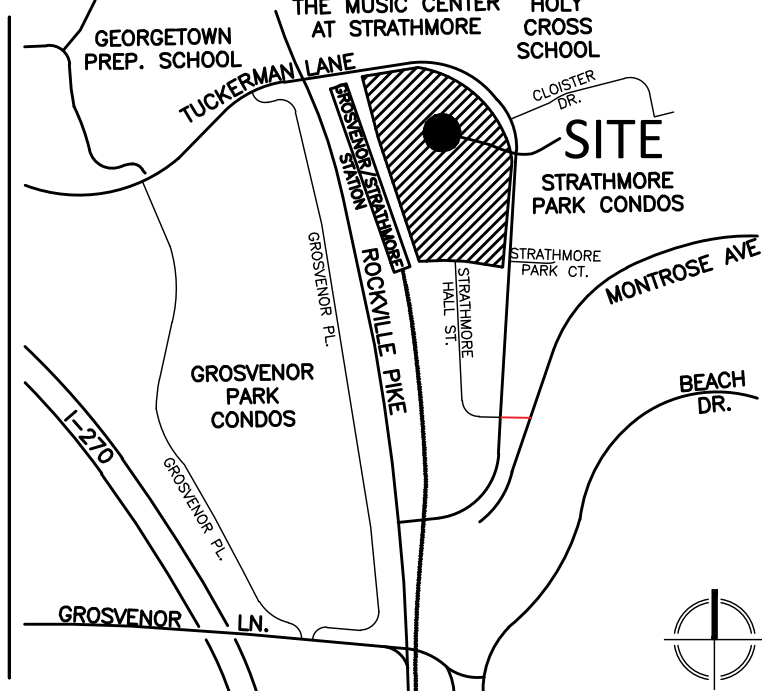

VICINITY MAP
SCALE: 1" = 2,000'

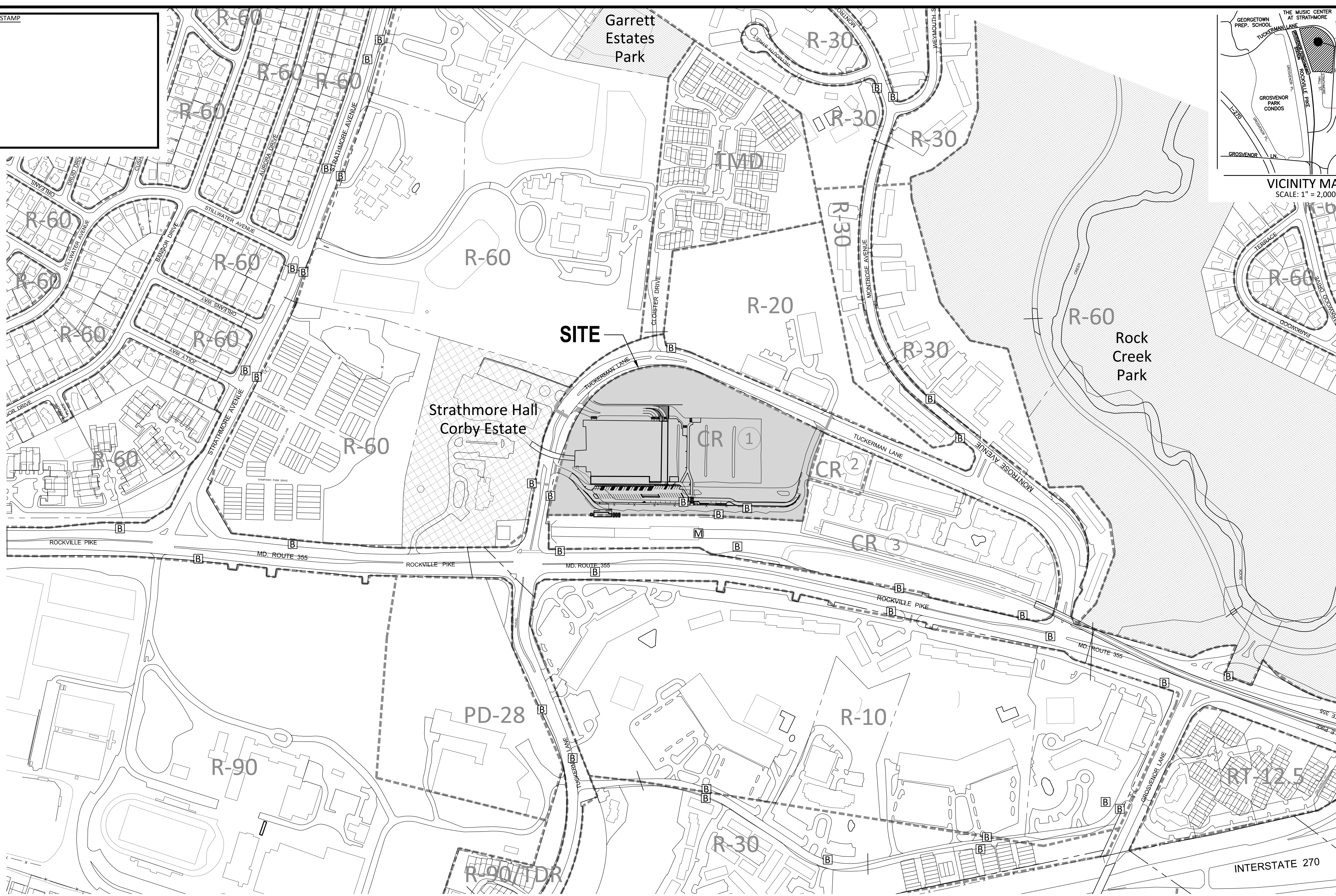

PREPARED FOR:
**FIVESQUARES
DEVELOPMENT @
GROSVENOR METRO, LLC**
1 THOMAS CIRCLE, NW
SUITE 200
WASHINGTON, DC, 20005
202-640-4445
SYLKE KNUPPEL, PE

DESIGN CONSULTANTS
**ARCHITECT
PERKINS EASTMAN DC**
1 THOMAS CIRCLE, NW
SUITE 270
WASHINGTON, DC 20005
202-455-7450
MATT BELL

LANDSCAPE ARCHITECT
VIKA MARYLAND, LLC
20251 CENTURY BOULEVARD
SUITE 400
GERMANTOWN, MD 20874
301.916.4100
JOSH SLOAN

ATTORNEY
LERCH, EARLY, BREWER
7600 WISCONSIN AVENUE
SUITE 700
BETHESDA, MD 20814
301.986.1300
STEVE ROBINS

TRAFFIC ENGINEER
WELLS + ASSOCIATES
1420 SPRING HILL ROAD
SUITE 610
TYSONS, VA 22102
703.917.6620
CHRIS TURNBULL

PLANNING, CIVIL ENGINEERING
VIKA MARYLAND, LLC
20251 CENTURY BOULEVARD
SUITE 400
GERMANTOWN, MD 20874
301.916.4100
LAURENT MOUNAID, PE

REVISIONS	DATE
1 INITIAL SUBMISSION	4/25/2018

PROFESSIONAL SEAL

I HEREBY CERTIFY THAT THESE DOCUMENTS WERE PREPARED OR APPROVED BY ME, AND THAT I AM A DULY LICENSED PROFESSIONAL ENGINEER UNDER THE LAWS OF THE STATE OF MARYLAND.
NAME: LAURENT MOUNAID
LICENSE #: 36748
EXPIRATION DATE: JAN. 23, 2019

**GROSVENOR -
STRATHMORE
WMATA GARAGE
EXPANSION**
4TH ELECTION DISTRICT
MONTGOMERY COUNTY,
MARYLAND
WSSC GRID: 213NW05
TAX MAP: HP123

**LOCAL AREA
MAP**

DRAWN BY: LWA
DESIGNED BY: IPD
DATE ISSUED: 04/25/18

VIKA PROJECT: VM 50226 A
APPLICATION NO.: MR2018026

SHEET NO. LOCAL-001

- LEGEND**
- Bus Stop
 - Metro
 - CR** Zoning
 - 1 CR 3.0, C-.5, R-2.75, H-300**
 - 2 CR 7.25, C-.25, R-7.25, H-180'
 - 3 CR 5, C-25, R-.5, H-40'
 - Parks
 - Historic Preservation Master Plan
- * Heights greater than 160' only permitted in key locations.

