

ROUNDED
CORNERS

48"

ROUNDED
CORNERS

DEVELOPMENT APPLICATION FOR: MALLORY SQUARE

ADMINISTRATIVE SITE PLAN AMENDMENT: 82012013B

- 1. INSTALL ADDITIONAL AMENITIES AND FURNITURE ON A PORTION OF THE ROOF OF THE APPROVED GARAGE.**
- 2. RELOCATION OF SWM FACILITIES FROM GARAGE TO IN FRONT OF BUILDING ON KEY WEST AVE. & OMEGA DR.**
- 3. REDUCTION OF ONE UNIT.**

**APPLICANT: MALLORY SQUARE PARTNERS I & II, c/o
WOODFIELD INVESTMENTS LLC
MARGARET SMITH FORD 301-789-2045**

For process and hearing information please contact:
The Maryland-National Capital Park and Planning Commission
8787 Georgia Avenue, Silver Spring, MD 20910
www.montgomeryplanning.org/development
(301) 495-4550

36"

ROUNDED
CORNERS

ROUNDED
CORNERS

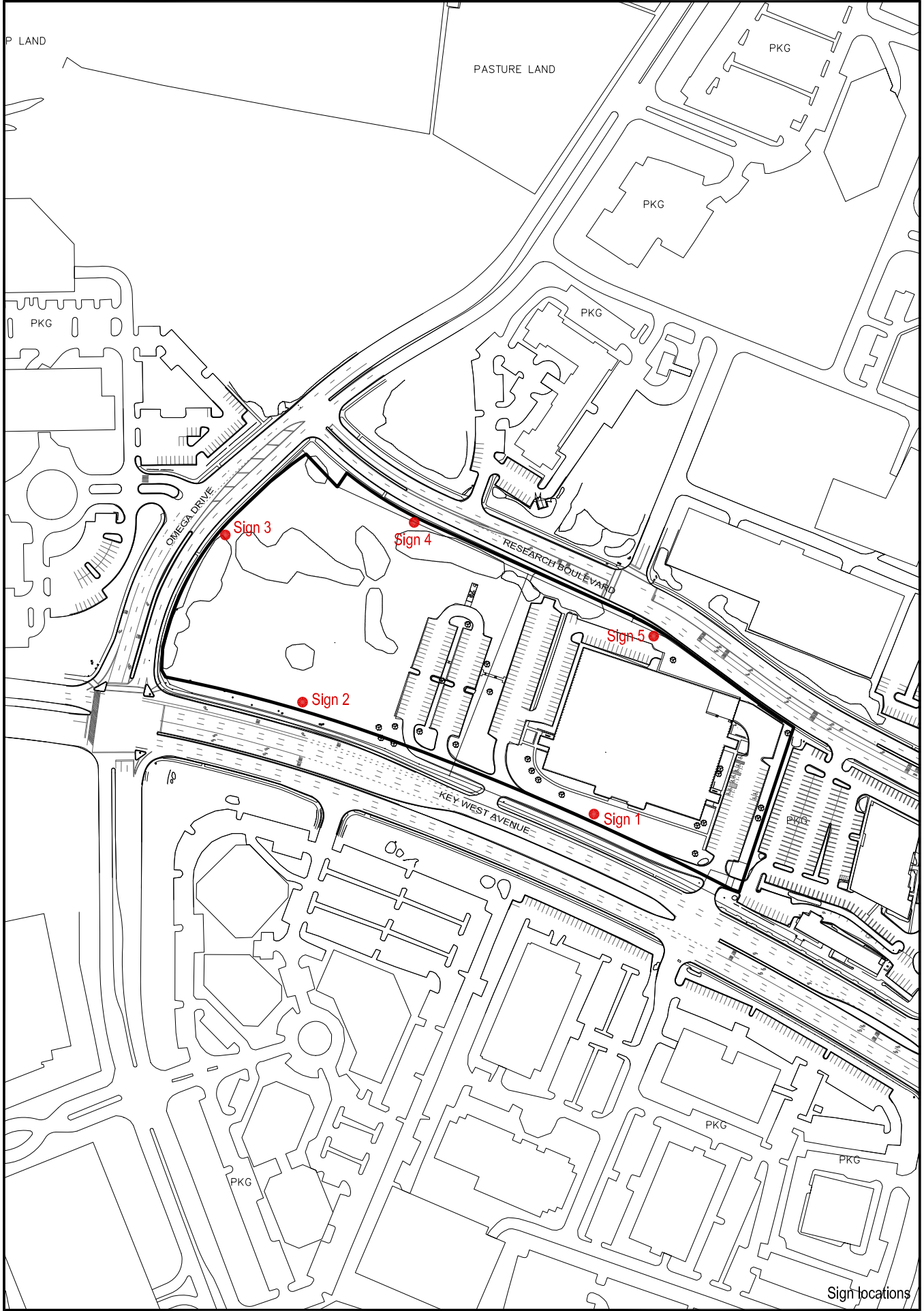

P LAND

PASTURE LAND

PKG

PKG

PKG

PKG

OMEGA DRIVE

Sign 3

Sign 4

RESEARCH BOULEVARD

Sign 5

Sign 2

KEY WEST AVENUE

Sign 1

PKG

PKG

PKG

Sign locations