

LAYOUT: 1, Plotted By: Duke

K:\1501-2000\1667\cadd\exhibits\1667200 PHASING SCHEDULE.dwg, ~ Jan 28, 2015 AT 10:57:20 AM

DEVELOPMENT PROGRAM	
Building B Phasing Schedule	
Timing Mechanism	Task
1 At any time	Release of Garage Use & Occupancy
2 Prior to release of first Residential Use & Occupancy	Applicant to complete lighting and sidewalk installation along the east side of Siesta Key Way, immediately adjacent to units seeking U&O
3 Prior to release of 67th Residential Use & Occupancy	Applicant to complete remaining amenity package on the property along east side of Siesta Key Way including bike racks & bench seating
4* Prior to release of 155th Residential Use & Occupancy	Applicant to complete 1) Pool Courtyard and 2) sidewalk, lighting and amenities, if any, fronting Research Boulevard & Key West Avenue immediately adjacent to units seeking U&O
5* Prior to release of 356th Residential Use & Occupancy	Applicant to complete all remaining public & private amenities on the property along Research Boulevard, Key West Highway & Street B10, east of Siesta Key Way Applicant to install a 15 dock/8 bike Share Station, or provide MNCPPC evidence of payment to the County for Bike Share Station, and notify MCDPS and MNCPPC of status in writing Applicant to complete as built for landscaping and cool roof for Building B

Building A Phasing Schedule	
Timing Mechanism	Task
6 At any time	Release of Garage Use & Occupancy
7 Prior to release of first Residential Use & Occupancy	Applicant to complete lighting and sidewalk installation along the west side of Siesta Key Way, immediately adjacent to units seeking U&O
8 Prior to release of 57th Residential Use & Occupancy	Applicant to complete remaining amenity package on the property along west side of Siesta Key Way including bike racks & bench seating
9* Prior to release of 133rd Residential Use & Occupancy	Applicant to complete 1) Pool Courtyard and 2) sidewalk, lighting and amenities, if any, fronting Research Boulevard & Key West Avenue immediately adjacent to units seeking U&O
10* Prior to release of 310th Residential Use & Occupancy	Applicant to complete all remaining public & private amenities on the property along Omega and Key West Avenue, west of Siesta Key Way Applicant to complete as built for landscaping and cool roof for Building A

Overall Project Phasing Schedule	
Timing Mechanism	Task
11 Prior to release of 681st Residential Use & Occupancy	Applicant to complete Tree Canopy as-built for entire project, showing locations and species with 15 year coverage

*Note: Prior to the release of U&O's for units adjacent to a sidewalk, Applicant to complete sidewalk and site lighting installation immediately adjacent to these units.

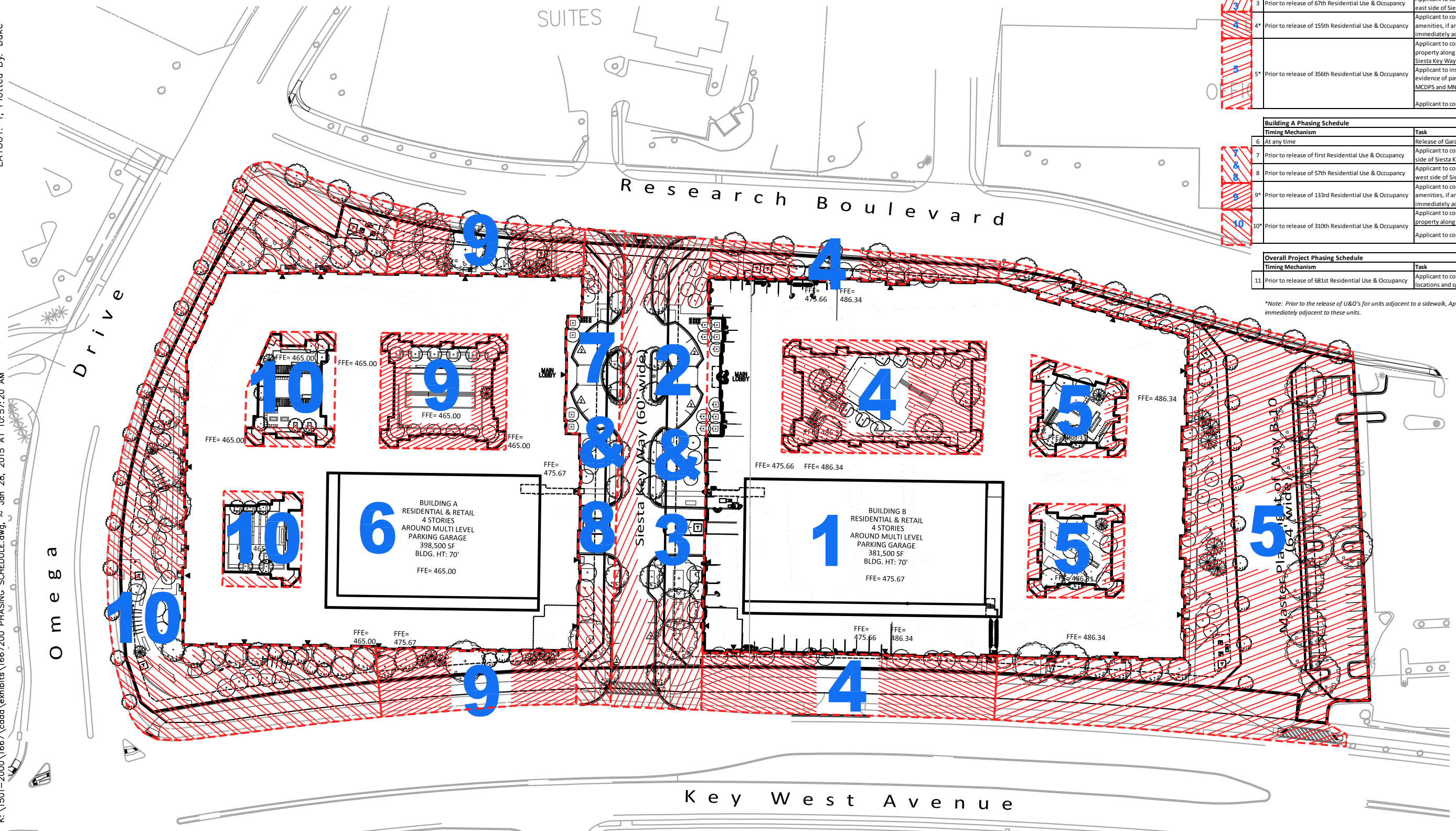

PROJECT PHASING SCHEDULE

MALLORY SQUARE

JANUARY, 2015