

M-NCPPC APPROVAL STAMP:

PROPERTY OWNERS CERTIFICATE:

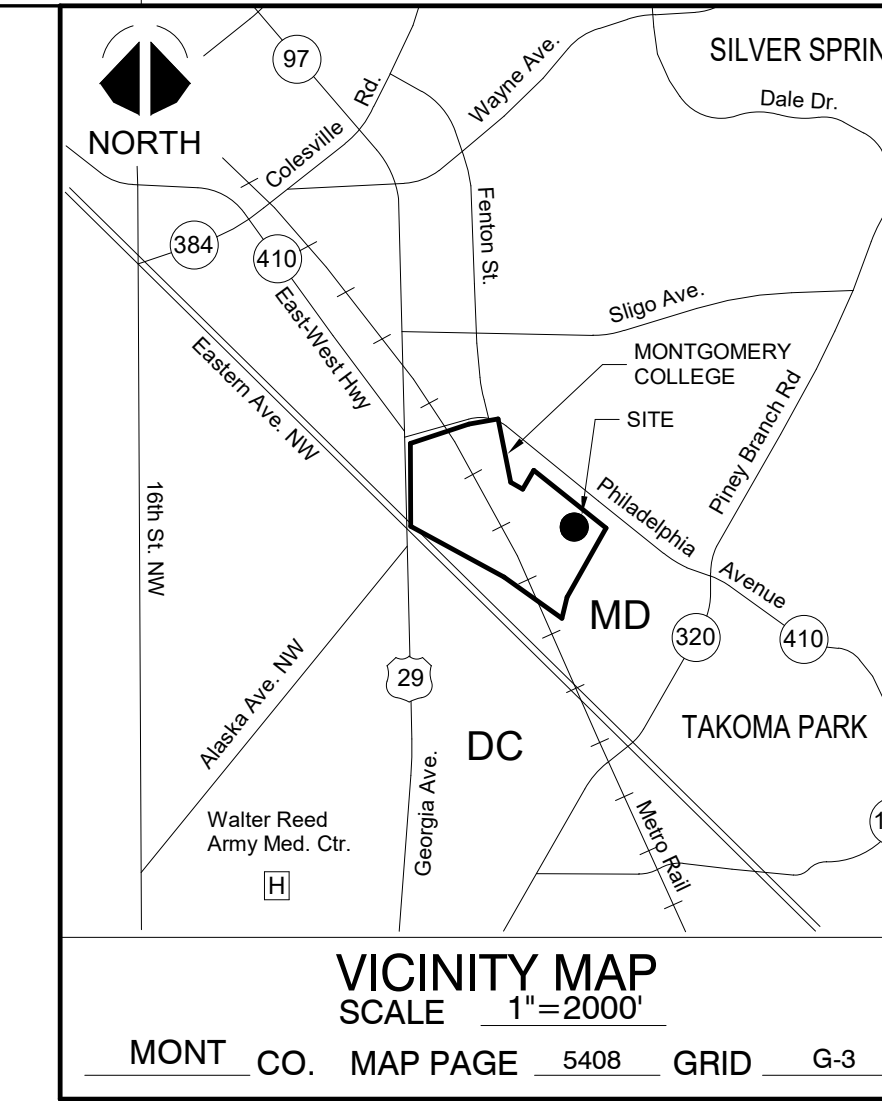

PROJECT NAME:
Catherine and Isiah Leggett Math and Science Building

PROJECT ADDRESS:
Montgomery College
Takoma Park / Silver Spring Campus
7600 Takoma Avenue
Takoma Park, MD 20912

PROPERTY OWNER:
Montgomery College
9221 Corporate Blvd.
Rockville, MD 20850

PRIMARY CONTACT:
Kevin Johnson (SMITHGROUP)
1700 New York Ave NW #100
Washington DC, 20006
e-mail: kevin.johnson@smithgroup.com
phone: 202-974-4589

APPLICANT:
Marvin D. Mills, Jr. (Montgomery College)
9221 Corporate Blvd.
Rockville, MD 20850
e-mail: marvin.mills@montgomerycollege.edu
phone: 240-567-9141

ENGINEER / PLAN PREPARED:
Mike Wychulis (AMT Engineering)
800 King Farm Blvd.
Rockville, MD 20850
e-mail: mwyichulis@amtenengineering.com
phone: 301-881-2545

Montgomery College Project #: FP16-077
Tax Map Grid #: JN32
WSSC # (New Building): Pending Service
WSSC # (Science South): 0064378
WSSC # (Falcon Hall): 2393379

DESIGN TEAM:
SMITHGROUP

1700 NEW YORK AVENUE NW
SUITE 100
WASHINGTON, DC 20006
202.842.2100
www.smithgroup.com

AMT Engineering
CIVIL ENGINEERS
800 King Farm Boulevard, 4th Floor
Rockville, MD 20850
301-881-2545

Cagley & Associates
STRUCTURAL ENGINEERS
6141 Executive Blvd.
Rockville, MD 20852
301-881-9050

Mahan Rykiel
LANDSCAPE ARCHITECTS
3300 Clipper Mill Road, Suite 200
Baltimore, MD 21211
410-256-8001

Sporksys
AV. IT. SECURITY
7257 Parkway Drive, suite 260
Hanover, MD 21076
410-712-0300

ISSUED FOR	REV	DATE

SEALS AND SIGNATURES
CERTIFICATE OF REGISTERED ENGINEER / SURVEYOR OR OTHER APPROPRIATE LICENSE INDIVIDUAL.



LPD Area Summary				
Label	Area	Total Watts	LPD	Description
Exterior Site Lighting	170148	2311.393	0.014	Lighting Power Density for Montgomery College

Symbol	Qty	Label	LLF	Description	Lum. Watts	BUG Rating	Lum. Lumens	Mt. Height
○	3	S1b-T4-450	0.900	UCM-LUM-ANG-T4-3ZLED-4K-450	48	B1-U1-G1	3900	12
○	16	S1c-T2-450	0.900	UCM-LUM-ANG-T2-3ZLED-4K-450	48	B1-U1-G1	4195	12
+	2	S2a-AR3P35	0.900	AR3P35-B0L4K	93.8	B3-U0-G3	10613	20
+	4	S2b-AR4P35	0.900	AR4P35-B0L4K	93.8	B1-U0-G3	10571	20
+	6	S3-HLED	0.900	65BEMW-HLED-30K	11.9	B1-U0-G0	1211	-
+	36	S5-LRS 90deg	0.900	Coleclg Lighttrail LRS Symmetrica	9.27	B0-U0-G0	637	3
+	24	S4-Bega 33052	0.900	Bega Shilded Lower Steplight	13	B0-U1-G1	113	0.75"
+	3	S6-Maxlite WP-	0.591	Maxlite WallMax Open Face 28W	39.824	B1-U3-G4	5357	10

Calculation Summary						
Label	CalcType	Units	Avg	Max	Min	Avg/Min
Driveway-N	Illuminance	Fc	1.79	7.7	0.3	5.97
Driveway-S	Illuminance	Fc	2.17	4.2	0.4	5.43
Driveway-W	Illuminance	Fc	1.55	4.2	0.4	3.88
Entry-East	Illuminance	Fc	3.89	7.5	0.8	4.86
Entry-N	Illuminance	Fc	2.04	8.6	0.3	6.80
Parking-S1	Illuminance	Fc	1.54	3.5	0.7	2.20
Parking-S2	Illuminance	Fc	2.54	4.3	1.3	1.95
Parking-W1	Illuminance	Fc	0.37	0.6	0.2	1.85
Parking-W2	Illuminance	Fc	2.22	4.2	0.6	3.70
Parking-W3	Illuminance	Fc	1.94	3.7	0.5	3.86
Sidewalk-NE	Illuminance	Fc	1.84	7.2	0.3	6.13
Sidewalk-NE Ramp	Illuminance	Fc	2.10	4.3	0.6	3.50
Sidewalk-SW_SE	Illuminance	Fc	1.63	7.4	0.2	8.15
Staircase-Egress_1	Illuminance	Fc	14.38	21.3	7.9	1.82
Staircase-Egress_3	Illuminance	Fc	14.15	21.3	8.1	1.75
Staircase-NE_1	Illuminance	Fc	14.39	22.3	7.9	1.82
Staircase-NE_2	Illuminance	Fc	14.95	23.3	9.0	1.66
Staircase-NE_3	Illuminance	Fc	16.45	24.9	9.9	1.60
Staircase-NE_4	Illuminance	Fc	17.74	24.1	11.5	1.54
Staircase-NE_5	Illuminance	Fc	17.37	23.1	10.4	1.67
Staircase-NE_6	Illuminance	Fc	16.43	23.3	10.0	1.64
Staircase-NE_7	Illuminance	Fc	16.26	24.2	9.3	1.75
Staircase-NE_8	Illuminance	Fc	14.98	21.4	8.0	1.87
Staircase-NEntry	Illuminance	Fc	11.81	20.5	5.7	2.07
Staircase-W	Illuminance	Fc	17.17	32.7	4.8	3.58

LEGEND

○ S1x LIGHTING FIXTURE TYPE DESIGNATION. "1" INDICATES SPECIFIC FIXTURE TYPE. AND "X" INDICATES SPECIFIC DISTRIBUTION OPTIC. REFERENCE LUMINAIRE SCHEDULE FOR ADDITIONAL SPECIFICATIONS

○ LIGHTING FIXTURE AMING/DIRECTIONAL INDICATION

○ EXTERIOR RECESSED DOWNLIGHT, IP66 RATED

○ EXTERIOR RATED, ROUND WITH STRAIGHT HOOD, LED, POLE FIXTURE

○ EXTERIOR RATED, ROADWAY RECTANGULAR, LED POLE FIXTURE WITH NEIGHBOR FRIENDLY OPTIC

— EXTERIOR RATED, LINEAR LED LIGHT INTEGRATED HANDRAIL

— EXTERIOR RATED, RECESSED LED STEPLIGHT WITH LOUVERED SHIELDING

□ EXTERIOR RATED, SURFACE MOUNTED, RECTANGULAR, LED WALLPACK

○ SINGLE PHOTOMETRIC CALCULATION POINT (UNIT IN FOOTCANDLES)

— SOLID LINE INDICATES OUTLINE OF PROPOSED BUILDING

--- DASHED LINE INDICATES MATCHLINE BETWEEN ENLARGED SITE AREAS

... DOTTED LINE INDICATES AREAS THAT CORRESPONDS WITH THE LABELS GIVEN TO THE ILLUMINANCE CALCULATION SHOWN IN THE CALCULATION SUMMARY TABLE

○ ALUMINUM LIGHT POLE
S1 SERIES: 14 FOOT MOUNTING HEIGHT
S2 SERIES: 20 FOOT MOUNTING HEIGHT

HUBBELL LIGHTING CAT. NO. PR4-4R14-125-B06
20 FOOT MOUNTING HEIGHT
KIM LIGHTING CAT. NO. HAS20-6188

GENERAL SHEET NOTES

- COORDINATE WITH LOCAL UTILITY FOR ALL SITE SERVICE REQUIREMENTS.
- CONTACT LOCAL UTILITY TO IDENTIFY ALL EXISTING UNDERGROUND UTILITIES.
- GRAY SHADING INDICATES OUT OF SCOPE AREAS.
- SEE HARDSCAPE DETAILS FOR POLE MOUNTED FIXTURE TYPE SERIES S1 AND S2 MOUNTING DETAILS.
- SITE ILLUMINATION DESIGNED TO IESNA STANDARDS.

SHEET KEYNOTES

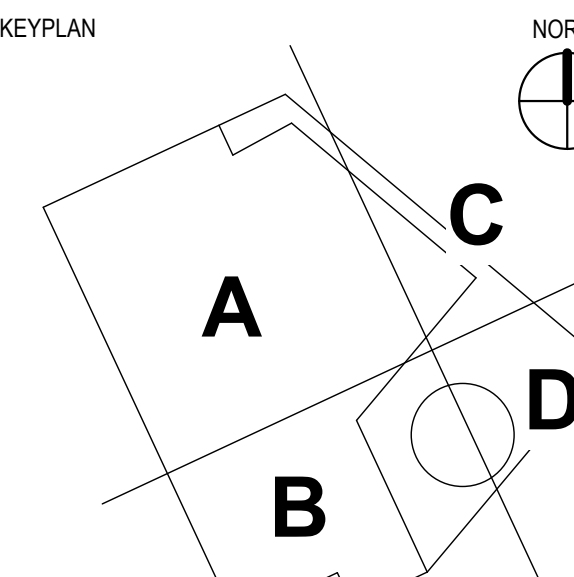

FIXTURE TYPE S1b & S1c



FIXTURE TYPE S2a & S2b



FIXTURE TYPE S3

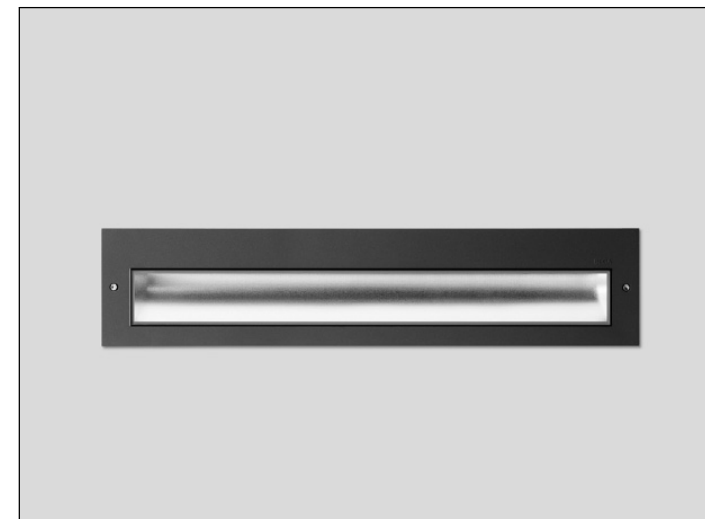

FIXTURE TYPE S4

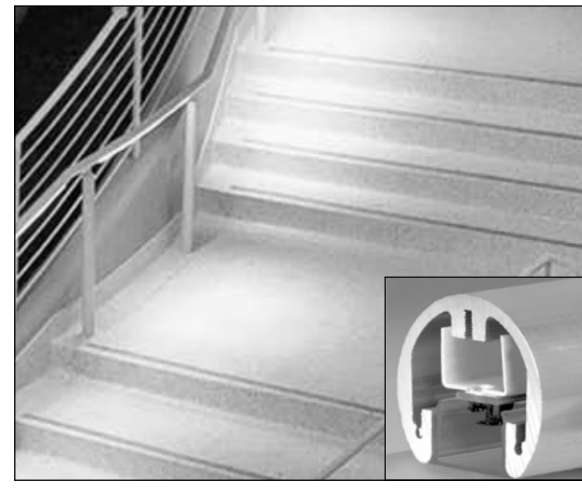

FIXTURE TYPE S5



FIXTURE TYPE S6

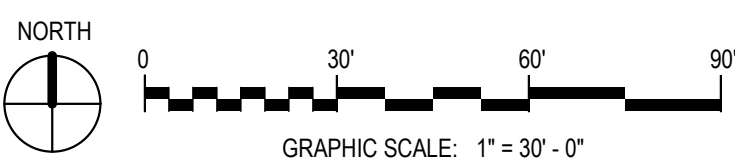

1 ELECTRICAL SITE PLAN
SCALE: 1" = 30'-0"

Plot Date: 12/14/2018 12:58:00 PM Author

MANDATORY REFERRAL NO. MR2019011

12543.000

PROJECT NUMBER

MR-10.6

SHEET NUMBER