

# TAKOMA JUNCTION

## SCHEMATIC LANDSCAPE ARCHITECTURE SITE PLAN #820190090

**VKA**  
 ENGINEERS PLANNERS  
 LANDSCAPE ARCHITECTS SURVEYORS  
 VKA MARYLAND, LLC  
 20251 CENTURY BOULEVARD, SUITE 400  
 GERMANTOWN, MARYLAND 20874  
 PHONE: (301) 916-4100  
 FAX: (301) 916-2262  
 GERMANTOWN, M.D. 21753, V.A.

PREPARED FOR:  
 Neighborhood Development Company  
 3232 Georgia Avenue  
 Suite 100  
 Washington DC 20010  
 202.567.3205  
 Jingjing Liu

PLANNER, CIVIL ENGINEER  
 VKA MARYLAND, LLC  
 20251 CENTURY BOULEVARD  
 SUITE 400  
 GERMANTOWN MD, 20874  
 301.916.4100  
 JOSHUA C. SLOAN

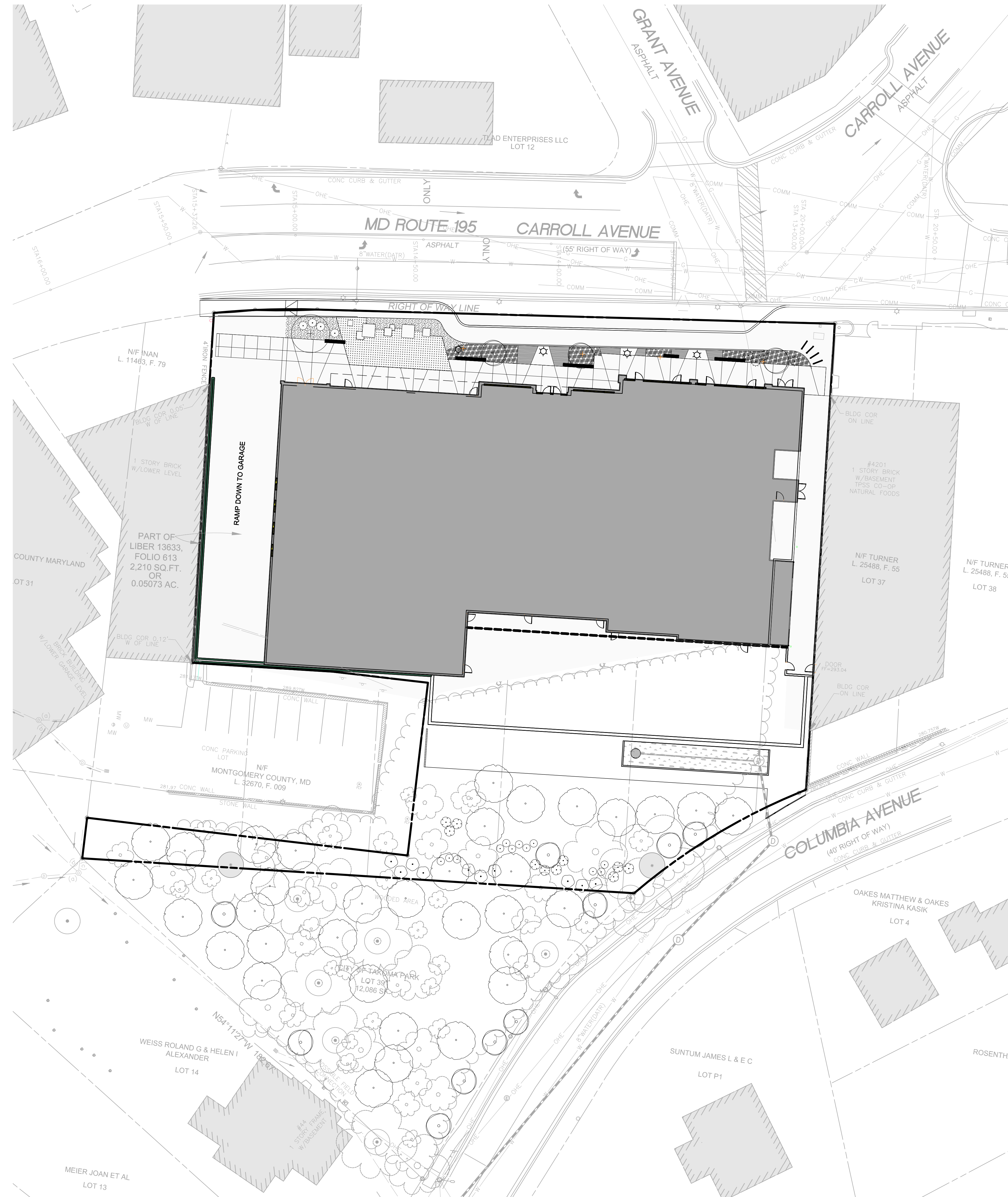

REVISIONS	DATE
REV. TO COMMENTS	4/30/2019

- SHEET INDEX:**
- L100 COVER SHEET
  - L110 OVERALL MATERIALS AND PAVING PLAN
  - L111 MATERIALS AND PAVING PLAN
  - L130 PLANTING PLAN
  - L131 TREE RE-PLANTING PLAN
  - L132 BIO-FILTER PLANTING PLAN
  - L200 AMENITY AREA PLAN
  - L300 LIGHTING PLAN
  - L503 SITE FURNISHING AND LIGHTING
  - L504 PLANTING PLAN NOTES AND DETAILS

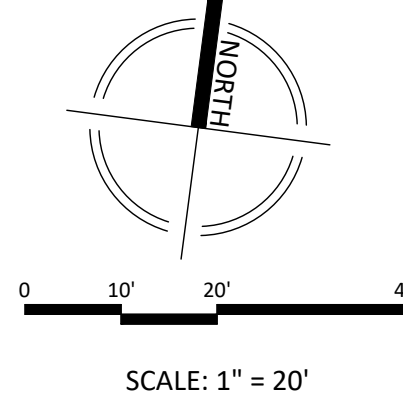

**TAKOMA JUNCTION**

MNCPPC #820190090  
 MONTGOMERY COUNTY,  
 MARYLAND  
 TAX MAP: JNS0  
 WSSC 208N301 & 209N301

**COVER SHEET**

**DEVELOPER'S CERTIFICATE**

The undersigned agrees to execute all the features of the Site Plan Approval No. 820190090, including Approval Conditions, Development Program and Certified Site Plan.

Developer's Name: NEIGHBORHOOD DEVELOPMENT COMPANY  
 Contact Person: JINGJING LIU  
 Address: 3232 GEORGIA AVENUE SUITE 100 WASHINGTON DC 20010  
 Phone: 202-567-3205  
 Signature: Jingjing Liu Date: \_\_\_\_\_

DRAWN BY: PJS  
 DESIGNED BY: JCS-DLK  
 DATE ISSUED: APR. 10, 2019  
 VKA  
 PROJECT: VM50263A

SHEET NO. L100

