

TAKOMA JUNCTION

SCHEMATIC LANDSCAPE ARCHITECTURE SITE PLAN

#820190090

VKA
 ENGINEERS PLANNERS
 LANDSCAPE ARCHITECTS SURVEYORS
 VKA MARYLAND, LLC
 20251 CENTURY BOULEVARD SUITE 400
 GERMANTOWN, MARYLAND 20874
 PHONE: (301) 916-4100
 FAX: (301) 916-2262
 GERMANTOWN, MD. 21753, VA.
 PREPARED FOR:
Neighborhood
Development Company
 3232 Georgia Avenue
 Suite 100
 Washington DC 20010
 202.567.3205
 Jingjing Liu

LANDSCAPE ARCHITECT
 VKA MARYLAND, LLC
 20251 CENTURY BOULEVARD
 SUITE 400
 GERMANTOWN MD, 20874
 301.916.4100
 JOSHUA C. SLOAN

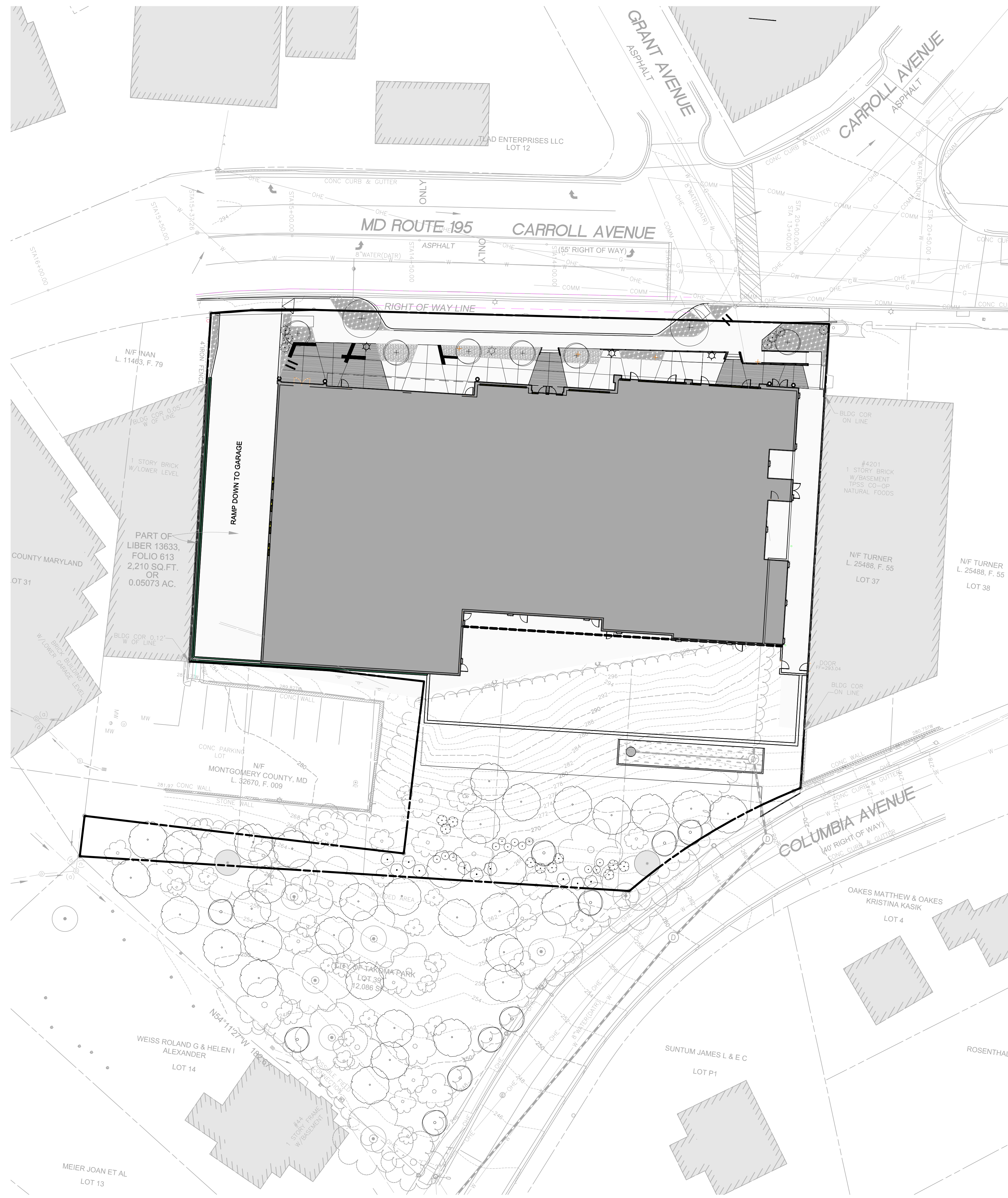

REVISIONS	DATE
REV. TO COMMENTS	4/30/2019
REV. TO COMMENTS	9/15/2020

SHEET INDEX:

- L100 COVER SHEET
- L110 MATERIALS AND PAVING PLAN
- L130 PLANTING PLAN
- L131 FOREST RE-PLANTING AND SCREENING PLAN
- L132 FOREST RE-PLANTING AND SCREENING PLAN- NOTES AND DETAILS
- L132 BIO-FILTER PLANTING PLAN
- L200 AMENITY AREA PLAN
- L300 LIGHTING PLAN
- L503 SITE FURNISHING AND LIGHTING

PROFESSIONAL SEAL

I HEREBY CERTIFY THAT THESE DOCUMENTS WERE PREPARED OR APPROVED BY ME, AND THAT I AM A QUALIFIED ENGINEER, REGISTERED ARCHITECT, LANDSCAPE ARCHITECT OR SURVEYOR UNDER THE CHARTER OF THE STATE OF MARYLAND. LICENSE NUMBER: 5776 EXPIRATION DATE: MAY 11, 2022

TAKOMA JUNCTION
 MNCPPC #820190090
 MONTGOMERY COUNTY,
 MARYLAND
 TAX MAP: JNS0
 WSSC 208N301 & 209N301

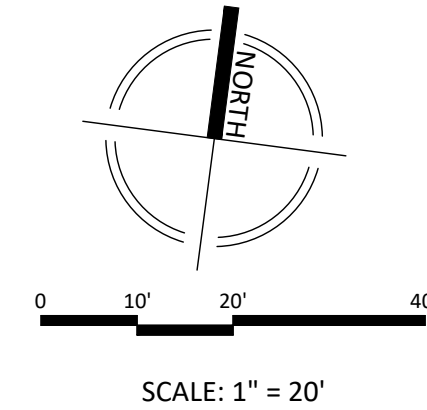

COVER SHEET

DRAWN BY: CC/DL
 DESIGNED BY: JS/RT
 DATE ISSUED: SEP. 15, 2020
 VKA PROJECT: VM50263A

DEVELOPER'S CERTIFICATE
 The undersigned agrees to execute all the features of the Site Plan Approval No. **820190090**, including Approval Conditions, Development Program and Certified Site Plan.
 Developer's Name: NEIGHBORHOOD DEVELOPMENT COMPANY
 Contact Person: JINGJING LIU
 Address: 3232 GEORGIA AVENUE SUITE 100 WASHINGTON DC 20010
 Phone: 202-567-3205
 Signature: *Jingjing Liu* Date: _____

SHEET NO. L100