

TAKOMA JUNCTION

SCHEMATIC LANDSCAPE ARCHITECTURE SITE PLAN

#820190090



ENGINEERS PLANNERS
LANDSCAPE ARCHITECTS SURVEYORS
VKA MARYLAND, LLC
20251 CENTURY BOULEVARD SUITE 400
GERMANTOWN, MARYLAND 20874
PHONE: (301) 916-4100
FAX: (301) 916-2262
GERMANTOWN, MD. TYSONS, VA.
PREPARED FOR:
Neighborhood
Development Company
3232 Georgia Avenue
Suite 100
Washington DC 20010
202.567.3205
Jingjing Liu

LANDSCAPE ARCHITECT
VKA MARYLAND, LLC
20251 CENTURY BOULEVARD
SUITE 400
GERMANTOWN MD, 20874
301.916.4100
JOSHUA C. SLOAN

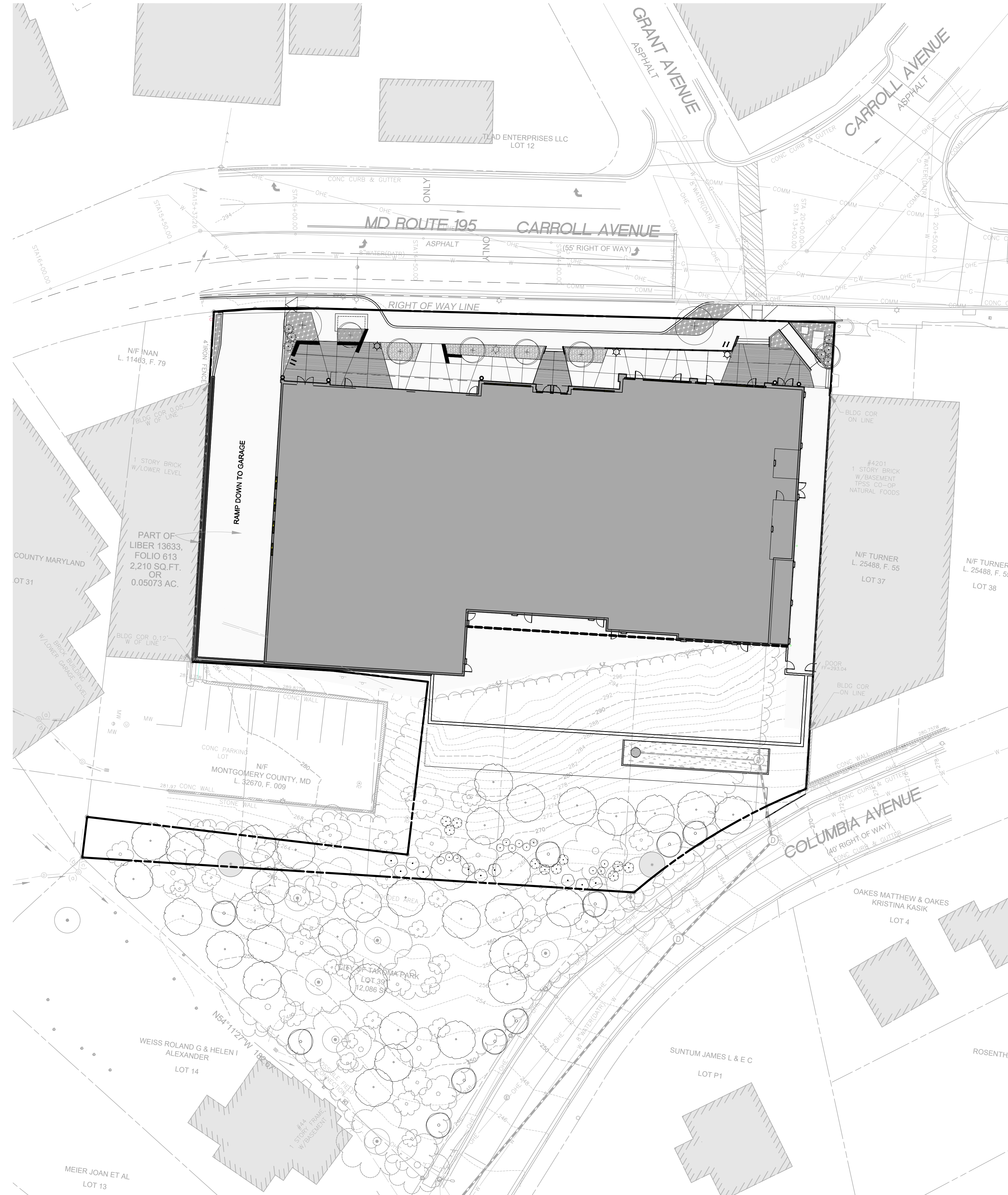

REVISIONS	DATE
REV. TO COMMENTS	4/30/2019
REV. TO COMMENTS	9/15/2020

PROFESSIONAL SEAL

SHEET INDEX:

- L100 COVER SHEET
- L110 MATERIALS AND PAVING PLAN
- L130 PLANTING PLAN
- L131 FOREST RE-PLANTING AND SCREENING PLAN
- L132 FOREST RE-PLANTING AND SCREENING PLAN- NOTES AND DETAILS
- L132 BIO-FILTER PLANTING PLAN
- L200 AMENITY AREA PLAN
- L300 LIGHTING PLAN
- L503 SITE FURNISHING AND LIGHTING

I HEREBY CERTIFY THAT THESE DOCUMENTS WERE PREPARED OR APPROVED BY ME, AND THAT I AM A QUALIFIED AND REGISTERED LANDSCAPE ARCHITECT UNDER THE CHARTER OF THE STATE OF MARYLAND. LICENSE NUMBER: 3776 EXPIRATION DATE: MAY 11, 2022

TAKOMA JUNCTION
MNCPPC #820190090
MONTGOMERY COUNTY,
MARYLAND
TAX MAP: JN50
WSSC 208N301 & 209N301

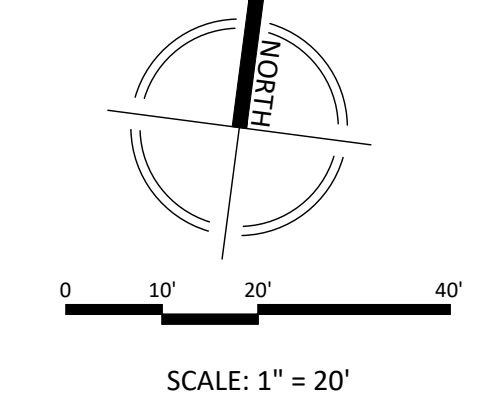

COVER SHEET

DEVELOPER'S CERTIFICATE
The undersigned agrees to execute all the features of the Site Plan Approval No. **820190090**, including Approval Conditions, Development Program and Certified Site Plan.

Developer's Name: NEIGHBORHOOD DEVELOPMENT COMPANY
Contact Person: JINGJING LIU
Address: 3232 GEORGIA AVENUE SUITE 100 WASHINGTON DC 20010
Phone: 202.567.3205
Signature: *Jingjing Liu* Date: _____

DRAWN BY: CC/DL
DESIGNED BY: JS/RT
DATE ISSUED: SEP. 15, 2020
VKA PROJECT: VM50263A
SHEET NO. L100