

E-FILE STAMP

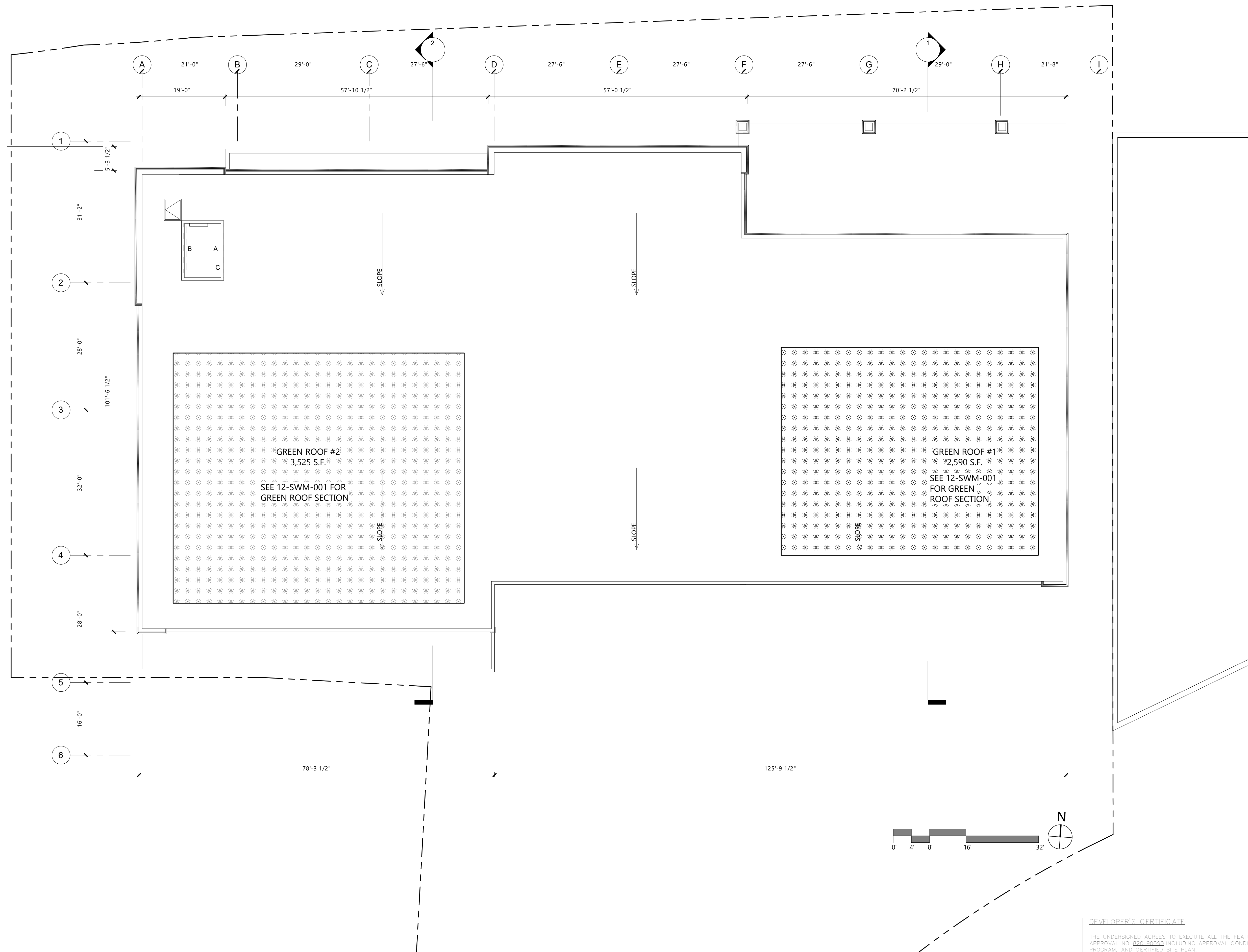

**AMT LLC**  
 PROFESSIONAL ENGINEERS  
 LAND SURVEYORS  
 LANDSCAPE ARCHITECTS  
 10 G STREET, NE, SUITE 430  
 WASHINGTON, DC 20002  
 PH: (202)289-4545  
 FAX: (202)289-5051



**TWO POINTS OF VIEW  
 ARCHITECTURAL STUDIO**

**SITE PLAN #820190090**  
**TAKOMA JUNCTION**  
 13TH ELECTION DISTRICT  
 CITY OF TAKOMA PARK  
 MONTGOMERY COUNTY, MARYLAND  
 TAX MAP: JN51  
 WSSC GRID: 208NE01 & 209NE01

DATE	REVISION

PROFESSIONAL CERTIFICATION: I CERTIFY THAT THESE DOCUMENTS WERE PREPARED OR APPROVED BY ME, AND THAT I AM A QUALY LICENSED ARCHITECT UNDER THE LAWS OF THE STATE OF MARYLAND, LICENSE NUMBER 18221, EXPIRATION DATE: 8/27/2021

DESIGNED	KML
CHECKED	KML
SCALE	AS SHOWN
FILE NO.	114-123
DATE	JULY 2020

**DEVELOPER'S CERTIFICATE**  
 THE UNDERSIGNED AGREES TO EXECUTE ALL THE FEATURES OF THE SITE PLAN APPROVAL NO. 820190090 INCLUDING APPROVAL CONDITIONS, DEVELOPMENT PROGRAM, AND CERTIFIED SITE PLAN.  
 DEVELOPER: NEIGHBORHOOD DEVELOPMENT COMPANY    JINGJING LIU  
 COMPANY    CONTACT PERSON  
 ADDRESS: 1232 GEORGIA AVENUE NW, SUITE 100, WASHINGTON, DC 20010  
 EMAIL: [info@neighborhooddevelopment.com](mailto:info@neighborhooddevelopment.com)  
 SIGNATURE: *Jingjing Liu*

# ROOF PLAN