

E-FILE STAMP

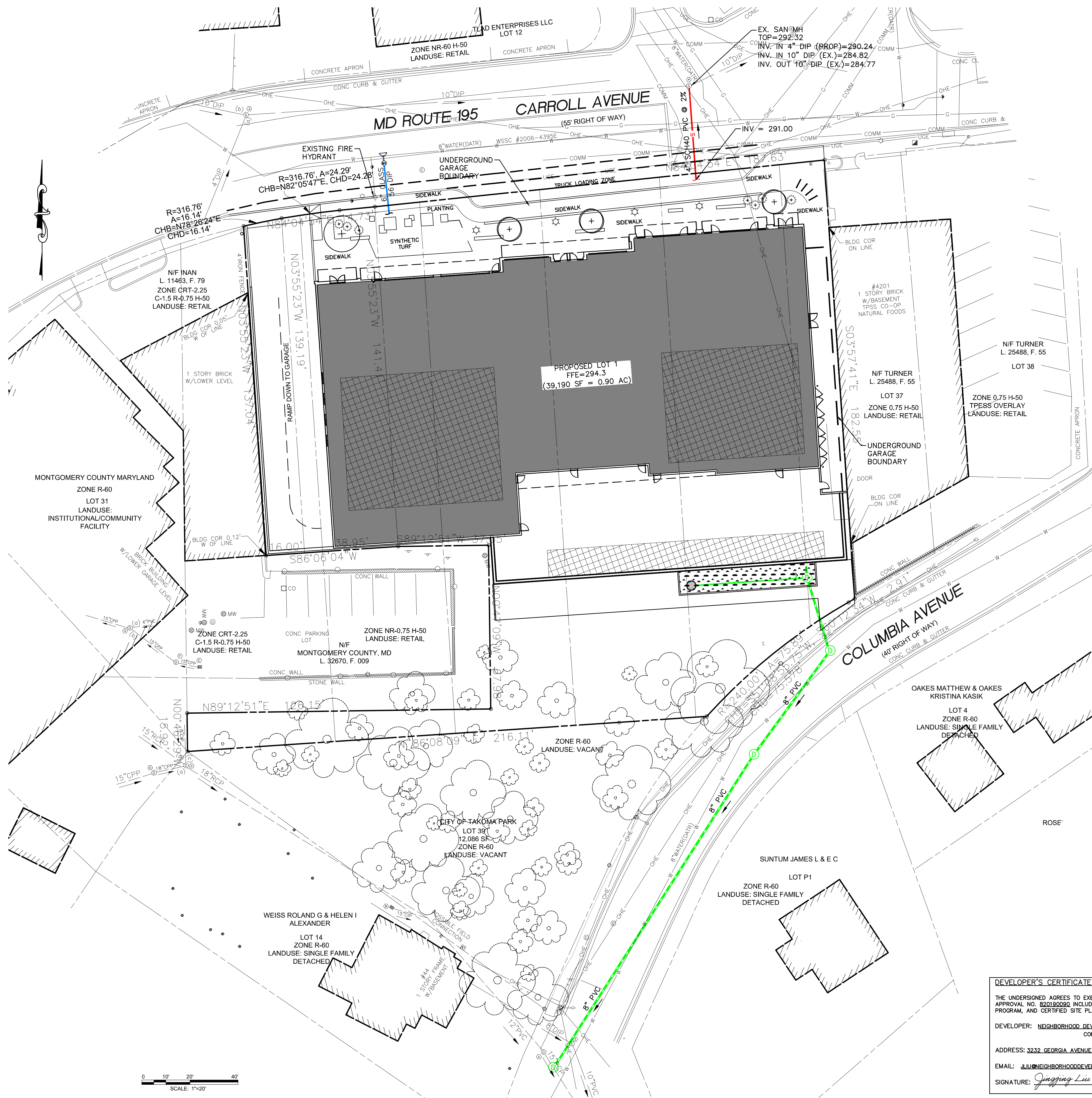

- LEGEND**
- SANITARY SEWER
 - WATER SERVICE
 - STORM SEWER
 - STORM DRAIN MANHOLE
 - SANITARY SEWER MANHOLE
 - WATER VALVE
 - NYLOPLAST DRAIN BASIN WITH GRATE INLET TOP
 - STORM CLEANOUT

"MISS UTILITY" NOTE
 CALL "MISS UTILITY" AT 1-800-257-7777, 48 HOURS PRIOR TO THE START OF WORK. THE EXCAVATOR MUST NOTIFY ALL PUBLIC UTILITY COMPANIES WITH UNDERGROUND FACILITIES IN THE AREA OF PROPOSED EXCAVATION AND HAVE THOSE FACILITIES LOCATED BY THE UTILITY COMPANIES PRIOR TO COMMENCING EXCAVATION. THE EXCAVATOR IS RESPONSIBLE FOR COMPLIANCE WITH REQUIREMENTS OF CHAPTER 36A OF THE MONTGOMERY COUNTY CODE.

SCALE: 1"=20'

AMT LLC
 PROFESSIONAL ENGINEERS
 LAND SURVEYORS
 LANDSCAPE ARCHITECTS
 10 G STREET, NE, SUITE 430
 WASHINGTON, DC, 20002
 PH: (202) 289-4545
 FAX: (202) 289-5051

SITE PLAN #820190090
TAKOMA JUNCTION
 13TH ELECTION DISTRICT
 CITY OF TAKOMA PARK
 MONTGOMERY COUNTY, MARYLAND
 TAX MAP: JN51
 WSSC GRID: 208NE01 & 209NE01

DATE	REVISION



PROFESSIONAL CERTIFICATION: I HEREBY CERTIFY THAT THESE DOCUMENTS WERE PREPARED OR APPROVED BY ME AND I AM AN A LICENSED PROFESSIONAL ENGINEER UNDER THE LAWS OF THE STATE OF MARYLAND LICENSE NO. 38317 EXPIRATION DATE: 04/07/2020

UTILITY PLAN (COLOR)

DESIGNED	AMC
CHECKED	BCJ
SCALE	AS SHOWN
FILE NO.	114-123
DATE	JULY 2020

C5.02

DEVELOPER'S CERTIFICATE
 THE UNDERSIGNED AGREES TO EXECUTE ALL THE FEATURES OF THE SITE PLAN APPROVAL NO. 820190090 INCLUDING APPROVAL CONDITIONS, DEVELOPMENT PROGRAM, AND CERTIFIED SITE PLAN.
 DEVELOPER: NEIGHBORHOOD DEVELOPMENT COMPANY JINGJING LIU
 COMPANY CONTACT PERSON
 ADDRESS: 3232 GEORGIA AVENUE NW, SUITE 100, WASHINGTON, DC 20010
 EMAIL: JL@NEIGHBORHOODEVELOPMENT.COM
 SIGNATURE: Jingjing Liu