

E-FILE STAMP

AMT LLC
PROFESSIONAL ENGINEERS
LAND SURVEYORS
LANDSCAPE ARCHITECTS
10 G STREET, NE, SUITE 430
WASHINGTON, DC 20002
PH: (202) 289-4545
FAX: (202) 289-5051

PRELIMINARY PLAN #120190150
TAKOMA JUNCTION
13TH ELECTION DISTRICT
CITY OF TAKOMA PARK
MONTGOMERY COUNTY, MARYLAND
TAX MAP: JN51
WSSC GRID: 208NE01 & 209NE01

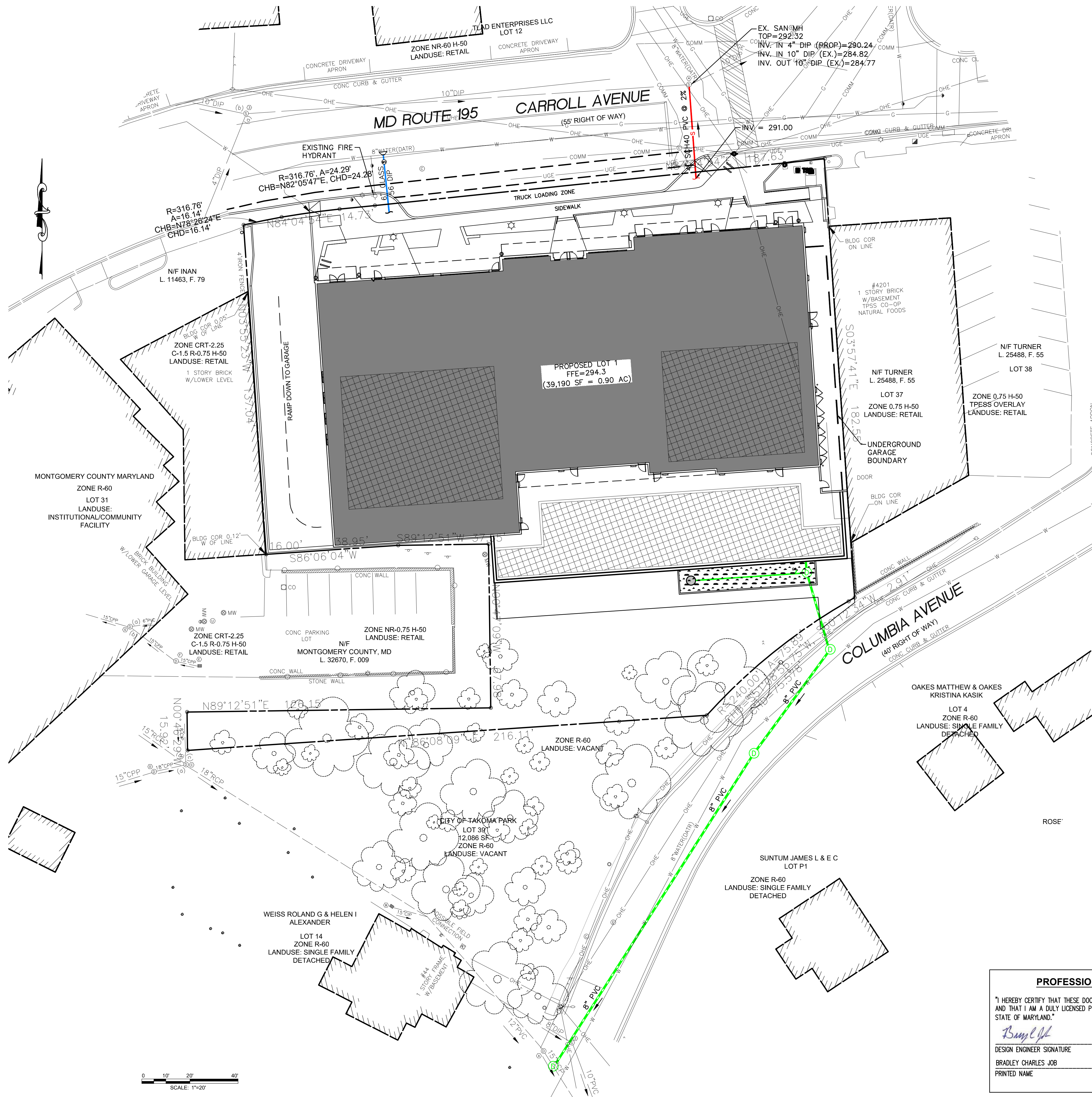

- LEGEND**
- SANITARY SEWER
 - WATER SERVICE
 - STORM SEWER
 - STORM DRAIN MANHOLE
 - SANITARY SEWER MANHOLE
 - WATER VALVE
 - NYLOPLAST DRAIN BASIN WITH GRATE INLET TOP
 - STORM CLEANOUT

"MISS UTILITY" NOTE
CALL "MISS UTILITY" AT 1-800-257-7777, 48 HOURS PRIOR TO THE START OF WORK. THE EXCAVATOR MUST NOTIFY ALL PUBLIC UTILITY COMPANIES WITH UNDERGROUND FACILITIES IN THE AREA OF PROPOSED EXCAVATION AND HAVE THOSE FACILITIES LOCATED BY THE UTILITY COMPANIES PRIOR TO COMMENCING EXCAVATION. THE EXCAVATOR IS RESPONSIBLE FOR COMPLIANCE WITH REQUIREMENTS OF CHAPTER 36A OF THE MONTGOMERY COUNTY CODE.

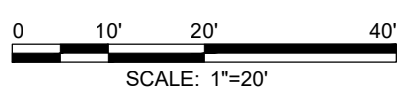

PROFESSIONAL CERTIFICATION

"I HEREBY CERTIFY THAT THESE DOCUMENTS WERE PREPARED OR APPROVED BY ME, AND THAT I AM A DULY LICENSED PROFESSIONAL ENGINEER UNDER THE LAWS OF THE STATE OF MARYLAND."

Bradley Charles Job
DESIGN ENGINEER SIGNATURE
BRADLEY CHARLES JOB
PRINTED NAME

OCTOBER 16, 2020
DATE
38317
REGISTRATION NUMBER

DATE	REVISION

UTILITY PLAN (COLOR)

DESIGNED	AMC
CHECKED	BCJ
SCALE	AS SHOWN
FILE NO.	114-123
DATE	OCTOBER 2020

C5.02