

E-FILE STAMP

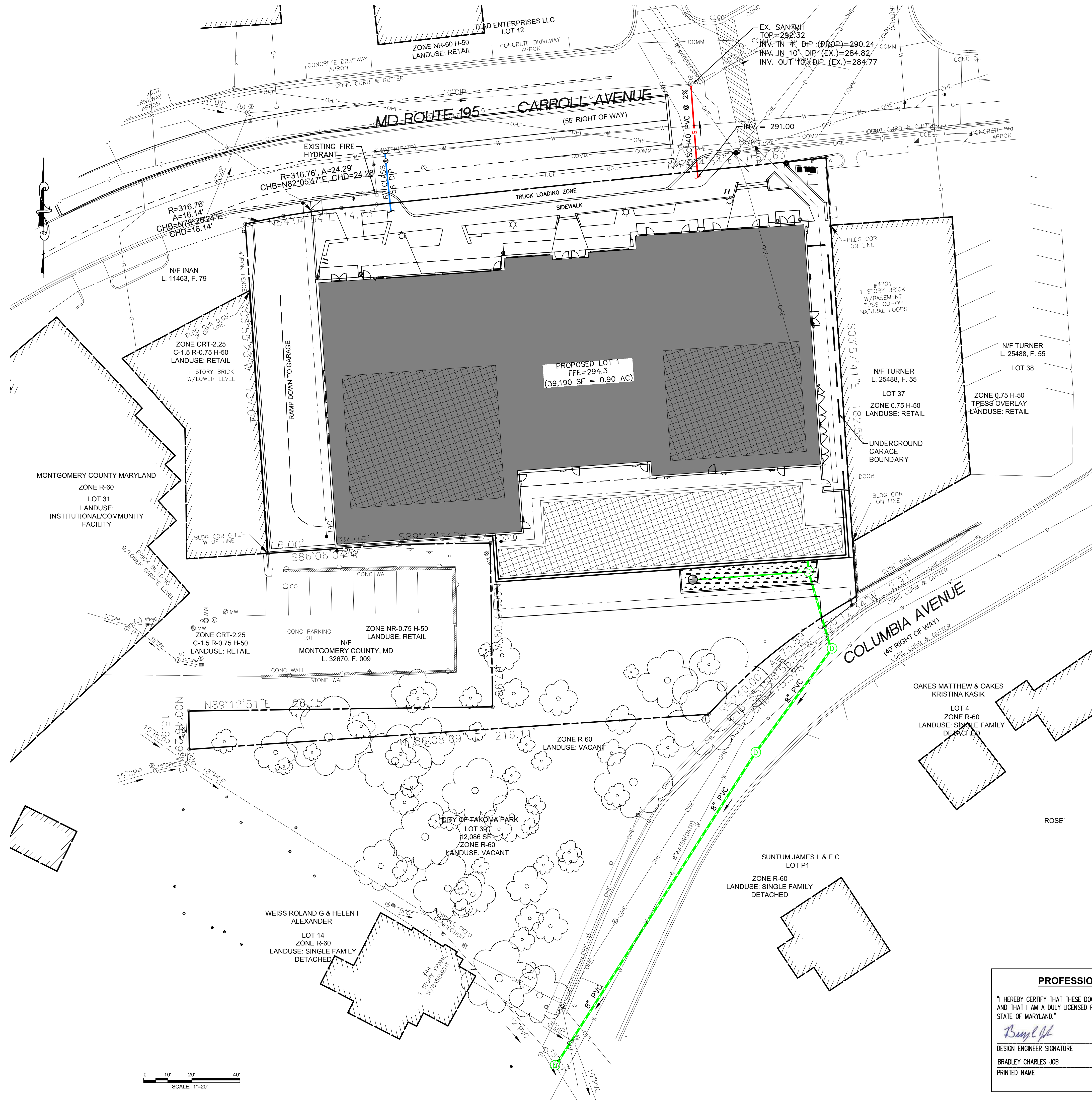

LEGEND

- S— SANITARY SEWER
- W— WATER SERVICE
- SS— STORM SEWER
- ① STORM DRAIN MANHOLE
- ⊙ SANITARY SEWER MANHOLE
- ⊗ WATER VALVE
- ⊕ NYLOPLAST DRAIN BASIN WITH GRATE INLET TOP
- COO STORM CLEANOUT

"MISS UTILITY" NOTE

CALL "MISS UTILITY" AT 1-800-257-7777, 48 HOURS PRIOR TO THE START OF WORK. THE EXCAVATOR MUST NOTIFY ALL PUBLIC UTILITY COMPANIES WITH UNDERGROUND FACILITIES IN THE AREA OF PROPOSED EXCAVATION AND HAVE THOSE FACILITIES LOCATED BY THE UTILITY COMPANIES PRIOR TO COMMENCING EXCAVATION. THE EXCAVATOR IS RESPONSIBLE FOR COMPLIANCE WITH REQUIREMENTS OF CHAPTER 36A OF THE MONTGOMERY COUNTY CODE.

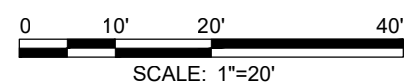

AMT LLC
 PROFESSIONAL ENGINEERS
 LAND SURVEYORS
 LANDSCAPE ARCHITECTS
 10 G STREET, NE, SUITE 430
 WASHINGTON, DC, 20002
 PH: (202) 289-4545
 FAX: (202) 289-5051

PRELIMINARY PLAN #120190150
TAKOMA JUNCTION
 13TH ELECTION DISTRICT
 CITY OF TAKOMA PARK
 MONTGOMERY COUNTY, MARYLAND
 TAX MAP: JN51
 WSSC GRID: 208NE01 & 209NE01

DATE	REVISION

PROFESSIONAL CERTIFICATION: I HEREBY CERTIFY THAT THESE DOCUMENTS WERE PREPARED OR APPROVED BY ME, AND THAT I AM A DULY LICENSED PROFESSIONAL ENGINEER UNDER THE LAWS OF THE STATE OF MARYLAND. LICENSE NO. 38317 EXPIRATION DATE: 09/27/2024.

UTILITY PLAN (COLOR)

DESIGNED	AMC
CHECKED	BCJ
SCALE	AS SHOWN
FILE NO.	114-123
DATE	JANUARY 2021

PROFESSIONAL CERTIFICATION

"I HEREBY CERTIFY THAT THESE DOCUMENTS WERE PREPARED OR APPROVED BY ME, AND THAT I AM A DULY LICENSED PROFESSIONAL ENGINEER UNDER THE LAWS OF THE STATE OF MARYLAND."

Bradley Charles Job
 DESIGN ENGINEER SIGNATURE
 DATE: JANUARY 15TH, 2021

BRADLEY CHARLES JOB
 PRINTED NAME
 38317
 REGISTRATION NUMBER

C5.02