

Roadway B-9 Section with parking

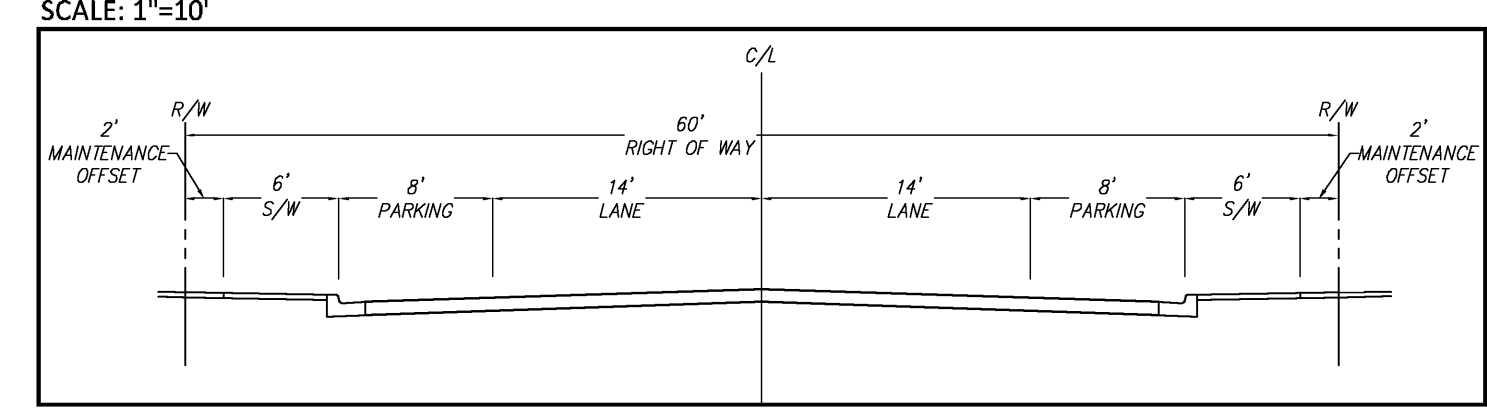

Roadway B-9 Section without parking

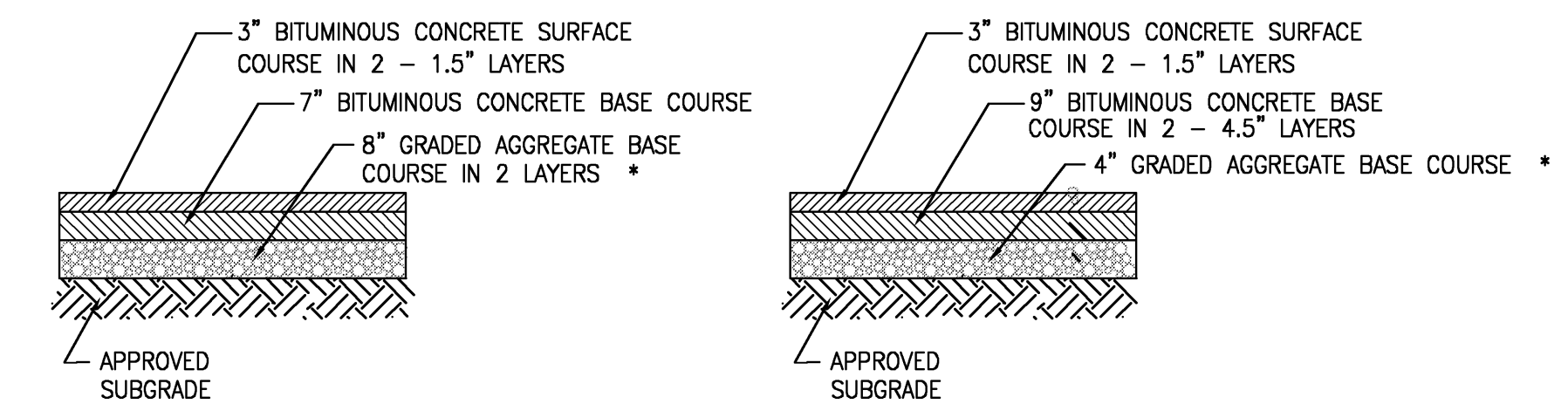
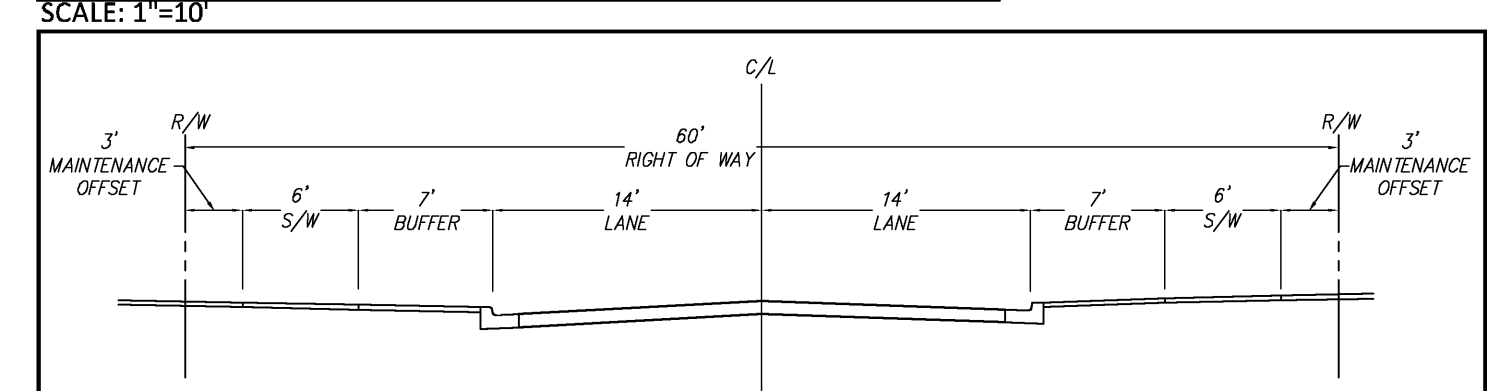

* SUBGRADE DRAINS REQUIRED (SEE MC-525.01)

PUBLIC STREET PAVING SECTION

NOT TO SCALE

TARGET SPEED: 25 MPH

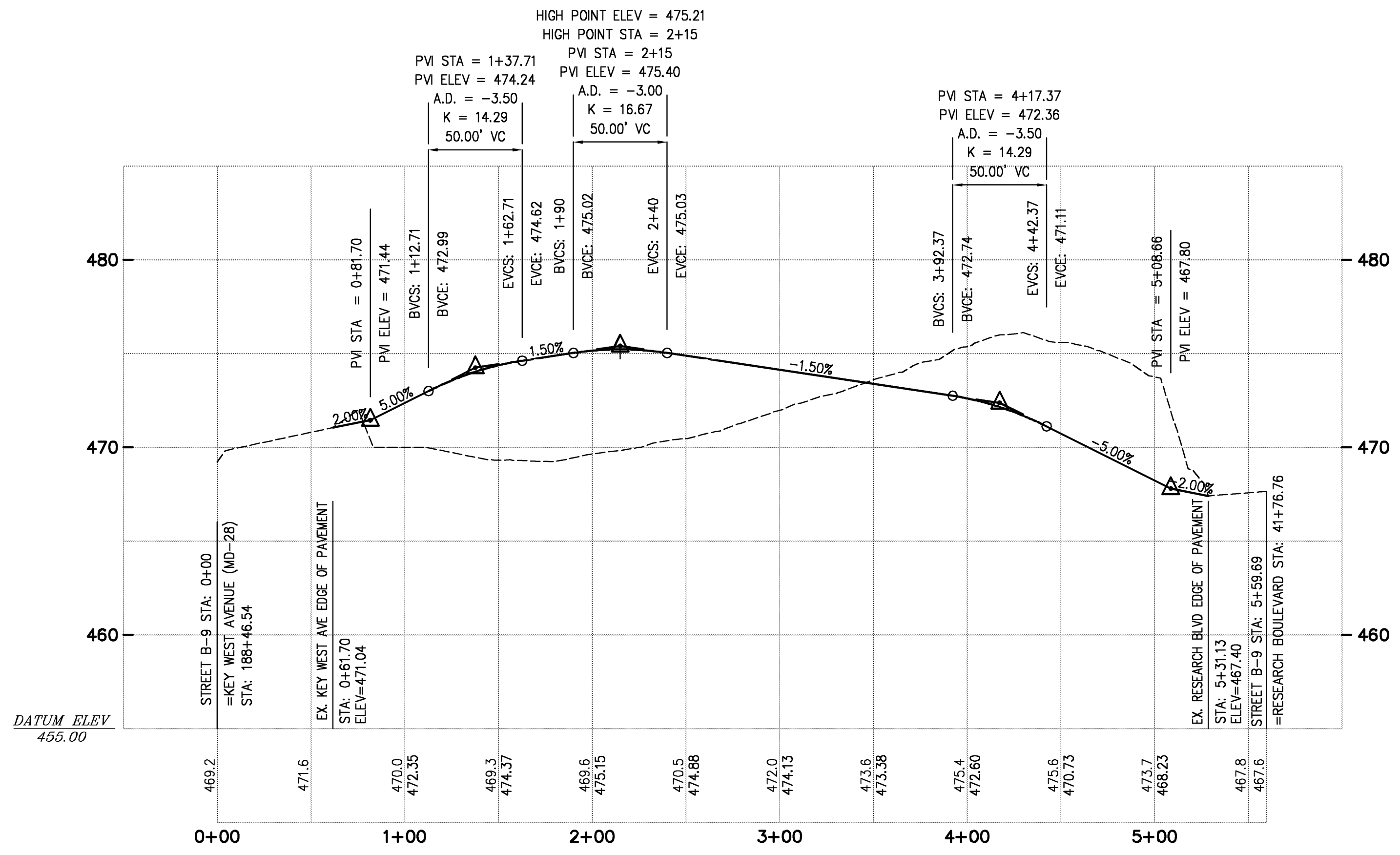

LEGEND

EXISTING GROUND	---
EXISTING GROUND (19' RIGHT)	---
EXISTING GROUND (19' LEFT)	---
EXISTING GROUND (35' RIGHT)	---
EXISTING GROUND (35' LEFT)	---
PROPOSED GRADE LINE (PGL)	1.00%
FUTURE GRADE LINE (PGL)	1.00%
VERTICAL CURVE POINT (VC)	
POINT OF VERTICAL INTERSECTION (PVI)	

PROFESSIONAL CERTIFICATION

I hereby certify that these documents were prepared or approved by me, and that I am a duly licensed Professional Engineer under the laws of the State of Maryland.

Signature: Jagdish Mandavia, PE
 Printed Name: Jagdish C. Mandavia
 Title: Senior Associate
 License No: 20776
 Date: June 19, 2012
 Expiration Date: March 22, 2013

PAVING, STORM DRAINAGE AND OTHER CONSTRUCTION INDICATED HEREON ARE FURNISHED AS BASIC INFORMATION REQUIRED BY MONTGOMERY COUNTY ROAD CONSTRUCTION CODE. THIS INFORMATION IS SUBJECT TO CHANGE AND IS NOT TO BE USED FOR CONSTRUCTION. FOR CONSTRUCTION SEE APPROVED STORM DRAIN AND PAVING PLANS.

- GENERAL NOTES:**
- REFER TO MARYLAND STATE HIGHWAY ADMINISTRATION SPECIFICATIONS FOR MATERIALS AND METHODS OF CONSTRUCTION.
 - SEE STANDARD MC-811.01-METHODS OF GRADING SLOPE SIDES.
 - SEE STANDARD MC-810-01 SWALE SECTION.
 - TOP OF CURB ELEVATION = CENTERLINE ELEVATION +0.02'(L) CENTERLINE ELEVATION +0.02'(RT)

DPS REVIEW #XXXXXX

APPROVED FOR STREET GRADES ONLY	
Montgomery County, Maryland Department of Permit Service	Maryland-National Capital Park and Planning Commission
Date: _____	Date: _____
By: _____	By: _____
M-NCP&PC Approved Profile No. _____	

REVIEW No.

MONTGOMERY COUNTY, MARYLAND DEPARTMENT OF PERMITTING SERVICES	
DATE: _____	
BY: _____	

VIKA
 ENGINEERS ■ PLANNERS ■ LANDSCAPE ARCHITECTS ■ SURVEYORS ■ GPS SERVICES
 ATTN: SUNIL PATEL
 EMAIL: PATEL@VIKA.COM
 VIKA INCORPORATED
 137H ELECTION DISTRICT
 MONTGOMERY COUNTY, MARYLAND
 20251 CENTURY BOULEVARD SUITE 400 GERMANTOWN, MD 20874
 (301) 251-1100 (C) 2012 VIKA INCORPORATED

MALLORY SQUARE
 LIBER 15342 FOLIO 128
 13TH ELECTION DISTRICT
 MONTGOMERY COUNTY, MARYLAND

**STREET B-9
 GRADE ESTABLISHMENT
 PLAN**

VIKA REVISIONS

DATE: JUNE 2012	
DES. SHP	DWN. CAD
SCALE: AS SHOWN	
PROJECT/FILE NO. VM1667A	
SHEET NO. GEP 1 OF 1	

"FOR LOCATION OF UTILITIES CALL 8-1-1 or 1-800-257-7777 OR LOG ON TO www.call811.com or http://www.missutility.net 48 HOURS IN ADVANCE OF ANY WORK IN THIS VICINITY"

The excavator must notify all public utility companies with underground facilities in the area of proposed excavation and have those facilities located by the utility companies prior to commencing excavation. The excavator is responsible for compliance with requirements of Chapter 36A of the Montgomery County Code.