

LEGEND - SITE ELEMENTS

- CANOPY STREET TREE
- SMALL FLOWERING TREE
- GROUNDCOVER
- CONCRETE PAVING
- SPECIAL UNIT PAVING (PLAZA)
- SPECIAL UNIT PAVING (STREETSAFE)
- PLANTER WALL
- BENCH
- WASHINGTON GLOBE STREET LIGHT

Developer's Certificate
 THE UNDERSIGNED AGREES TO EXECUTE ALL THE FEATURES OF THE SITE PLAN APPROVAL NO. 820200080 INCLUDING APPROVAL CONDITIONS, DEVELOPMENT PROGRAM, AND CERTIFIED SITE PLAN.

Developer: Ardenes Partners, LLC. John Davis
 Company Contact Person

Address: 7113 Warbler Lane
McLean, Virginia 22101

Phone: 703 - 932 - 6666

Signature: _____

MATCHLINE -
 08-LL-82020008-101

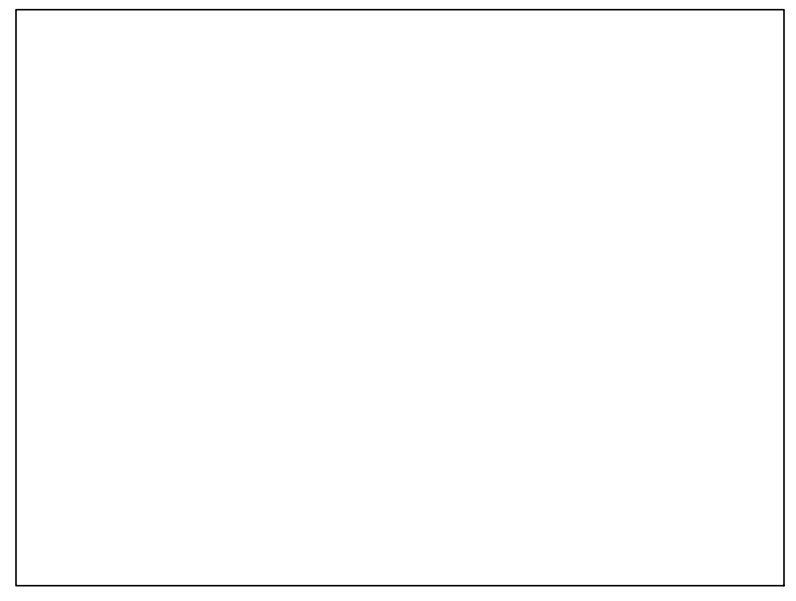

Montgomery County Planning Department

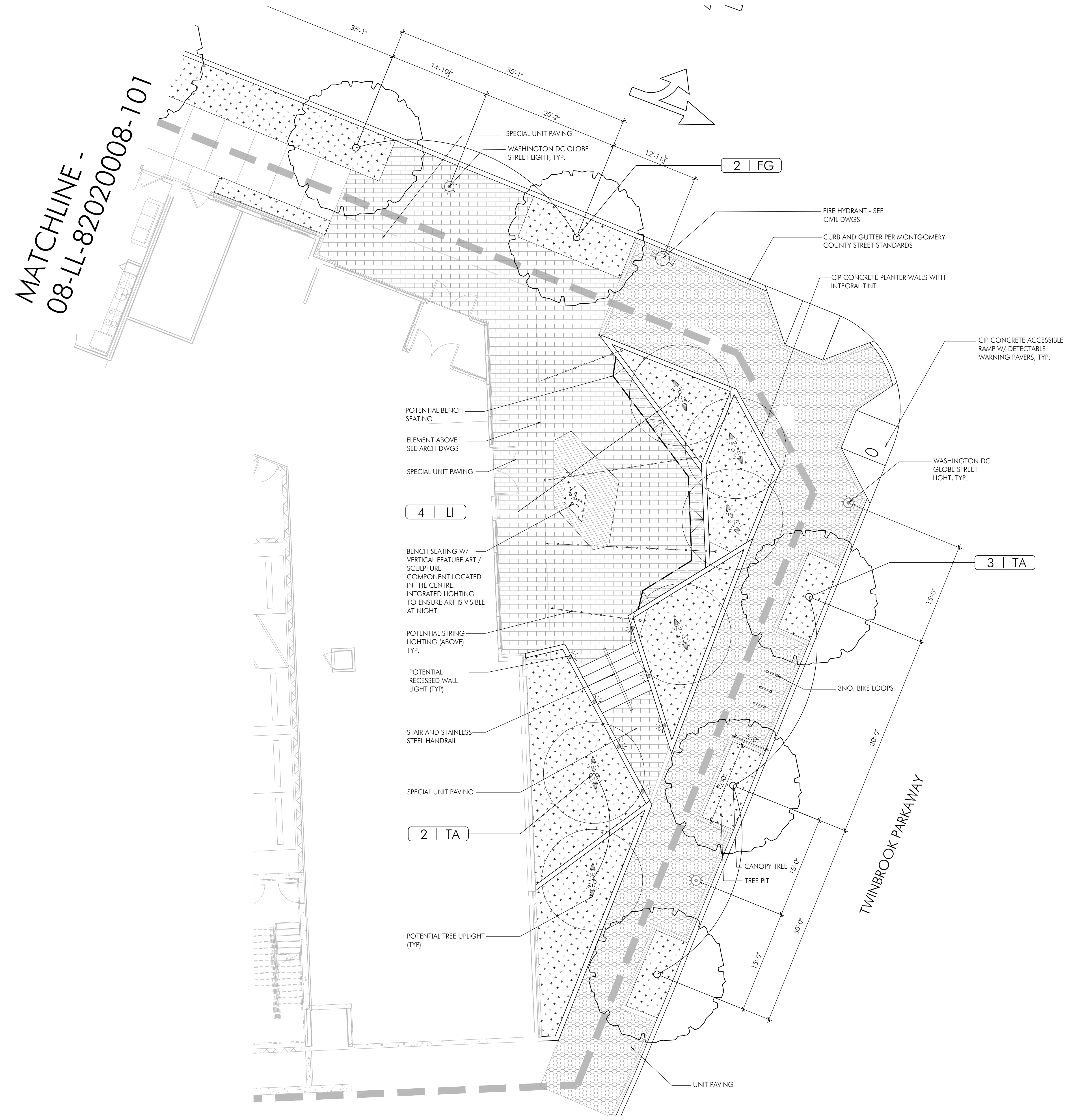

4 | LI

2 | FG

3 | TA

2 | TA