

Montgomery County Planning Department



ILLUSTRATIVE BENCH PHOTO - PROVIDED TO SHOW CHARACTER AND DESIGN INTENT

**BENCH**

MANUFACTURER: STREETLIFE

MODEL: SOLID SERIF

FINISH/COLOR: FSC HARDWOOD AND STEEL W/ A POWDER COAT PAINT FINISH - COLOR TBD

**02 BENCH SURFACE MOUNTED - DETAILS (FREESTANDING BENCH - ALT 'A')**

SCALE : NTS

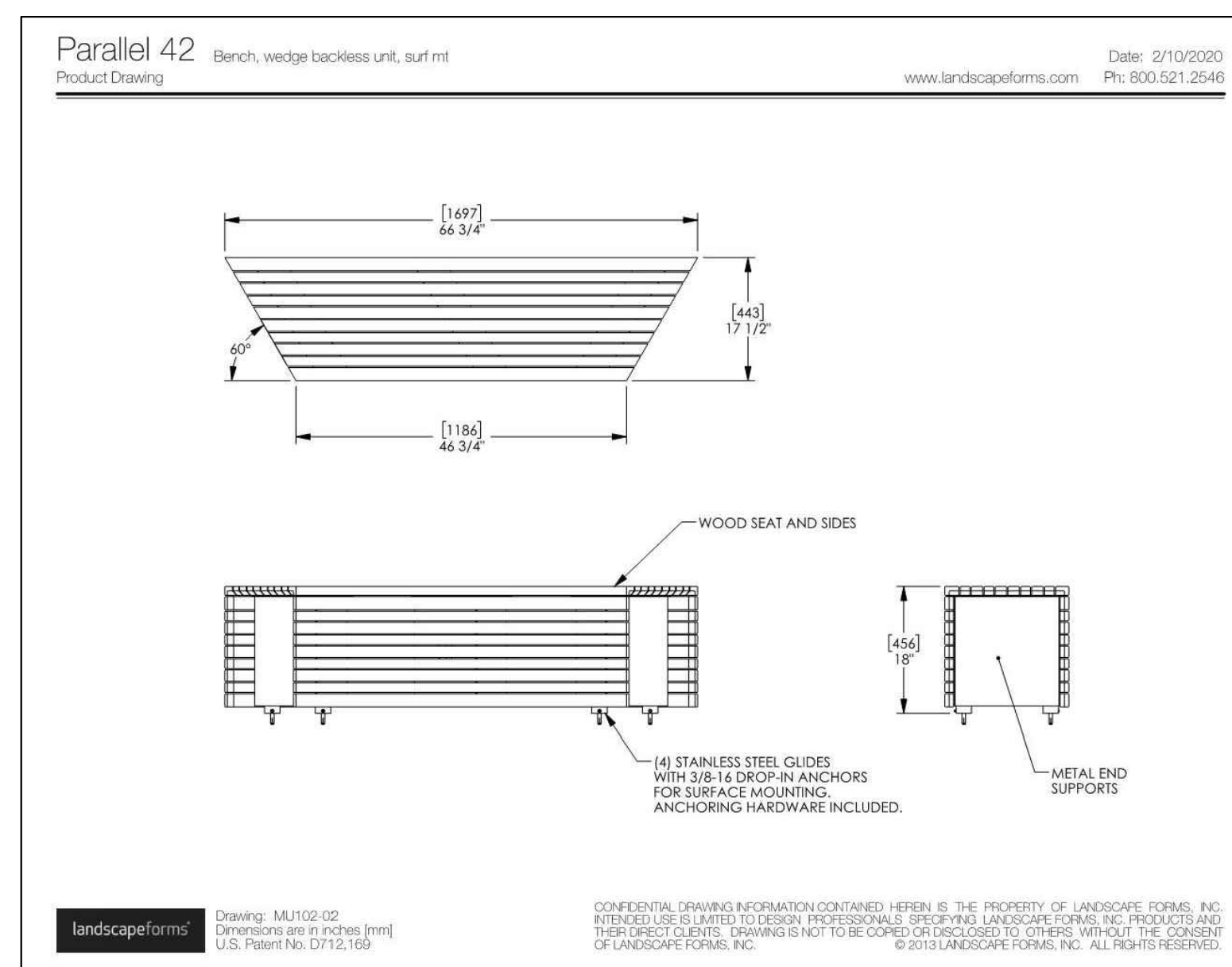

**BENCH**

MANUFACTURER: LANDSCAPE FORMS

MODEL: PARALLEL

FINISH/COLOR: FSC IPE AND STEEL W/ A POWDER COAT PAINT FINISH - COLOR TBD

**03 BENCH SURFACE MOUNTED - DETAILS (FREESTANDING BENCH - ALT 'B')**

SCALE : NTS



**PODIUM BENCH**

MANUFACTURER: STREETLIFE

MODEL: PODIUM W/ CUSTOM ANGULAR FABRICATED SHAPE  
FINISH/COLOR: FSC HARDWOOD AND POWDER COAT PAINT - COLOR TBD

**04 SCULPTURED WOOD BENCH - CONCEPT IMAGE**

SCALE : NTS

**01 SCULPTURED WOOD BENCH - ENLARGED PLAN**

SCALE : 1/2" = 1'-0"

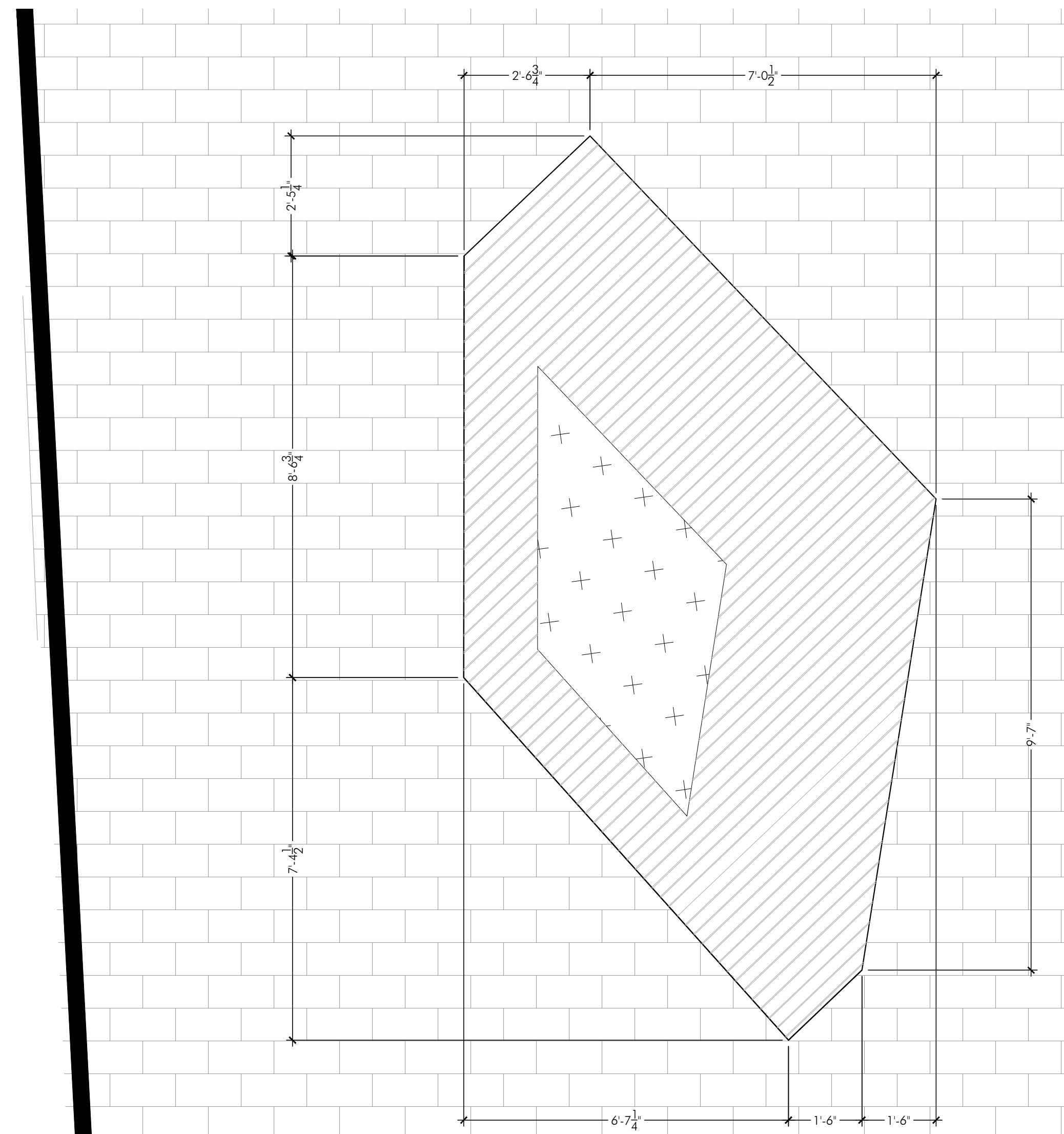

PARKER RODRIGUEZ INC.  
101 NORTH UNION STREET  
SUITE 340  
ALEXANDRIA, VA 22314  
PH: 703.548.5010  
www.parkerrodriguez.com

CONTACT  
TRINI RODRIGUEZ  
101 NORTH UNION STREET  
SUITE 340  
ALEXANDRIA, VA 22314  
PH: 703.548.5010  
www.parkerrodriguez.com

APPLICANT  
ARDENNES PARTNERS, LLC.  
7113 WARBLER LANE  
MCLEAN, VA 22101  
PH: 703 - 932 - 6666  
CONTACT: JOHN DAVIS

12500 ARDENNES  
12500 Ardenes Ave. Rockville, MD 20852  
LOT P3 / BLOCK A / PARCEL N184  
MONTGOMERY COUNTY, MARYLAND  
4TH ELECTION DISTRICT  
PLAT 10000 LIBER 24446, FOLIO 157  
WSSC SHEET MAP 216NW06, TAX MAP GRID GQ63

REVISIONS	
DATE	DESCRIPTION
04/01/2020	SITE PLAN RESUBMISSION
04/21/2020	SITE PLAN RESUBMISSION

SITE PLAN  
Site Furnishings - Streetscape

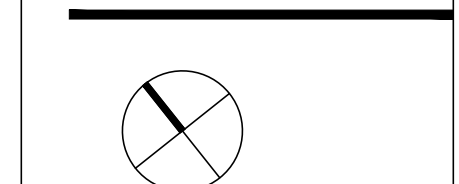

SHEET NUMBER:  
08-LL-820200080-501

**Developer's Certificate**  
THE UNDERSIGNED AGREES TO EXECUTE ALL THE FEATURES OF THE SITE PLAN APPROVAL NO. 8201 \_\_\_\_\_ INCLUDING APPROVAL CONDITIONS, DEVELOPMENT PROGRAM, AND CERTIFIED SITE PLAN.

Developer: Ardenes Partners, LLC. John Davis  
Company Contact Person

Address: 7113 Warbler Lane  
McLean, Virginia 22101

Phone: 703 - 932 - 6666

Signature: \_\_\_\_\_