

PLANNING DEPARTMENT USE ONLY (E-PLANS)

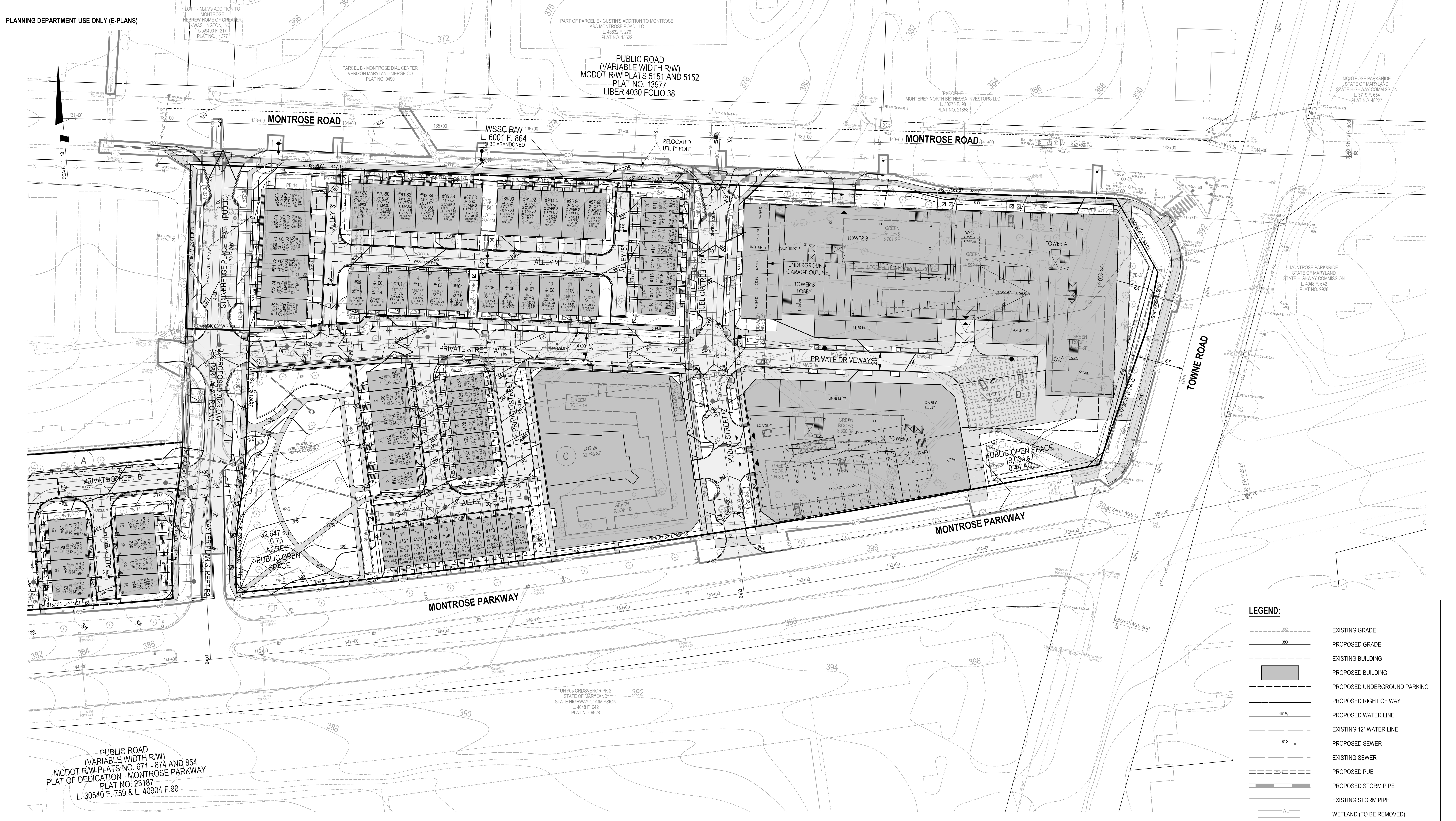

LEGEND:

	EXISTING GRADE
	PROPOSED GRADE
	EXISTING BUILDING
	PROPOSED BUILDING
	PROPOSED UNDERGROUND PARKING
	PROPOSED RIGHT OF WAY
	PROPOSED WATER LINE

ENGINEER'S CERTIFICATE
 I HEREBY CERTIFY, TO THE BEST OF MY PROFESSIONAL KNOWLEDGE, INFORMATION AND BELIEF, THAT THE PLAN SHOWS HEREON CONFORMS WITH THE MONTGOMERY COUNTY SUBDIVISION REGULATIONS AS ADOPTED OCTOBER 1961 AND AS AMENDED THEREAFTER.
 SIGNATURE: BRANDON J. FRITZ, P.E. TITLE: PROJECT MANAGER
 DATE: _____
 MD. REG. NO. 26286

SOLTESZ, INC.
 Rockville
 Lanham
 Waldorf
 Leonardtown
 Frederick
 Soltesz DC, LLC
 ROCKVILLE OFFICE
 2 Research Place, Suite 100
 Rockville, MD 20850
 P. 301.948.2750 F. 301.948.9067
 www.soltesz.com

NO.	DATE	REVISIONS	BY	DATE	
DESIGNED:	JANUARY 2020	CAO STANDARDS VERSION:	18 - NCS	TECHNICIAN:	NC
CHECKED:					

MISS UTILITY NOTE
 INFORMATION CONCERNING EXISTING UNDERGROUND UTILITIES WAS OBTAINED FROM AVAILABLE RECORDS; THE CONTRACTOR MUST DETERMINE THE EXACT LOCATION AND ELEVATION OF ALL EXISTING UTILITIES AND UTILITIES ORIGINALLY BY ENGINEER TEST FITS BY HAND, WELL IN ADVANCE OF THE START OF EXCAVATION. CONTACT "MISS UTILITY" AT 1-800-251-7777 48 HOURS PRIOR TO THE START OF EXCAVATION. IF CLEARANCES ARE LESS THAN SHOWN ON THIS PLAN OR TWELVE (12) INCHES, WHICHEVER IS LESS, CONTACT THE ENGINEER AND THE UTILITY COMPANY BEFORE PROCEEDING WITH CONSTRUCTION. CLEARANCES LESS THAN NOTED MAY REQUIRE REVISIONS TO THIS PLAN.

OWNER/DEVELOPER/APPLICANT
 WILGUS/MONTROSE ASSOCIATES LLC
 7811 MONTROSE ROAD
 SUITE 200
 POTOMAC, MD 20854
 PHONE: (301) 396-1500
 ROCKING@WILCO.COM
 RICHARD COHEN

PROFESSIONAL CERTIFICATION
 I HEREBY CERTIFY THAT THESE DOCUMENTS WERE PREPARED OR APPROVED BY ME, AND THAT I AM A DULY LICENSED PROFESSIONAL ENGINEER UNDER THE LAWS OF THE STATE OF MARYLAND.
 LICENSE NO. 26286 EXPIRATION DATE: 06/21/21

MAP	ADC	GRID	5285
TAX MAP	Q002	ZONING CATEGORY:	CR-20 (C-10, R-10, R-20, R-30, R-40, R-50, R-60, R-70, R-80, R-90, R-100)
WBCS 200 SHEET			
SITE DATUM	215 NW 06		
HORIZONTAL:	NAD83		
VERTICAL:	NAD83		

PRELIMINARY PLAN - CENTRAL AND EAST SIDE

PRELIMINARY PLAN WILGUS TRACT # 120200140

POTOMAC (1ST) ELECTION DISTRICT, MONTGOMERY COUNTY, MARYLAND

PROJECT NO. 1205-02-01

SHEET 4 OF 10

The original of this drawing document was prepared by Soltesz, Inc. (SOLTESZ). This document was not obtained directly from SOLTESZ, Inc. SOLTESZ, Inc. cannot guarantee that unauthorized changes and/or alterations were not made by others. If verification of the information contained herein is needed, contact should be made directly with SOLTESZ, Inc. SOLTESZ makes no warranties, express or implied, concerning the accuracy of any information that has been transmitted by electronic means.