

PLANNING DEPARTMENT USE ONLY (E-PLANS)

SCALE 1" = 20'

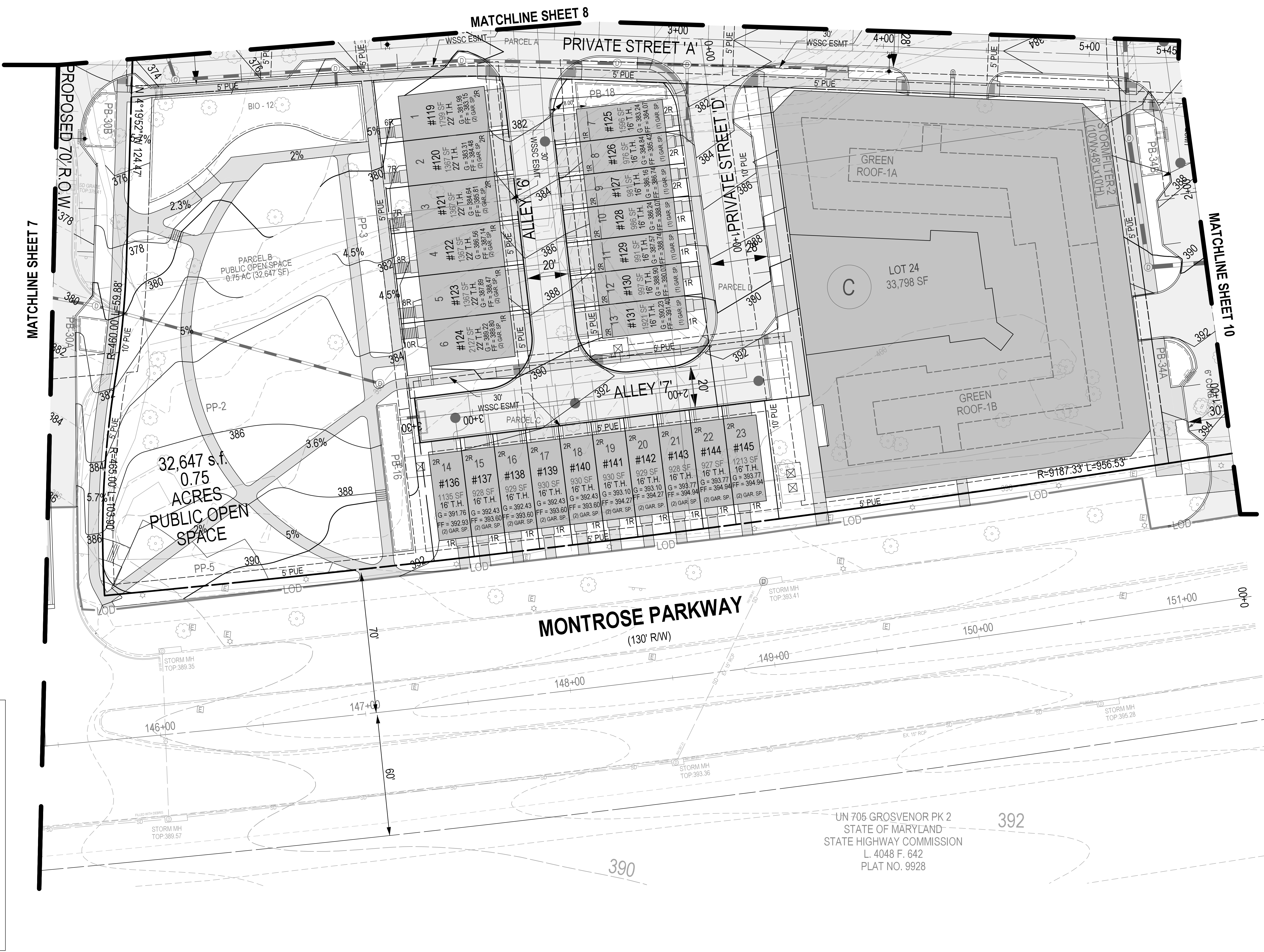

LEGEND:

	EXISTING GRADE
	PROPOSED GRADE
	EXISTING BUILDING
	PROPOSED BUILDING
	PROPOSED UNDERGROUND PARKING
	PROPOSED RIGHT OF WAY
	PROPOSED WATER LINE
	EXISTING 12" WATER LINE
	PROPOSED SEWER
	EXISTING SEWER
	PROPOSED PUE
	PROPOSED STORM PIPE
	EXISTING STORM PIPE
	WETLAND (TO BE REMOVED)

ENGINEER'S CERTIFICATE
 I HEREBY CERTIFY, TO THE BEST OF MY PROFESSIONAL KNOWLEDGE, INFORMATION AND BELIEF, THAT THE PLAN SHOWS HEREON CONFORMS WITH THE MONTGOMERY COUNTY SUBDIVISION REGULATIONS AS ADOPTED OCTOBER 1961 AND AS AMENDED THEREAFTER.
 SIGNATURE: BRANDON J. FRITZ, P.E. TITLE: PROJECT MANAGER
 MD. REG. NO. 26286

SOLTESZ, INC.
 ROCKVILLE OFFICE
 2 Research Place, Suite 100
 Rockville, MD 20850
 P. 301.948.2750 F. 301.948.9067
 www.soltesz.com

NO.	DATE	REVISIONS	BY	DATE
1	JANUARY 2020	CAO STANDARDS VERSION: 18 - NCS		
	DESIGNED: KDL	TECHNICIAN: NC	CHECKED: BJF	

MISS UTILITY NOTE
 INFORMATION CONCERNING EXISTING UNDERGROUND UTILITIES WAS OBTAINED FROM AVAILABLE RECORDS. THE CONTRACTOR MUST DETERMINE THE EXACT LOCATION AND ELEVATION OF ALL EXISTING UTILITIES AND UTILITIES ORIGINALLY BY ENGINE TEST FITS BY HAND, WELL IN ADVANCE OF THE START OF EXCAVATION. CONTACT "MISS UTILITY" AT 1-800-261-7777 48 HOURS PRIOR TO THE START OF EXCAVATION. IF CLEARANCES ARE LESS THAN SHOWN ON THE PLAN OR TWELVE (12) INCHES, WHICHEVER IS LESS, CONTACT THE ENGINEER AND THE UTILITY COMPANY BEFORE PROCEEDING WITH CONSTRUCTION. CLEARANCES LESS THAN NOTED MAY REQUIRE REVISIONS TO THIS PLAN.

OWNER/DEVELOPER/APPLICANT
 WILGUS/MONTROSE ASSOCIATES LLC
 7811 MONTROSE ROAD
 SUITE 200
 POTOMAC, MD 20854
 PHONE: (240) 396-1500
 ROCKENWILCO.COM
 RICHARD COHEN

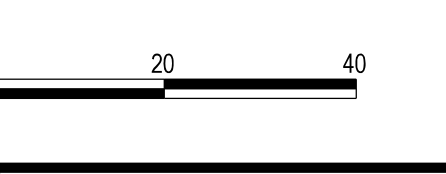

PROFESSIONAL CERTIFICATION
 I HEREBY CERTIFY THAT THESE DOCUMENTS WERE PREPARED OR APPROVED BY ME, AND THAT I AM A DULY LICENSED PROFESSIONAL ENGINEER UNDER THE LAWS OF THE STATE OF MARYLAND.
 LICENSE NO. 26286 EXPIRATION DATE: 06/21/21



PRELIMINARY PLAN

**PRELIMINARY PLAN
 WILGUS TRACT
 # 120200140**
 POTOMAC (1ST) ELECTION DISTRICT, MONTGOMERY COUNTY, MARYLAND

SHEET	9
OF	10
PROJECT NO.	120200140