

PLANNING DEPARTMENT USE ONLY (E-PLANS)

Tree Protection Fence Detail  
Not to scale

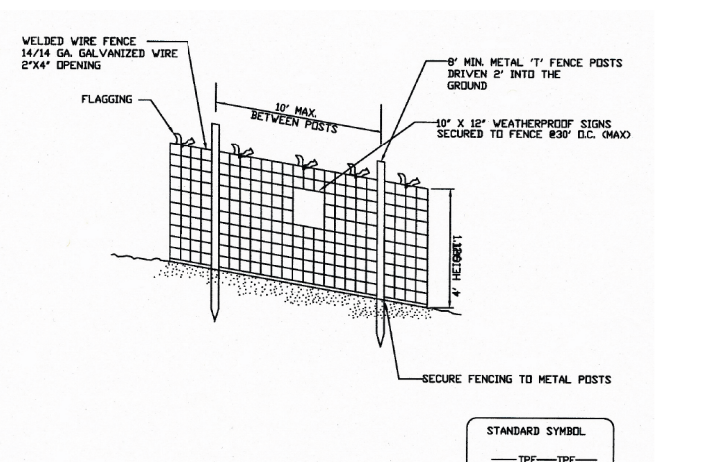

- NOTES
1. Practices may be combined with sediment control fencing.
  2. Location and limits of fencing should be coordinated in field with arborist.
  3. Conditions of protection areas should be staked prior to installing protective device.
  4. Root damage within the protection area should be avoided.
  5. Protection signage is required.
  6. Fencing shall be maintained throughout construction.

SPLIT RAIL FENCE DETAIL  
NOT TO SCALE

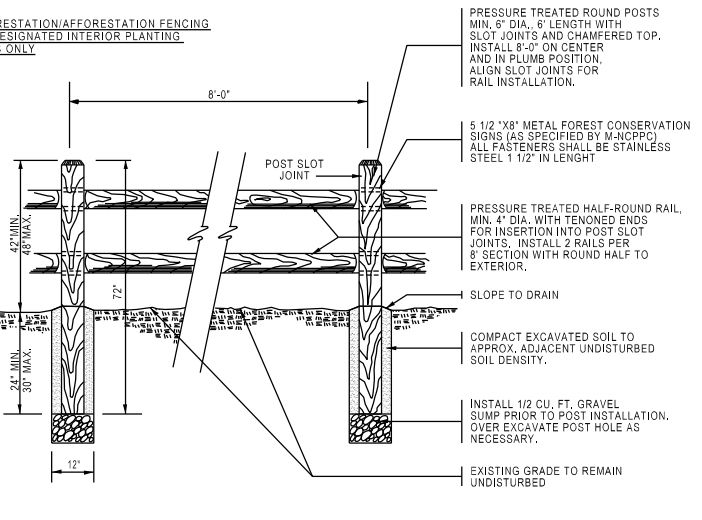

- NOTE:
1. FOREST PROTECTION FENCE SHALL BE INSTALLED PER THE REQUIREMENTS OF THE REVIEW PROCESS.
  2. BOUNDARIES OF RETENTION AREAS SHOULD BE STAKED AND NOTED.
  3. APPROVED TREE PROTECTION DEVICES SHALL BE USED.
  4. EXACT LOCATION OF FENCE SHALL BE DETERMINED IN THE FIELD IN COORDINATION WITH THE FOREST CONSERVATION INSPECTOR.
  5. PROTECTIVE SIGNAGE IS REQUIRED AT ALL SPACING ALONG ALL LOCATIONS THROUGHOUT CONSTRUCTION.
  6. SIGNAGE SHOULD BE INSTALLED PRIOR TO THE BEGINNING OF CONSTRUCTION AND MAINTAINED THROUGHOUT CONSTRUCTION.

FOREST CONSERVATION AREA  
DO NOT DISTURB  
UNDER PENALTY OF LAW  
NO DUMPING  
NO MOTORIZED VEHICLES

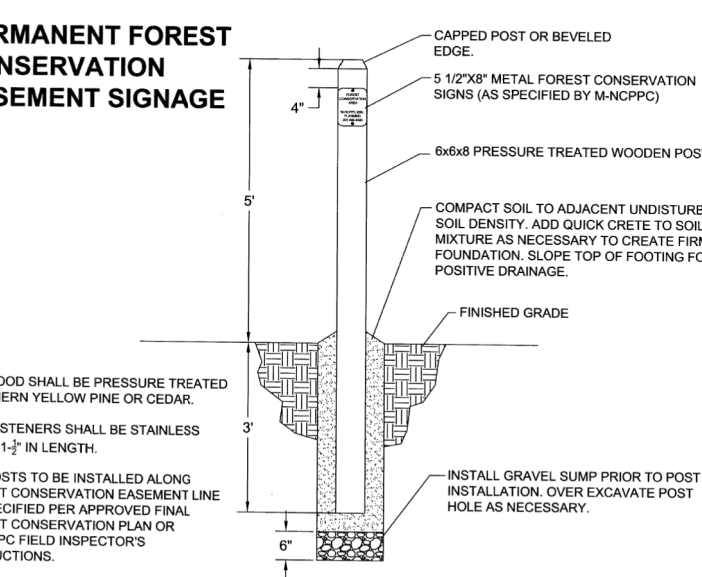

PERMANENT FOREST CONSERVATION SIGNAGE

- NOTE:
1. ALL WOOD SHALL BE PRESSURE TREATED.
  2. ALL METAL SHALL BE GALVANNEAL.
  3. ALL FASTENERS SHALL BE STAINLESS STEEL 316 FINISH.
  4. ALL POSTS TO BE INSTALLED ALONG PERMANENT FOREST CONSERVATION LINE.
  5. ALL POSTS TO BE INSTALLED PERMANENTLY.
  6. ALL POSTS TO BE INSTALLED PERMANENTLY.
  7. ALL POSTS TO BE INSTALLED PERMANENTLY.
  8. ALL POSTS TO BE INSTALLED PERMANENTLY.
  9. ALL POSTS TO BE INSTALLED PERMANENTLY.
  10. ALL POSTS TO BE INSTALLED PERMANENTLY.

SIGNIFICANT AND SPECIMEN TREE LIST									
Tree #	Common Name	Scientific Name	DBH (inch)	CRZ Area	CRZ Impacted	% Impacted	Cond.	Remove/Save	
17	Tulip Tree	Liriodendron tulipifera	24	4069	4069	100.0%	Fair	Remove	
18	Tulip Tree	Liriodendron tulipifera	25	4416	4416	100.0%	Poor	Remove	
19	Tulip Tree	Liriodendron tulipifera	25	4416	4416	100.0%	Poor	Remove	
21	Tulip Tree	Liriodendron tulipifera	28	5539	5539	100.0%	Poor	Remove	
25	Tulip Tree	Liriodendron tulipifera	28	5539	5539	100.0%	Fair	Remove	
32	Tulip Tree	Liriodendron tulipifera	28	5539	5539	100.0%	Poor	Remove	
38	Tulip Tree	Liriodendron tulipifera	24	4069	4069	100.0%	Fair	Remove	
39	Tulip Tree	Liriodendron tulipifera	28	5539	5539	100.0%	Fair	Remove	
40	Tulip Tree	Liriodendron tulipifera	26	4776	4776	100.0%	Poor	Remove	
42	Tulip Tree	Liriodendron tulipifera	26	4776	4776	100.0%	Fair	Remove	
44	Tulip Tree	Liriodendron tulipifera	24	4069	4069	100.0%	Fair	Remove	
46	Tulip Tree	Liriodendron tulipifera	28	5539	5539	100.0%	Fair	Remove	
47	Tulip Tree	Liriodendron tulipifera	28	5539	5539	100.0%	Fair	Remove	
48	Tulip Tree	Liriodendron tulipifera	28	5539	5539	100.0%	Fair	Remove	
49	Tulip Tree	Liriodendron tulipifera	24	4069	4069	100.0%	Fair	Remove	
52	Black Oak	Quercus velutina	26	4776	4776	100.0%	Fair	Remove	
59	Tulip Tree	Liriodendron tulipifera	26	4776	4776	100.0%	Fair	Remove	
60	Tulip Tree	Liriodendron tulipifera	28	5539	5539	100.0%	Fair	Remove	
63	Tulip Tree	Liriodendron tulipifera	26	4776	4776	100.0%	Poor	Remove	
64	Tulip Tree	Liriodendron tulipifera	28	5539	5539	100.0%	Fair	Remove	
65	Tulip Tree	Liriodendron tulipifera	26	4776	4776	100.0%	Fair	Remove	
68	Tulip Tree	Liriodendron tulipifera	28	5539	5539	100.0%	Fair	Remove	
69	Tulip Tree	Liriodendron tulipifera	26	4776	4776	100.0%	Poor	Remove	
74	Tulip Tree	Liriodendron tulipifera	24	4069	4069	100.0%	Poor	Remove	
81	Tulip Tree	Liriodendron tulipifera	28	5539	5539	100.0%	Fair	Remove	
95	Red Maple	Acer rubrum	28	5539	5539	100.0%	Poor	Remove	
100	Red Maple	Acer rubrum	28	5539	5539	100.0%	Poor	Remove	
110	Tulip Tree	Liriodendron tulipifera	24	4069	4069	100.0%	Poor	Remove	
122	Black Cherry	Prunus serotina	26	4776	4776	100.0%	Poor	Remove	
129	Red Maple	Acer rubrum	26	4776	4776	100.0%	Poor	Remove	
133	Black Locust	Robinia pseudoacacia	28	5539	5539	100.0%	Fair	Remove	
132	Black Locust	Robinia pseudoacacia	26	4776	4776	100.0%	Poor	Remove	
138	Tulip Tree	Liriodendron tulipifera	28	5539	5539	100.0%	Fair	Remove	
144	Silver Maple	Acer sachalinum	26	4776	4776	100.0%	Poor	Remove	
146	Black Locust	Robinia pseudoacacia	28	5539	5539	100.0%	Poor	Remove	
147	Black Locust	Robinia pseudoacacia	28	5539	5539	100.0%	Poor	Remove	
149	Eastern Cottonwood	Populus deltoides	26	4776	4776	100.0%	Fair	Remove	
150	Black Locust	Robinia pseudoacacia	28	5539	5539	100.0%	Poor	Remove	
151	Black Locust	Robinia pseudoacacia	26	4776	4776	100.0%	Poor	Remove	
152	Red Maple	Acer rubrum	28	5539	5539	100.0%	Poor	Remove	
153	Red Maple	Acer rubrum	28	5539	1785	32.2%	Fair	Remove	
1	Tulip Tree	Liriodendron tulipifera	38	10202	10202	100.0%	Good	Remove	
2	Tulip Tree	Liriodendron tulipifera	44	13678	13678	100.0%	Fair	Remove	
3	Tulip Tree	Liriodendron tulipifera	36	9156	9156	100.0%	Fair	Remove	
4	Tulip Tree	Liriodendron tulipifera	41	11876	11876	100.0%	Poor	Remove	
5	Tulip Tree	Liriodendron tulipifera	36	9156	9156	100.0%	Fair	Remove	
6	Tulip Tree	Liriodendron tulipifera	38	10202	10202	100.0%	Fair	Remove	
7	Tulip Tree	Liriodendron tulipifera	41	11876	11876	100.0%	Fair	Remove	
8	Tulip Tree	Liriodendron tulipifera	38	10202	10202	100.0%	Fair	Remove	
9	Tulip Tree	Liriodendron tulipifera	58	23977	23977	100.0%	Fair	Remove	
10	Tulip Tree	Liriodendron tulipifera	30	6359	6359	100.0%	Fair	Remove	
11	Tulip Tree	Liriodendron tulipifera	42	12463	12463	100.0%	Poor	Remove	
12	Tulip Tree	Liriodendron tulipifera	30	6359	6359	100.0%	Poor	Remove	
13	Tulip Tree	Liriodendron tulipifera	36	9156	9156	100.0%	Poor	Remove	
14	Tulip Tree	Liriodendron tulipifera	36	9156	9156	100.0%	Poor	Remove	
15	Tulip Tree	Liriodendron tulipifera	36	9156	9156	100.0%	Fair	Remove	
16	Tulip Tree	Liriodendron tulipifera	36	9156	9156	100.0%	Poor	Remove	
20	Tulip Tree	Liriodendron tulipifera	30	6359	6359	100.0%	Fair	Remove	
22	Tulip Tree	Liriodendron tulipifera	30	6359	6359	100.0%	Poor	Remove	
23	Tulip Tree	Liriodendron tulipifera	38	10202	10202	100.0%	Poor	Remove	
24	Tulip Tree	Liriodendron tulipifera	32	7235	7235	100.0%	Fair	Remove	
26	Tulip Tree	Liriodendron tulipifera	36	9156	9156	100.0%	Poor	Remove	
27	Tulip Tree	Liriodendron tulipifera	32	7235	7235	100.0%	Poor	Remove	
28	Tulip Tree	Liriodendron tulipifera	40	11304	11304	100.0%	Fair	Remove	
29	Tulip Tree	Liriodendron tulipifera	38	10202	10202	100.0%	Poor	Remove	
30	Tulip Tree	Liriodendron tulipifera	48	16278	16278	100.0%	Fair	Remove	
31	Tulip Tree	Liriodendron tulipifera	34	8167	8167	100.0%	Fair	Remove	
33	Tulip Tree	Liriodendron tulipifera	36	9156	9156	100.0%	Fair	Remove	
34	Tulip Tree	Liriodendron tulipifera	32	7235	7235	100.0%	Fair	Remove	
35	Tulip Tree	Liriodendron tulipifera	32	7235	7235	100.0%	Fair	Remove	
36	Tulip Tree	Liriodendron tulipifera	38	10202	10202	100.0%	Fair	Remove	
37	Tulip Tree	Liriodendron tulipifera	38	10202	10202	100.0%	Fair	Remove	
41	Tulip Tree	Liriodendron tulipifera	42	12463	12463	100.0%	Fair	Remove	
43	Tulip Tree	Liriodendron tulipifera	36	9156	9156	100.0%	Fair	Remove	
45	Tulip Tree	Liriodendron tulipifera	36	9156	9156	100.0%	Poor	Remove	
50	Tulip Tree	Liriodendron tulipifera	36	9156	9156	100.0%	Fair	Remove	
51	Tulip Tree	Liriodendron tulipifera	64	28938	28938	100.0%	Poor	Remove	
53	Hickory species	Carya spp.	30	6359	6359	100.0%	Fair	Remove	
54	Black Oak	Quercus velutina	34	8167	8167	100.0%	Fair	Remove	
55	Tulip Tree	Liriodendron tulipifera	42	12463	12463	100.0%	Fair	Remove	
56	White Oak	Quercus alba	38	10202	10202	100.0%	Fair	Remove	
57	Tulip Tree	Liriodendron tulipifera	32	7235	7235	100.0%	Fair	Remove	
58	Tulip Tree	Liriodendron tulipifera	30	6359	6359	100.0%	Fair	Remove	
61	Tulip Tree	Liriodendron tulipifera	34	8167	8167	100.0%	Poor	Remove	
62	Tulip Tree	Liriodendron tulipifera	38	10202	10202	100.0%	Fair	Remove	
66	Tulip Tree	Liriodendron tulipifera	36	9156	9156	100.0%	Fair	Remove	
67	Tulip Tree	Liriodendron tulipifera	36	9156	9156	100.0%	Fair	Remove	
70	Tulip Tree	Liriodendron tulipifera	38	10202	10202	100.0%	Poor	Remove	
71	Tulip Tree	Liriodendron tulipifera	38	10202	10202	100.0%	Fair	Remove	
72	Tulip Tree	Liriodendron tulipifera	36	9156	9156	100.0%	Poor	Remove	
75	Tulip Tree	Liriodendron tulipifera	38	10202	10202	100.0%	Poor	Remove	
76	Tulip Tree	Liriodendron tulipifera	48	16278	16278	100.0%	Poor	Remove	
77	Tulip Tree	Liriodendron tulipifera	38	10202	10202	100.0%	Poor	Remove	
78	Tulip Tree	Liriodendron tulipifera	34	8167	8167	100.0%	Poor	Remove	
79	Tulip Tree	Liriodendron tulipifera	32	7235	7235	100.0%	Poor	Remove	
80	Tulip Tree	Liriodendron tulipifera	30	6359	6359	100.0%	Poor	Remove	
82	Tulip Tree	Liriodendron tulipifera	46	14950	14950	100.0%	Fair	Remove	
83	Tulip Tree	Liriodendron tulipifera	48	16278	16278	100.0%	Fair	Remove	
84	Tulip Tree	Liriodendron tulipifera	45	14307	14307	100.0%	Fair	Remove	
85	Tulip Tree	Liriodendron tulipifera	36	9156	9156	100.0%	Fair	Remove	
86	Tulip Tree	Liriodendron tulipifera	48	16278	16278	100.0%	Fair	Remove	
87	Tulip Tree	Liriodendron tulipifera	36	9156	9156	100.0%	Fair	Remove	
88	Tulip Tree	Liriodendron tulipifera	48	16278	16278	100.0%	Fair	Remove	
89	Tulip Tree	Liriodendron tulipifera	52	19104	19104	100.0%	Fair	Remove	
90	Tulip Tree	Liriodendron tulipifera	56	22156	22156	100.0%	Fair	Remove	
91	Tulip Tree	Liriodendron tulipifera	60	25434	25434	100.0%	Fair	Remove	
92	Tulip Tree	Liriodendron tulipifera	60	25434	25434	100.0%	Poor	Remove	
93	Tulip Tree	Liriodendron tulipifera	40	11304	11304	100.0%	Fair	Remove	
94	Tulip Tree	Liriodendron tulipifera	38	10202	10202	100.0%	Fair	Remove	
96	Tulip Tree	Liriodendron tulipifera	42	12463	12463	100.0%	Fair	Remove	
97	Tulip Tree	Liriodendron tulipifera	48	16278	16278	100.0%	Fair	Remove	
98	Tulip Tree	Liriodendron tulipifera	46	14950	14950	100.0%	Fair	Remove	
99	Tulip Tree	Liriodendron tulipifera	52	19104	19104	100.0%	Fair	Remove	
100	Hickory species	Carya spp.	30	6359	6359	100.0%	Fair	Remove	
101	Black Oak	Quercus velutina	52	19104	19104	100.0%	Fair	Remove	
102	Tulip Tree	Liriodendron tulipifera	48	16278	16278	100.0%	Fair	Remove	
103	White Oak	Quercus alba	48	16278	16278	100.0%	Poor	Remove	
104	Tulip Tree	Liriodendron tulipifera	56	22156	22156	100.0%	Fair	Remove	
105	Tulip Tree	Liriodendron tulipifera	48	16278	16278	100.0%	Fair	Remove	
106	Tulip Tree	Liriodendron tulipifera	38	10202	10202	100.0%	Fair	Remove	
107	Tulip Tree	Liriodendron tulipifera	41	11876	11876	100.0%	Fair	Remove	
109	Tulip Tree	Liriodendron tulipifera	30	6359	6359	100.0%	Poor	Remove	
111	Tulip Tree	Liriodendron tulipifera	34	8167	8167	100.0%	Fair	Remove	
112	Tulip Tree	Liriodendron tulipifera	54	17562	17562	100.0%	Fair	Remove	
113	Red Maple	Acer rubrum	34	8167	8167	100.0%	Fair	Remove	
114	Tulip Tree	Liriodendron tulipifera	44	13678	13678	100.0%	Fair	Remove	
115	Tulip Tree	Liriodendron tulipifera	38	10202	10202	100.0%	Poor	Remove	
116	Tulip Tree	Liriodendron tulipifera	48	16278	16278	100.0			