

PLANNING DEPARTMENT USE ONLY (E-PLANS)

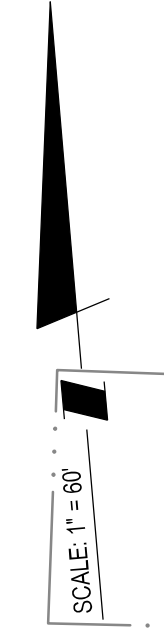
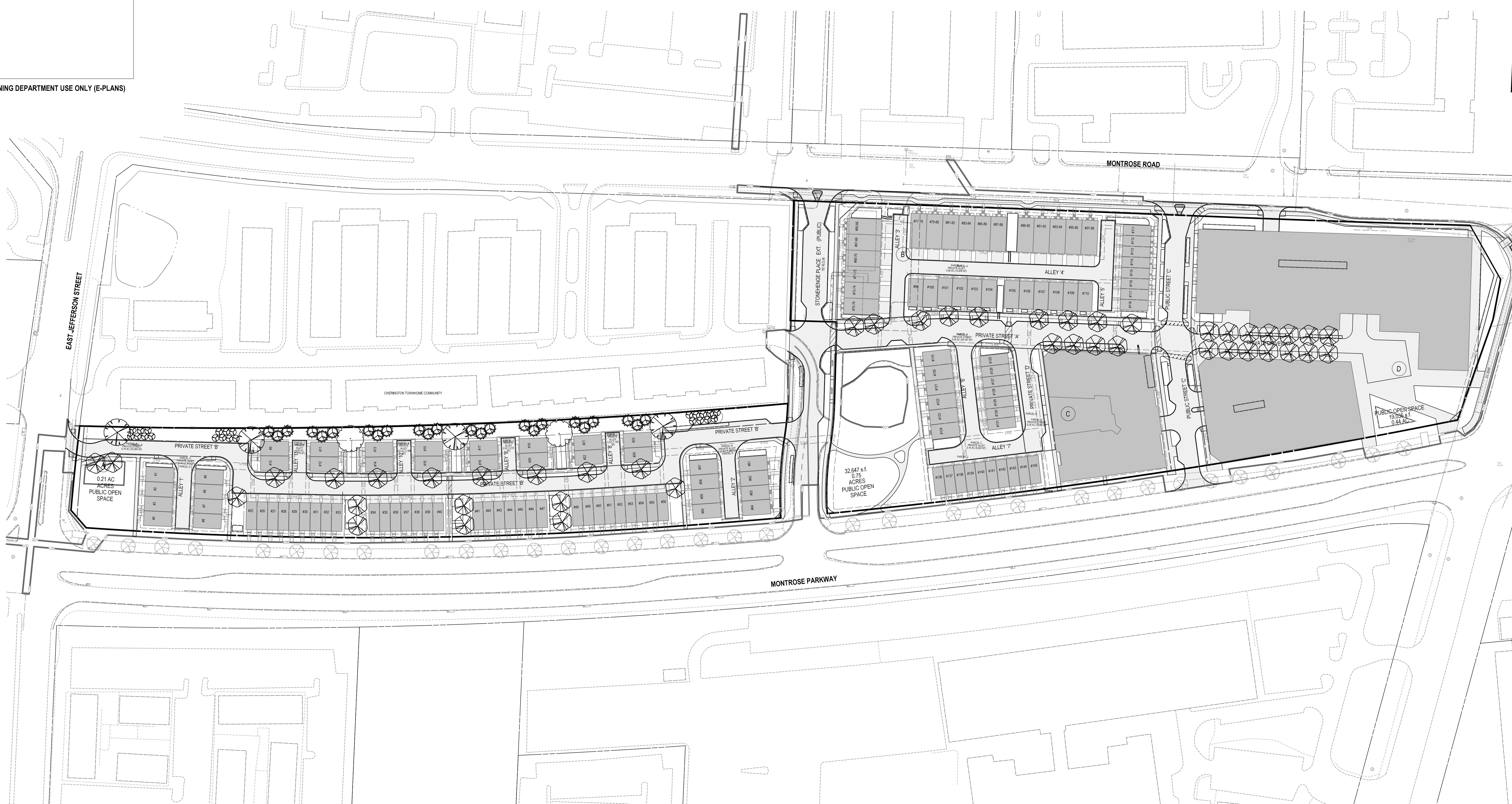

Symbol	Qty.	Location	Common Name	Botanical Name	CAL.	B&B /	Remarks
	24	On-site Buffer	Loblolly Pine	<i>Pinus taeda</i>	1-1 1/2" cal.	B&B	Full, Limb to 7' from ground
	2	On-site Buffer	Swamp White Oak	<i>Quercus bicolor</i>	4-4 1/2" cal.	B&B	Full, Limb to 7' from ground
	4	On-site Buffer	Willow Oak	<i>Quercus phellos</i>	4-4 1/2" cal.	B&B	Full, Limb to 7' from ground
	23	On-site Buffer	American Holly	<i>Ilex opaca</i>	1-1 1/2" cal.	B&B	Full, Limb to 7' from ground
	45	On-site	Native Species to be determined		4-4 1/2" cal.	B&B	Full, Limb to 7' from ground
N/A	405	Forest Bank	Remainder of mitigation requirement will be fulfilled with the purchase of a 4.05-acre forest bank, or the equivalent of (405) 2" caliper trees.				
	503	<b>Total Trees Planted (98 Onsite)</b>					
	1061"	<b>Total Cal. Replaced (251" Onsite)</b>					

**DEVELOPER'S CERTIFICATE**  
 The Undersigned agrees to execute all the features of the Approved Final Forest Conservation Plan No. \_\_\_\_\_, including financial bonding, forest planting, maintenance, and all other applicable agreements.  
 Developer's Name: WILGUS CONSTRUCTION CO., INC. ROBERT A. WAZZUCA  
 Company: CORPSE PERSON  
 Address: 7811 MONTROSE ROAD, POTOMAC, MD 20854  
 Phone: 301-369-1421  
 Signature: \_\_\_\_\_

**SOLTESZ, INC.**  
 Rockville Office  
 2 Research Place, Suite 100  
 Rockville, MD 20850  
 P. 301.948.2750 F. 301.948.9067  
 www.soltesz.com

NO.	DATE	DESIGNED	TECHNICIAN	BY	DATE
1	JANUARY 2020	KDL	JW		

**MISS UTILITY NOTE**  
 INFORMATION CONCERNING EXISTING UNDERGROUND UTILITIES WAS OBTAINED FROM AVAILABLE RECORDS. THE CONTRACTOR MUST DETERMINE THE EXACT LOCATION AND ELEVATION OF ALL EXISTING UTILITIES AND UTILITY CROSSINGS BY ENGINEERING TEST PITS BY HAND, WELL IN ADVANCE OF THE START OF EXCAVATION. CONTACT "MISS UTILITY" AT 1-800-261-7777 48 HOURS PRIOR TO THE START OF EXCAVATION. IF CLEARANCES ARE LESS THAN SHOWN ON THIS PLAN OR TWELVE (12) INCHES, WHICHEVER IS LESS, CONTACT THE ENGINEER AND THE UTILITY COMPANY BEFORE PROCEEDING WITH CONSTRUCTION. CLEARANCES LESS THAN NOTED MAY REQUIRE REVISIONS TO THIS PLAN.

**OWNER/DEVELOPER/APPLICANT**  
 WILGUS/MONTROSE ASSOCIATES, LLC  
 7811 MONTROSE ROAD  
 SUITE 200  
 POTOMAC, MD 20854  
 PHONE: (301) 369-1500  
 ROCKEN@WILGUS.CO  
 RICHARD COHEN

MAP	ADC	GRID	5285
TAX MAP	QC02	ZONING CATEGORY	CR-20, CL-10, RL-10, R-20, R-30, R-40, R-50, R-60, R-70, R-80, R-90, R-100, R-110, R-120, R-130, R-140, R-150, R-160, R-170, R-180, R-190, R-200, R-210, R-220, R-230, R-240, R-250, R-260, R-270, R-280, R-290, R-300, R-310, R-320, R-330, R-340, R-350, R-360, R-370, R-380, R-390, R-400, R-410, R-420, R-430, R-440, R-450, R-460, R-470, R-480, R-490, R-500, R-510, R-520, R-530, R-540, R-550, R-560, R-570, R-580, R-590, R-600, R-610, R-620, R-630, R-640, R-650, R-660, R-670, R-680, R-690, R-700, R-710, R-720, R-730, R-740, R-750, R-760, R-770, R-780, R-790, R-800, R-810, R-820, R-830, R-840, R-850, R-860, R-870, R-880, R-890, R-900, R-910, R-920, R-930, R-940, R-950, R-960, R-970, R-980, R-990, R-1000
WISC 200 SHEET			
215 NW 06			
SITE DATUM			
HORIZONTAL	NAD83		
VERTICAL	NAD83		

**MITIGATION TREE PLANTING PLAN**

**PRELIMINARY FOREST CONSERVATION PLAN**  
**WILGUS TRACT**  
**# 120200140**

POTOMAC (1ST) ELECTION DISTRICT, MONTGOMERY COUNTY, MARYLAND

SHEET **8**  
OF **8**  
PROJECT NO. 1202-02-01