

PLANNING DEPARTMENT USE ONLY (E-PLANS)

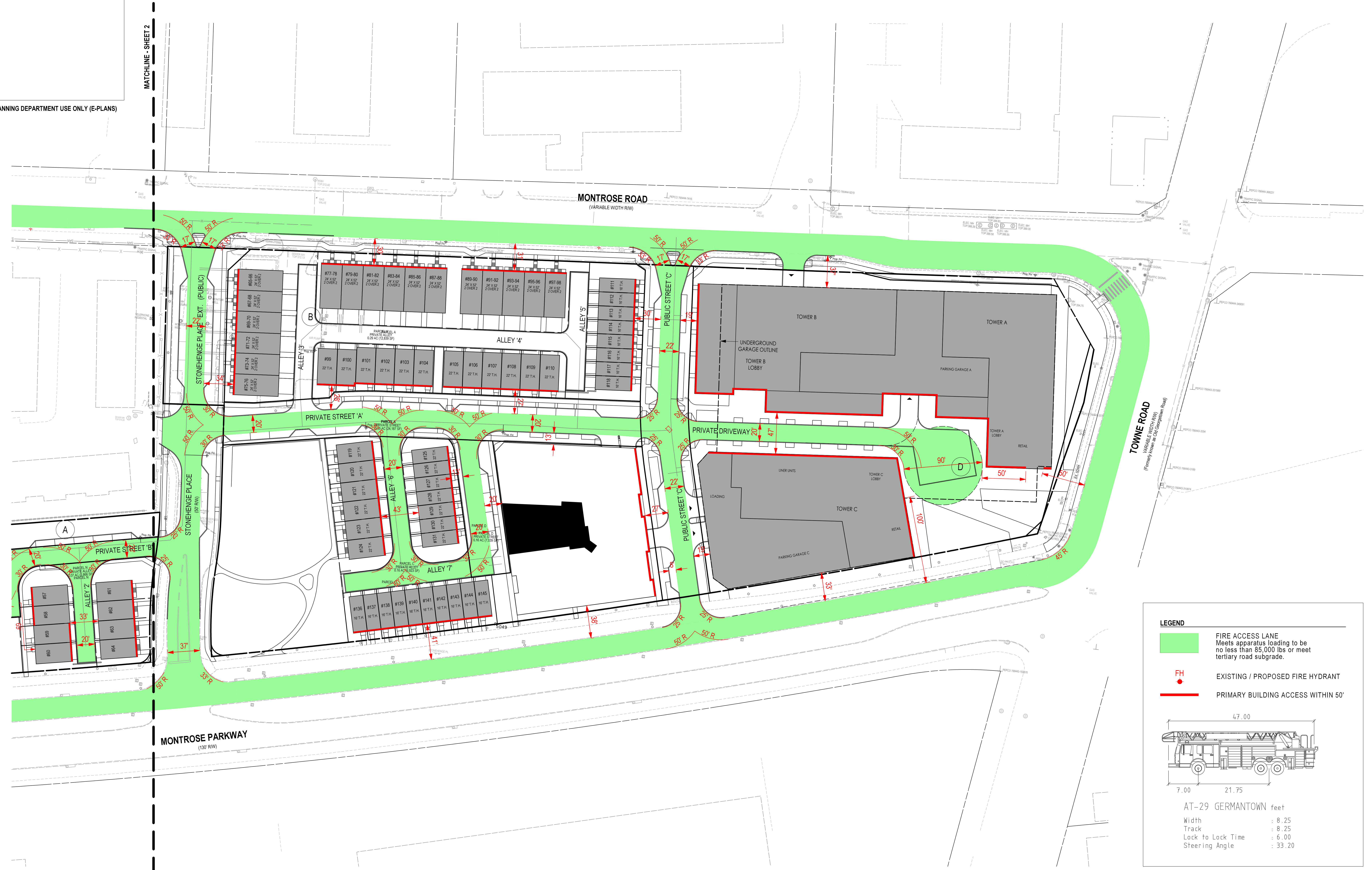

LEGEND

- FIRE ACCESS LANE
Meets apparatus loading to be no less than 85,000 lbs or meet tertiary road subgrade.
- EXISTING / PROPOSED FIRE HYDRANT
- PRIMARY BUILDING ACCESS WITHIN 50'

AT-29 GERMANTOWN feet

Width	: 8.25
Track	: 8.25
Lock to Lock Time	: 6.00
Steering Angle	: 33.20

ENGINEER'S CERTIFICATE
 I HEREBY CERTIFY, TO THE BEST OF MY PROFESSIONAL KNOWLEDGE, INFORMATION AND BELIEF, THAT THE PLAN SHOWN HEREON CONFORMS WITH THE MONTGOMERY COUNTY SUBDIVISION REGULATIONS AS ADOPTED OCTOBER 1961 AND AS AMENDED THEREAFTER.

SIGNATURE: _____ DATE: _____
 PRINTED NAME: BRANDON J. FRITZ, P.E. TITLE: PROJECT MANAGER
 MD. REG. NO. 26286

SOLTESZ, INC.
 Rockville Lanham Waldorf Leonardtown Frederick Soltesz DC, LLC

ROCKVILLE OFFICE
 2 Research Place, Suite 100
 Rockville, MD 20850
 P. 301.948.2750 F. 301.948.9067

www.soltesz.com

NO.	DATE	REVISIONS	BY	DATE
DESIGNED:	JANUARY 2020	CAO STANDARDS VERSION:	18 - NCS	
TECHNICIAN:	KDL	NC		
CHECKED:			BJF	

MISS UTILITY NOTE
 INFORMATION CONCERNING EXISTING UNDERGROUND UTILITIES WAS OBTAINED FROM AVAILABLE RECORDS. THE CONTRACTOR MUST DETERMINE THE EXACT LOCATION AND ELEVATION OF ALL EXISTING UTILITIES AND UTILITIES ORIGINATING BY ENGINE TEST PITS BY HAND, WELL IN ADVANCE OF THE START OF EXCAVATION. CONTACT "MISS UTILITY" AT 1-800-261-7777 48 HOURS PRIOR TO THE START OF EXCAVATION. IF CLEARANCES ARE LESS THAN SHOWN ON THE PLAN OR TWELVE (12) INCHES, WHICHEVER IS LESS, CONTACT THE ENGINEER AND THE UTILITY COMPANY BEFORE PROCEEDING WITH CONSTRUCTION. CLEARANCES LESS THAN NOTED MAY REQUIRE REVISIONS TO THIS PLAN.

OWNER/DEVELOPER/APPLICANT
 WILGUS/MONTROSE ASSOCIATES LLC
 7811 MONTROSE ROAD
 SUITE 200
 POTOMAC, MD 20854
 PHONE: (301) 396-1500
 ROCKING@WILGUS.COM
 RICHARD COHEN

MAP	ADC	GRID	5285
TAX MAP	GC02	ZONING CATEGORY	CR-20, CD-10, RD-10, RD-20, RD-30, RD-40, RD-50, RD-60, RD-70, RD-80, RD-90, RD-100
WBCS 200' SHEET		SITE DATUM	215 NW 06
HORIZONTAL:	NAD83	VERTICAL:	NAD83

PROFESSIONAL CERTIFICATION
 I HEREBY CERTIFY THAT THESE DOCUMENTS WERE PREPARED OR APPROVED BY ME, AND THAT I AM A DULY LICENSED PROFESSIONAL ENGINEER UNDER THE LAWS OF THE STATE OF MARYLAND.
 LICENSE NO. 26286 EXPIRATION DATE: 06/21/21

FIRE DEPARTMENT ACCESS PLAN

**PRELIMINARY PLAN
 WILGUS TRACT
 # 120200140**

POTOMAC (1ST) ELECTION DISTRICT, MONTGOMERY COUNTY, MARYLAND

PROJECT NO. 1205-02-01

SHEET 3 OF 3

The original of this drawing document was prepared by Soltesz, Inc. (SOLTESZ). This document was not obtained directly from SOLTESZ, Inc. and is being transmitted electronically. SOLTESZ cannot guarantee that unauthorized changes and/or alterations were not made by others. If verification of the information contained herein is needed, contact should be made directly with SOLTESZ. SOLTESZ makes no warranties, express or implied, concerning the accuracy of any information that has been transmitted by electronic means.