

PLANNING BOARD HEARING

On **July 23, 2020**, the Montgomery County Planning Board will conduct a virtual public hearing at 8787 Georgia Avenue, Silver Spring, Maryland on the following development plan:

Name of Plan: Wilgus

Preliminary Plan Number: 120200140

Zoning: CR-2.0; C-1.0; R-1.5; H-200; CR-2.0; C-0.25; R-1.75; H-75 and CRN-0.75; C-0.0; R-0.75; H-50

Site Area: 16.64 acres

Sector Plan: 2018 White Flint 2 Sector Plan area.

Proposed Use: Request for subdivision of 5 platted parcels for a proposed mixed-use project with 1,025,789 square feet of residential uses (107 lots for townhouse units, 2 lots for multi-family units, and 2 lots for two-over-two units), and 15,000 square feet of commercial uses on 1 lot; additional parcels for private streets, open space, and stormwater management; located at the northwest quadrant of the intersection of Montrose Parkway and Towne Road.

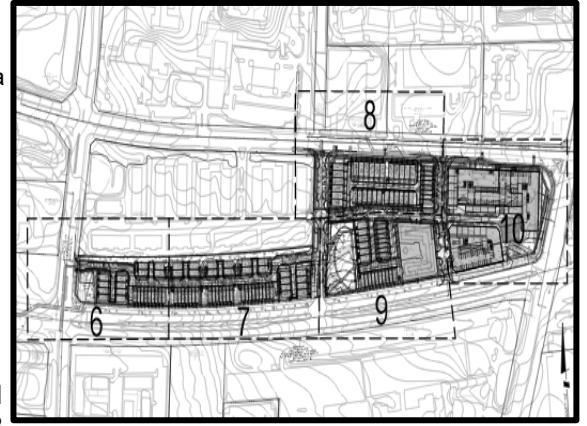

To review a written report by planners regarding the development plan, check the approximate hearing time, or to sign up to testify, go to our website at montgomeryplanningboard.org/agendas/. You may also sign up to testify by calling 301.495.4605. The public can still participate in the Planning Board hearing online at www.montgomeryplanningboard.org while our building is closed, and our daily work operations are still in effect.

For more information or to comment on the development plans, please contact Tamika Graham; the Preliminary Plan reviewer, via email at Tamika.Graham@montgomeryplanning.org, or by phone at 301.495.4551.

Thank you for your interest in Montgomery County's future development.

The Maryland-National Capital Park and Planning Commission encourages the participation of individuals with disabilities in its programs and facilities. For support in using facilities, staff support or adaptive equipment, contact the Planning Department ADA Coordinator. Provide requests one week in advance of event: Christine.McGrew@montgomeryplanning.org | (301) 495-1324 | 301-495-1331 (TTY) | 7-1-1 or 800-552-7724 (MD Relay)

Montgomery County Planning Department
M-NCPCC
8787 Georgia Avenue
Silver Spring, Maryland 20910

Montgomery County Planning Board HEARING NOTICE

Wilgus
JULY 23, 2020

(view additional information on the back of this card)

Written comments should include the agenda item and must be received by 12 noon on Wednesday morning before a scheduled Thursday hearing. They may be emailed to Montgomery County Planning Board Chair Casey Anderson at mcp-chair@mncppc-mc.org; mailed to Chair Casey Anderson, Montgomery County Planning Board, 8787 Georgia Avenue, Silver Spring, MD 20910; or faxed to (301) 495-1320.

Written comments received after the deadline may not be considered by the Planning Board or be included in the public record unless the Chair leaves the record open.

Wilgus Associates Limited Partnership
c/o Willco Construction Co. Inc.
7811 Montrose Road Suite 200
Suite 500
Potomac, MD 20854-3300

Property Management Company for the
Executive Commercial Condominium
3414 Morningwood Drive
Olney, MD 20832

Kaiser Foundation Health Plan
of Mid-Atlantic States
P.O. Box 6095
Rockville, MD 20849-6095

Hebrew Home of Greater
Washington, Inc.
6121 Montrose Road
Rockville, MD 20852

Monterey North Bethesda Investors LLC
c/o Robert Weiner
395 W. Passaic Street Suite 251
Suite 251
Rochelle Park, NJ 7662

Richard S. Cohen, et al., Tr.
for Washington Science Joint Venture
7811 Montrose Road Suite 500
Suite 500
Potomac, MD 20854

Resident
6015 Executive Boulevard Unit 4
Unit 4
Rockville, MD 20850

Hui Liu and Bai Yawen
11900 Grey Hollow Court Unit 87
Unit 87
N. Bethesda, MD 20852

Adam Marc Stern
Dawn Elyse Stern
11903 Grey Hollow Court Unit 75
Unit 75
N. Bethesda, MD 20852-5805

Ramiro X. Paez
11701 Winterset Terrace
Potomac, MD 20854

Property Management Company for the
Hebrew Home of Greater Washington
6121 Montrose Road
Rockville, MD 20852

Property Management Company for the
Cherington Condominium
7811 Montrose Road, #110
Potomac, MD 20854

United States Postal Service
10400 Little Patuxent Parkway #400
#400
Columbia, MD 21044-3527

Verizon Maryland Merge Co.
P. O. Box 152206
Irving, TX 75015-2206

State of Maryland
State Road Commission
707 N. Calvert Street
Baltimore, MD 21202

Resident
6001 Executive Boulevard Unit 1
Unit 1
Rockville, MD 20850

Federal Realty Investment Trust
c/o Altus Group-500-1485
P.O. Box 92129
Southlake, TX 76092

Joshua Prober
Denise Katz-Prober
11901 Grey Hollow Court Unit 74
Unit 74
N. Bethesda, MD 20852-3553

Justin Katz
Alexandra J. Katz
11904 Grey Hollow Court Unit 85
Unit 85
Rockville, MD 20852

Resident
11905 Grey Hollow Court Unit 76
Unit 76
N. Bethesda, MD 20852-5805

Property Management Company for the
Monterey Apartments
c/o Panco Management
395 W. Passaic Street, #251
Rochelle Park, NJ 7662

Kaiser Foundation Health Plan
of Mid-Atlantic States
P.O. Box 6095
Rockville, MD 20849-6095

Greater Washington Jewish
Community Foundation
6125 Montrose Road
Rockville, MD 20852-4856

A & A Montrose Road LLC
8200 Greensboro Drive Suite 1440
Suite 1440
McLean, VA 22102

State of Maryland
Tawes State Office Building
Annapolis, MD 21401

Richard S. Cohen, et al., Tr.
for Washington Science Joint Venture
7811 Montrose Road Suite 500
Suite 500
Potomac, MD 20854

Resident
11806 Rockville Pike
Rockville, MD 20852

Brian A. Coblitz
Lauren M. Coblitz
11902 Grey Hollow Court Unit 86
Unit 86
N. Bethesda, MD 20852

Resident
11904 Grey Hollow Court Unit 84
Unit 84
Potomac, MD 20854

Stephen Andrew Katrivanos
Elaine Blyskun Katrivanos
11907 Grey Hollow Court Unit 77
Unit 77
Rockville, MD 20852

David Tannenbaum
Qun Xu
11906 Grey Hollow Court Unit 84
Unit 84
N. Bethesda, MD 20852-5805

Richard W. Strom
6001 Berkshire Drive
Bethesda, MD 20814-2251

Mark C. Miller
11912 Grey Hollow Court Unit 81
Unit 81
N. Bethesda, MD 20852

James D. Katz and
Amy Fried
6002 Stonehenge Place Unit 35
Unit 35
N. Bethesda, MD 20852-4897

Resident
6006 Stonehenge Place Unit 33
Unit 33
N. Bethesda, MD 20852

Jeffrey S. Gemunder
Anne Marie Gemunder
6012 Stonehenge Place Unit 30
Unit 30
N. Bethesda, MD 20852-4897

Resident
6018 Stonehenge Place Unit 28
Unit 28
Rockville, MD 20852-4897

Azarell Ram
Tsipora Tsipi Ram
6024 Stonehenge Place Unit 25
Unit 25
N. Bethesda, MD 20852-5800

Jerome M. and Karen Kirchberg
6030 Stonehenge Place Unit 21
Unit 21
Rockville, MD 20852-5800

Cyrus Pardis
Mollie Agahi
6102 Stonehenge Place Unit 19
Unit 19
N. Bethesda, MD 20852-5803

Eric D. Zatz
Rebecca L. Zatz
11908 Grey Hollow Court Unit 83
Unit 83
N. Bethesda, MD 20852-5805

Resident
11910 Grey Hollow Court Unit 82
Unit 82
N. Bethesda, MD 20852-5805

Ronen Scheflan
Karen Scheflan
11913 Grey Hollow Court Unit 80
Unit 80
N. Bethesda, MD 20852-5805

Kevork G. Ghazarian, et al., Tr.
6004 Stonehenge Place Unit 34
Unit 34
N. Bethesda, MD 20852-4897

Sarit Schwartz
Uri Schwartz
6008 Stonehenge Place Unit 32
Unit 32
N. Bethesda, MD 20852-4897

Arthur Rulnick, et al.
6014 Stonehenge Place Unit 29
Unit 29
N. Bethesda, MD 20852-4897

Tessa Victoria Capeloto
Andre Neumann Kauffman
6020 Stonehenge Place Unit 27
Unit 27
Rockville, MD 20852-4897

Victor M. Galitski
Kristina Galitski
6026 Stonehenge Place Unit 24
Unit 24
N. Bethesda, MD 20852-5800

Jay S. and Alison R. Mershon
6032 Stonehenge Place Unit 21
Unit 21
N. Bethesda, MD 20852-5800

Lucia and Jozef Plachy
6104 Stonehenge Place Unit 18
Unit 18
Rockville, MD 20852-5803

David Galbraith
11909 Grey Hollow Court Unit 78
Unit 78
N. Bethesda, MD 20852

Anand Krishnamurthy
Vasuki Palanigobu
11911 Grey Hollow Court Unit 79
Unit 79
Rockville, MD 20854

Steven A. Loewy
6000 Stonehenge Place Unit 36
Unit 36
N. Bethesda, MD 20852-4897

Jay J. and W. J. Lee
202 Long Trail Terrace
Rockville, MD 20850

Raul Garcia
Elena Garcia
6010 Stonehenge Place Unit 31
Unit 31
Rockville, MD 20852-4897

Kimani Clark
1830 Jefferson Place, NW Apt 4
Apt. 4
Washington, DC 20036

Mariyam Zhumadil
Zhanibek Zhumadil
6022 Stonehenge Place Unit 26
Unit 26
N. Bethesda, MD 20852-5800

Harold David Allick, et al.
6028 Stonehenge Place Unit 23
Unit 23
Rockville, MD 20852-5800

Rutzu Lin
6100 Stonehenge Place Unit 20
Unit 20
Rockville, MD 20852-5803

Lorelei A. and S. Z. Kowalski
6106 Stonehenge Place Unit 17
Unit 17
N. Bethesda, MD 20852

Sheldon P. and R. J. Needle
6108 Stonehenge Place Unit 16
Unit 16
N. Bethesda, MD 20852

Ian A. Cameron
Laurence de Suremain
6114 Stonehenge Place Unit 13
Unit 13
N. Bethesda, MD 20852

Debra M. Linowes
6122 Stonehenge Place Unit 10
Unit 10
N. Bethesda, MD 20852-3553

David Ta-Wei Poo, et al.
10118 Crestberry Place
Bethesda, MD 20817

Resident
6131 Stonehenge Place Unit 14-11
Unit 14-11
N. Bethesda, MD 20852

Ngoc D. Tran Rev. Trust
200 Caledonia Drive
Martinsburg, WV 25405

Jeffrey M. and R. H. Alexander
6136 Stonehenge Place Unit 4
Unit 4
N. Bethesda, MD 20852-5806

Elena Torbenko
William D. Sanders
14711 Bauer Drive
Rockville, MD 20852

Resident
6139 Stonehenge Place Unit 14-3
Unit 14-3
Rockville, MD 20854

Resident
6141 Stonehenge Place Unit 14-9
Unit 14-9
Rockville, MD 20854

Leslie R. Cohen Revocable Trust
6110 Stonehenge Place Unit 15
Unit 15
N. Bethesda, MD 20852-5803

Stephen P. Wathen
Ekaterina Wathen
6118 Stonehenge Place Unit 12
Unit 12
N. Bethesda, MD 20852-5803

Joseph Wang
Sun Ling Wang
6124 Stonehenge Place Unit 9
Unit 9
N. Bethesda, MD 20852-3553

Resident
6130 Stonehenge Place Unit 7
Unit 7
N. Bethesda, MD 20852-5806

Son Nguyen and Trang Cam
6132 Stonehenge Place Unit 6
Unit 6
Rockville, MD 20852-5806

Resident
6134 Stonehenge Place Unit 5
Unit 5
N. Bethesda, MD 20852

Montgomery Homes Limited
Partnership X
10400 Detrick Avenue
Kensington, MD 20895-2440

Resident
6138 Stonehenge Place Unit 3
Unit 3
Rockville, MD 20852-5806

Diane K. Swenson
6140 Stonehenge Place Unit 2
Unit 2
Rockville, MD 20852-5807

Loc T. and T. N. Duong
6142 Stonehenge Place Unit 1
Unit 1
N. Bethesda, MD 20852-5807

Li-Chun Dai and
Liu Sheng-Chi
6112 Stonehenge Place Unit 14
Unit 14
N. Bethesda, MD 20852-5803

Claude J. Suissa, a/k/a
Joseph Claude Suissa
6120 Stonehenge Place Unit 11
Unit 11
Rockville, MD 20852

Moti Kachlon
Yulit Yospe Kachlon
6126 Stonehenge Place Unit 8
Unit 8
N. Bethesda, MD 20852-5806

Housing Unlimited, Inc.
12125 Veirs Mill Road #201
#201
Silver Spring, MD 20906-3435

Inessa Shusterman
6133 Stonehenge Place Unit 14-5
Unit 14-5
N. Bethesda, MD 20852-5801

Heather A. Kenney
6135 Stonehenge Place Unit 14-6
Unit 14-6
Rockville, MD 20852-5801

Resident
6137 Stonehenge Place Unit 14-4
Unit 14-4
Rockville, MD 20854

Montgomery Homes Limited
Partnership X
10400 Detrick Avenue
Kensington, MD 20895-2440

Montgomery Homes Limited
Partnership X
10400 Detrick Avenue
Kensington, MD 20895-2440

Darlene C. Johnson
6143 Stonehenge Place Unit 14-7
Unit 14-7
N. Bethesda, MD 20852

Dilip Desai
6145 Stonehenge Place Unit 14-2
Unit 14-2
N. Bethesda, MD 20852-5801

Housing Unlimited, Inc.
12125 Veirs Mill Road #201
#201
Silver Spring, MD 20906-3435

Ali Abasi and
Nahal Akbari-Saneh
11900 Bristol Manor Court Unit 73
Unit 73
N. Bethesda, MD 20852-5804

Jennifer Weiner
11903 Bristol Manor Court Unit 62
Unit 62
Rockville, MD 20854

Joshua D. Gluck
Jennifer A. Kopp
11906 Bristol Manor Court Unit 70
Unit 70
N. Bethesda, MD 20852-5804

Patrick W. Baranowsky
11909 Bristol Manor Court Unit 65
Unit 65
N. Bethesda, MD 20852-5802

Joel E. Lubin
11912 Bristol Manor Court Unit 67
Unit 67
N. Bethesda, MD 20852-5802

Resident
11902 Kings Bridge Way Unit 59
Unit 59
N. Bethesda, MD 20852-4870

Fei Han
11908 Kings Bridge Way Unit 56
Unit 56
N. Bethesda, MD 20852-4870

Jeffrey Peter Bui
11903 Kings Bridge Way Unit 50
Unit 50
N. Bethesda, MD 20852

Amir Eshaghi and
Niloofar Rezvani
6147 Stonehenge Place Unit 14-1
Unit 14-1
Rockville, MD 20852-5801

Resident
6151 Stonehenge Place Unit 14-10
Unit 14-10
Rockville, MD 20854

Christina Widodo
11901 Bristol Manor Court Unit 61
Unit 61
N. Bethesda, MD 20852

John H. and G. S. Staples
11904 Bristol Manor Court Unit 71
Unit 71
N. Bethesda, MD 20852

Roger N. Simon
Tracy E. Simon
11907 Bristol Manor Court Unit 64
Unit 64
N. Bethesda, MD 20852-3553

Jessica L. Oh and Edward H. Oh
11910 Bristol Manor Court Unit 68
Unit 68
Rockville, MD 20852-5804

Victoria Y. Pillitteri
Nicholas J. Pillitteri
11900 Kings Bridge Way Unit 60
Unit 60
N. Bethesda, MD 20852-4870

Ayotunde O. Williams
11904 Kings Bridge Way Unit 58
Unit 58
N. Bethesda, MD 20852-4870

Daniel Chow
Cindy Xin Li Chow
11910 Kings Bridge Way Unit 55
Unit 55
N. Bethesda, MD 20852-4870

Scott Ormiston
Milica Ormiston
11905 Kings Bridge Way Unit 51
Unit 51
Rockville, MD 20852-4863

Denis Belik
6149 Stonehenge Place Unit 14-8
Unit 14-8
N. Bethesda, MD 20852-5801

Ming Zhu, et al.
6153 Stonehenge Place Unit 14-12
Unit 14-12
N. Bethesda, MD 20852-3553

Raphael and Galia Ron
11902 Bristol Manor Court Unit 72
Unit 72
N. Bethesda, MD 20852-5804

Paul R. and Lauren Thomas
11905 Bristol Manor Court Unit 63
Unit 63
N. Bethesda, MD 20852-5802

Anupama Khare
Amit Kokate
11908 Bristol Manor Court Unit 69
Unit 69
N. Bethesda, MD 20852-5804

Esiri R. and C. Karunaratne
11911 Bristol Manor Court Unit 66
Unit 66
N. Bethesda, MD 20852-3553

Oscar Harasic
Vesna Harasic
9901 Hall Road
Potomac, MD 20854

Misha V. Belkindas and
Leonora Karasina
11906 Kings Bridge Way Unit 57
Unit 57
N. Bethesda, MD 20852-4870

Aleksandr V. Stekolshchikov
Anna V. Stekolshchikova
11901 Kings Bridge Way Unit 49
Unit 49
N. Bethesda, MD 20852-4863

Reginald P. Mitchell, Jr.
11907 Kings Bridge Way Unit 52
Unit 52
N. Bethesda, MD 20852

Hammad Qureshi
11909 Kings Bridge Way Unit 53
Unit 53
Rockville, MD 20852-4863

Stanton and S. C. Joseph
11911 Kings Bridge Way Unit 54
Unit 54
N. Bethesda, MD 20852-4863

Valora Kolker
11900 Castlegate Court Unit 48
Unit 48
N. Bethesda, MD 20852-4896

Leopold Sedogo
Alimata Gamene Sedogo
11901 Castlegate Court Unit 37
Unit 37
N. Bethesda, MD 20852-4895

Jason Liverette
11902 Castlegate Court Unit 47
Unit 47
Rockville, MD 20852-4896

Kristin H. Koo-Kim
11903 Castlegate Court Unit 38
Unit 38
N. Bethesda, MD 20852-4895

Avihu Hiram
Yael Hiram
11904 Castlegate Court Unit 46
Unit 46
Rockville, MD 20852-4896

Jimmy Su
Juiching Chen
11905 Castlegate Court Unit 39
Unit 39
N. Bethesda, MD 20852-4895

Dana Klein
1500 First Street, NW
Washington, DC 20001

Resident
11906 Castlegate Court Unit 45
Unit 45
Rockville, MD 20852-4896

Mia E. Harbitz
11907 Castlegate Court Unit 40
Unit 40
N. Bethesda, MD 20852-4895

Vincent B. Ho
11908 Castlegate Court Unit 44
Unit 44
N. Bethesda, MD 20852-4896

Hwa Y. Kim
11909 Castlegate Court Unit 41
Unit 41
N. Bethesda, MD 20852-4895

Nadya V. Elis
11910 Castlegate Court Unit 43
Unit 43
N. Bethesda, MD 20852

Margaret N. Godwin-Opara
11911 Castlegate Court Unit 42
Unit 42
Rockville, MD 20852-4895

Bethesda-Chevy Chase CC
Ginanne Italiano, Exec. Director
7910 Woodmont Avenue #1204
#1204
Bethesda, MD 20814

Cherington Condominium
c/o Glen Loveland, Abaris Realty, Inc.
12009 Nebel Street
Rockville, MD 20852

City of Rockville
Rob DiSpirito, City Manager
111 Maryland Avenue
Rockville, MD 20850

City of Rockville
Bridget Donnell Newton, Mayor
111 Maryland Avenue
Rockville, MD 20850

City of Rockville
Cordero Hjarman, Sr. Neigh. Res. Coord.
111 Maryland Avenue
Rockville, MD 20850

City of Rockville
Doug Barber, Clerk
111 Maryland Avenue
Rockville, MD 20850

East County Citizens Advisory Board
3300 Briggs Chaney Road
Silver Spring, MD 20904

Forum Council of Co-Owners
c/o Gary Digges
11801 Rockville Pike
Rockville, MD 20852

Greater Farmland Civic Association
Edward Rich, Co-President
11703 Hitching Post Lane
North Bethesda, MD 20852

Greater Farmland Civic Association
Eliot Applestein, Co-President
6807 Breezewood Terrace
North Bethesda, MD 20852

Luxmanor Citizens Association
Abbe Milstein, Trustee
11704 Ibsen Drive
Rockville, MD 20852

Luxmanor Citizens Association
Sharon Plotnick, President
6316 Cameo Court
Rockville, MD 20852

Luxmanor Citizens Association
Sheri Steisel Weiss, Vice Pres.
11326 Cushman Road
Rockville, MD 20852

Midtown Bethesda North Condominium
Catherine Windfield Jones, V.P.
5750 Bou Avenue Unit 1911
Unit 1911
N. Bethesda, MD 20852.00

Midtown Bethesda North Condominium
Robert Brunelle, General Mgr.
5750 Bou Avenue
N. Bethesda, MD 20852

Midtown Bethesda North Condominium
Ruth Tanker, Secretary
5750 Bou Avenue
N. Bethesda, MD 20852

Midtown Bethesda North Condominium
Sue Levine, Treasurer
5750 Bou Avenue
N. Bethesda, MD 20852

Midtown Bethesda North Condominium
Teresa Taylor, President
5750 Bou Avenue Unit 1115
Unit 1115
N. Bethesda, MD 20852

Montgomery County Civic Federation
Bailey Condrey, President
10205 Parkwood Drive
Kensington, MD 20895

Montgomery County Renters Alliance Inc.
Hermoine Freeman, Chair

Montgomery County Renters Alliance Inc.
Matthew Losak, Director
1001 Spring Street #316
#316
Silver Spring, MD 20910

Montgomery County Taxpayers League
Joan Fidler, President
7400 Pyle Road
Bethesda, MD 20817

Montgomery Preservation, Inc.
Judith Christensen, Director
6 Walker Avenue
Gaithersburg, MD 20877

Montrose Civic Association
Susan Zemsky, Co-President
1622 Martha Terrace
Rockville, MD 20852

Montrose Civic Association
Marilyn Powell, Co-President
1715 Wilmart Street
Rockville, MD 20852

Montrose Forest Homeowners Assn.
20440 Century Boulevard Suite 100
Suite 100
Germantown, MD 20874

Montrose Woods Condo., Inc.
Shireen Ambush, Abaris Realty, Inc.
12009 Nebel Street
Rockville, MD 20852

Northern Montgomery County Alliance
Julius Cinque, Chair
22300 Slidell Road
Boysd, MD 20841

Old Georgetown Village Homeowners
Beatrice Chester, Vice President
11200 Empire Lane
N. Bethesda, MD 20852

Randolph Civic Association
Brian Hooker, President
5003 Macon Road
North Bethesda, MD 20852

Randolph Civic Association
Chad Salganik, Pres. Emeritus
P.O. Box 2202
Rockville, MD 20852

Randolph Civic Association
Kevin Kline, Exec. Secretary
4808 Randolph Road
North Bethesda, MD 20852

Randolph Hills Civic Association
Board Member
4602 Wilwyn Way
Rockville, MD 20852

Rockville Chamber of Commerce
Andrea Jolly
One Research Court Suite 450
Suite 450
Rockville, MD 20850

Sierra Club - Montgomery County Group
Jennifer Rossmere, Treasurer
P.O. Box 4024
Rockville, MD 20849

Strathmore Avenue Pedestrian Bike
Traffic Safety Coalition
5113 Strathmore Avenue
5113 Strathmore Avenue
N. Bethesda, MD 20895

Strathmore Avenue Pedestrian Bike
Traffic Safety Coalition
10901 Orleans Way
10901 Orleans Way
N. Bethesda, MD 20895

Strathmore Avenue Pedestrian Bike
Traffic Safety Coalition
4922 Strathmore Avenue
4922 Strathmore Avenue
N. Bethesda, MD 20852

Strathmore Avenue Pedestrian Bike
Traffic Safety Coalition
5201 Strathmore Avenue
5201 Strathmore Avenue
N. Bethesda, MD 20895

Tildenwood Homeowners Assn., Inc.
Abaris Realty, Inc.
12009 Nebel Street
12009 Nebel Street
Rockville, MD 20852

Washington Metropolitan Area Transit
Authority
Shyam Kannan, Ofc. of Planning
600 Fifth Street, NW
Washington, DC 20001

White Flint Station Condominiums
Michael Darzi, President, Bd. of Dir.
P.O. Box 2308
11800 Old Georgetown Road
Rockville, MD 20847

Wisconsin Condo. Homeowners
Association
Paul Meyer, President
5809 Nicholson Lane #116
#116

Luxmanor Elementary School
5701 Grosvenor Lane
Bethesda, MD 20814

Tilden Middle School
11211 Old Georgetown Road
Rockville, MD 20852

Walter Johnson High School
6400 Rock Spring Drive
Bethesda, MD 20814

Twinbrook Library
202 Meadow Hall Drive
Rockville, MD 20851

Christopher Lee
6006 Stonehenge Place
N. Bethesda, MD 20852

Bob Eisenberg
6004 Winnebago Road
Bethesda, MD 20816

Michael Kirchberg
6030 Stonehenge Place Unit 21
Unit 21
Rockville, MD 20852

Jasmine Whims
1007 Mercer Place
Frederick, MD 21701

Ed Van Coutren
6121 Montrose Road
Rockville, MD 20852

Adrienne Rulnick
6014 Stonehenge Place
Rockville, MD 20852

Keely Lauretti
Soltesz
2 Research Place Suite 100
Suite 100
Rockville, MD 20850

Brandon Fritz
Soltesz
2 Research Place Suite 100
Suite 100
Rockville, MD 20850

Aileen Alex
6028 Stonehenge Place
Rockville, MD 20852

E. Paul Huang
5607 Whitney Mill Way
N. Bethesda, MD 20852

Diane Swenson
6140 Stonehenge Place
Rockville, MD 20852

Lori Kowalski
6106 Stonehenge Place
N. Bethesda, MD 20852

Chip Veise
6173 Executive Boulevard
Rockville, MD 20852

Tam Duong
6142 Stonehenge Place
N. Bethesda, MD 20852

Zena Skarzynski
5809 Nicholson Lane #25
#25
N. Bethesda, MD 20852

Aileen Allick
6028 Stonehenge Place
Rockville, MD 20852

Dave Allick
6028 Stonehenge Place
Rockville, MD 20852

Maryland-National Capital Park and
Planning Commission
Intake Section, D.A.R.C.
8787 Georgia Avenue
Silver Spring, MD 20910

Willco Construction Company, Inc.
Bob Mazzuca
7811 Montrose Road Suite 200
Suite 200
Potomac, MD 20854

Willco Construction Company, Inc.
Richard Cohen
7811 Montrose Road Suite 200
Suite 200
Potomac, MD 20854

Soltesz
Phil Isaja
2 Research Place Suite 100
Suite 100
Rockville, MD 20850

Linowes and Blocher LLP
Barbara A. Sears
7200 Wisconsin Avenue Suite 800
Suite 800
Bethesda, MD 20814

120200140

