

PLANNING DEPARTMENT USE ONLY (E-PLANS)

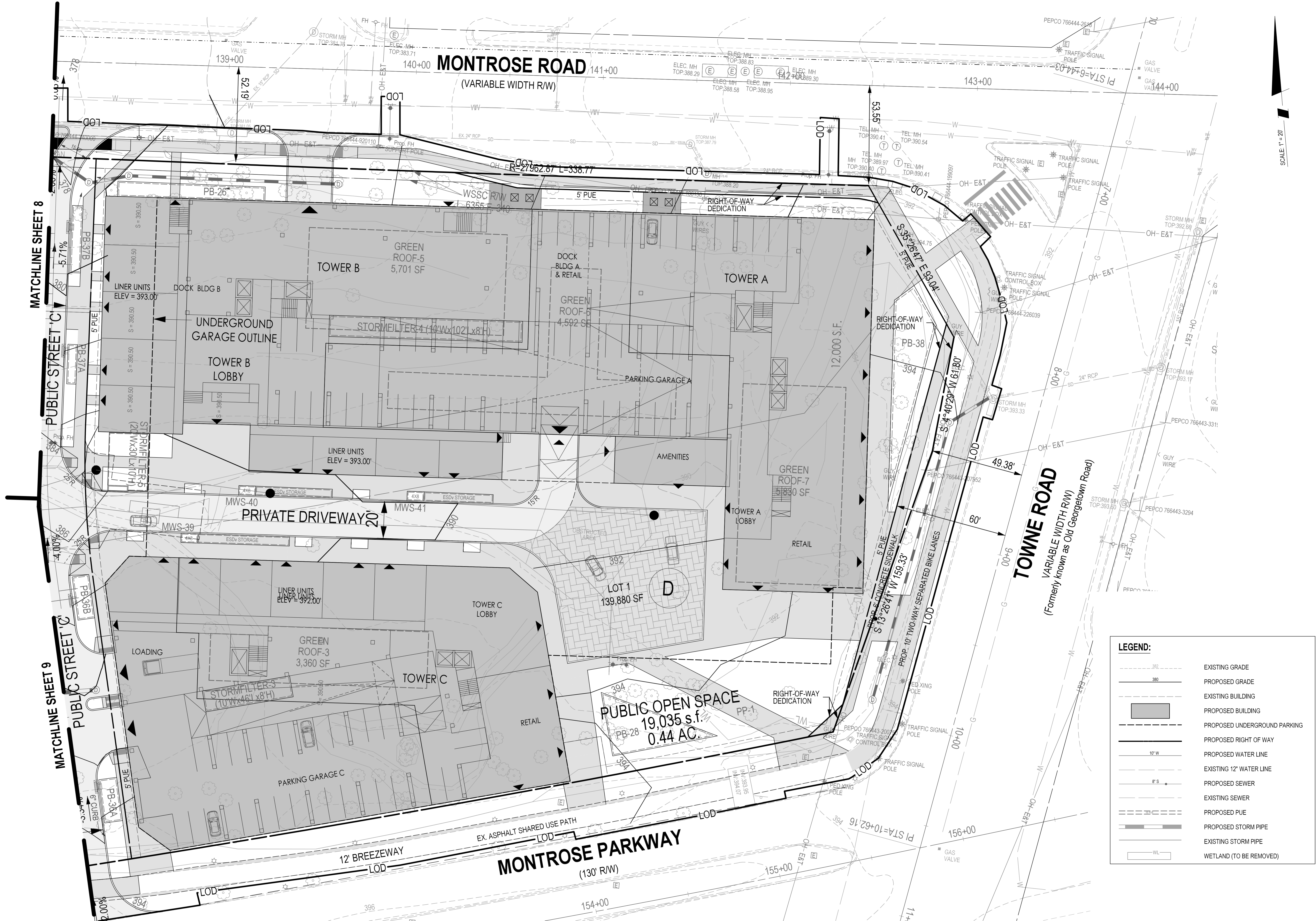

LEGEND:

	EXISTING GRADE
	PROPOSED GRADE
	EXISTING BUILDING
	PROPOSED BUILDING
	PROPOSED UNDERGROUND PARKING
	PROPOSED RIGHT OF WAY
	PROPOSED WATER LINE
	EXISTING 12" WATER LINE
	PROPOSED SEWER
	EXISTING SEWER
	PROPOSED PUE
	PROPOSED STORM PIPE
	EXISTING STORM PIPE
	WETLAND (TO BE REMOVED)

ENGINEER'S CERTIFICATE

I HEREBY CERTIFY, TO THE BEST OF MY PROFESSIONAL KNOWLEDGE, INFORMATION AND BELIEF, THAT THE PLAN SHOWS HEREON CONFORMS WITH THE MONTGOMERY COUNTY SUBDIVISION REGULATIONS AS ADOPTED OCTOBER 1961 AND AS AMENDED THEREAFTER.

SIGNATURE: _____ DATE: _____
 PRINTED NAME: TIMOTHY J. STEMANN TITLE: PROJECT MANAGER
 MD. REG. NO. 30287

PROFESSIONAL CERTIFICATION

I HEREBY CERTIFY THAT THESE DOCUMENTS WERE PREPARED OR APPROVED BY ME, AND THAT I AM A DULY LICENSED PROFESSIONAL ENGINEER UNDER THE LAWS OF THE STATE OF MARYLAND.

LICENSE NO. 30287 EXPIRATION DATE: 05/18/2022

PRELIMINARY PLAN

CERTIFIED PRELIMINARY PLAN
WILGUS TRACT
 # 120200140

ROCKVILLE (4TH) ELECTION DISTRICT, MONTGOMERY COUNTY, MARYLAND

SOLTESZ, INC.

Rockville Office
 2 Research Place, Suite 100
 Rockville, MD 20850
 P. 301.948.2750 F. 301.948.9067

www.soltesz.com

NO.	DESCRIPTION	DATE	BY
1	PRELIMINARY PLAN RESOLUTION APPROVED	10/15/2020	JCW
DESIGNED:	KDL	TECHNICIAN:	JCW
DATE:	MARCH 2021	CAD STANDARDS VERSION:	V8 - R15
CHECKED:	TJS		

MISS UTILITY NOTE

INFORMATION CONCERNING EXISTING UNDERGROUND UTILITIES WAS OBTAINED FROM AVAILABLE RECORDS. THE CONTRACTOR MUST DETERMINE THE EXACT LOCATION AND ELEVATION OF ALL EXISTING UTILITIES AND UTILITY ORIGINATOR'S RECORDS. TEST FITS BY HAND, WELL IN ADVANCE OF THE START OF EXCAVATION. CONTACT MISS UTILITY AT 1-800-261-7777 48 HOURS PRIOR TO THE START OF EXCAVATION. IF CLEARANCES ARE LESS THAN SHOWN ON THE PLAN OR TWELVE (12) INCHES, WHOEVERS LESS, CONTACT THE ENGINEER AND THE UTILITY COMPANY BEFORE PROCEEDING WITH CONSTRUCTION. CLEARANCES LESS THAN NOTED MAY REQUIRE REVISIONS TO THIS PLAN.

OWNER/DEVELOPER/APPLICANT

WILGUS/MONTROSE ASSOCIATES LLC
 7811 MONTROSE ROAD
 SUITE 200
 POTOMAC, MD 20854
 PHONE: (240) 396-1500
 ROCKINGWILLCO.COM
 RICHARD COHEN

MAP	ADC	GRID	5285
TAX MAP	GC02		
WBCS 200 SHEET			
SITE DATUM	215 NW 06		
HORIZONTAL:	NAD83		
VERTICAL:	NAD83		



SHEET	10
OF	17
PROJECT NO.	1205-02-01