

# PLANNING BOARD HEARING

On **July 30, 2020**, the Montgomery County Planning Board will conduct a virtual public hearing at 8787 Georgia Avenue, Silver Spring, Maryland on the following development plan:

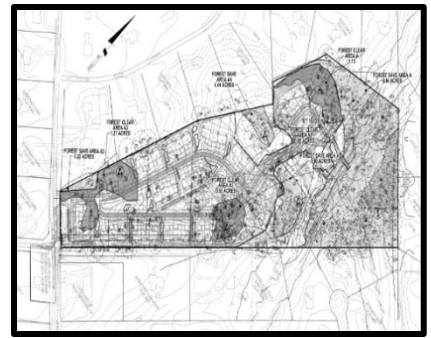

**Name of Plan: Spectrum Retirement Communities**  
**Preliminary Forest Conservation Plan Number: CU202005**  
**Conditional Use Plan Number: CU202005**  
**Zoning: RE-2 zone      Site Area: 5.93 acres**

**Master Plan: 2002 Potomac Subregion Master Plan**

**Proposed Use:** A. Preliminary Forest Conservation Plan CU-20-05 for Conditional Use to operate a 100-unit, 130 Residential Care Facility for (over 16 Persons) including an 18 memory care wing, on a 5.93 -acre property located at 9545 River Road on the north side of the Road, 0.5 mile east of its intersection with Falls Road in Potomac, MD.

**Staff Recommendation: Approval with conditions (Planning Board Action)**

B. Request for a Conditional Use to operate a 100-unit, 130 bed Residential Care Facility for (over 16 Persons) including an 18-unit memory care section, on a 5.93 -acre property located at 9545 River Road on the north side of the Road, 0.5 mile east of its intersection with Falls Road in Potomac, MD.

**Staff Recommendation: Approval with conditions (Planning Board recommendation)**

To review a written report by planners regarding the development plan, check the approximate hearing time, or to sign up to testify, go to our website at [montgomeryplanningboard.org/agendas/](http://montgomeryplanningboard.org/agendas/). You may also sign up to testify by calling 301.495.4605. The public can still participate in the Planning Board hearing online at [www.montgomeryplanningboard.org](http://www.montgomeryplanningboard.org) while our building is closed, and our daily work operations are still in effect.

You may also sign up to testify by calling 301.495.4605 or by filling out a written form on the day of the hearing.

For more information or to comment on the development plans, please contact Elsabett Tesfaye at [Elsabett.Tesfaye@montgomeryplanning.org](mailto:Elsabett.Tesfaye@montgomeryplanning.org), and for the Preliminary Forest Conservation Plan please contact Josh Penn, via email at [Joshua.penn@montgomeryplanning.org](mailto:Joshua.penn@montgomeryplanning.org) or by phone at 301.495.4546.

**Thank you for your interest in Montgomery County's future development.**

The Maryland-National Capital Park and Planning Commission encourages the participation of individuals with disabilities in its programs and facilities. For support in using facilities, staff support or adaptive equipment, contact the Planning Department ADA Coordinator. Provide requests one week in advance of event: [Christine.McGrew@montgomeryplanning.org](mailto:Christine.McGrew@montgomeryplanning.org) | (301) 495-1324 | 301-495-1331 (TTY) | 7-1-1 or 800-552-7724 (MD Relay)

Montgomery County Planning Department  
M-NCPPC  
8787 Georgia Avenue  
Silver Spring, Maryland 20910

## Montgomery County Planning Board HEARING NOTICE

### Spectrum Retirement Communities JULY 30, 2020

(view additional information on the back of this card)

Written comments should include the agenda item and must be received by 12 noon on Wednesday morning before a scheduled Thursday hearing. They may be emailed to Montgomery County Planning Board Chair Casey Anderson at [mcp-chair@mncppc-mc.org](mailto:mcp-chair@mncppc-mc.org); mailed to Chair Casey Anderson, Montgomery County Planning Board, 8787 Georgia Avenue, Silver Spring, MD 20910; or faxed to (301) 495-1320.

Written comments received after the deadline may not be considered by the Planning Board or be included in the public record unless the Chair leaves the record open.

HARALD R LEUBA NANCY KINGSBURY  
9555 PERSIMMON TREE RD  
POTOMAC, MD 20854

JOHN KAMYA  
9621 RIVER RD  
POTOMAC, MD 20854

RANDI LU SIDGMORE TR  
9505 PERSIMMON TREE RD  
POTOMAC, MD 20854

TAK 2010 GRAT ONE TRUST TAK 2010  
GRAT TWO TRUST  
9550 RIVER RD  
POTOMAC, MD 20854

MAQSOOD H & R R MIR  
PO BOX 60409  
POTOMAC, MD 20852

MARK C ELLENBERG & NANCY S  
ABRAMOWITZ  
9600 SOTWEED DR  
POTOMAC, MD 20854

JUN H & E H AN  
9812 BENTCROSS DR  
POTOMAC, MD 20854

LEROY S HOWARD & DEANNE L AYERS-  
HOWARD  
9531 RIVER RD  
POTOMAC, MD 20854

SHI B & L.C. YAO  
9904 BENTCROSS DR  
POTOMAC, MD 20854

ARTHUR J WASSERMAN REV TR GAIL  
MARIE FOLENA-WASSERMAN RVTR  
9900 BENTCROSS DR  
POTOMAC, MD 20854

Steven A. Robins Lerch, Early & Brewer,  
Chtd.  
7600 Wisconsin Avenue, Suite 700  
Bethesda, MD 20814

Elizabeth C. Rogers Lerch, Early &  
Brewer, Chtd.  
7600 Wisconsin Avenue, Suite 700  
Bethesda, MD 20814

West Montgomery County Citizens  
Assn. c/o Susanne Lee, President  
10311 Glen Road  
Potomac, MD 20854

Avenel Community Assn. c/o Lucy  
Wilson, General Manager  
9501 Beman Woods Way  
Potomac, MD 20854

Avenel Community Assn. c/o Marvin  
Burt, President  
5 Willow Gate Court  
Bethesda, MD 20817

Brickyard Coalition Inc. c/o Curtis Uhre,  
President  
9513 Brickyard Road  
Potomac, MD 20854

Brickyard Coalition Inc. c/o Ted Duncan  
7800 Buckboard Court  
Potomac, MD 20854

East County Citizens Advisory Board  
3300 Briggs Chaney Road  
Silver Spring, MD 20904

Montgomery County Civic Federation  
c/o Bailey Condrey, President  
10205 Parkwood Drive  
Kensington, MD 20895

Montgomery County Renters Alliance  
Inc. c/o Matthew Losak , Director  
1001 Spring Street #316  
Silver Spring, MD 20910

Montgomery County Taxpayers League  
c/o Joan Fidler, President  
7400 Pyle Road  
Bethesda, MD 20817

Montgomery Preservation, Inc. c/o  
Judith Christensen, Director  
6 Walker Avenue  
Gaithersburg, MD 20877

Newbridge Citizens Assn. c/o Barbara  
Phillips, President  
9811 Sorrel Ave.  
Potomac, MD 20854

Northern Montgomery County Alliance  
c/o Julius Cinque, Chair  
22300 Slidell Road  
Boysds, MD 20841

Potomac Chamber of Commerce Attn:  
President  
P O Box 59160  
Potomac, MD 20859

Sierra Club - Montgomery County  
Group Attn: Jennifer Rossmere,  
Treasurer  
P O Box 4024  
Rockville, MD 20849

Washington Metro Area Transit  
Authority Attn: S. Kannan, Mgng Dir  
Offc of Plan.  
600 Fifth Street NW  
Washington, DC 20001  
Cu202005

