

**VICINITY MAP**  
 SCALE: 1" = 2,000'  
 WSSC GRID: 208NW04  
 TAX MAP GRID: HN-341

- LEGEND**
- EX. BUILDING
  - PROP. BUILDING
  - EX. CURB
  - PROP. CURB
  - EX. SIDEWALK
  - PROP. SIDEWALK
  - EX. SEWER
  - PROP. SEWER
  - EX. WATER
  - PROP. WATER
  - EX. STORM DRAIN
  - PROP. STORM DRAIN
  - PROP. FIRE ACCESS ROUTE
  - MAIN ENTRANCE DOOR
  - PROP. FIRE HYDRANT
  - PROP. TURNING RADIUS
  - PROP. CURB RADIUS
  - PROP. FIRE ACCESS PAVEMENT WIDTH (CURB TO CURB)

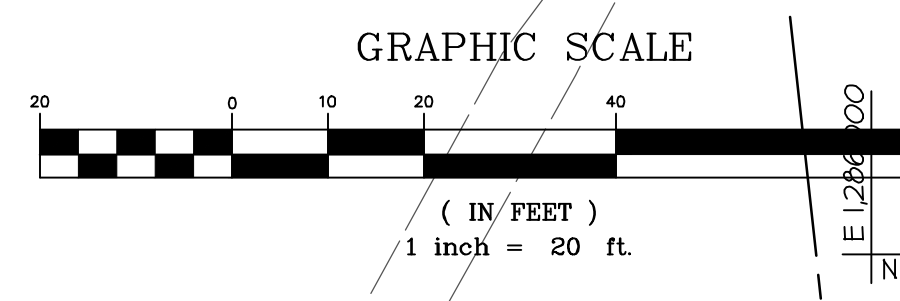

**PROFESSIONAL CERTIFICATION**  
 I hereby certify that to the best of my knowledge, information and the belief that the plan shown hereon is true and correct; has been prepared in accordance with the Subdivision Regulations of Montgomery County, Maryland, and the boundary has been field surveyed. I hereby certify that these plans were prepared or approved by me, and that I am a duly licensed Professional Engineer under the laws of the State of Maryland.

License No.: 29414  
 Expiration Date: January 20, 2022  
 8/12/2020  
 Date

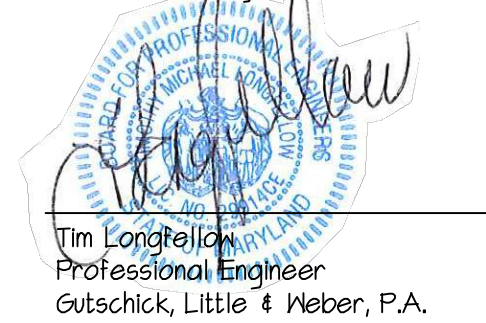

**GLW**  
 PLANNING | ENGINEERING | SURVEYING  
 3909 NATIONAL DRIVE | SUITE 250 | BURTONSVILLE, MD 20886 | GLWPA.COM  
 PHONE: 301-421-4024 | BALT: 410-880-1820 | DC&VA: 301-989-2524 | FAX: 301-421-4186

DESIGNED BY	DATE	REVISION	BY	APP'R.
WDN				
DRAWN BY				
WDN				
CHECKED BY				
TML				

PREPARED FOR:  
 WINTHROP INVESTMENT GROUP  
 PO BOX 1134  
 MCLEAN, VA. 22101  
 ATTN: HANS SCHMIDT  
 TEL: (703) 356-7975

SCALE  
 1" = 20'  
 DATE  
 AUG., 2020

ZONING  
 CR-1.5, C-0.25,  
 R-1.5, H-70  
 TAX MAP - GRID  
 HN-341

**FIRE ACCESS PLAN**  
**4702 CHEVY CHASE DRIVE**  
**PART OF LOTS 3 & 4, "BRADLEY HILLS"**  
**L. 45795 F. 214**

G. L. W. FILE No.  
 19123  
 SHEET  
 1 OF 1

BETHESDA ELECTION DISTRICT No. 07 MONTGOMERY COUNTY, MARYLAND

L:\CADD\DRAWINGS\19123\PLANS BY GLW\PRELIM PLANS\EXHIBITS\19123 Fire Access Plan.dwg, PLOTTED: 8/12/2020, 1:36 PM, LAST SAVED: 8/11/2020, 2:45 PM, PLOTTED BY: WIL D. NEWMAN

© GLW 2020