

PLANNING DEPARTMENT USE ONLY (E-PLANS)

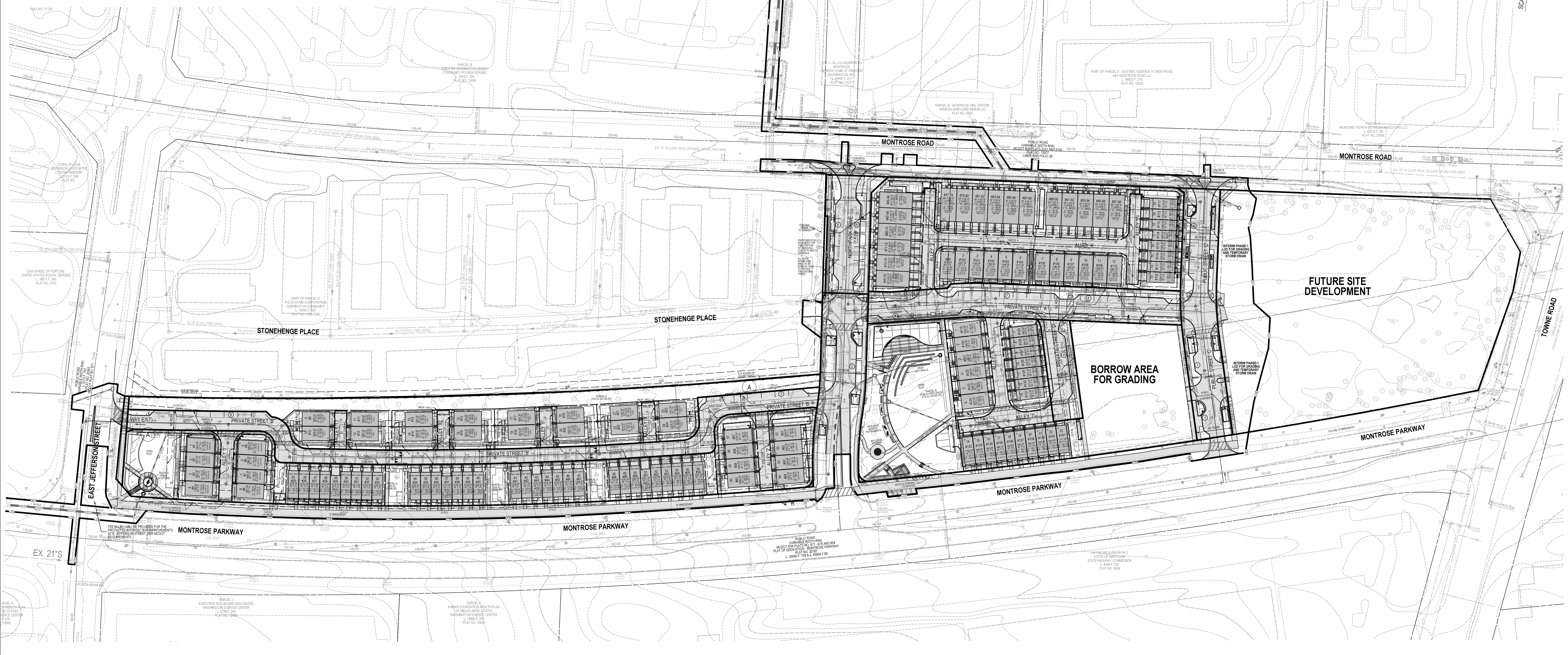

SCALE 1" = 60'

LEGEND:

| | |
|--|------------------------------|
| | EXISTING GRADE |
| | PROPOSED GRADE |
| | EXISTING BUILDING |
| | PROPOSED BUILDING |
| | PROPOSED UNDERGROUND PARKING |
| | PROPOSED RIGHT OF WAY |
| | PROPOSED WATER LINE |
| | EXISTING 12" WATER LINE |
| | PROPOSED SEWER |
| | EXISTING SEWER |
| | PROPOSED PUE |
| | PROPOSED STORM PIPE |
| | EXISTING STORM PIPE |
| | WETLAND (TO BE REMOVED) |

DEVELOPER'S CERTIFICATE
 The undersigned agrees to execute all the features of the Site Plan Approval No. 820210080, including Approval Conditions, Development Program, and Certified Site Plan.
 Developer's Name: WILGUS-MONTROSE ASSOCIATES LLC
 Company: RICHARD COHEN
 Address: 7811 MONTROSE ROAD, SUITE 200, POTOMAC, MD 20854
 Phone: (240) 399-1500
 Signature: _____



PROFESSIONAL CERTIFICATION
 I HEREBY CERTIFY THAT THESE DOCUMENTS WERE PREPARED OR APPROVED BY ME, AND THAT I AM A DULY LICENSED PROFESSIONAL ENGINEER UNDER THE LAWS OF THE STATE OF MARYLAND.
 LICENSE NO. 30287 EXPIRATION DATE: 05/18/2022



OVERALL PLAN VIEW

SITE PLAN 820210080
NORTH PARK AT MONTROSE
(FORMERLY WILGUS TRACT)

ROCKVILLE (4TH) ELECTION DISTRICT, MONTGOMERY COUNTY, MARYLAND

PROJECT NO. 1325-02-01

SOLTESZ, INC.
 Engineering
 Surveying
 Planning
 Environmental Sciences

Rockville Office
 2 Research Place, Suite 100
 Rockville, MD 20850
 P. 301.948.2750 F. 301.948.9067

Rockville
 Lanham
 Waldorf
 Leonardtown
 Frederick
 Soltesz DC, LLC

www.soltesz.com

| NO. | DATE | DESIGNED | CAO STANDARDS VERSION | REVISIONS | BY | DATE | CHECKED |
|-----|------------|----------|-----------------------|-----------|----|------|---------|
| | MARCH 2021 | JDS/KOL | 19 - NCS | | | | TJS |

MISS UTILITY NOTE
 INFORMATION CONCERNING EXISTING UNDERGROUND UTILITIES WAS OBTAINED FROM AVAILABLE RECORDS. THE CONTRACTOR MUST DETERMINE THE EXACT LOCATION AND ELEVATION OF ALL EXISTING UTILITIES AND UTILITIES OR SERVICES BY ENGINEERING TEST FITS BY HAND, WELL IN ADVANCE OF THE START OF EXCAVATION. CONTACT "MISS UTILITY" AT 1-800-261-7777 48 HOURS PRIOR TO THE START OF EXCAVATION. IF CLEARANCES ARE LESS THAN SHOWN ON THIS PLAN OR TWELVE (12) INCHES, WHOEVER IS LESS, CONTACT THE ENGINEER AND THE UTILITY COMPANY BEFORE PROCEEDING WITH CONSTRUCTION. CLEARANCES LESS THAN NOTED MAY REQUIRE REVISIONS TO THIS PLAN.

OWNER/DEVELOPER/APPLICANT
 WILGUS-MONTROSE ASSOCIATES LLC
 7811 MONTROSE ROAD
 SUITE 200
 POTOMAC, MD 20854
 PHONE: (240) 399-1500
 ROCKEN@WILLCO.COM
 RICHARD COHEN

| | | | |
|------------------|-----------|-----------------|---|
| MAP | ADC | GRID | 5285 |
| TAX MAP | G0562 | ZONING CATEGORY | CR-20, CD-10, MD, PD-20, CR-10, CR-15, CR-20, CR-25, CR-30, CR-35, CR-40, CR-45, CR-50, CR-55, CR-60, CR-65, CR-70, CR-75, CR-80, CR-85, CR-90, CR-95, CR-100 |
| WBSIC 2000 SHEET | 215 NW 06 | SITE DATUM | HORIZONTAL: NAD83 VERTICAL: NAD83 |