

PLANNING DEPARTMENT USE ONLY (E-PLANS)

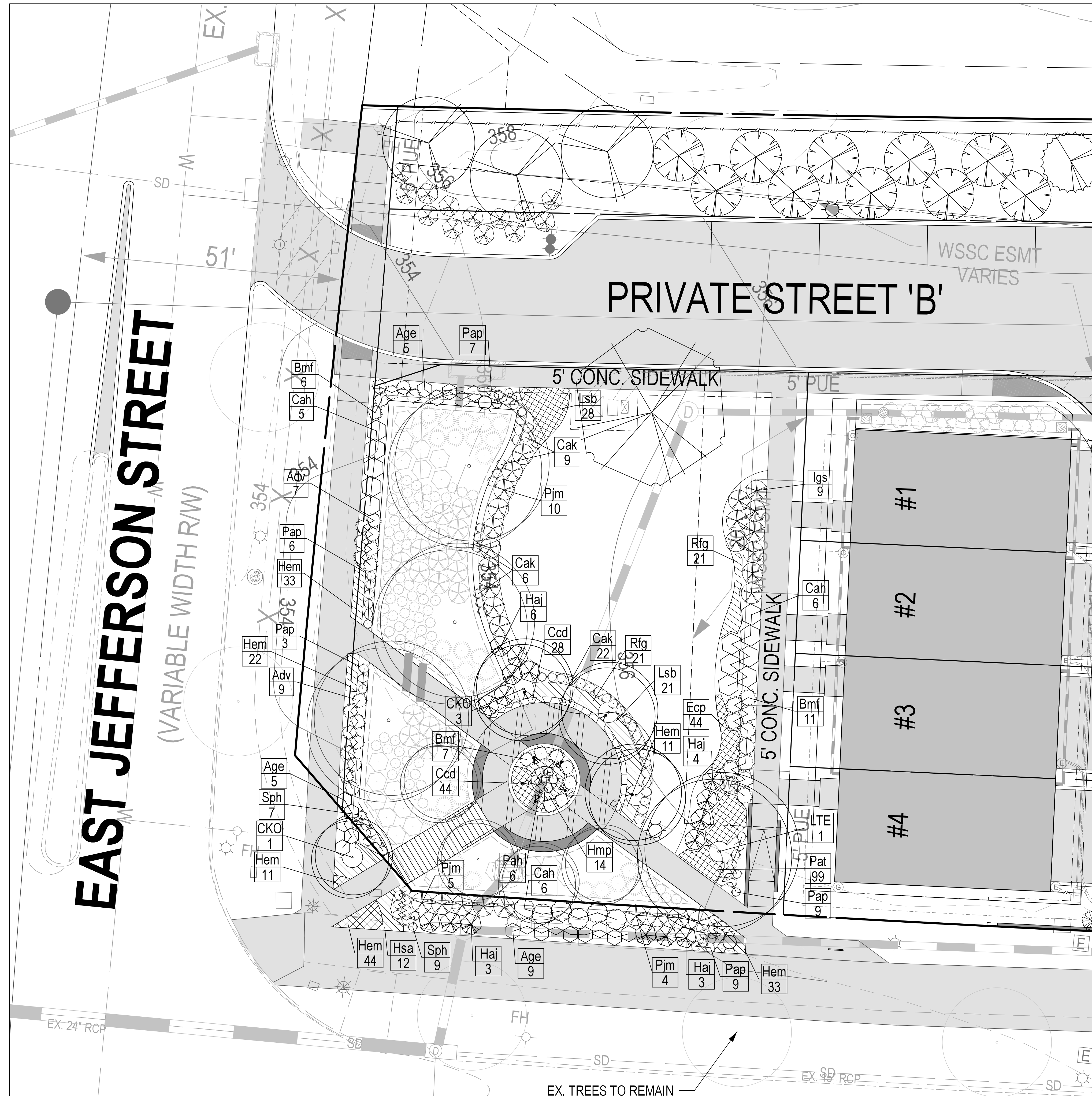

WESTERN PARK PLAN

1" = 10'

PLANT SCHEDULE FOR WESTERN PARK							
QTY	KEY	BOTANICAL NAME	COMMON NAME	SPACING	SIZE	TYPE	REMARK
SHADE TREES							
1	LTE	<i>Liriodendron tulipifera</i> 'Emerald City'	Emerald City Tulip Tree	As Shown	3" Cal.	B&B	Single-Stem, Full
ORNAMENTAL TREES							
4	CKO	<i>Cornus Kousa</i>	Kousa Dogwood	As Shown	2 - 2 1/2" Cal.	B&B	Single-Stem, Full
DECIDUOUS SHRUB							
19	Age	<i>Abelia x grandiflora</i> 'Edward Goucher'	Pink Abelia	36" O.C.	24"- 30" Ht.	B&B/#3 Cont.	Full-Sun
17	Cah	<i>Clethra alnifolia</i> 'Hummingbird'	Summersweet	42" O.C.	30"- 36" Ht.	B&B/#3 Cont.	Full-Sun to Part-Shade
9	Haj	<i>Hydrangea arborescens</i> 'Jane'	Little Lime Hydrangea	42" O.C.	30"- 36" Ht.	B&B/#4 Cont.	Full-Sun to Part-Shade
EVERGREEN SHRUB							
16	Adv	<i>Azalea</i> 'Delaware Valley White'	Delaware Valley Azalea	30" O.C.	24"- 30" Ht.	B&B/#3 Cont.	Part Shade
24	Bmf	<i>Buxus microphylla</i> 'Faulkner'	Littleleaf Boxwood	30" O.C.	24"- 30" Ht.	B&B/#3 cont.	Part-Sun to Full-Shade
9	Igs	<i>Ilex glabra</i> 'Shamrock'	Shamrock Inkberry Holly	48" O.C.	24"- 30" Ht.	B&B/#3 cont.	Full-Sun to Part-Shade
18	Pjm	<i>Pieris japonica</i> 'Mountain Fire'	Mountain Fire Japanese Pieris	48" O.C.	36"- 48" Ht.	B&B/#3 cont.	Full-Sun to Part-Shade
GRASSES AND PERENNIALS							
37	Cak	<i>Calamagrostis x acutiflora</i> 'Karl Foerster'	Feather Reed Grass	24" O.C.	#2	Cont.	Full-Sun to Part-Shade
44	Ecp	<i>Echinacea purpurea</i> 'Rubinstern'	Ruby Star Purple Coneflower	12" O.C.	#2	Cont.	Full-Sun
49	Lsb	<i>Leucanthemum x superbum</i> 'Becky'	Becky Shasta Daisy	18" O.C.	#2	Cont.	Full-Sun
154	Hem	<i>Hemerocallis</i> 'Stella D'Oro'	Stella D' Oro Daylily	12" O.C.	#2	Cont.	Full-Sun to Part-Shade
14	Hmp	<i>Heuchera micrantha</i> var. <i>diversifolia</i> 'Palace Purple'	Palace Purple Coral Bells	18" O.C.	#2	Cont.	Full-Sun to Part-Shade
34	Pap	<i>Pennisetum alopecuroides</i> 'Praline'	Praline Fountain Grass	24" O.C.	#2	Cont.	Full-Sun to Part-Shade
6	Pah	<i>Pennisetum alopecuroides</i> 'Hameln'	Hameln Dwarf Fountain Grass	24" O.C.	#2	Cont.	Full-Sun
42	Rfg	<i>Rudbeckia fulgida</i> 'Goldstrum'	Goldstrum Black Eyed Susan	18" O.C.	#2	Cont.	Full-Sun
16	Sph	<i>Sporobolus heterolepis</i>	Prairie Dropseed	24" O.C.	#2	Cont.	Full-Sun
PERENNIAL GROUNDCOVER							
74	Ccd	<i>Campanula carpatica</i> 'Deep Blue Chips'	Blue Bellflower	12" O.C.	#1	Cont.	Full-Sun to Part-Shade
12	Has	<i>Hylotelephium spectabile</i> 'Autumn Fire'	Stonecrop	24" O.C.	#1	Cont.	Full-Sun
99	Pat	<i>Pachysandra terminalis</i>	Pachysandra	12" O.C.	#1	Cont.	Full-Sun to Part-Shade

SCALE: 1" = 10'



NOTE: STORMWATER FACILITIES WILL BE PLANTED PER MCDPS REQUIREMENTS

DEVELOPER'S CERTIFICATE
 The Undersigned agrees to execute all the features of the Plan Approval No. 820210080 including Approval Conditions, Development Program, and Landscape and Lighting Plan.
 Developer's Name: WILGUS-MONTROSE ASSOCIATES LLC
 Address: 7811 MONTROSE ROAD, SUITE 200, POTOMAC, MD 20854
 Phone: (240) 399-1500
 Signature: _____

SOLTESZ, INC.
 Rockville Lanham Waldorf Leonardtown Frederick Soltesz DC, LLC
 ROCKVILLE OFFICE
 2 Research Place, Suite 100
 Rockville, MD 20850
 P. 301.948.2750 F. 301.948.9067
 www.soltesz.com

NO.	DATE	REVISIONS	BY	DATE
DESIGNED: SAC	DECEMBER 2020	CAO STANDARDS VERSION: 18 - NCS	TECHNICIAN: JCW	CHECKED: KDL

MISS UTILITY NOTE
 INFORMATION CONCERNING EXISTING UNDERGROUND UTILITIES WAS OBTAINED FROM AVAILABLE RECORDS. THE CONTRACTOR MUST DETERMINE THE EXACT LOCATION AND ELEVATION OF ALL EXISTING UTILITIES AND UTILITIES OR SERVICES BY ENGINEERING TEST FITS BY HAND, WELL IN ADVANCE OF THE START OF EXCAVATION. CONTACT "MISS UTILITY" AT 1-800-261-7777. 48 HOURS PRIOR TO THE START OF EXCAVATION. IF CLEARANCES ARE LESS THAN SHOWN ON THIS PLAN OR TWELVE (12) INCHES, WHOEVER IS LESS, CONTACT THE ENGINEER AND THE UTILITY COMPANY BEFORE PROCEEDING WITH CONSTRUCTION. CLEARANCES LESS THAN NOTED MAY REQUIRE REVISIONS TO THIS PLAN.

OWNER/DEVELOPER/APPLICANT
 WILGUS-MONTROSE ASSOCIATES LLC
 7811 MONTROSE ROAD
 SUITE 200
 POTOMAC, MD 20854
 PHONE: (240) 399-1500
 ROCKINGWILLCO.COM
 RICHARD COHEN

MAP: ADC	GRID: 5285
TAX MAP: G0552	ZONING CATEGORY: CR-2 (C-1, C-2, C-3, C-4, C-5, C-6, C-7, C-8, C-9, C-10, C-11, C-12, C-13, C-14, C-15, C-16, C-17, C-18, C-19, C-20, C-21, C-22, C-23, C-24, C-25, C-26, C-27, C-28, C-29, C-30, C-31, C-32, C-33, C-34, C-35, C-36, C-37, C-38, C-39, C-40, C-41, C-42, C-43, C-44, C-45, C-46, C-47, C-48, C-49, C-50, C-51, C-52, C-53, C-54, C-55, C-56, C-57, C-58, C-59, C-60, C-61, C-62, C-63, C-64, C-65, C-66, C-67, C-68, C-69, C-70, C-71, C-72, C-73, C-74, C-75, C-76, C-77, C-78, C-79, C-80, C-81, C-82, C-83, C-84, C-85, C-86, C-87, C-88, C-89, C-90, C-91, C-92, C-93, C-94, C-95, C-96, C-97, C-98, C-99, C-100)
WISC 200 SHEET: 215 NW 06	SITE DATUM: HORIZONTAL: NAD83 VERTICAL: NAD83

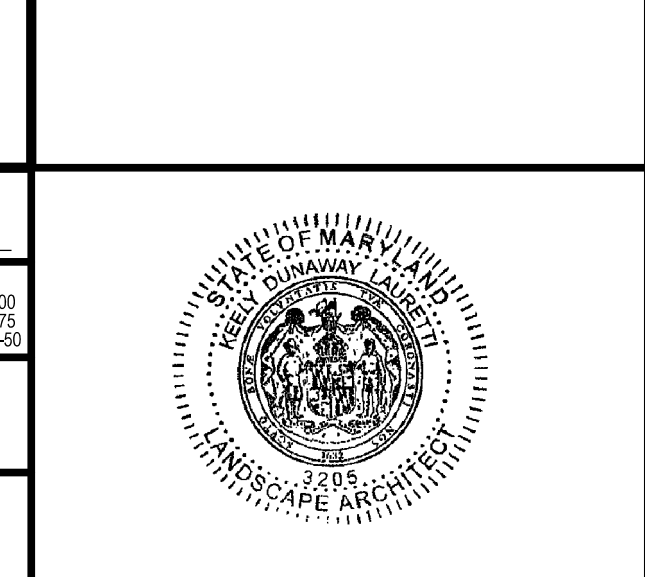

WESTERN PARK LANDSCAPE PLAN - 10 SCALE

LANDSCAPE AND LIGHTING PLAN 820210080
NORTH PARK AT MONTROSE
(FORMERLY WILGUS TRACT)

ROCKVILLE (4TH) ELECTION DISTRICT, MONTGOMERY COUNTY, MARYLAND

PROJECT NO. 1325-02-01