

The original of this drawing document was prepared by Soltesz, Inc. (SOLTESZ). This document was not obtained directly from SOLTESZ, Inc. and/or it was transmitted electronically. SOLTESZ cannot guarantee that unauthorized changes and/or alterations were not made by others. If verification of the information contained herein is needed, contact should be made directly with SOLTESZ. SOLTESZ makes no warranties, express or implied, concerning the accuracy of any information that has been transmitted by electronic means.

| DRAINAGE AREA TO ESD FACILITIES | | |
|---------------------------------|--------------------------------|-------------------|
| ESD FACILITY NO. | DRAINAGE AREA TO FACILITY S.F. | Runoff Coeff. 'C' |
| PB-2 | 3,696 | 0.90 |
| PB-3 | 3,696 | 0.90 |
| PB-4 | 1,728 | 0.90 |
| MWS-5 | 19,392 | 0.79 |
| MWS-6 | 18,567 | 0.80 |
| MWS-7 | 19,307 | 0.78 |
| PB-10 | 3,696 | 0.90 |
| PB-11 | 6,657 | 0.88 |
| PB-13 | 6,641 | 0.74 |
| PB-13A-13E | 1,320 | 0.90 |
| PB-14 | 11,252 | 0.79 |
| PB-16 | 8,924 | 0.87 |
| PB-17A-17I | 5,472 | 0.90 |
| PB-18 | 4,704 | 0.90 |
| PB19A-19E | 1,320 | 0.90 |
| PB-21 | 2,292 | 0.90 |
| PB-22 | 2,601 | 0.90 |
| PB-23 | 2,612 | 0.90 |
| PB-24 | 9,076 | 0.81 |
| PB-26 | 5,670 | 0.90 |
| PB-28* | 13,876 | 0.90 |
| PB-30A | 8,492 | 0.73 |
| PB-30B | 3,645 | 0.66 |
| PB-31 | 6,212 | 0.70 |
| PB-32A | 6,425 | 0.65 |
| PB-32B | 5,555 | 0.63 |
| PB-33A | 4,513 | 0.61 |
| PB-33B | 2,677 | 0.59 |
| PB-34A | 2,412 | 0.76 |
| PB-34B | 3,897 | 0.77 |
| PB-35A | 3,338 | 0.76 |
| PB-35B | 2,579 | 0.84 |
| PB-36A | 1,688 | 0.69 |
| PB-36B | 3,180 | 0.80 |
| PB-37A | 4,459 | 0.84 |
| PB-37B | 2,163 | 0.70 |
| BS-1 | 5,894 | 0.43 |
| PB-38 | 19,049 | 0.90 |
| MWS_39 | 3,960 | 0.90 |
| MWS_40 | 3,220 | 0.90 |
| MWS_41 | 2,990 | 0.90 |
| PP-1 | 1,600 | 0.90 |
| PP-2 | 1,726 | 0.90 |
| PP-3 | 950 | 0.90 |
| PP-4 | 423 | 0.90 |
| PP-6 | 3,843 | 0.90 |
| GRF-1A | 2,808 | 0.90 |
| GRF-1B | 5,196 | 0.90 |
| GRF-2 | 4,608 | 0.90 |
| GRF-3 | 3,360 | 0.90 |
| GRF-5 | 5,701 | 0.90 |
| GRF-6 | 4,592 | 0.90 |
| GRF-7 | 5,830 | 0.90 |

* IMPERVIOUS AREA ALSO TREATED BY GREEN ROOF

| DRAINAGE AREA TO STRUCTURAL FACILITIES | | |
|--|--------------------------------|-------------------|
| STRUCTURAL FACILITY NO. | DRAINAGE AREA TO FACILITY S.F. | Runoff Coeff. 'C' |
| BIO-1 | 33,625 | 0.74 |
| BIO-12 | 42,594 | 0.81 |
| STORMFILTER 1 | 24,666 | 0.72 |
| STORMFILTER 2* | 17,204 | 0.90 |
| STORMFILTER 3* | 13,833 | 0.90 |
| STORMFILTER 4* | 30,884 | 0.90 |
| STORMFILTER 5 | 20,954 | 0.85 |

* IMPERVIOUS AREA ALSO TREATED BY GREEN ROOF

| DRAINAGE AREA TO INLETS | | |
|-------------------------|-------------------------------------|--------------|
| Structure No. | Total Tributary Drainage Area (Ac.) | Weighted "C" |
| EX101 | 0.247 | 0.65 |
| EX102 | 0.338 | 0.57 |
| EX103 | 0.548 | 0.54 |
| EX104 | 0.772 | 0.56 |
| EX105 | 0.201 | 0.68 |
| EX106 | 0.490 | 0.62 |
| EX107 | 0.644 | 0.57 |
| EX109 | 0.095 | 0.72 |
| EX110 | 0.106 | 0.74 |
| EX111 | 0.247 | 0.72 |
| EX112 | 0.189 | 0.72 |
| EX113 | 0.231 | 0.73 |
| EX114 | 0.252 | 0.76 |
| EX115 | 0.267 | 0.83 |
| EX116 | 0.311 | 0.71 |
| EX117 | 0.246 | 0.71 |
| EX118 | 0.280 | 0.71 |
| EX501 | 0.447 | 0.67 |
| EX502 | 0.130 | 0.74 |
| EX503 | 0.104 | 0.67 |
| EX504 | 0.096 | 0.86 |

| DRAINAGE AREA TO INLETS | | |
|-------------------------|---|--------------|
| Structure No. | Total Tributary Drainage Area (Sq. ft.) | Weighted "C" |
| EX201 | 20,795 | 0.67 |
| EX202 | 6,653 | 0.65 |
| EX203 | 6,369 | 0.62 |
| EX204 | 8,301 | 0.64 |
| EX205 | 34,636 | 0.68 |
| EX207 | 9,694 | 0.78 |
| EX208 | 33,016 | 0.82 |
| EX208A | 5,205 | 0.71 |
| EX210 | 4,438 | 0.58 |
| EX214 | 21,517 | 0.73 |
| IN122 | 14,630 | 0.68 |
| IN124 | 11,087 | 0.45 |
| IN204 | 4,628 | 0.69 |
| IN220 | 13,007 | 0.78 |
| IN222 | 4,632 | 0.78 |
| IN224 | 6,065 | 0.45 |
| IN228 | 6,444 | 0.29 |
| BIO12 | 31,407 | 0.73 |
| TD200 | 13,596 | 0.86 |
| P_OFFSITE | 62,797 | 0.67 |

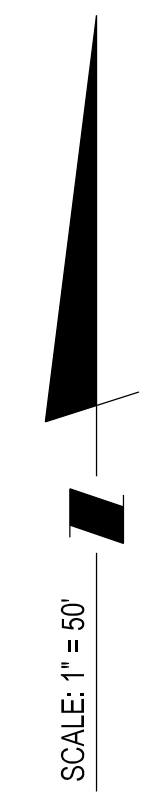
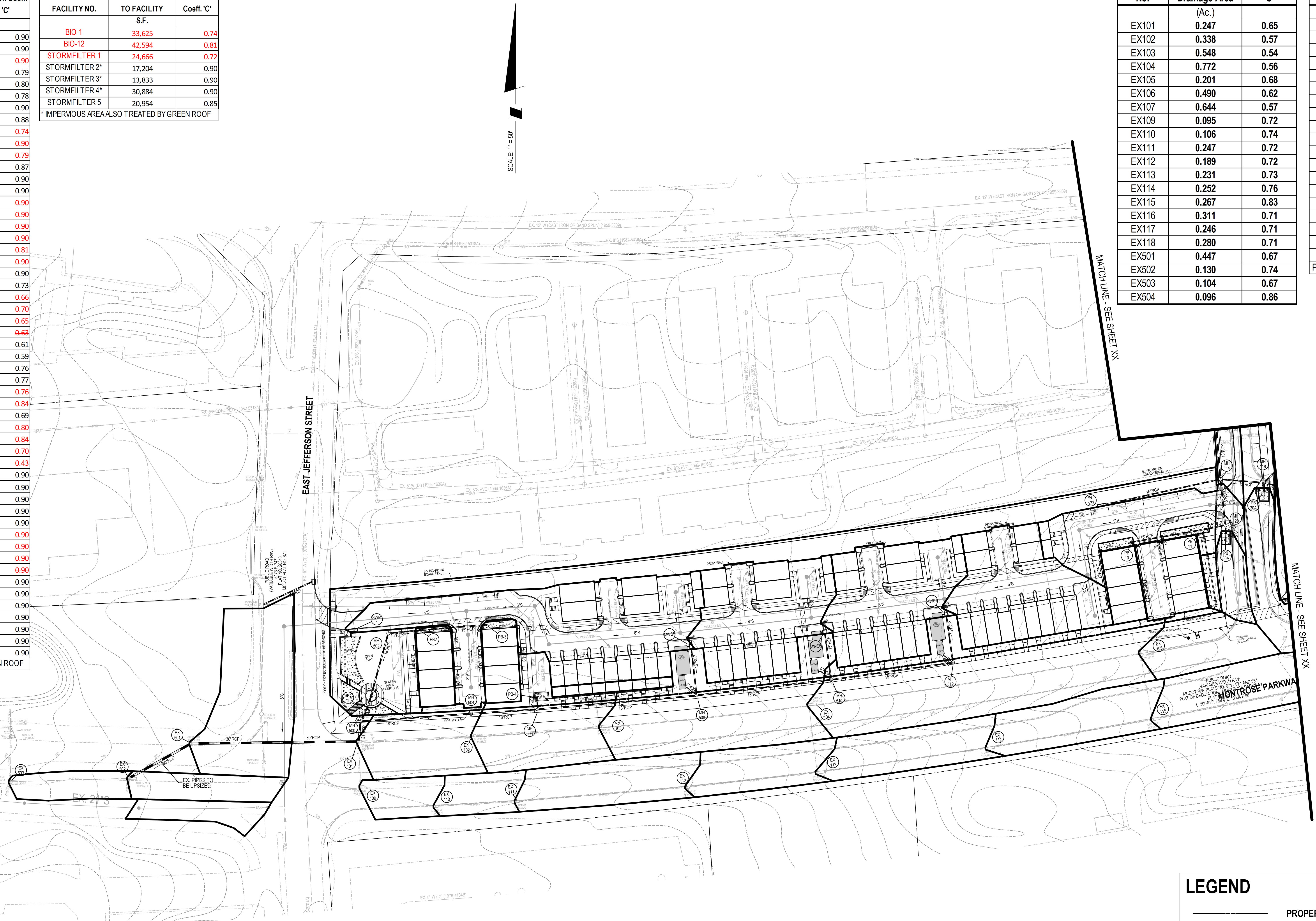

LEGEND

- PROPERTY LINE
- UNDERGROUND STORAGE VAULT
- PLANTER BOX
- PROPOSED DRAINAGE DIVIDE



SOLTESZ, INC.
 Rockville
 Lanham
 Waldorf
 Leonardtown
 Frederick
 Soltesz DC, LLC

ROCKVILLE OFFICE
 2 Research Place, Suite 100
 Rockville, MD 20850
 P. 301.948.2750 F. 301.948.9067
 www.solteszco.com

| NO. | DATE | DESIGNED | BY | DATE |
|-----|---------------|----------|----|------|
| 1 | DECEMBER 2020 | A.G. | | |

| REVISIONS | BY | DATE |
|---------------------------------|----|------|
| CAO STANDARDS VERSION: 19 - NCS | | |
| TECHNICIAN: A.G. | | |
| CHECKED: J.S. | | |

MISS UTILITY NOTE

INFORMATION CONCERNING EXISTING UNDERGROUND UTILITIES WAS OBTAINED FROM AVAILABLE RECORDS. THE CONTRACTOR MUST DETERMINE THE EXACT LOCATION AND ELEVATION OF ALL EXISTING UTILITIES AND UTILITIES OR SOBBMS BY EXCAVATION TEST PITS BY HAND, WELL IN ADVANCE OF THE START OF EXCAVATION. CONTACT "MISS UTILITY" AT 1-800-267-7777, 48 HOURS PRIOR TO THE START OF EXCAVATION. IF CLEARANCES ARE LESS THAN SHOWN ON THE PLAN OR TWELVE (12) INCHES, WHICHEVER IS LESS, CONTACT THE ENGINEER AND THE UTILITY COMPANY BEFORE PROCEEDING WITH CONSTRUCTION. CLEARANCES LESS THAN NOTED MAY REQUIRE REVISIONS TO THIS PLAN.

OWNER/DEVELOPER/APPLICANT

WILGUS/MONTROSE ASSOCIATES, LLC
 7811 MONTROSE ROAD
 SUITE 200
 POTOMAC, MD 20854
 PHONE: (240) 398-1500
 ROCKINGWILLOCO.COM
 RICHARD COHEN

| | | | |
|----------------|-------------------|------|------|
| MAP | ADC | GRID | 5285 |
| TAX MAP | GC02 | | |
| WSSC 200 SHEET | 215 NW 06 | | |
| SITE DATUM | HORIZONTAL: NAD83 | | |
| | VERTICAL: NAD83 | | |

PROFESSIONAL CERTIFICATION

I HEREBY CERTIFY THAT THESE DOCUMENTS WERE PREPARED OR APPROVED BY ME, AND THAT I AM A DULY LICENSED PROFESSIONAL ENGINEER UNDER THE LAWS OF THE STATE OF MARYLAND.

LICENSE NO. 30287 EXPIRATION DATE: 05/18/2022

STORM DRAIN DRAINAGE AREA MAP

PRELIMINARY STORM DRAIN PLANS
NORTH PARK AT MONTROSE
(FORMERLY WILGUS TRACT)
7811 MONTROSE ROAD

POTOMAC (1ST) ELECTION DISTRICT, MONTGOMERY COUNTY, MARYLAND

SHEET **2** OF **6**

PROJECT NO. 1326-02-01