

PLANNING DEPARTMENT USE ONLY (E-PLANS)

LOCAL AREA MAP

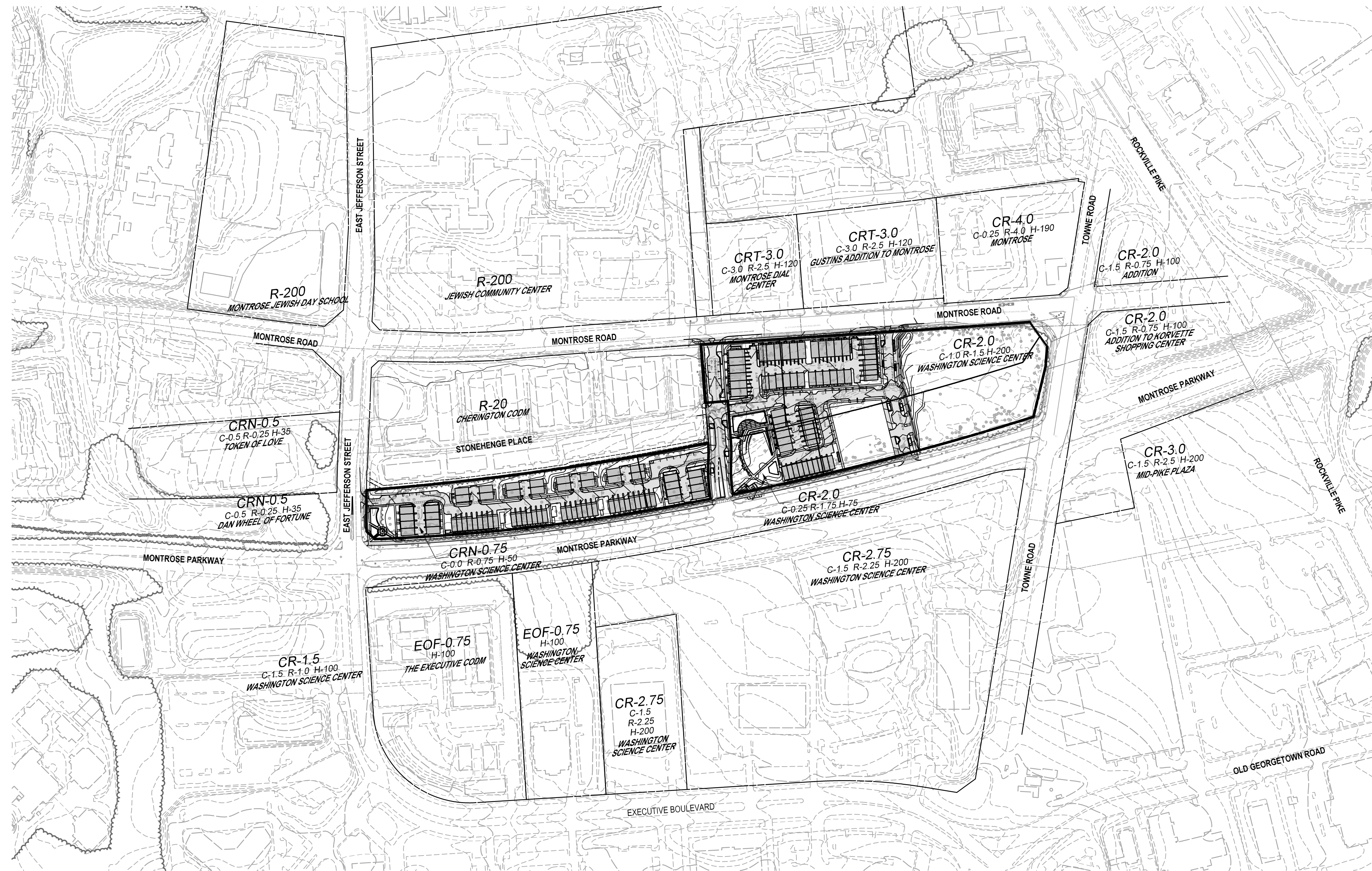

LEGEND:	
	EXISTING GRADE
	PROPOSED GRADE
	EXISTING BUILDING
	PROPOSED BUILDING
	PROPOSED RIGHT OF WAY
	PROPERTY ADJACENT
	PROPOSED SITE TREES

SCALE: 1" = 200'

DEVELOPER'S CERTIFICATE
 The undersigned agrees to execute all the features of the Site Plan Approval No. 820210080, including Approval Conditions, Development Program, and Certified Site Plan.
 Developer's Name: WILGUS/MONTROSE ASSOCIATES LLC
 Company: RICHARD COHEN
 Contact Person: RICHARD COHEN
 Address: 7811 MONTROSE ROAD, SUITE 200, POTOMAC, MD 20854
 Phone: (240) 399-1500
 Signature: _____

PROFESSIONAL CERTIFICATION
 I HEREBY CERTIFY THAT THESE DOCUMENTS WERE PREPARED OR APPROVED BY ME, AND THAT I AM A DULY LICENSED PROFESSIONAL ENGINEER UNDER THE LAWS OF THE STATE OF MARYLAND.
 LICENSE NO. 30287 EXPIRATION DATE: 05/18/2022

LOCAL AREA MAP

SITE PLAN 820210080 NORTHPARK AT MONTROSE (FORMERLY WILGUS TRACT)

POTOMAC (1ST) ELECTION DISTRICT, MONTGOMERY COUNTY, MARYLAND

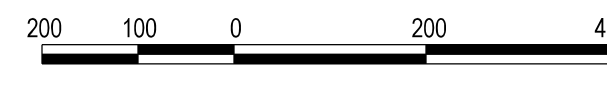

SOLTESZ, INC.
 Rockville Office
 2 Research Place, Suite 100
 Rockville, MD 20850
 P. 301.948.2750 F. 301.948.9067
 www.soltesz.com

NO.	DATE	DESIGNED	TECHNICAL	REVISIONS	BY	DATE
1	DECEMBER 2020	JS	ENT	VS - RCS		

MISS UTILITY NOTE
 INFORMATION CONCERNING EXISTING UNDERGROUND UTILITIES WAS OBTAINED FROM AVAILABLE RECORDS. THE CONTRACTOR MUST DETERMINE THE EXACT LOCATION AND ELEVATION OF ALL EXISTING UTILITIES AND UTILITIES ORIGINATING BY ENGINEER TEST PITS BY HAND, WELL IN ADVANCE OF THE START OF EXCAVATION. CONTACT "MISS UTILITY" AT 1-800-261-7777 48 HOURS PRIOR TO THE START OF EXCAVATION. IF CLEARANCES ARE LESS THAN SHOWN ON THE PLAN OR TWELVE (12) INCHES, WHICHEVER IS LESS, CONTACT THE ENGINEER AND THE UTILITY COMPANY BEFORE PROCEEDING WITH CONSTRUCTION. CLEARANCES LESS THAN NOTED MAY REQUIRE REVISIONS TO THIS PLAN.

OWNER/DEVELOPER/APPLICANT
 WILGUS/MONTROSE ASSOCIATES LLC
 7811 MONTROSE ROAD
 SUITE 200
 POTOMAC, MD 20854
 PHONE: (240) 399-1500
 ROCKEN@WILLCO.COM
 RICHARD COHEN

MAP	ADC	GRID	5285
TAX MAP	G0562	ZONING CATEGORY	CR-3.0 C-1.5 R-2.5 H-100
WESC 200 SHEET	215 NW 06	STATE	MD
SITE DATUM	HORIZONTAL: NAD83	VERTICAL:	NAD83



SHEET 1
 PROJECT NO. 1325-02-01