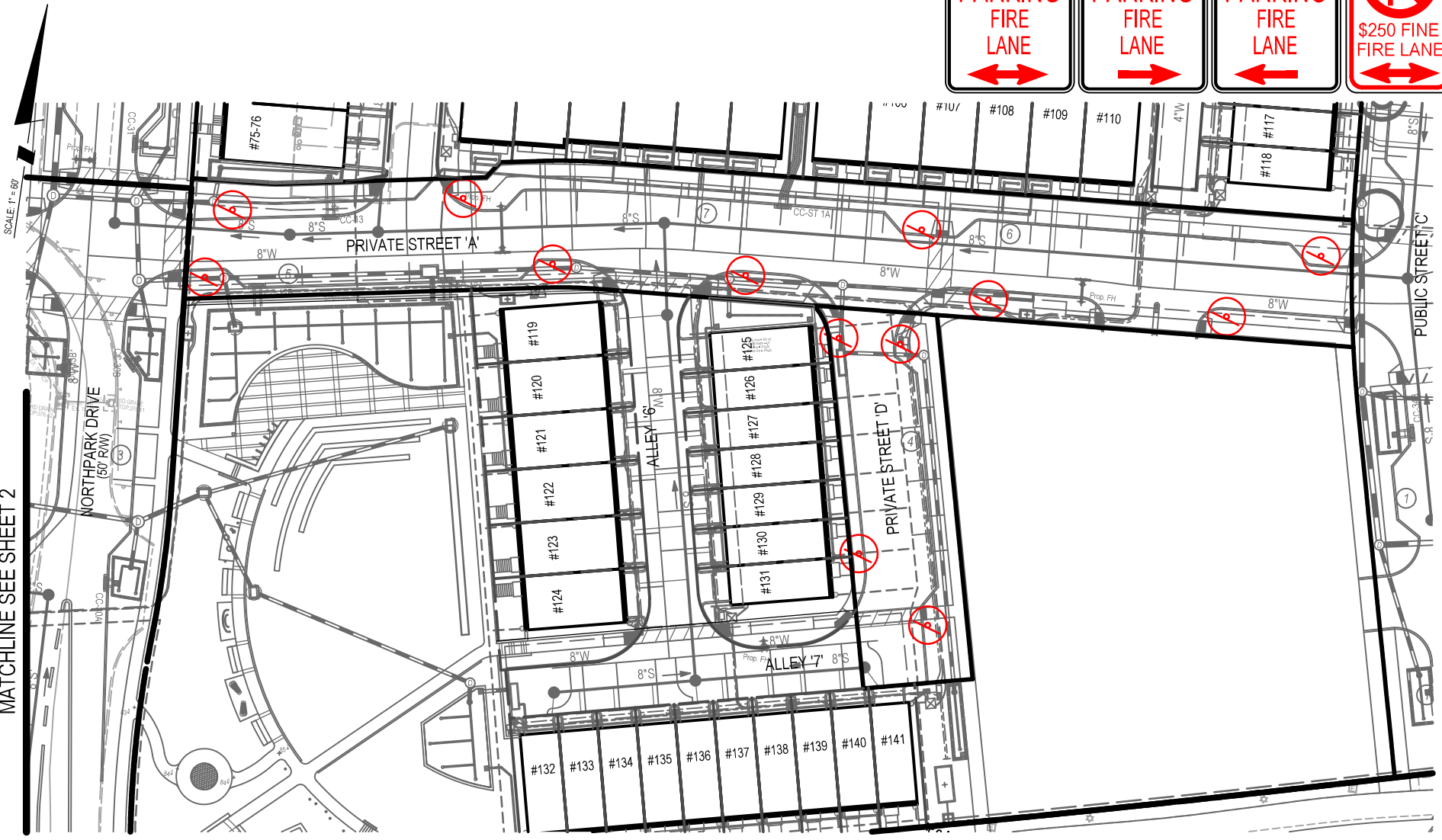

The original of this drawing document was prepared by Soltesz, Inc. (SOLTESZ). If this document was not obtained directly from SOLTESZ and/or it was transmitted electronically, SOLTESZ cannot guarantee that unauthorized changes and / or alterations were not made by others. If verification of the information contained herein is needed, contact should be made directly with SOLTESZ. SOLTESZ makes no warranties, express or implied, concerning the accuracy of any information that has been transmitted by electronic means.

MATCHLINE SEE SHEET 2

LEGEND
 FIRE LANE SIGNS

FIRE LANE NO PARKING SIGN DETAILS

SOLTESZ, Inc.
 2 Research Place, Suite 100
 Rockville, MD 20850
 P.301.948.2750 F.301.948.9067
 www.solteszco.com

FIRE LANE SIGN PLAN
**NORTHPARK AT MONTROSE
 (FORMERLY WILGUS TRACT)**
 MONTGOMERY COUNTY, MARYLAND

SHEET 3
 OF 3

JOB NO. 1326-02-01 SCALE 1" = 60' DATE 4/19/2021