

PLANNING DEPARTMENT USE ONLY (E-PLANS)

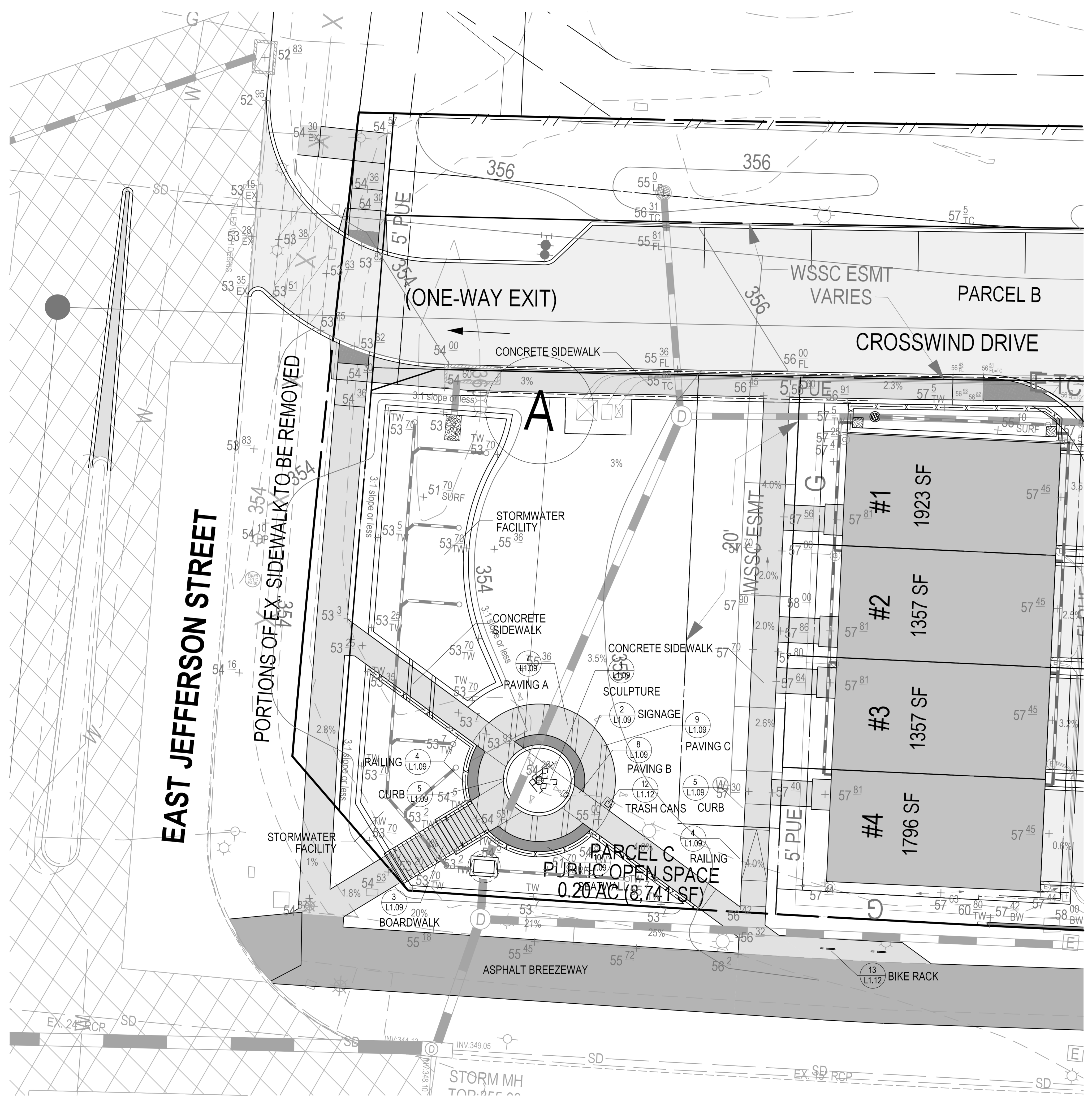

SCALE: 1" = 10'



DEVELOPER'S CERTIFICATE
 The Undersigned agrees to execute all the features of the Site Plan Approval No. 820210080, including Approval Conditions, Development Program, and Certified Site Plan.
 Developer's Name: WILGUS MONTROSE ASSOCIATES LLC
 Company: RICHARD COHEN
 Contact Person: RICHARD COHEN
 Address: 7811 MONTROSE ROAD, SUITE 200, POTOMAC, MD 20854
 Phone: (240) 399-1500
 Signature: *[Signature]*

SOLTESZ, INC.
 Rockville Office
 2 Research Place, Suite 100
 Rockville, MD 20850
 P. 301.948.2750 F. 301.948.9067
 www.solteszco.com

NO.	DATE	REVISIONS	BY	DATE

DATE: DECEMBER 2020
 DESIGNED: SAC
 CAD STANDARDS VERSION: V8 - NCS
 TECHNICIAN: JCW
 CHECKED: KDL

MISS UTILITY NOTE
 INFORMATION CONCERNING EXISTING UNDERGROUND UTILITIES WAS OBTAINED FROM AVAILABLE RECORDS. THE CONTRACTOR MUST DETERMINE THE EXACT LOCATION AND ELEVATION OF ALL EXISTING UTILITIES AND UTILITIES ORIGINATING BY ENGINEER TEST FITS BY HAND, WELL IN ADVANCE OF THE START OF EXCAVATION. CONTACT MISS UTILITY AT 781-227-7777 48 HOURS PRIOR TO THE START OF EXCAVATION. IF CLEARANCES ARE LESS THAN SHOWN ON THIS PLAN OR TWELVE (12) INCHES, WHOEVER IS LESS, CONTACT THE ENGINEER AND THE UTILITY COMPANY BEFORE PROCEEDING WITH CONSTRUCTION. CLEARANCES LESS THAN NOTED MAY REQUIRE REVISIONS TO THIS PLAN.

OWNER/DEVELOPER/APPLICANT
 WILGUS MONTROSE ASSOCIATES LLC
 7811 MONTROSE ROAD
 SUITE 200
 POTOMAC, MD 20854
 PHONE: (240) 399-1500
 ROCKING@WILLCO.COM
 RICHARD COHEN

MAP	ADC	GRID	5285
TAX MAP	G0562	ZONING CATEGORY	CR-20 (C-10, C-15, C-20, C-25, C-30, C-35, C-40, C-45, C-50, C-55, C-60, C-65, C-70, C-75, C-80, C-85, C-90, C-95, C-100)
WSSC 200 SHEET	215 NW 06	SITE DATUM	HORIZONTAL: NAD83 VERTICAL: NAD83

Daniel H. Park
 Daniel H. Park
 1.12.07
 10:50:05 AM
 12/17/2021 3:27:54 PM

WESTERN PARK HARDSCAPE PLAN- 10 SCALE

CERTIFIED LANDSCAPE AND LIGHTING PLAN 820210080

NORTH PARK AT MONTROSE (FORMERLY WILGUS TRACT)

ROCKVILLE (4TH) ELECTION DISTRICT, MONTGOMERY COUNTY, MARYLAND

PROJECT NO. 1326-02-01