

PLANNING DEPARTMENT USE ONLY (E-PLANS)

- GENERAL NOTES:**
- FOR ELECTRICAL SYMBOLS, ABBREVIATIONS, AND MOUNTING HEIGHTS, REFER TO DRAWING EG-1.
 - FOR LIGHTING FIXTURES DESCRIPTION, REFER TO LIGHTING FIXTURE SCHEDULE ON DRAWING EG-1.
 - FOR ACTUAL LOCATION OF SITE LIGHTING FIXTURES, REFER TO LANDSCAPE DRAWINGS.

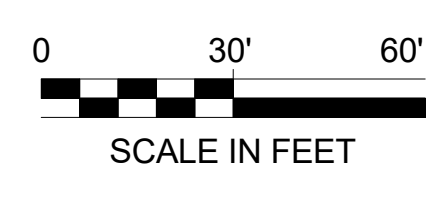

1 ELECTRICAL SITE LIGHTING PLAN
SCALE: 1" = 30'-0"

SITE PLAN 81995045G

DEVELOPER'S CERTIFICATE
The Undersigned agrees to execute all the features of the Site Plan Approval No. 81995045G, including Approval Conditions, Development Program and Certified Site Plan.
Developer's Name: ARE-Maryland No 24.LLC William DePippo
Company Contact Person
Address: 946 Clopper Road, Gaithersburg, MD 20878
Phone: 301-947-1770
Signature: _____

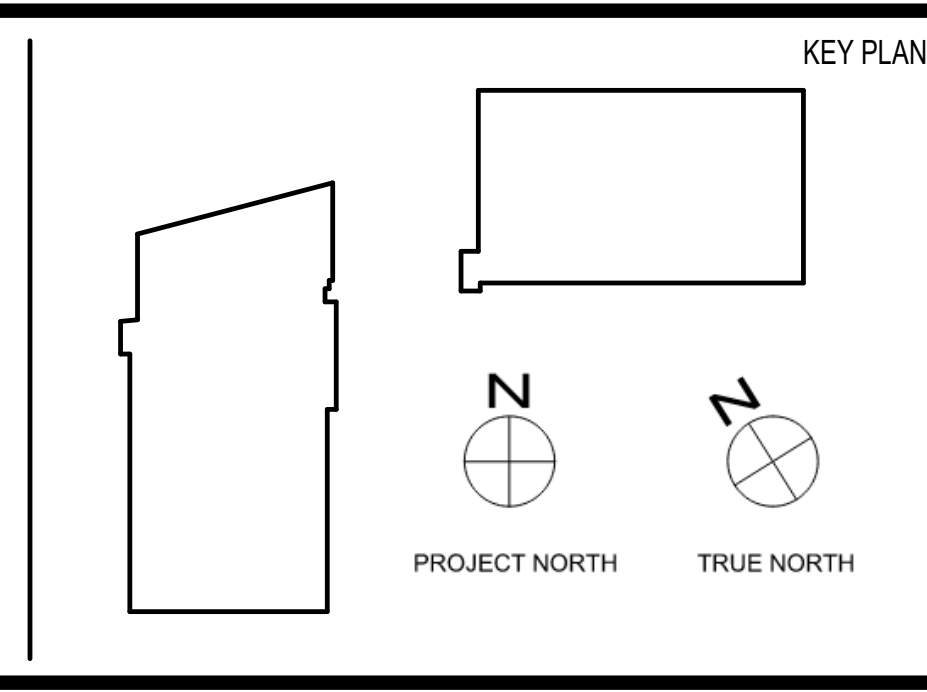

NO.	BY	DESCRIPTION	DATE

REVISIONS

CIVIL SITE ENGINEERS:
SOLTESZ ENGINEERING
2 Riverchase Place, Suite 100
Rockville, MD 20850
Phone: 301-463-2700

LAND PLANNERS & LANDSCAPE ARCHITECTS:
MCKE
452 South Ludlow Alley
Columbia, OH 43219
Phone: 614-621-2790

STRUCTURAL ENGINEERS:
FACENT ASSOCIATES, INC.
810 Light Street
Baltimore, MD 21202
Phone: 410-783-1699

MEP ENGINEERS:
JEANERIK ENGINEERING, INC.
8833 D Baker Road
Nightingale, MD 21228
Phone: 410-870-1300

SUSTAINABILITY CONSULTANTS:
LORAX PARTNERSHIPS, LLC
1220 Light Street
Baltimore, MD 21202
Phone: 410-444-0310

PRINCIPAL
WILLIAM A.L. GAUDREAU
PROJECT MANAGER
RICH WILLIAMS

810 Light Street
Baltimore, MD 21202-3970
Tel: 410-837-5040 Fax: 410-234-8010

EWING COLE

Copyright © 2021 by EWINGCOLE

PROJECT NO. Project Number SCALE As indicated
DRAWING NAME ELECTRICAL SITE LIGHTING PLAN

ALEXANDRIA REAL ESTATE EQUITIES

9800 MEDICAL CENTER DRIVE,
BUILDING E & PARKING DECK

ROCKVILL, MD 20850

DRAWN BY JB DATE 01-19-2021
FLOOR/SECTION PHASE DRAWING NO.
E.L0.1

2/23/2021 7:48:53 PM C:\Revit\Local Files\2020\5650_L20_CENTRAL_Banner\COLIER.rvt