

Contract No. EWINGCOLE
CONSULTANTS
CIVIL SITE ENGINEERS
 554 TIGER CROWNING
 2 River Road, Suite 100
 Pikesville, MD 21088
 Phone: 410-644-3700
LAND PLANNERS & LANDSCAPE ARCHITECTS:
 WLF
 405 South Lister Alley
 Columbia, MD 21046
 Phone: 410-651-2700
STRUCTURAL ENGINEERS:
 FALSTY ENGINEERING, INC.
 814 Light Street
 Baltimore, MD 21202
 Phone: 410-761-1800
MERFF ENGINEERS:
 JENKINS ENGINEERING, INC.
 8817 Forest Road
 Nottingham, MD 21078
 Phone: 410-831-1300
SUSTAINABILITY CONSULTANTS:
 LOWE PARTNERSHIP, LLC
 100 Light Street
 Baltimore, MD 21202
 Phone: 410-681-0100

PLANNING DEPARTMENT USE ONLY (E-PLANS)

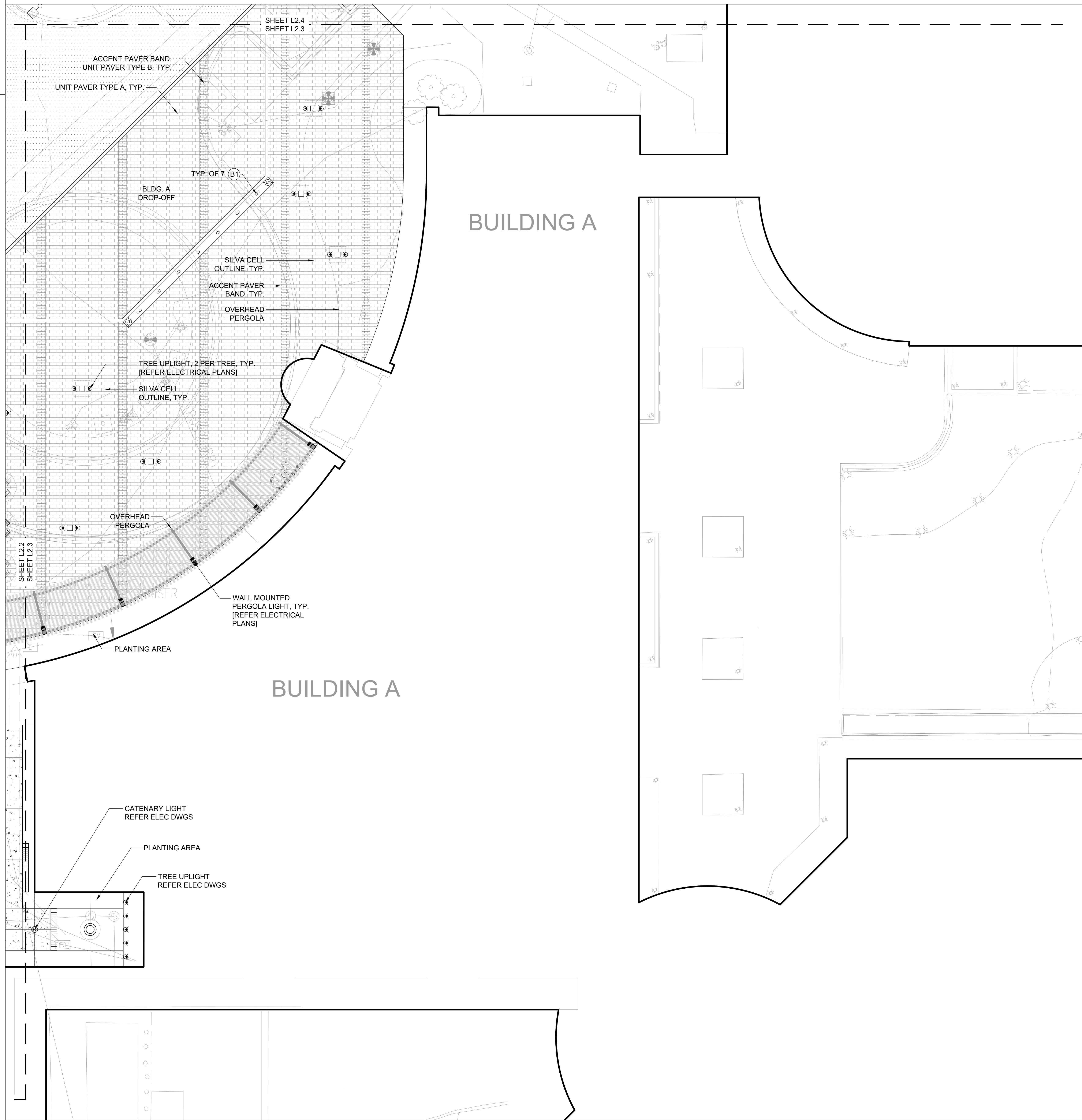

KEY PLAN

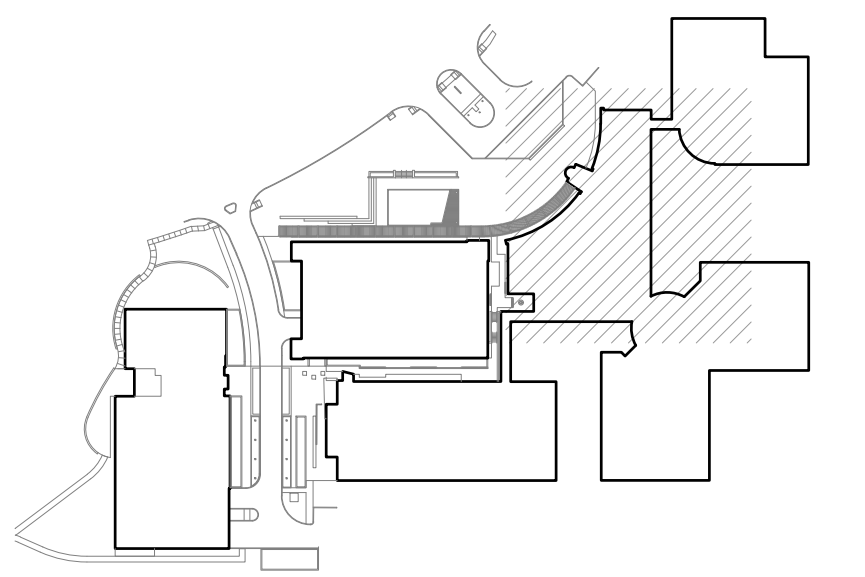

PRINCIPAL
ANDY KNIGHT, PLA
PROJECT MANAGER
RICK ESPE, PLA

Professional Certification: I certify that these documents were prepared or approved by me, and that I am a duly licensed landscape architect under the laws of the State of Maryland.
License No: 01-4189 Expiration Date: 01/26/23

REVISIONS

NO.	BY	DESCRIPTION	DATE

SITE PLAN AMENDMENT G:
81995045G
9800 MEDICAL CENTER DRIVE

SITE PLAN 81995045G

DEVELOPER'S CERTIFICATE
 The Undersigned agrees to execute all the features of the Site Plan Approval No. 81995045G, including Approval Conditions, Development Program and Certified Site Plan.
 Developer's Name: ARE-Maryland No.24, LLC. William DePippo
 Company Contact Person
 Address: 946 Clopper Road, Gaithersburg, MD 20878
 Phone: 301-947-1770
 Signature: _____



ALEXANDRIA
 ALEXANDRIA REAL ESTATE EQUITIES, INC.

**9800 MEDICAL CENTER DRIVE
 BUILDING E & PARKING DECK**

ROCKVILLE, MD 20850

DRAWN BY DB DATE 02-19-2021

PROJECT NO. SCALE

DRAWING NAME

MATERIALS PLAN

FLOOR/SECTION/PHASE DRAWING NO.

DD L2.3

