

PLANNING DEPARTMENT USE ONLY (E-PLANS)

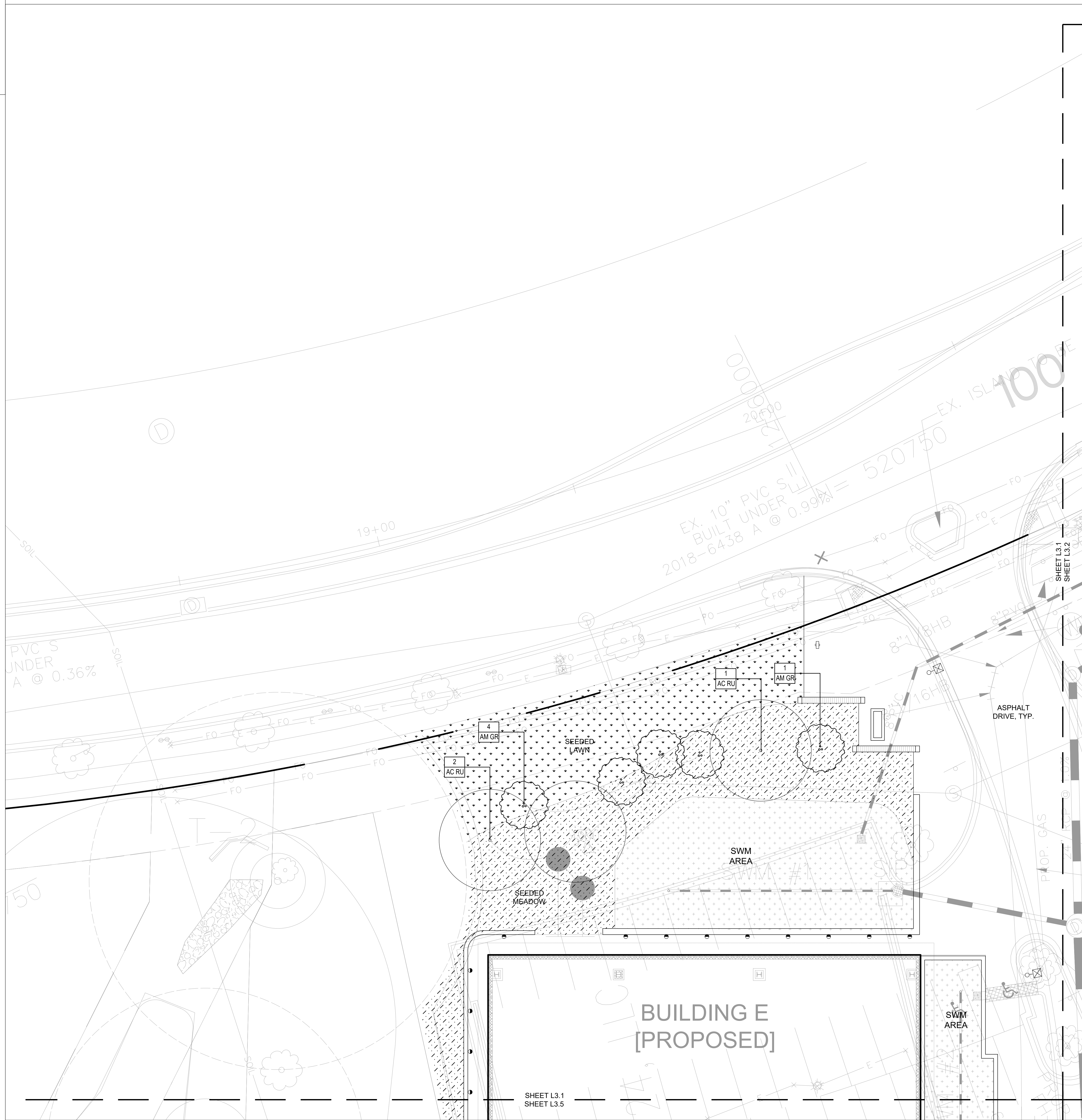

SHEET L3.1
SHEET L3.5

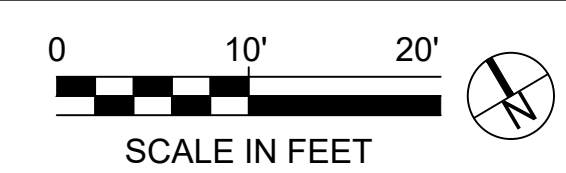

SITE PLAN AMENDMENT G:
81995045G
9800 MEDICAL CENTER DRIVE

SITE PLAN 81995045G

DEVELOPER'S CERTIFICATE
 The Undersigned agrees to execute all the features of the Site Plan Approval No. 81995045G, including Approval Conditions, Development Program and Certified Site Plan.
 Developer's Name: ARE-Maryland No.24, LLC. William DePippo
Company Contact Person

Address: 946 Clopper Road, Gaithersburg, MD 20878
 Phone: 301-947-1770
 Signature: _____

EWING COLE
 810 Light Street
 Baltimore, MD 21230-3970
 Tel: 410-837-5040 Fax: 410-234-8010

Contract: 19 EWINGCOLE

CONSULTANTS
CIVIL SITE ENGINEERS:
 SA, LLC ENGINEERING
 2000 North Point Blvd
 P.O. Box 1000
 P.O. Box 1000
 Phone: 301-948-3700

LAND PLANNERS & LANDSCAPE ARCHITECTS:
 W&P
 405 South Lister Alley
 Columbia, MD 21046
 Phone: 410-321-2700

STRUCTURAL ENGINEERS:
 F&S ENGINEERING, INC.
 815 Light Street
 Baltimore, MD 21202
 Phone: 410-781-1800

MERFF ENGINEERS:
 JENSEN ENGINEERING, INC.
 8817 Forest Road
 Nottingham, MD 21070
 Phone: 410-331-1300

SUSTAINABILITY CONSULTANTS:
 LOWE PARTNERSHIPS, LLC
 200 Light Street
 Baltimore, MD 21202
 Phone: 410-681-0100

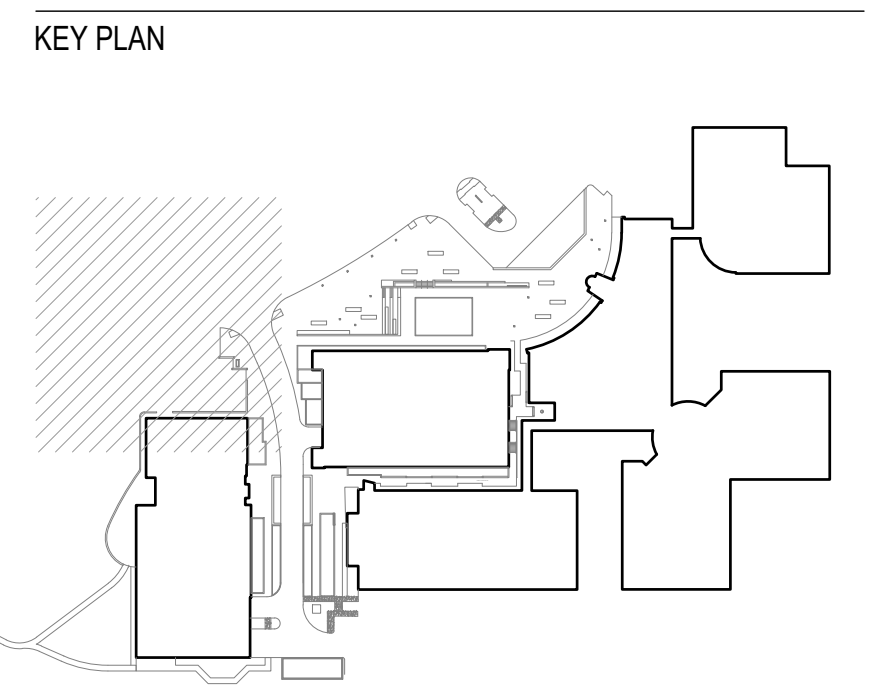

PRINCIPAL:
 ANDY KNIGHT, PLA
PROJECT MANAGER:
 RICK ESPE, PLA

Professional Certification: I certify that these documents were prepared or approved by me, and that I am a duly licensed landscape architect under the laws of the State of Maryland.
 License No: 01-14189 Expiration Date: 01/26/23

REVISIONS

NO.	BY	DESCRIPTION	DATE

ALEXANDRIA
 ALEXANDRIA REAL ESTATE EQUITIES, INC

**9800 MEDICAL CENTER DRIVE
 BUILDING E & PARKING DECK**

ROCKVILLE, MD 20850

DRAWN BY	DB	DATE	02-19-2021
PROJECT NO.	SCALE		
DRAWING NAME			
LANDSCAPE PLAN			
FLOOR/SECTION/PHASE	DRAWING NO.		
DD	L3.1		