

PLANNING DEPARTMENT USE ONLY (E-PLANS)

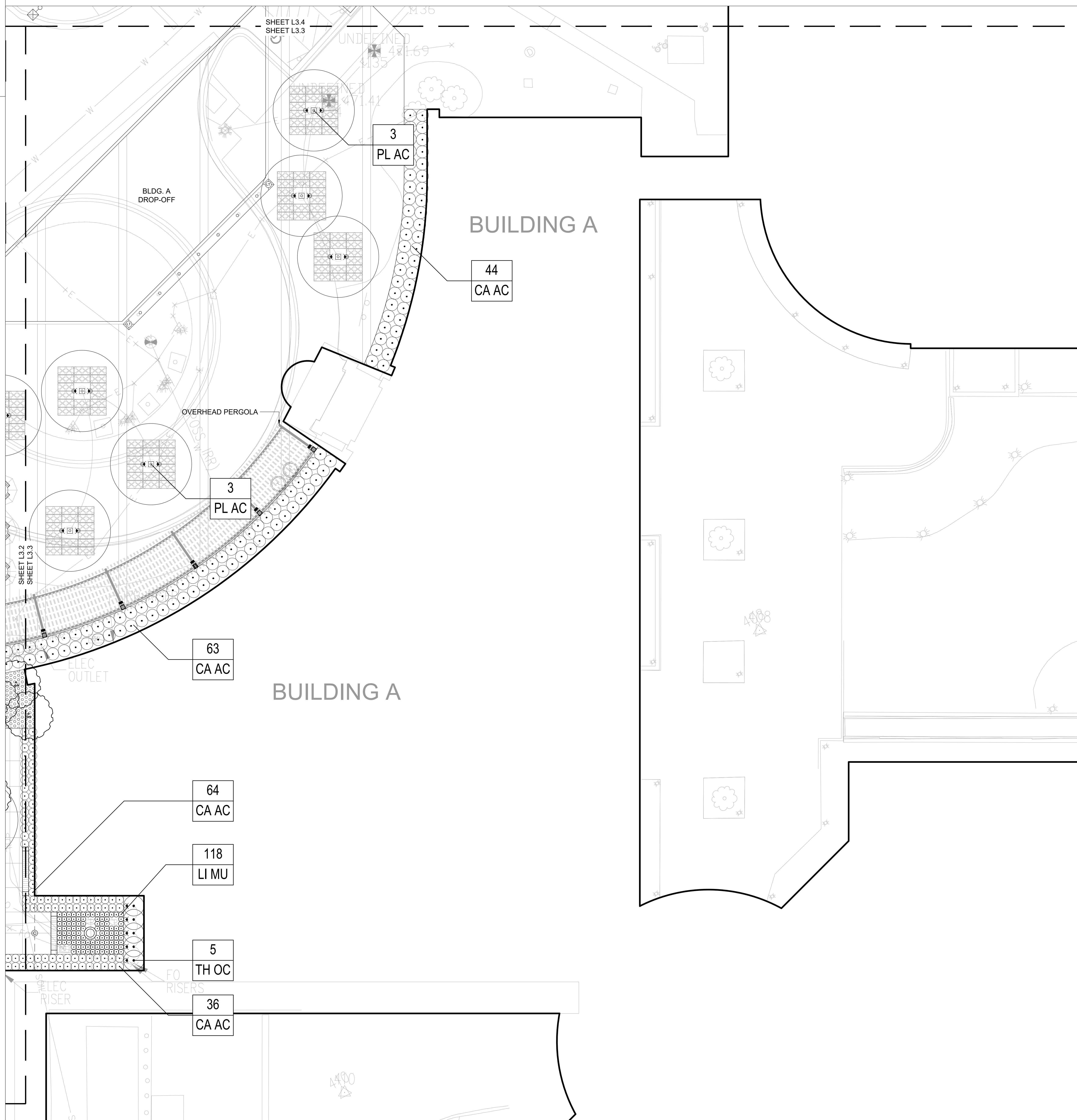

Contract No. EWINGCOLE
CONSULTANTS
CIVIL SITE ENGINEERS
 55A TICE ENGINEERING
 2 River Road, Suite 100
 Pikesville, MD 21110
 Phone: 410-644-3700
LAND PLANNERS & LANDSCAPE ARCHITECTS:
 W&P
 405 South Lenoir Alley
 Columbia, MD 21046
 Phone: 410-621-2700
STRUCTURAL ENGINEERS:
 F&J
 815 Light Street
 Baltimore, MD 21202
 Phone: 410-781-1800
M&P ENGINEERS:
 JENSEN ENGINEERING, INC.
 8817 Forest Road
 Nottingham, MD 21078
 Phone: 410-831-1300
SUSTAINABILITY CONSULTANTS:
 LOWE PARTNERSHIP, LLC
 100 Light Street
 Baltimore, MD 21202
 Phone: 410-681-0100

KEY PLAN

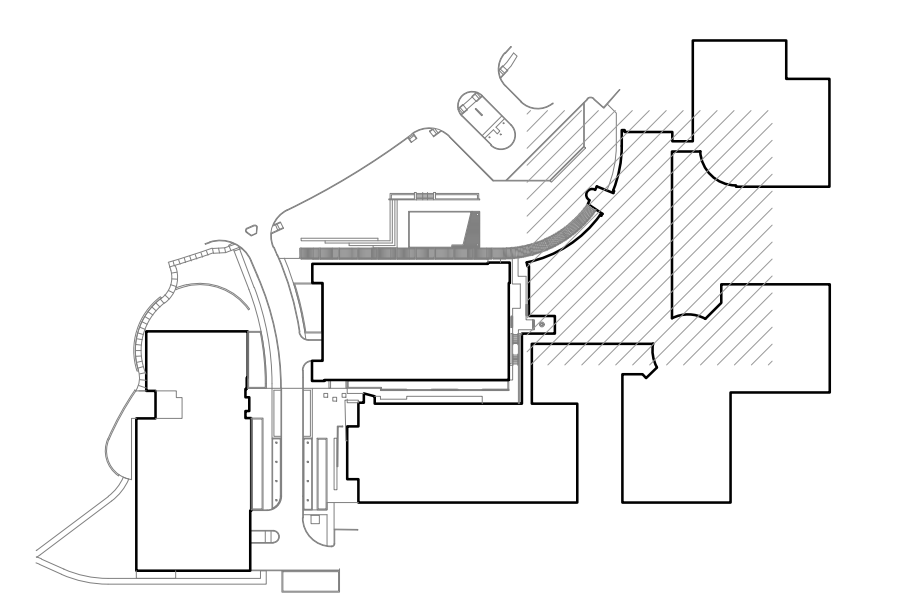

PRINCIPAL
 ANDY KNIGHT, PLA
 PROJECT MANAGER
 RICK ESPE, PLA
 Professional Certification: I certify that these documents were prepared or approved by me, and that I am a duly licensed landscape architect under the laws of the State of Maryland.
 License No: 01-4188 Expiration Date: 01/26/23

REVISIONS

NO.	BY	DESCRIPTION	DATE

SITE PLAN AMENDMENT G:
81995045G
9800 MEDICAL CENTER DRIVE

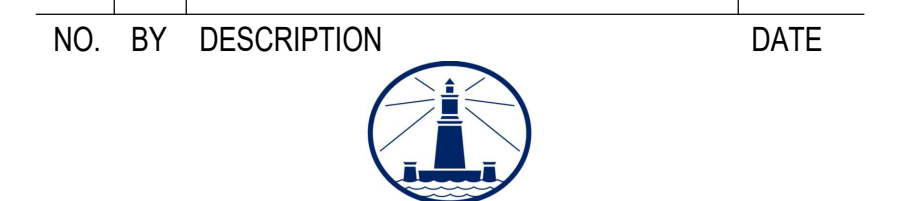

ALEXANDRIA
 ALEXANDRIA REAL ESTATE EQUITIES, INC

9800 MEDICAL CENTER DRIVE
BUILDING E & PARKING DECK
 ROCKVILLE, MD 20850

SITE PLAN 81995045G

DEVELOPER'S CERTIFICATE
 The Undersigned agrees to execute all the features of the Site Plan Approval No. 81995045G, including Approval Conditions, Development Program and Certified Site Plan.
 Developer's Name: ARE-Maryland No.24, LLC. William DePippo
 Company Contact Person
 Address: 946 Clopper Road, Gaithersburg, MD 20878
 Phone: 301-947-1770
 Signature: _____

DRAWN BY	DB	DATE	02-19-2021
PROJECT NO.	SCALE		
DRAWING NAME	LANDSCAPE PLAN		
FLOOR/SECTION/PHASE	DD	DRAWING NO.	L3.3

