

Contract No. EWINGCOLE

CONSULTANTS
CIVIL SITE ENGINEERS:
D&L ENGINEERING, INC.
2700 E. Joppa Road, Suite 100
Baltimore, MD 21286
Phone: 301-944-3700

LAND PLANNERS & LANDSCAPE ARCHITECTS:
W&P
405 South Lenoir Alley
Columbia, MD 21045
Phone: 410-321-2700

STRUCTURAL ENGINEERS:
F&J ENGINEERING, INC.
814 Light Street
Baltimore, MD 21202
Phone: 410-781-1800

M&P ENGINEERS:
J&M ENGINEERING, INC.
8815 Forest Road
Hagerstown, MD 21758
Phone: 410-391-1300

SUSTAINABILITY CONSULTANTS:
LOWE PARTNERSHIP, LLC
1000 Light Street
Baltimore, MD 21202
Phone: 410-681-0100

PLANNING DEPARTMENT USE ONLY (E-PLANS)

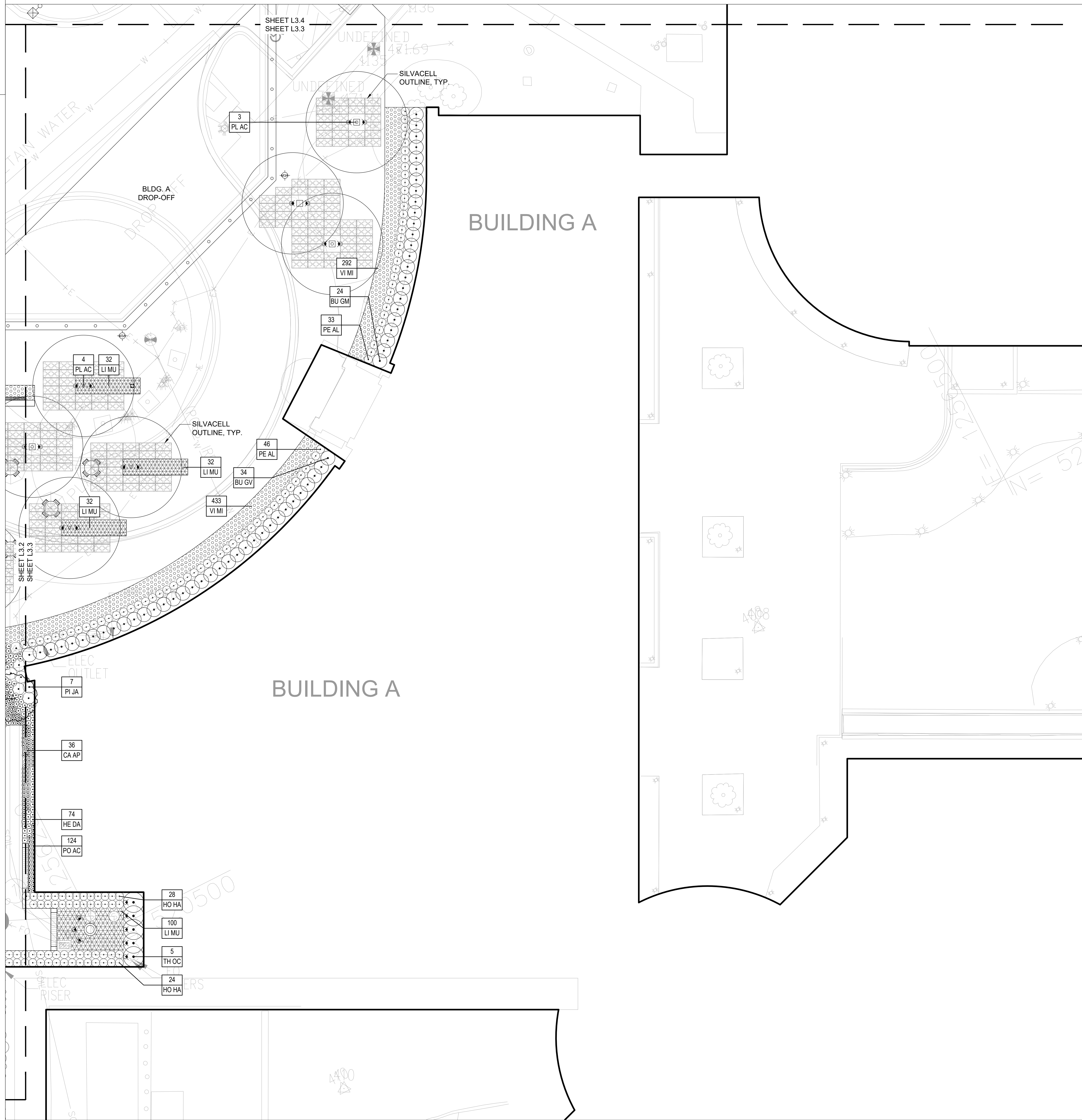

KEY PLAN

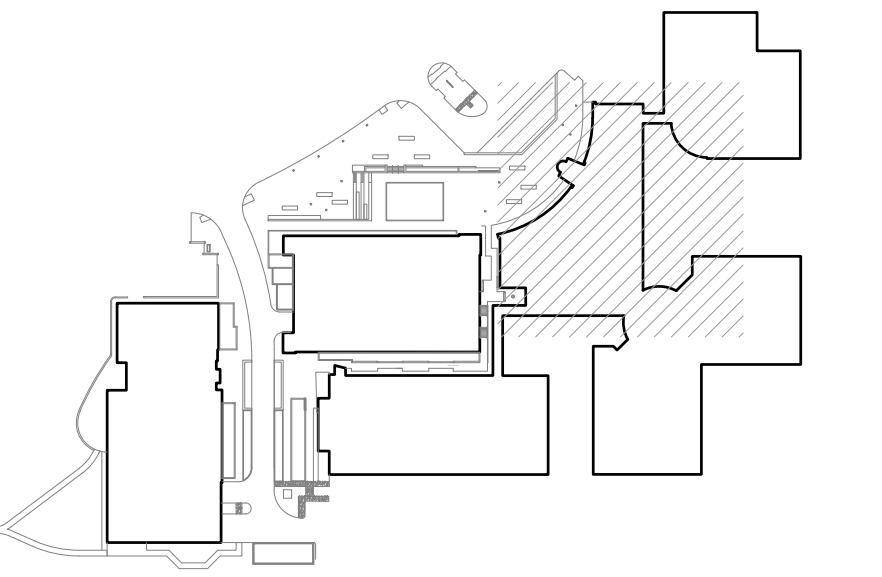

PRINCIPAL:
ANDY KNIGHT, PLA
PROJECT MANAGER:
RICK ESPE, PLA

Professional Certification: I certify that these documents were prepared or approved by me, and that I am a duly licensed landscape architect under the laws of the State of Maryland.
License No: 01-4189 Expiration Date: 01/26/23

REVISIONS

NO.	BY	DESCRIPTION	DATE

SITE PLAN AMENDMENT G:
81995045G
9800 MEDICAL CENTER DRIVE

SITE PLAN 81995045G

DEVELOPER'S CERTIFICATE
The Undersigned agrees to execute all the features of the Site Plan Approval No. 81995045G, including Approval Conditions, Development Program and Certified Site Plan.
Developer's Name: ARE-Maryland No.24, LLC. William DePippo
Company Contact Person
Address: 946 Clopper Road, Gaithersburg, MD 20878
Phone: 301-947-1770
Signature: _____

ALEXANDRIA
ALEXANDRIA REAL ESTATE EQUITIES, INC
9800 MEDICAL CENTER DRIVE
BUILDING E & PARKING DECK

ROCKVILLE, MD 20850
DRAWN BY: DB DATE: 02-19-2021
PROJECT NO.: SCALE:
DRAWING NAME:
LANDSCAPE PLAN
FLOOR/SECTION/PHASE: DD DRAWING NO.: L3.3

