

Contract No. 19-0000000000  
CONSULTANTS  
EWING COLE  
CIVIL SITE ENGINEERS  
55A TIGER CREEK ROAD  
2 FLOOR SUITE 200  
ROCKVILLE, MD 20850  
PHONE: 301-947-1770  
FAX: 301-947-1770  
LAND PLANNERS & LANDSCAPE ARCHITECTS:  
WILLIAM DEPIPPO  
450 SOUTH LEXINGTON AVENUE  
COLUMBIA, SC 29201  
PHONE: 803-732-1234  
STRUCTURAL ENGINEERS:  
FALSBY ENGINEERS, INC.  
815 LIGHT STREET  
BALTIMORE, MD 21202  
PHONE: 410-781-1888  
MECHANICAL ENGINEERS:  
JENSEN ENGINEERING, INC.  
8815 TOWN HALL  
HAGERSTOWN, MD 21048  
PHONE: 410-391-1300  
SUSTAINABILITY CONSULTANTS:  
LOWE PARTNERSHIP, LLC  
3000 GAITHERSBURG ROAD  
GAITHERSBURG, MD 20878  
PHONE: 410-488-0100

PLANNING DEPARTMENT USE ONLY (E-PLANS)

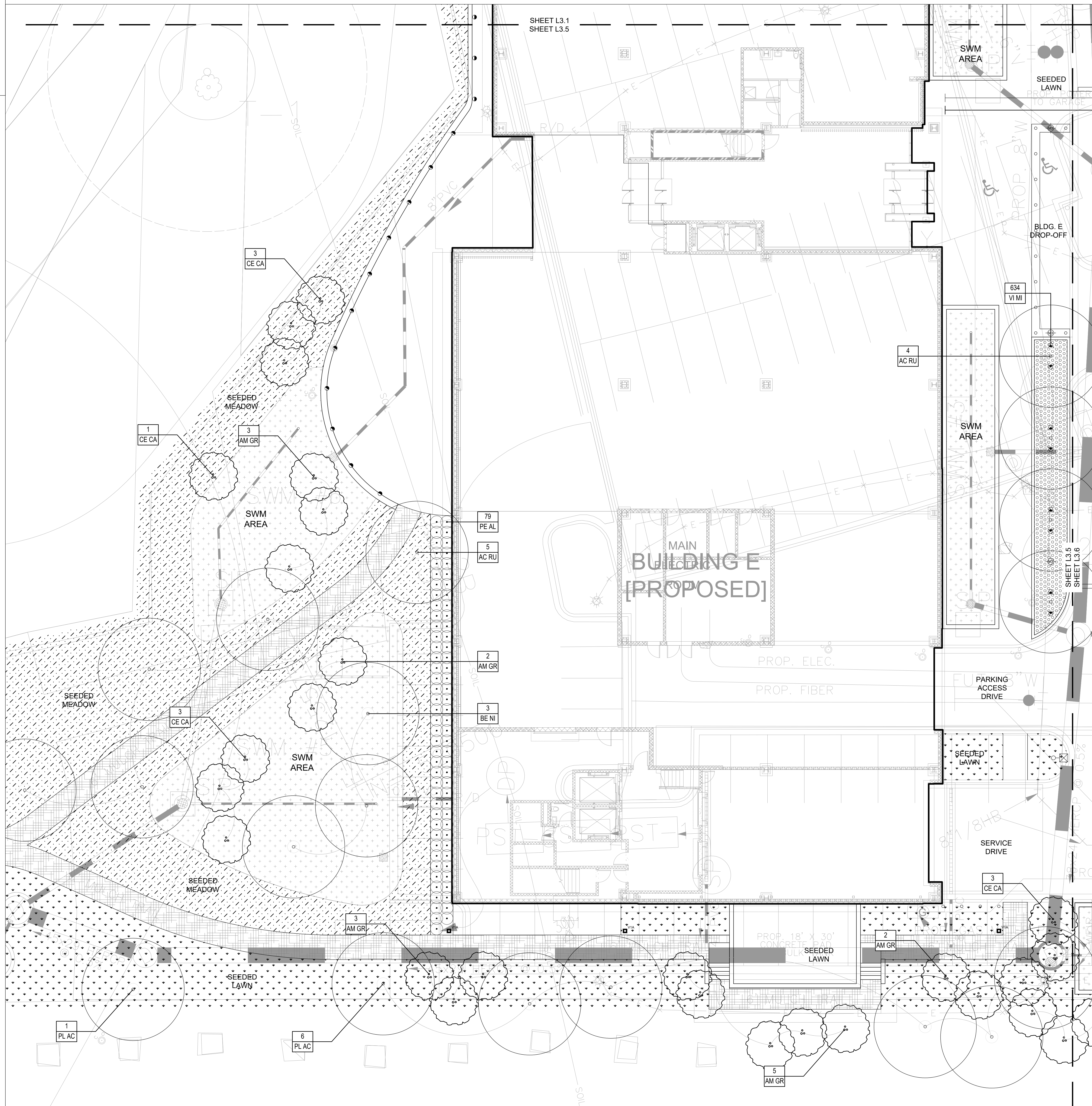

KEY PLAN

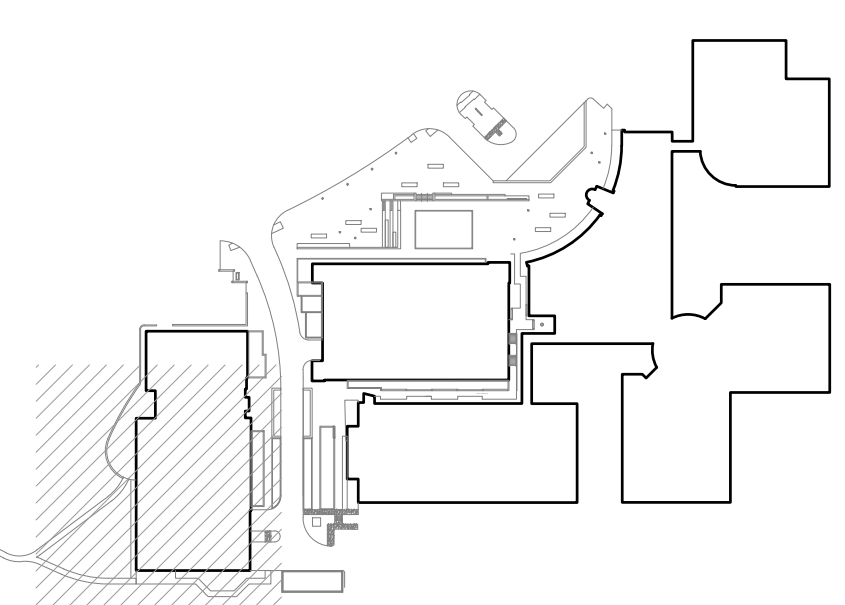

PRINCIPAL  
ANDY KNIGHT, PLA  
PROJECT MANAGER  
RICK ESPE, PLA  
Professional Certification: I certify that these documents were prepared or approved by me, and that I am a duly licensed landscape architect under the laws of the State of Maryland.  
License No: 01-14189 Expiration Date: 01/26/23

REVISIONS

NO.	BY	DESCRIPTION	DATE

**SITE PLAN AMENDMENT G:**  
**81995045G**  
**9800 MEDICAL CENTER DRIVE**

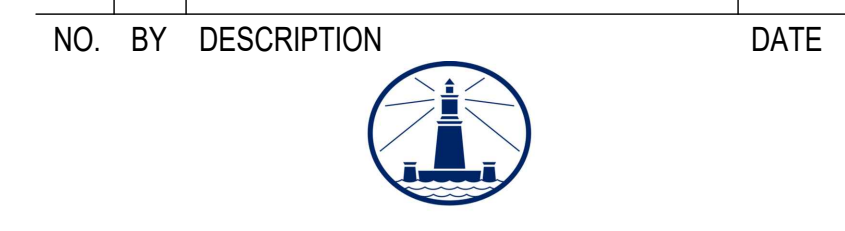

**ALEXANDRIA**  
ALEXANDRIA REAL ESTATE EQUITIES, INC

**9800 MEDICAL CENTER DRIVE  
BUILDING E & PARKING DECK**

ROCKVILLE, MD 20850

**SITE PLAN 81995045G**

**DEVELOPER'S CERTIFICATE**  
The Undersigned agrees to execute all the features of the Site Plan Approval No. 81995045G, including Approval Conditions, Development Program and Certified Site Plan.  
Developer's Name: ARE-Maryland No.24, LLC. William DePippo  
Company Contact Person  
Address: 946 Clopper Road, Gaithersburg, MD 20878  
Phone: 301-947-1770  
Signature: \_\_\_\_\_

DRAWN BY	DB	DATE	02-19-2021
PROJECT NO.	SCALE		
DRAWING NAME			
LANDSCAPE PLAN			
FLOOR/SECTION/PHASE	DRAWING NO.		L3.5
DD			

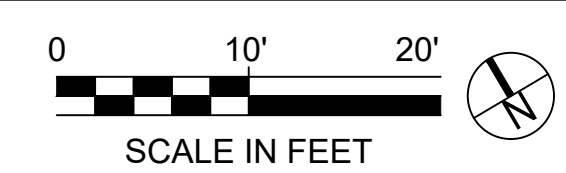

0-94-0921  
WEL