

Contract No. 81995045G
CONSULTANTS
CIVIL SITE ENGINEERS:
 SA TOC ENGINEERING
 2000 E. JONES ROAD, SUITE 100
 ROCKVILLE, MD 20850
 Phone: 301-948-3333
LAND PLANNERS & LANDSCAPE ARCHITECTS:
 W&P
 405 South Lorton Alley
 COLLEGE PARK, MD 20740
 Phone: 410-271-2700
STRUCTURAL ENGINEERS:
 F&S ENGINEERING, INC.
 815 Light Street
 Baltimore, MD 21202
 Phone: 410-516-1800
MERFF ENGINEERS:
 JENKINS ENGINEERING, INC.
 8817 Forest Road
 HAGERSTOWN, MD 21048
 Phone: 410-313-1300
SUSTAINABILITY CONSULTANTS:
 LOWE PARTNERSHIP, LLC
 10000 Green
 Baltimore, MD 21210
 Phone: 410-488-0100

PLANNING DEPARTMENT USE ONLY (E-PLANS)

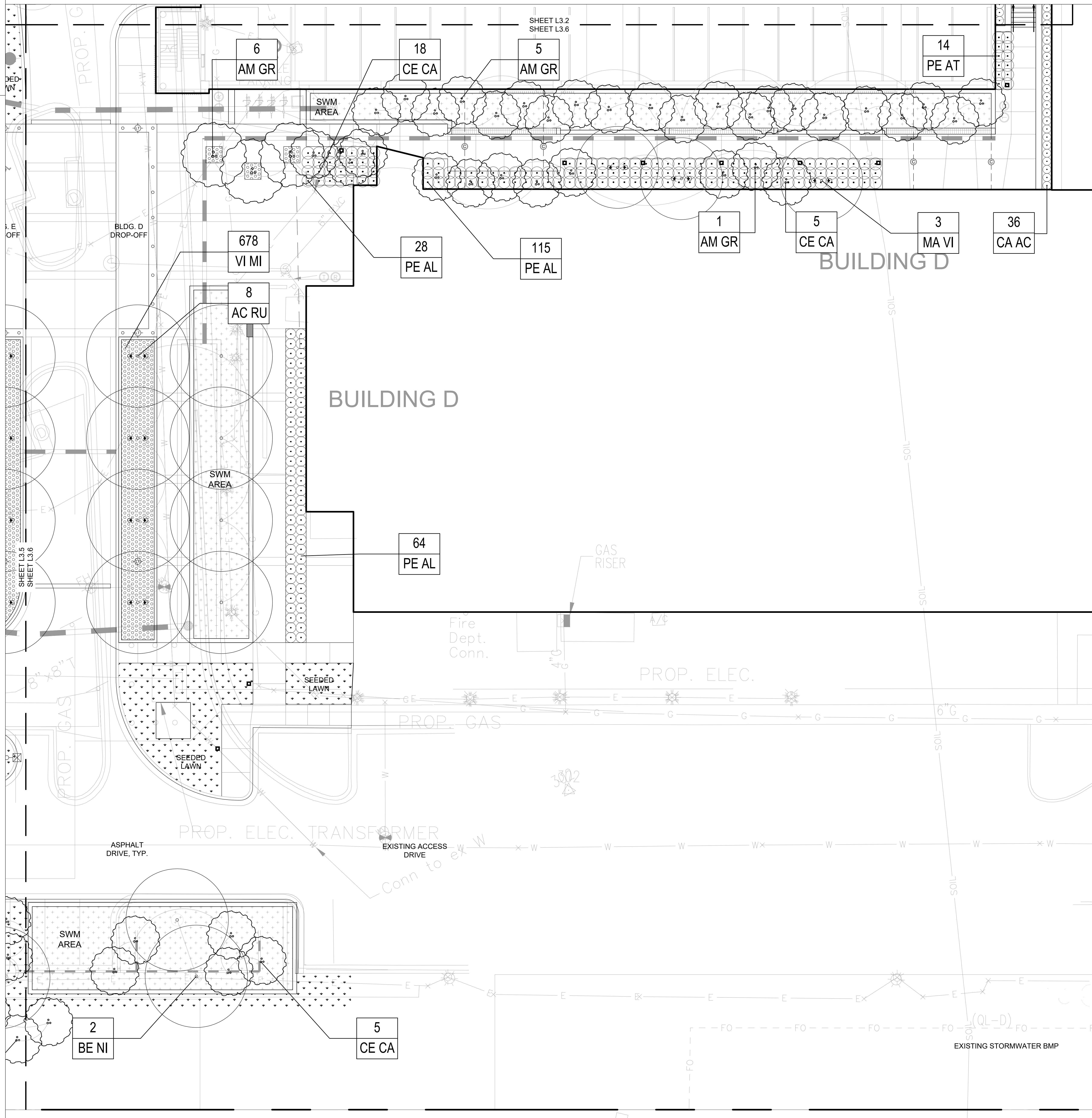

KEY PLAN

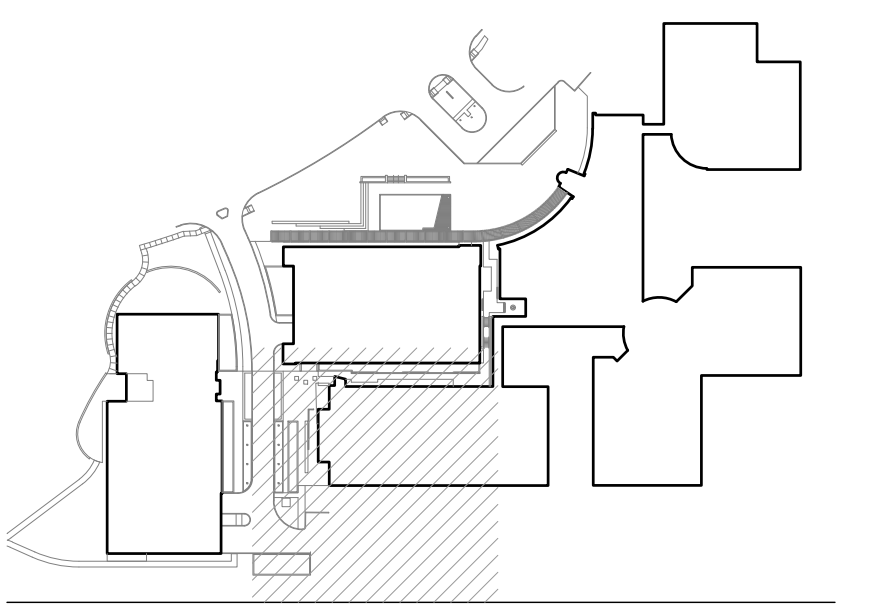

PRINCIPAL:
ANDY KNIGHT, PLA
PROJECT MANAGER:
RICK ESPE, PLA

Professional Certification: I certify that these documents were prepared or approved by me, and that I am a duly licensed landscape architect under the laws of the State of Maryland.
 License No: 01-4189 Expiration Date: 01/26/23

REVISIONS

NO.	BY	DESCRIPTION	DATE

SITE PLAN AMENDMENT G:
81995045G
9800 MEDICAL CENTER DRIVE

SITE PLAN 81995045G

DEVELOPER'S CERTIFICATE
 The Undersigned agrees to execute all the features of the Site Plan Approval No. 81995045G, including Approval Conditions, Development Program and Certified Site Plan.
 Developer's Name: ARE-Maryland No.24, LLC. William DePippo
 Company Contact Person
 Address: 946 Clopper Road, Gaithersburg, MD 20878
 Phone: 301-947-1770
 Signature: _____

ALEXANDRIA
 ALEXANDRIA REAL ESTATE EQUITIES, INC
9800 MEDICAL CENTER DRIVE
BUILDING E & PARKING DECK
 ROCKVILLE, MD 20850

DRAWN BY: DB **DATE:** 02-19-2021
PROJECT NO.: _____ **SCALE:** _____
DRAWING NAME: LANDSCAPE PLAN
FLOOR/SECTION/PHASE: DD **DRAWING NO.:** L3.6