

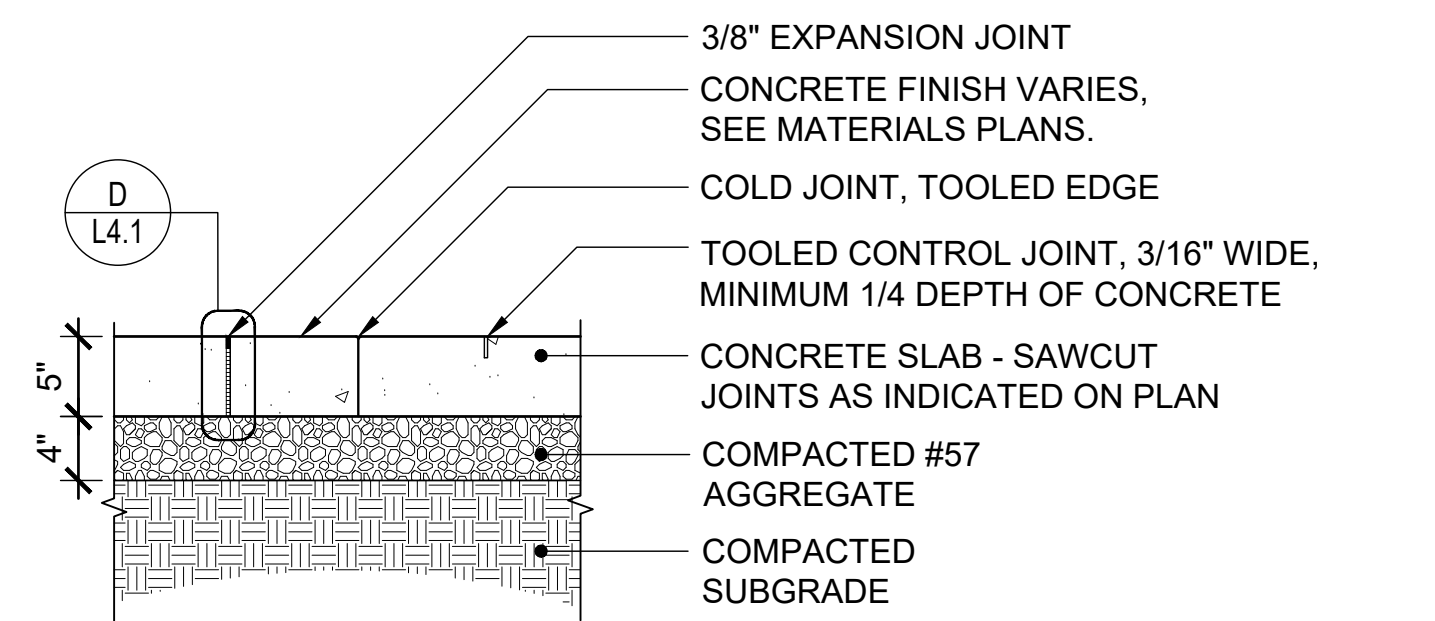

CONCRETE PAVING, TYP.

PLANNING DEPARTMENT USE ONLY (E-PLANS)



**A STANDARD CONCRETE**  
1'0" 1'6" 1'1" 1'2" TYPICAL SECTION

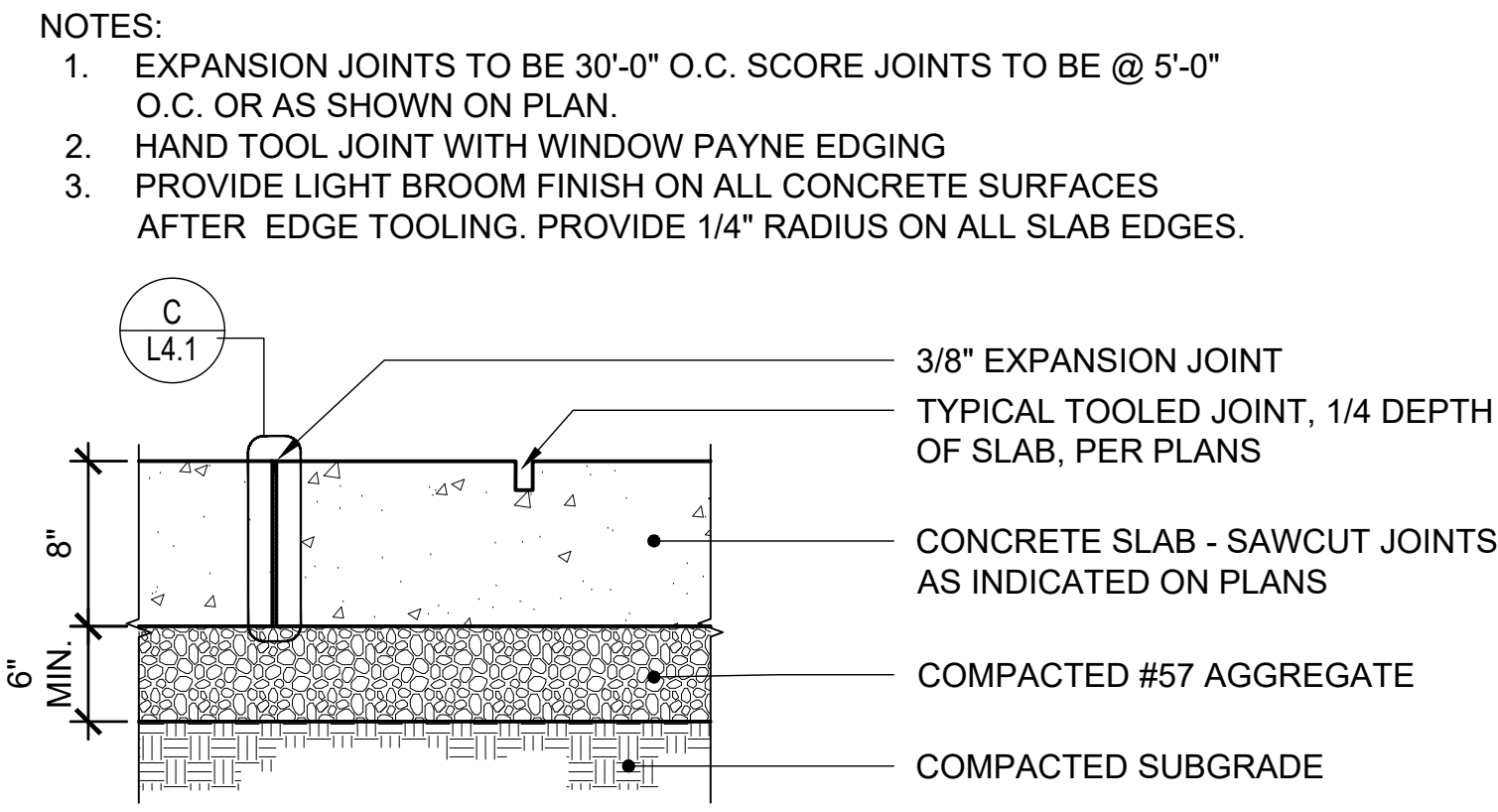

**B HEAVY DUTY CONCRETE PAVEMENT**  
1'0" 1'6" 1'1" 1'2" TYPICAL SECTION



STANDARD PAVERS, TYP.

NOTES:  
1. X = PAVER THICKNESS, VARIES PER PAVER TYPE. SEE PLANS FOR PAVER SPECIFICATION SCHEDULE.

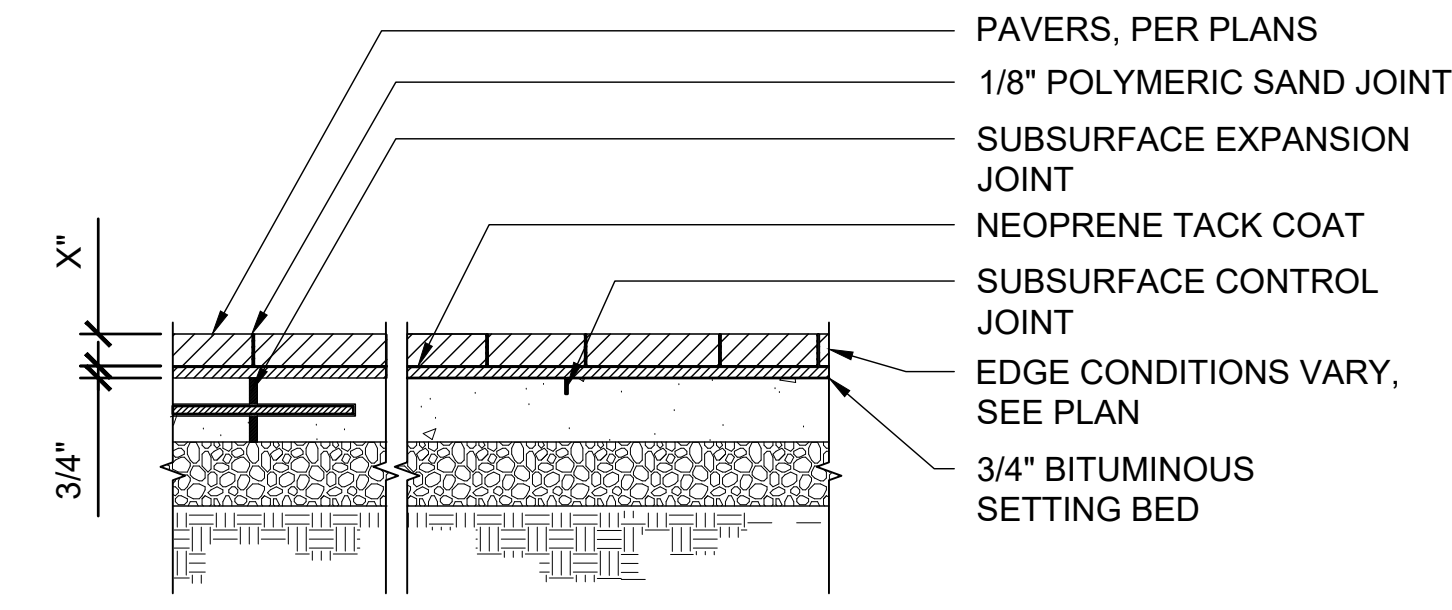

**C STANDARD PAVER**  
1'0" 1'6" 1'1" 1'2" TYPICAL SECTION

NOTE: SEE LAYOUT PLANS FOR EXPANSION JOINT LOCATIONS.

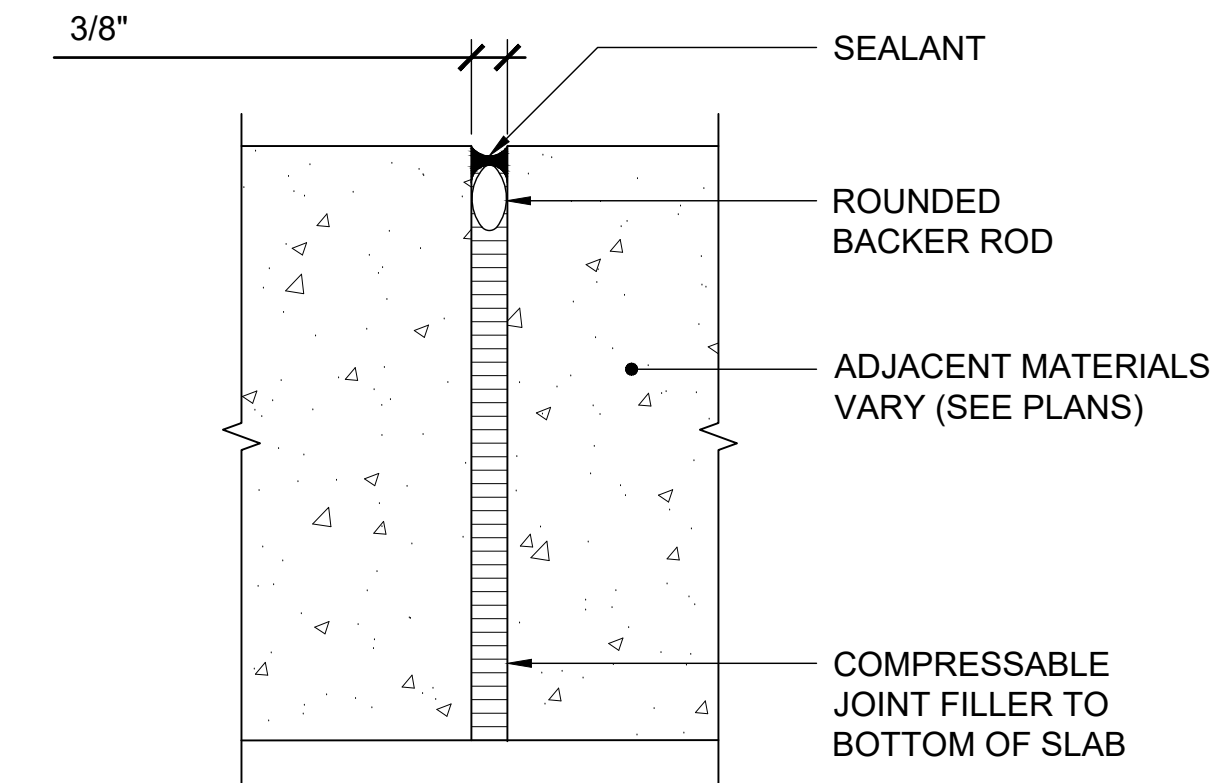

**D EXPANSION JOINT**  
1'0" 1'2" 1'4" 1'8"

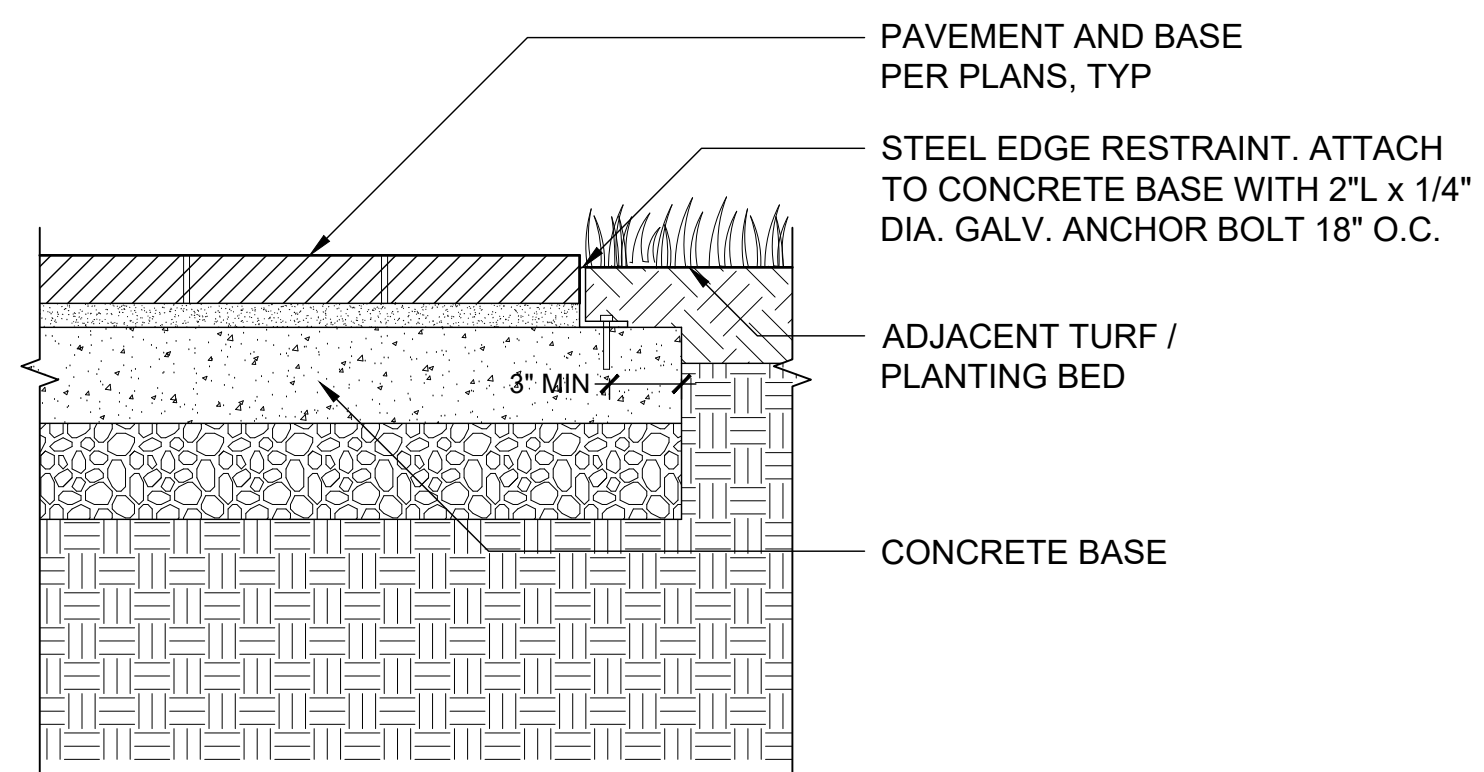

**E PAVER EDGE RESTRAINT**  
1'0" 1'4" 1'8" 1'1'-4" TYPICAL SECTION

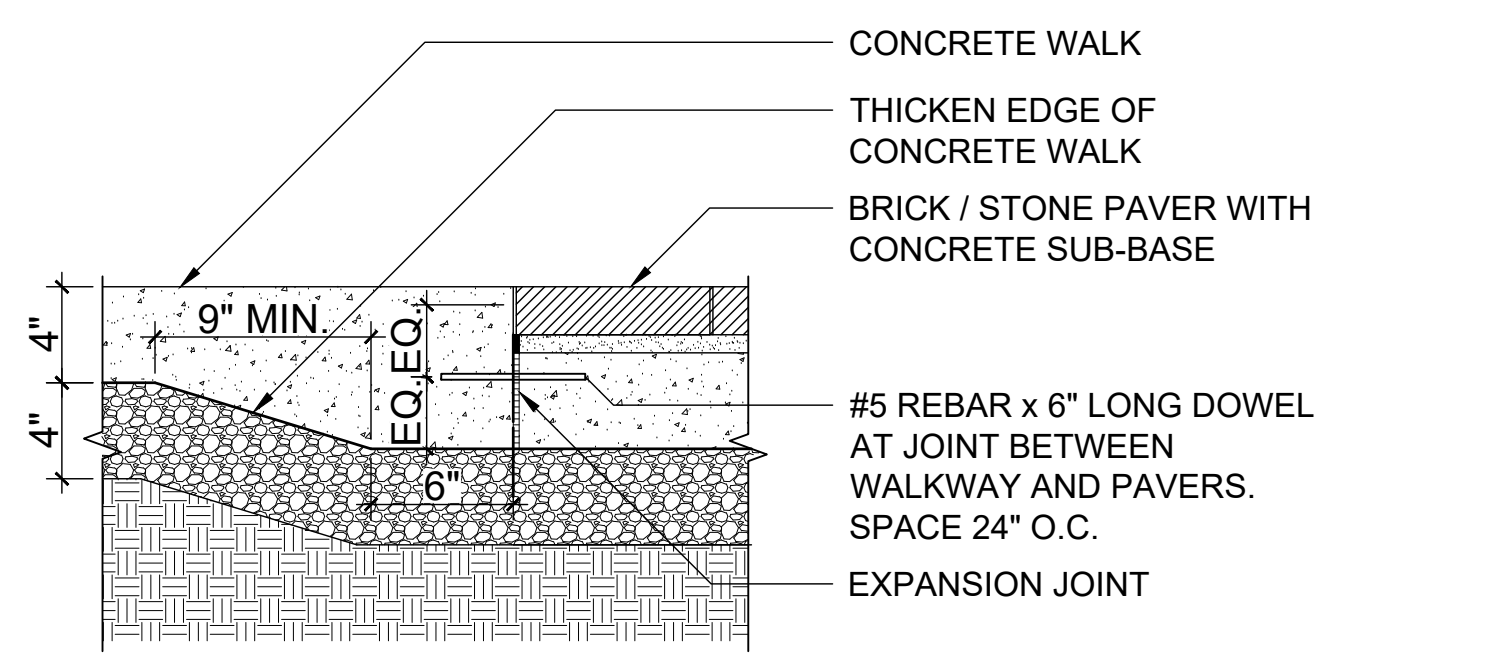

**F EXPANSION JOINT TO BRICK / STONE PAVEMENT**  
1'0" 1'4" 1'8" 1'1'-4" TYPICAL SECTION

Consultants: EWINGCOLE  
**CONSULTANTS**  
**CIVIL SITE ENGINEERS**  
59A TIGER CREEK ROAD  
2 NUMBER 2000, SUITE 100  
ROCKVILLE, MD 20850  
Phone: 301-947-3300  
**LAND PLANNERS & LANDSCAPE ARCHITECTS:**  
WOLF  
405 South Lorton Alley  
Columbia, MD 21046  
Phone: 410-321-2700  
**STRUCTURAL ENGINEERS:**  
HARRY ANDERSON, INC.  
815 Light Street  
Baltimore, MD 21202  
Phone: 410-516-1800  
**MSEPP ENGINEERS:**  
JENKINS ENGINEERING, INC.  
8813 Timber Lake  
Hollywood, MD 20636  
Phone: 410-331-1300  
**SUSTAINABILITY CONSULTANTS:**  
LOWE PARTNERSHIPS, LLC  
1000 Light Street  
Baltimore, MD 21202  
Phone: 410-681-0100

KEY PLAN

PRINCIPAL  
ANDY KNIGHT, PLA  
PROJECT MANAGER  
RICK ESPE, PLA

Professional Certification: I certify that these documents were prepared or approved by me, and that I am a duly licensed landscape architect under the laws of the State of Maryland.  
License No: 01-4189 Expiration Date: 01/26/23

REVISIONS

NO.	BY	DESCRIPTION	DATE



**ALEXANDRIA**  
ALEXANDRIA REAL ESTATE EQUITIES, INC

9800 MEDICAL CENTER DRIVE  
BUILDING E & PARKING DECK

ROCKVILLE, MD 20850

**SITE PLAN AMENDMENT G:**  
**81995045G**  
**9800 MEDICAL CENTER DRIVE**

**SITE PLAN 81995045G**

**DEVELOPER'S CERTIFICATE**

The Undersigned agrees to execute all the features of the Site Plan Approval No. 81995045G, including Approval Conditions, Development Program and Certified Site Plan.

Developer's Name: ARE-Maryland No.24, LLC. William DePippo  
Company Contact Person

Address: 946 Clopper Road, Gaithersburg, MD 20878

Phone: 301-947-1770

Signature: \_\_\_\_\_

DRAWN BY \_\_\_\_\_ DB DATE 02-19-2021

PROJECT NO. \_\_\_\_\_ SCALE \_\_\_\_\_

DRAWING NAME \_\_\_\_\_

DETAILS \_\_\_\_\_

FLOOR/SECTION/PHASE \_\_\_\_\_ DRAWING NO. \_\_\_\_\_

**DD** **L4.1**