

Contract No. 19- EWINGCOLE

CONSULTANTS
CIVIL SITE ENGINEERS:
 55A TIGER CROWNING
 2 Towson Station, Suite 100
 Towson, MD 21286
 Phone: 410-288-3300
 Fax: 410-288-3303

LAND PLANNERS & LANDSCAPE ARCHITECTS:
 W&P
 405 East Lister Alley
 Columbia 21046
 Phone: 410-731-1891

STRUCTURAL ENGINEERS:
 F&J
 815 Light Street
 Baltimore, MD 21202
 Phone: 410-781-1891

MEDICAL ENGINEERS:
 JENSEN ENGINEERING, INC.
 8815 Forest Road
 Nottingham, MD 21058
 Phone: 410-331-1891

SUSTAINABILITY CONSULTANTS:
 LOWE PARTNERSHIPS, LLC
 1000 Light Street
 Baltimore, MD 21202
 Phone: 410-681-0100

PLANNING DEPARTMENT USE ONLY (E-PLANS)

NOTES:
 1. SEE MCD 111.02 FOR PAVERS IN R.O.W.

NOTE: SEE LAYOUT PLANS FOR EXPANSION JOINT LOCATIONS.

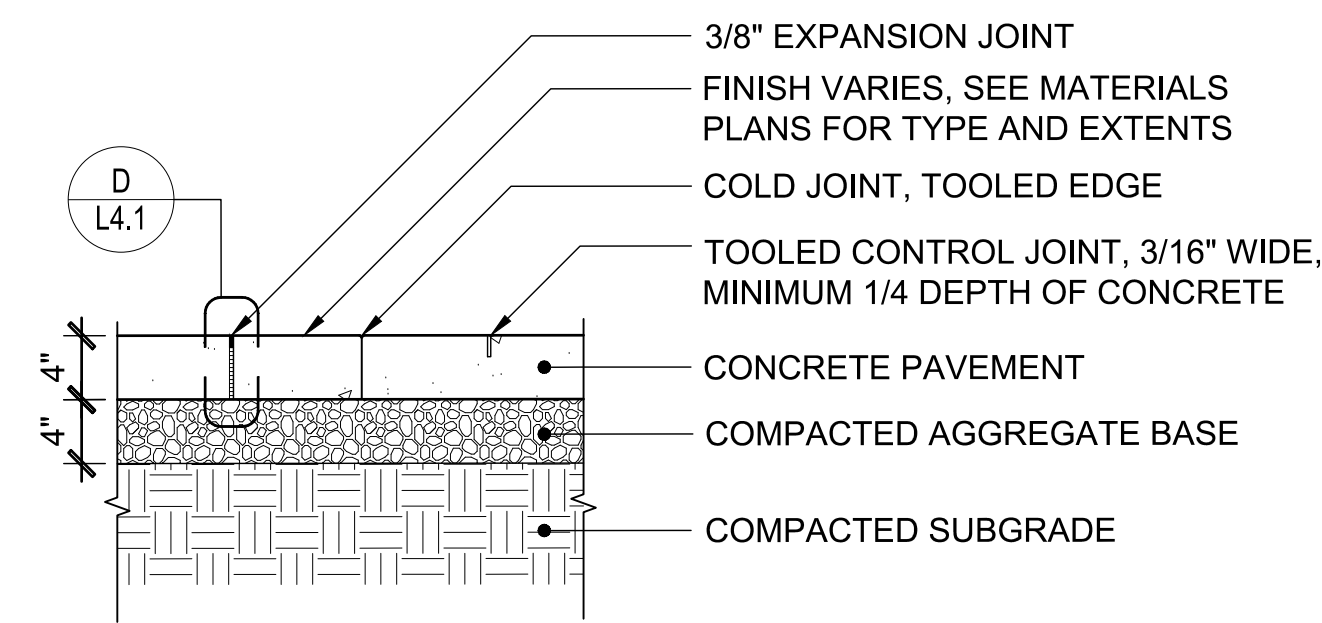

A CONCRETE PAVEMENT
 1/0 1/2" 1/1" 1/2" 1/2" TYPICAL SECTION

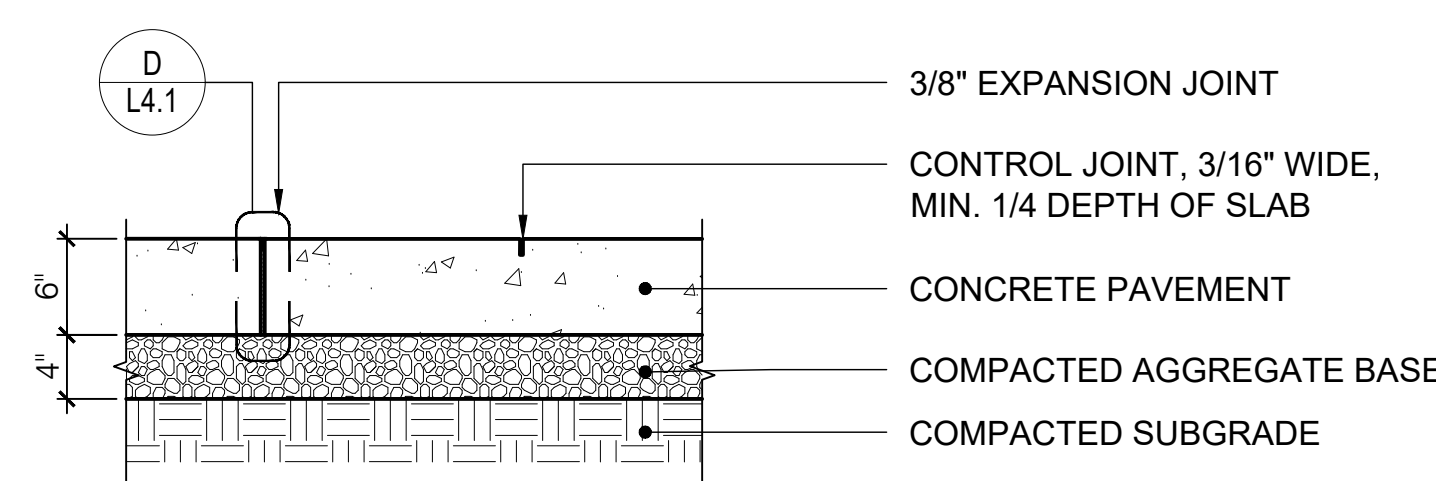

B HEAVY DUTY CONCRETE PAVING
 1/0 1/2" 1/1" 1/2" TYPICAL SECTION

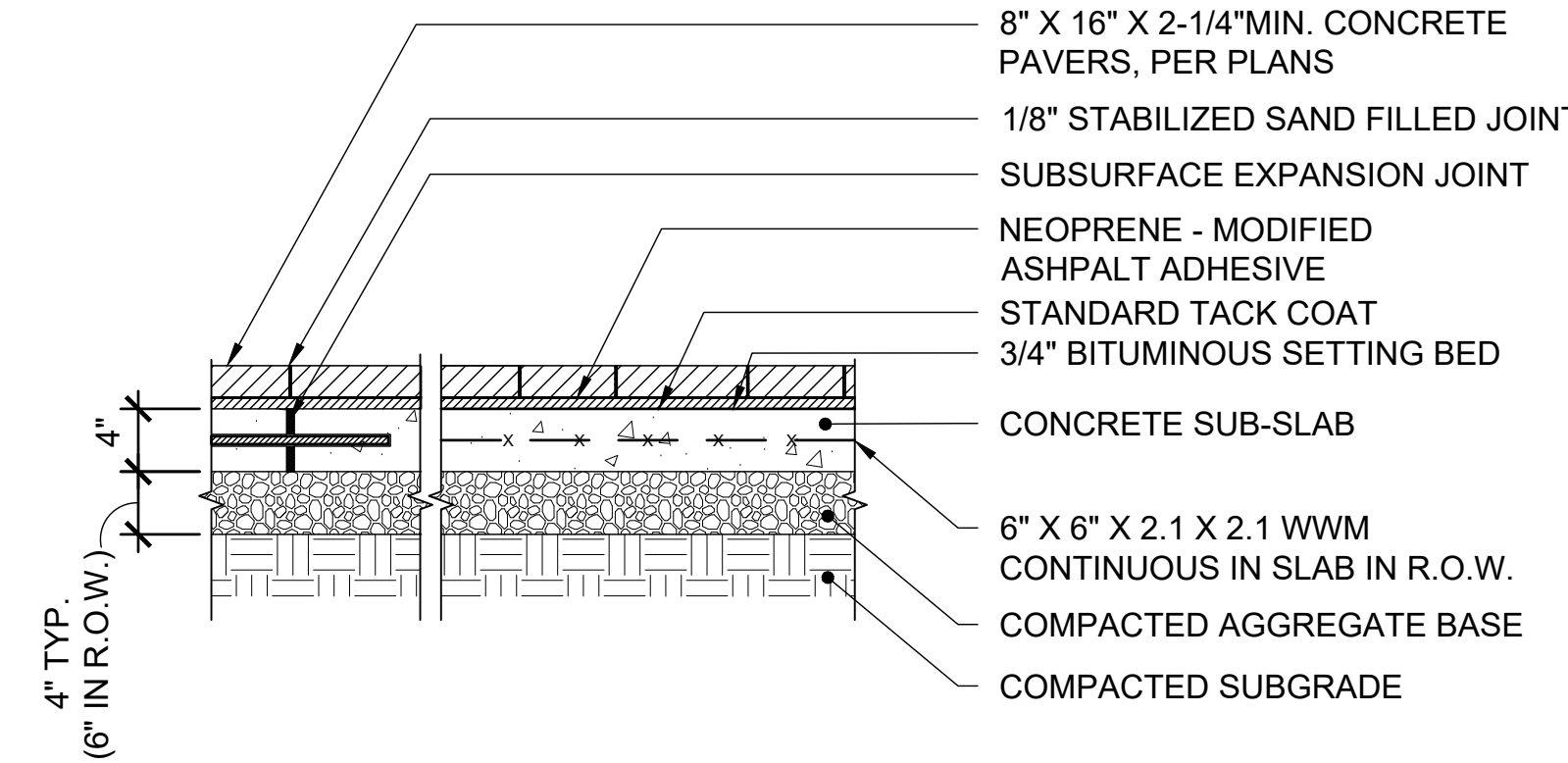

C PEDESTRIAN PAVERS
 1/0 1/2" 1/1" 1/2" TYPICAL SECTION

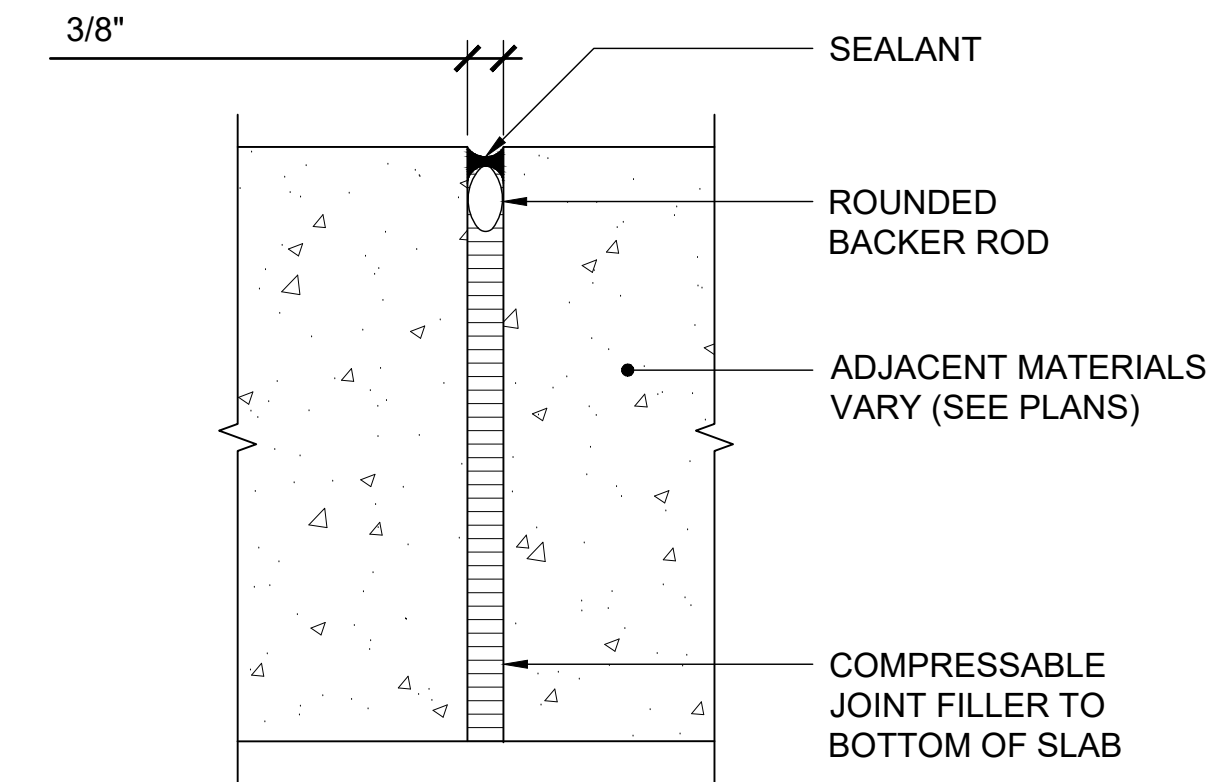

D EXPANSION JOINT
 1/0 1.5" 1.3" 1/6" TYPICAL SECTION

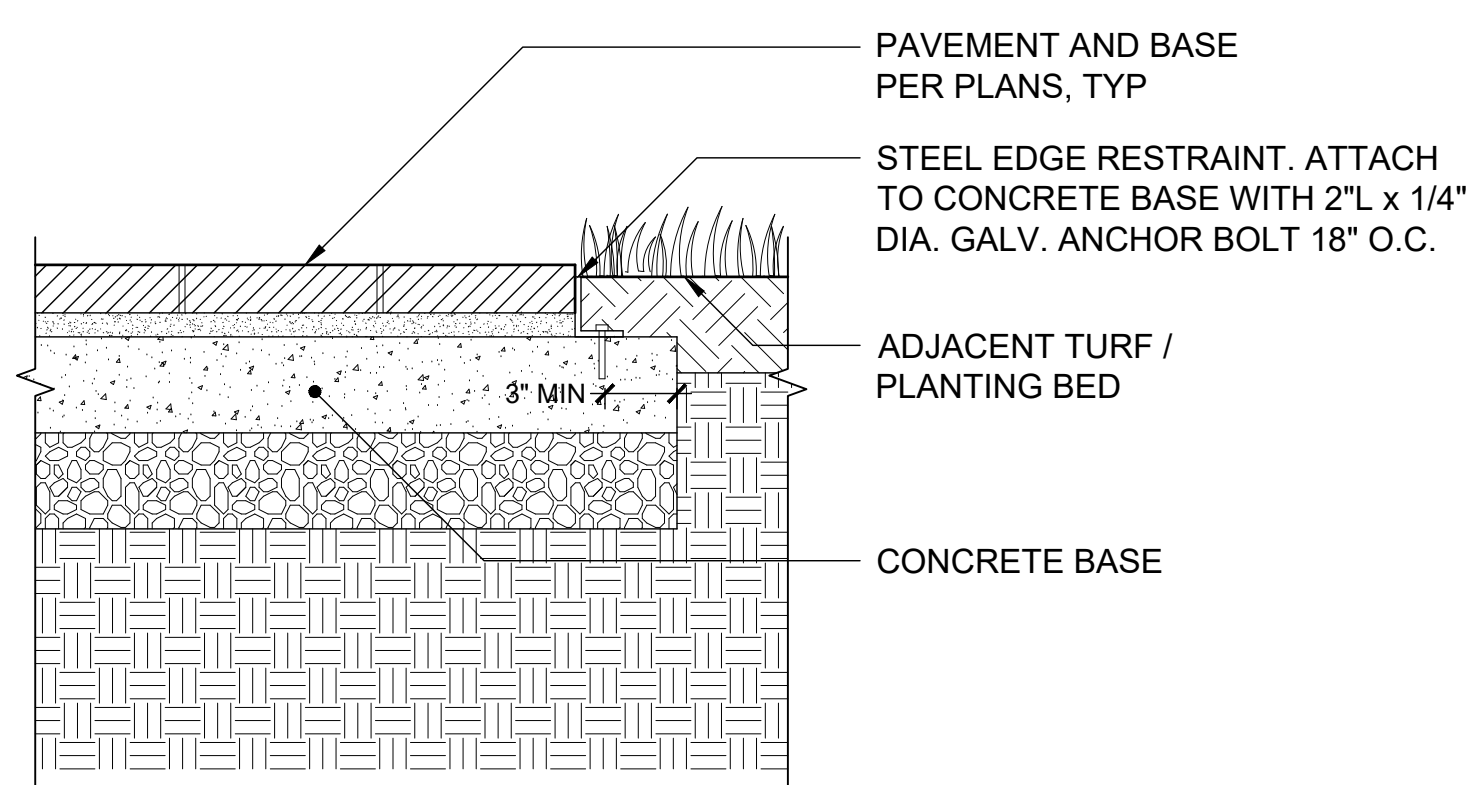

E PAVER EDGE RESTRAINT
 1/0 1/3/4" 1/1 1/2" 1/3" TYPICAL SECTION

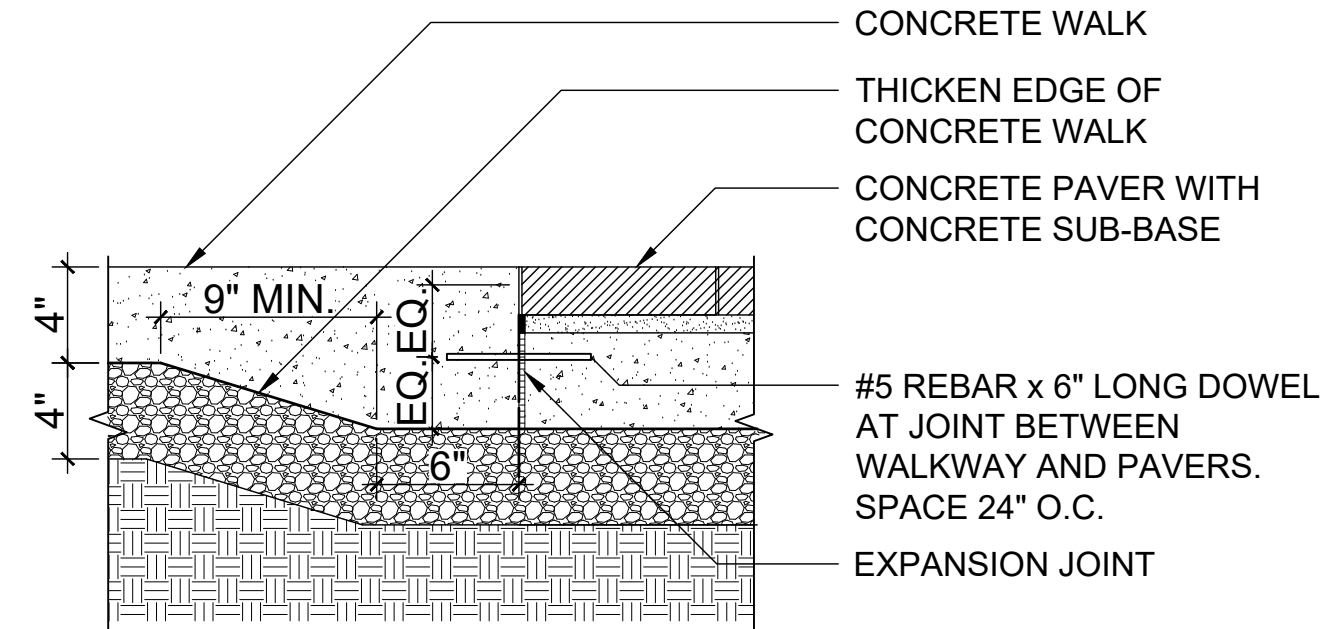

F PAVERS AT CONCRETE
 1/0 1/3/4" 1/1 1/2" 1/3" TYPICAL SECTION

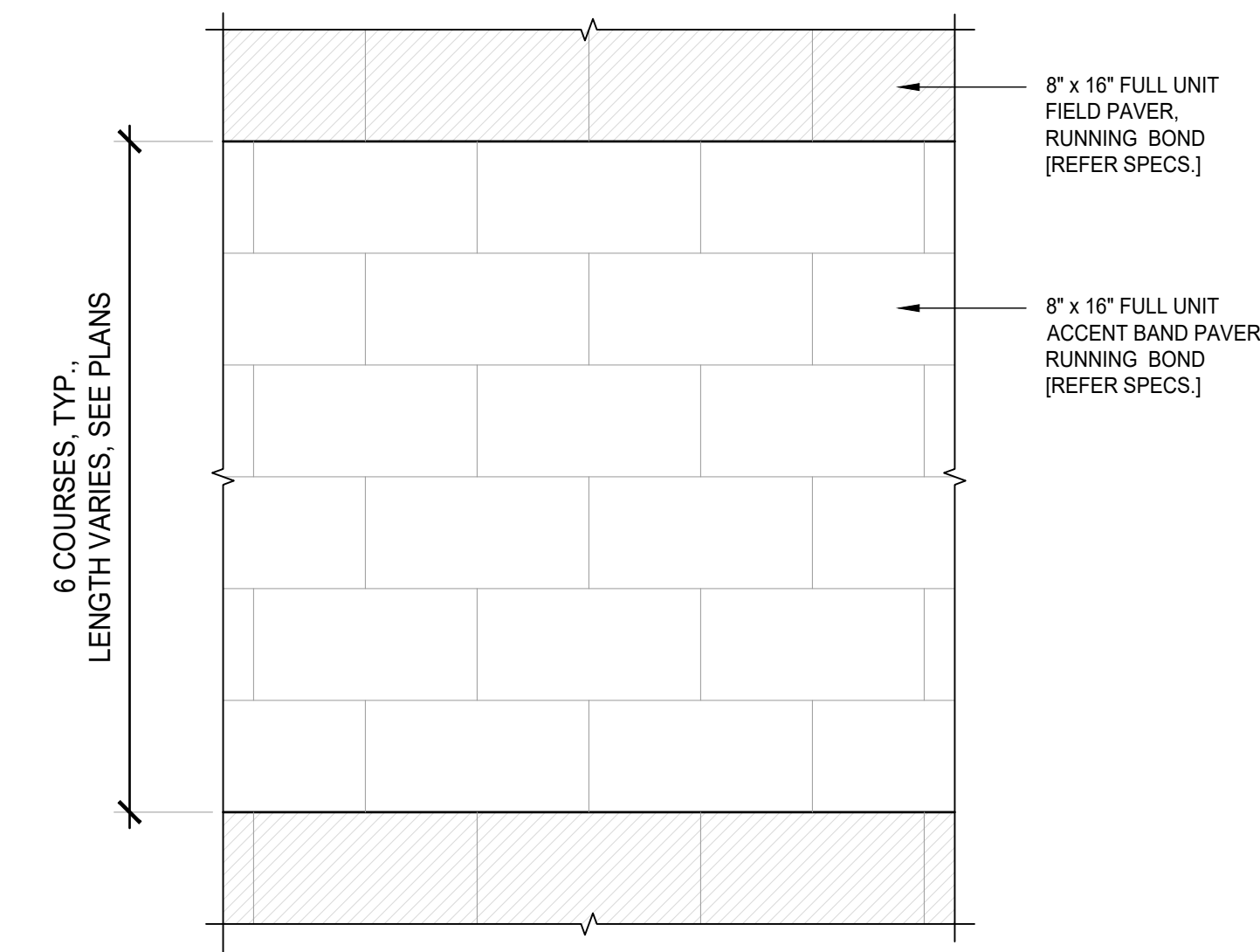

G UNIT PAVING - BANDING ENLARGEMENT
 1/0 1/6" 1/1" 1/2" PLAN TYPICAL

KEY PLAN

PRINCIPAL
 ANDY KNIGHT, PLA
 PROJECT MANAGER
 RICK ESPE, PLA

Professional Certification: I certify that these documents were prepared or approved by me, and that I am a duly licensed landscape architect under the laws of the State of Maryland.
 License No: 01-14189 Expiration Date: 01/26/23

REVISIONS

NO. BY DESCRIPTION DATE



ALEXANDRIA
 ALEXANDRIA REAL ESTATE EQUITIES, INC

9800 MEDICAL CENTER DRIVE
 BUILDING E & PARKING DECK

ROCKVILLE, MD 20850

SITE PLAN AMENDMENT G:
81995045G
9800 MEDICAL CENTER DRIVE

SITE PLAN 81995045G

DEVELOPER'S CERTIFICATE
 The Undersigned agrees to execute all the features of the Site Plan Approval No. 81995045G, including Approval Conditions, Development Program and Certified Site Plan.
 Developer's Name: ARE-Maryland No.24, LLC. William DePippo
 Company Contact Person

Address: 946 Clopper Road, Gaithersburg, MD 20878
 Phone: 301-947-1770
 Signature: _____

DRAWN BY DB DATE 02-19-2021

PROJECT NO. SCALE
 DRAWING NAME

DETAILS

FLOOR/SECTION/PHASE DRAWING NO.

DD **L4.1**

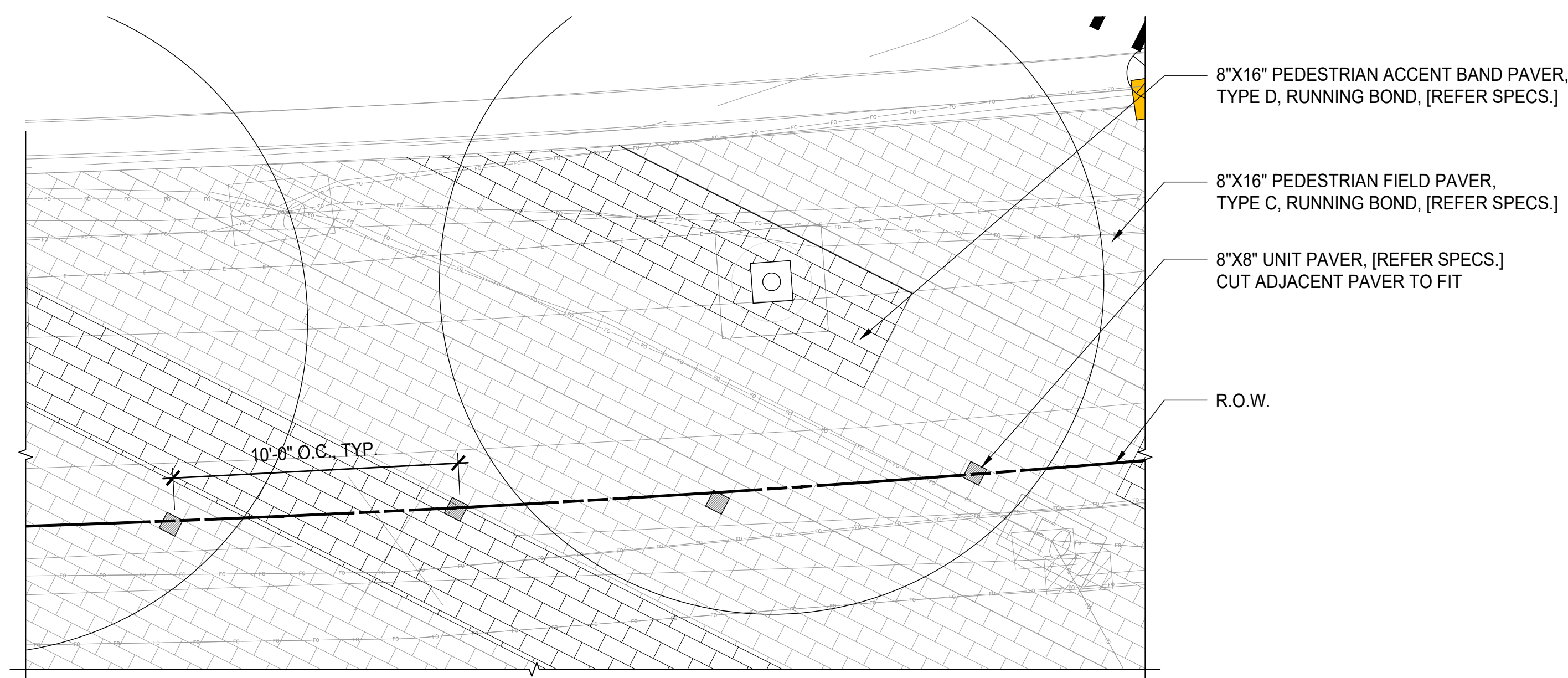

H R.O.W. DEMARCATION BAND
 1/0 1/8" 1/1/4" 1/1/2" PLAN

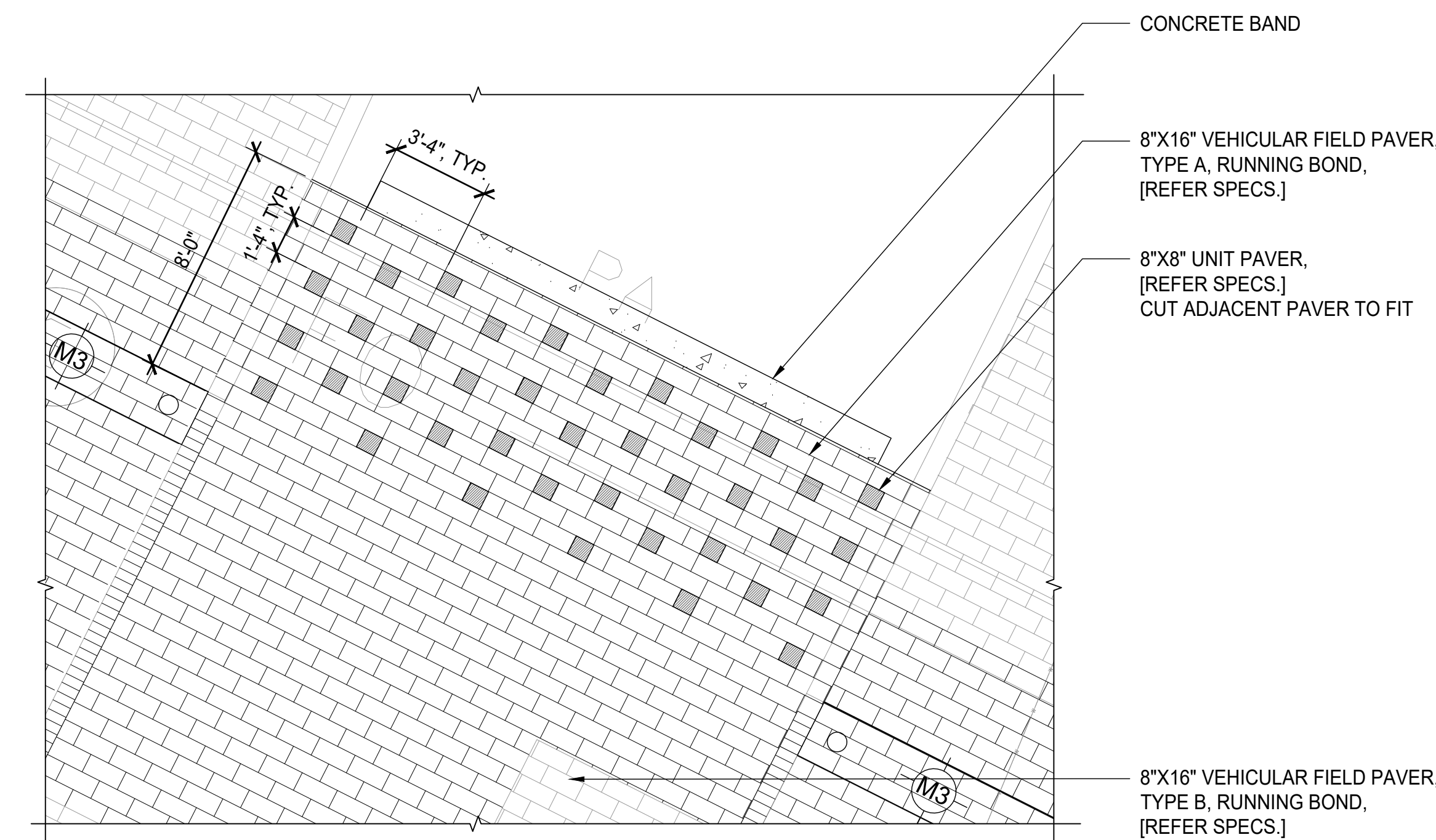

I CROSSWALK DEMARCATION PAVERS
 1/0 1/8" 1/1/4" 1/1/2" PLAN