

PLANNING DEPARTMENT USE ONLY (E-PLANS)

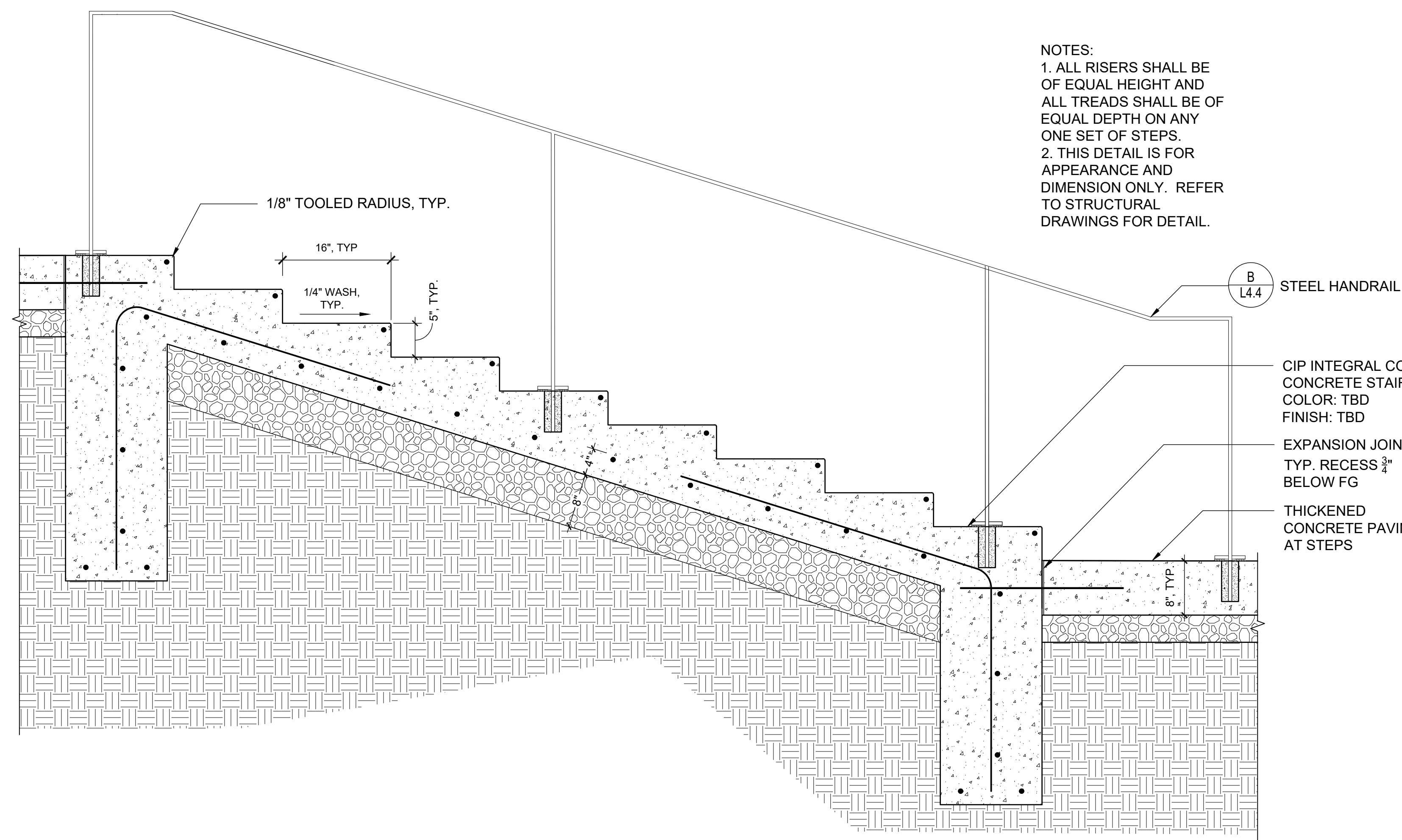

A CONCRETE STAIR 10 16 11 12 TYPICAL SECTION

NOTES:
1. ALL RISERS SHALL BE OF EQUAL HEIGHT AND ALL TREADS SHALL BE OF EQUAL DEPTH ON ANY ONE SET OF STEPS.
2. THIS DETAIL IS FOR APPEARANCE AND DIMENSION ONLY. REFER TO STRUCTURAL DRAWINGS FOR DETAIL.

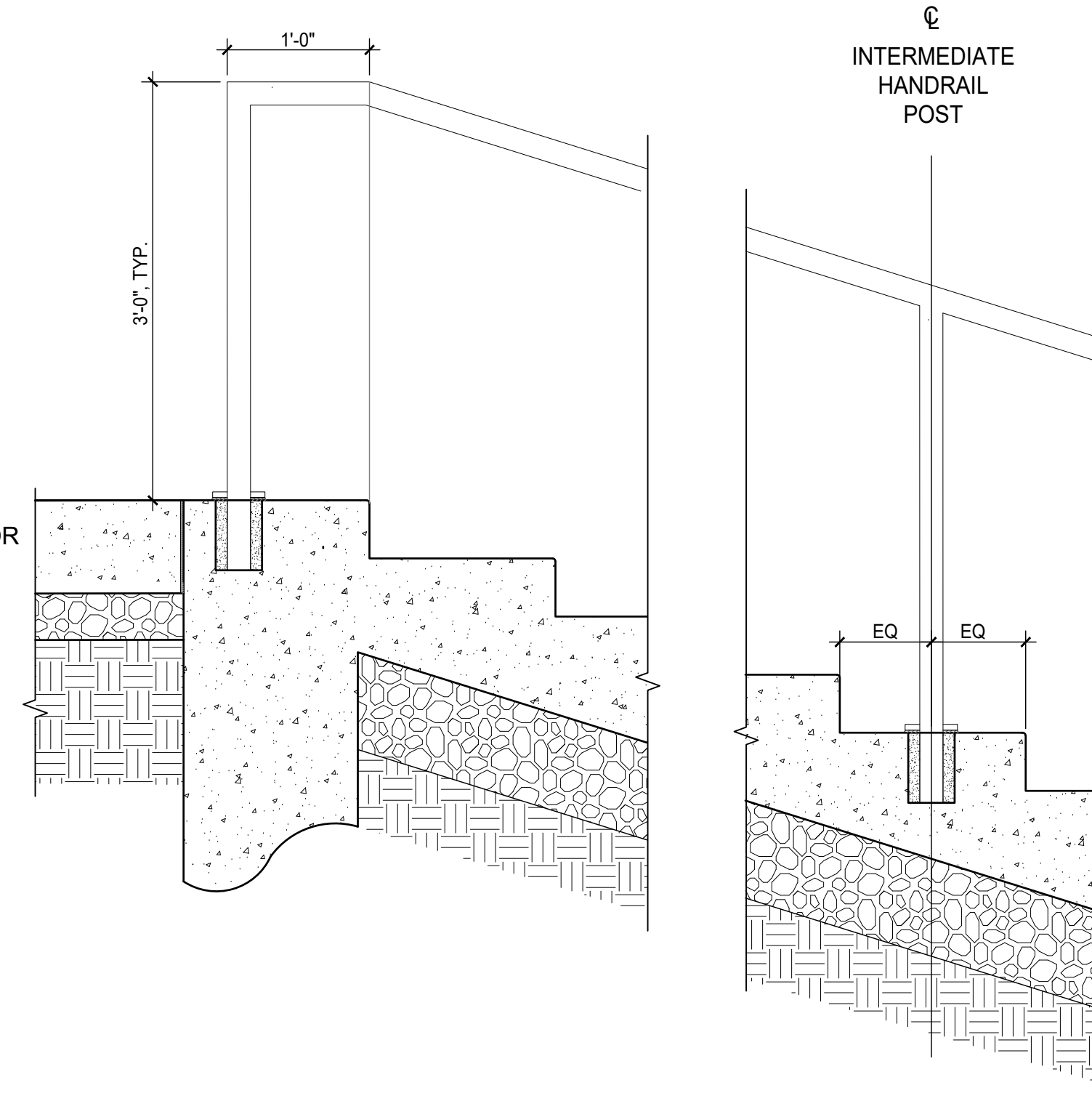

B STEEL HANDRAIL 10 16 11 12 TYPICAL SECTION

NOTES:
1. CONTRACTOR TO PROVIDE SHOP DRAWINGS FOR REVIEW AND APPROVAL BY LANDSCAPE ARCHITECT.

CONSULTANTS
EWINGCOLE
CONSULTANTS
CIVIL SITE ENGINEERS
55A TICE ENGINEERING
2 River Street, Suite 100
Baltimore, MD 21202
Phone: 301-943-3700
FAX: 301-943-3700
LAND PLANNERS & LANDSCAPE ARCHITECTS:
WAVE
405 East Lister Alley
Columbia, MD 21046
Phone: 410-321-2700
STRUCTURAL ENGINEERS:
FISHER ENGINEERING, INC.
815 Light Street
Baltimore, MD 21202
Phone: 410-517-1800
MEP ENGINEERS:
JENSEN ENGINEERING, INC.
8517 Forest Road
Hollywood, MD 20636
Phone: 410-321-1300
SUSTAINABILITY CONSULTANTS:
LOWE PARTNERSHIPS, LLC
1200 Light Street
Baltimore, MD 21202
Phone: 410-618-0100

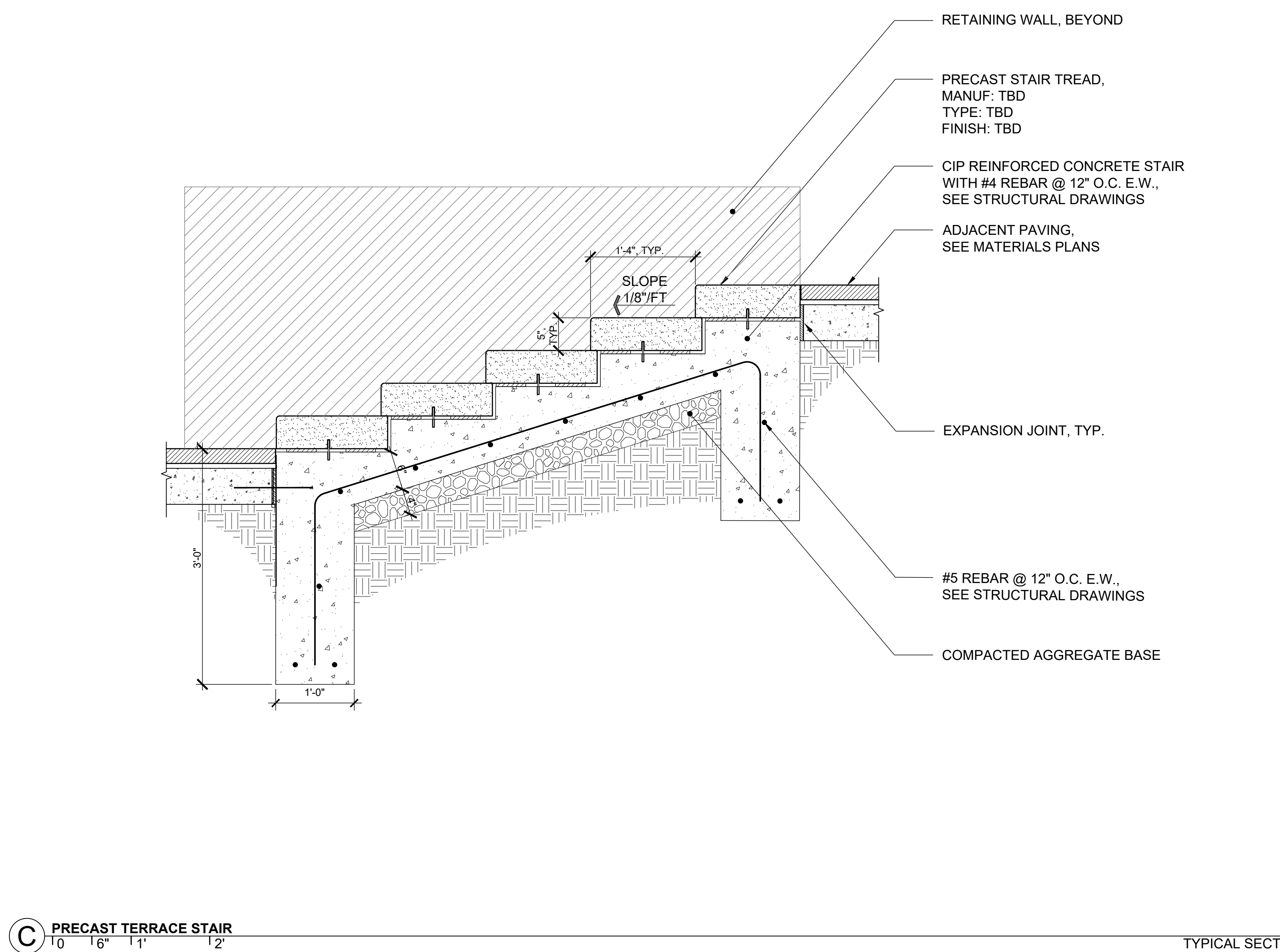

C PRECAST TERRACE STAIR 10 16 11 12 TYPICAL SECTION

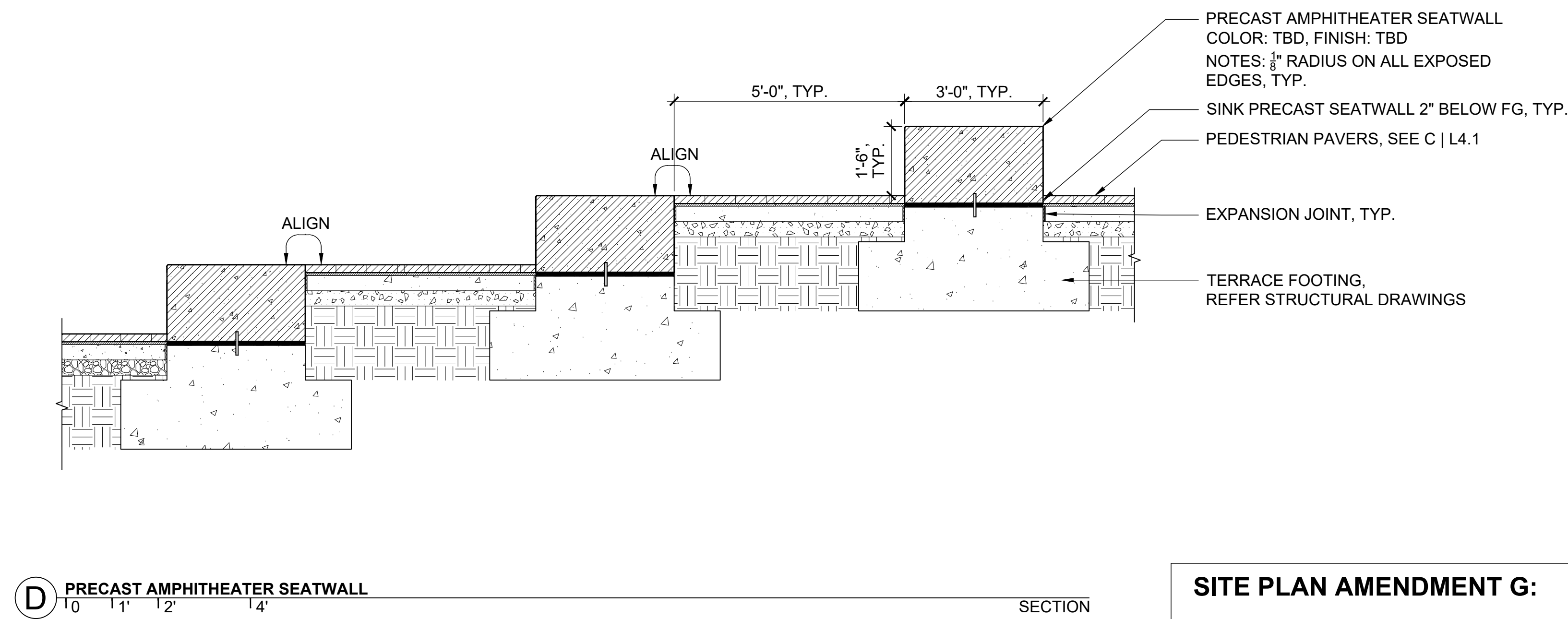

D PRECAST AMPHITHEATER SEATWALL 10 11 12 14 SECTION

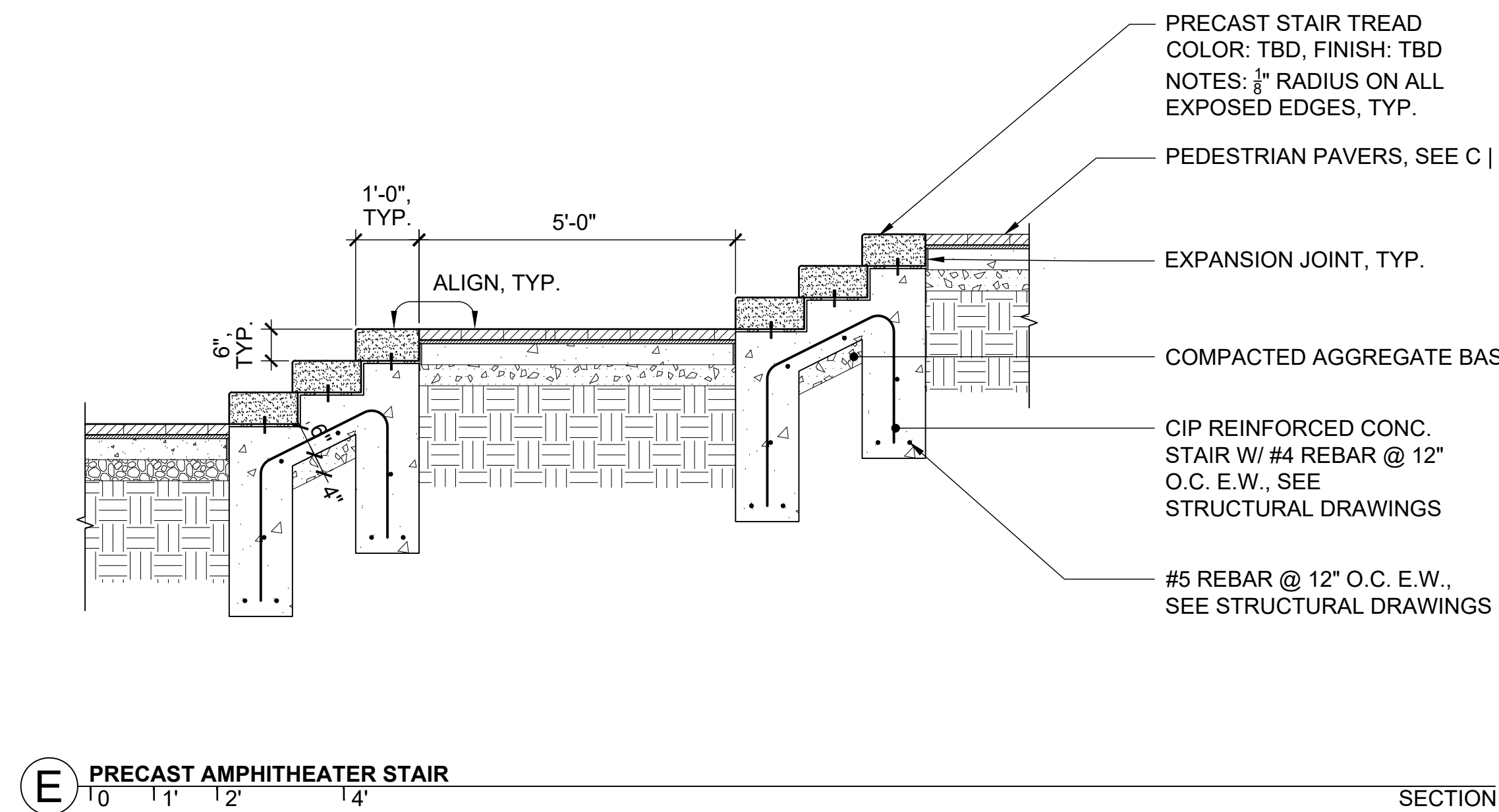

E PRECAST AMPHITHEATER STAIR 10 11 12 14 SECTION

SITE PLAN AMENDMENT G:
81995045G
9800 MEDICAL CENTER DRIVE

SITE PLAN 81995045G

DEVELOPER'S CERTIFICATE
The Undersigned agrees to execute all the features of the Site Plan Approval No. 81995045G, including Approval Conditions, Development Program and Certified Site Plan.
Developer's Name: ARE-Maryland No.24, LLC, William DePippo, Contact Person
Address: 946 Clopper Road, Gaithersburg, MD 20878
Phone: 301-947-1770
Signature: _____

PRINCIPAL:
ANDY KNIGHT, PLA
PROJECT MANAGER:
RICK ESPE, PLA
Professional Certification: I certify that these documents were prepared or approved by me, and that I am a duly licensed landscape architect under the laws of the State of Maryland.
License No: 01-4189 Expiration Date: 01/26/23

REVISIONS

NO. BY DESCRIPTION DATE

ALEXANDRIA
ALEXANDRIA REAL ESTATE EQUITIES, INC

**9800 MEDICAL CENTER DRIVE
BUILDING E & PARKING DECK**

ROCKVILLE, MD 20850

DRAWN BY: DB DATE: 02-19-2021

PROJECT NO. SCALE

DRAWING NAME

DETAILS

FLOOR/SECTION/PHASE DRAWING NO.

DD **L4.4**