

PLANNING DEPARTMENT USE ONLY (E-PLANS)

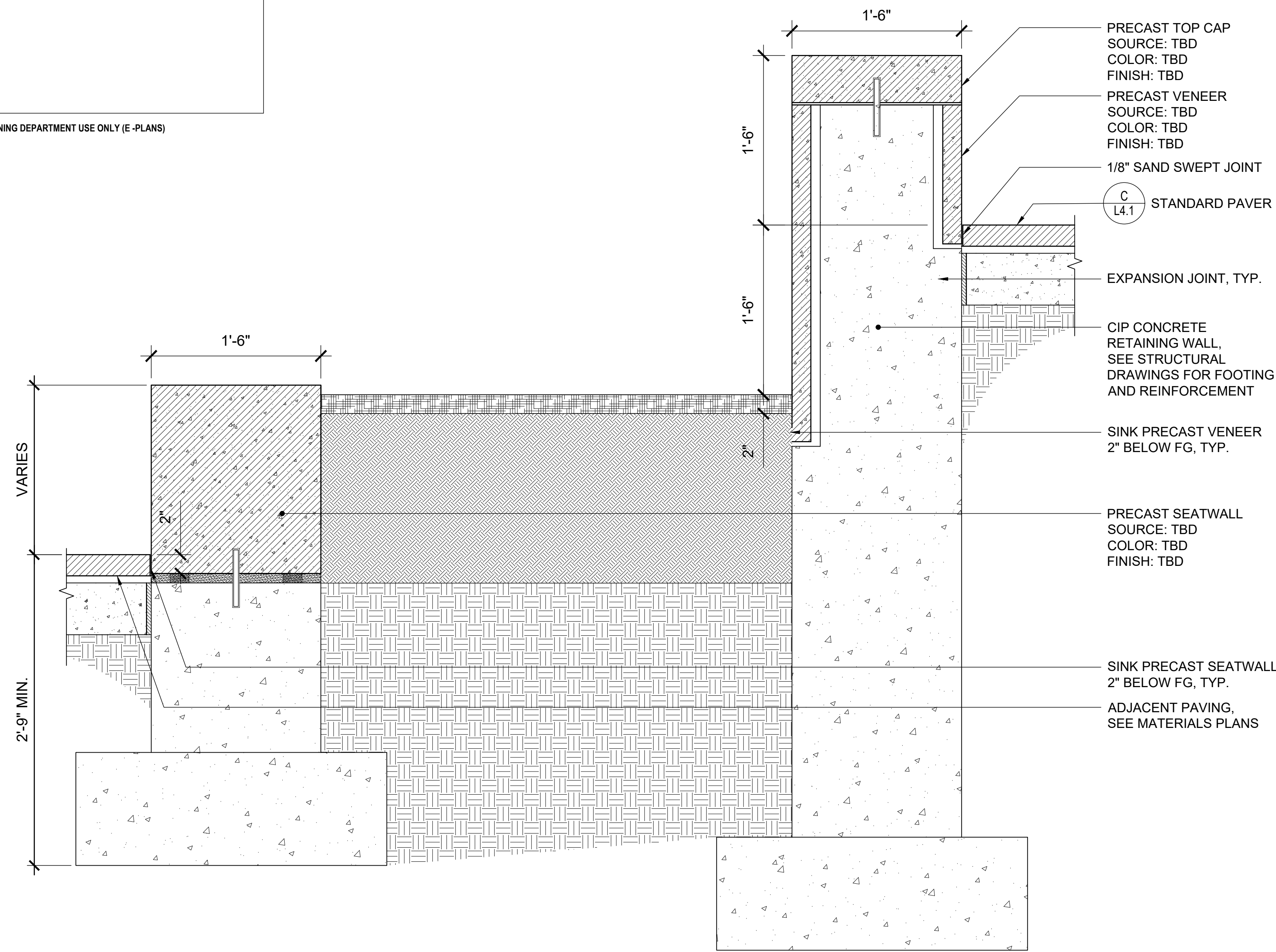

**A** PLANTER TERRACE WALL  
1'-0" 1'-4" 1'-8" 1'-4" TYPICAL SECTION

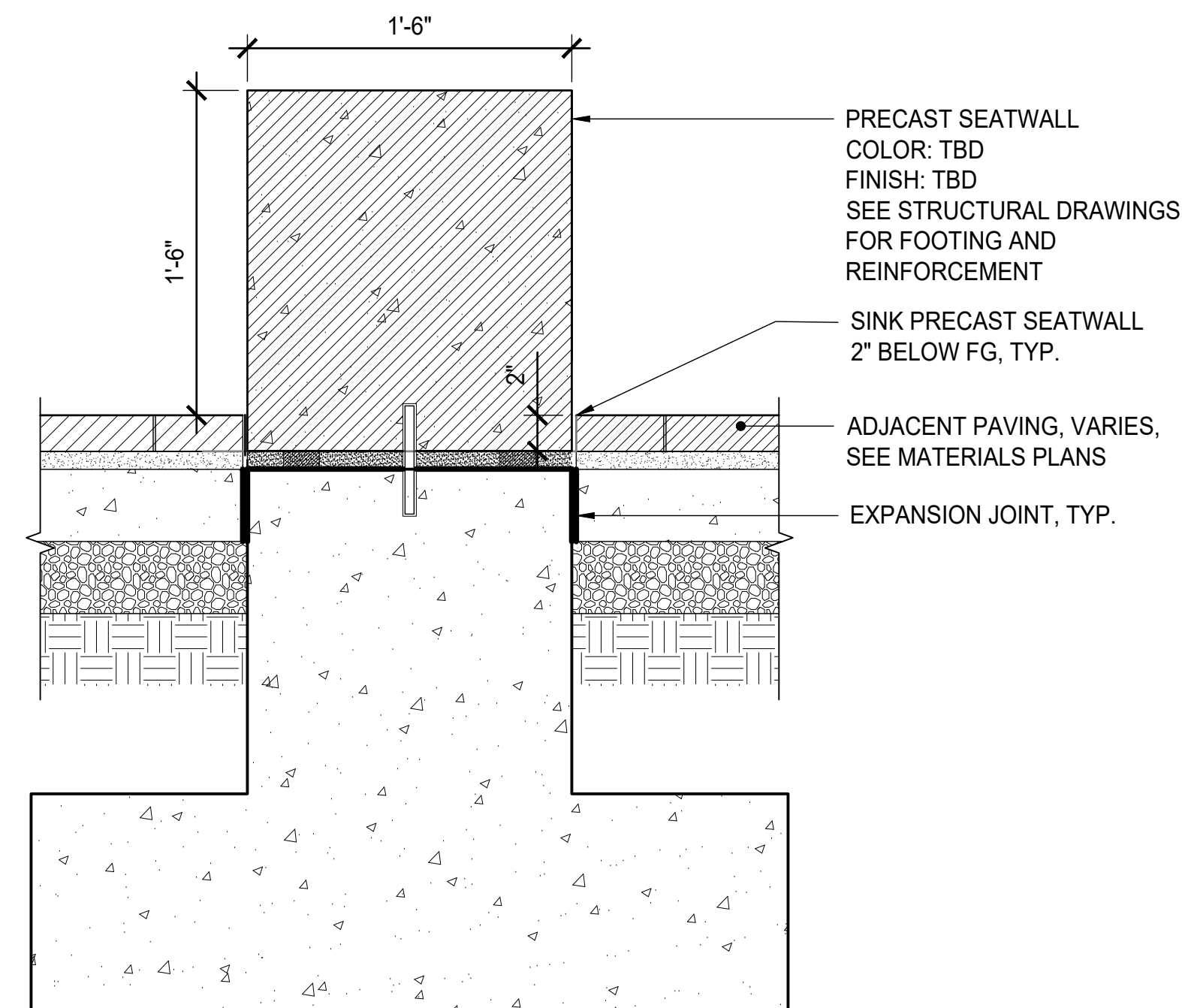

**B** PRECAST CONCRETE SEATWALL  
1'-0" 1'-4" 1'-8" 1'-4" TYPICAL SECTION

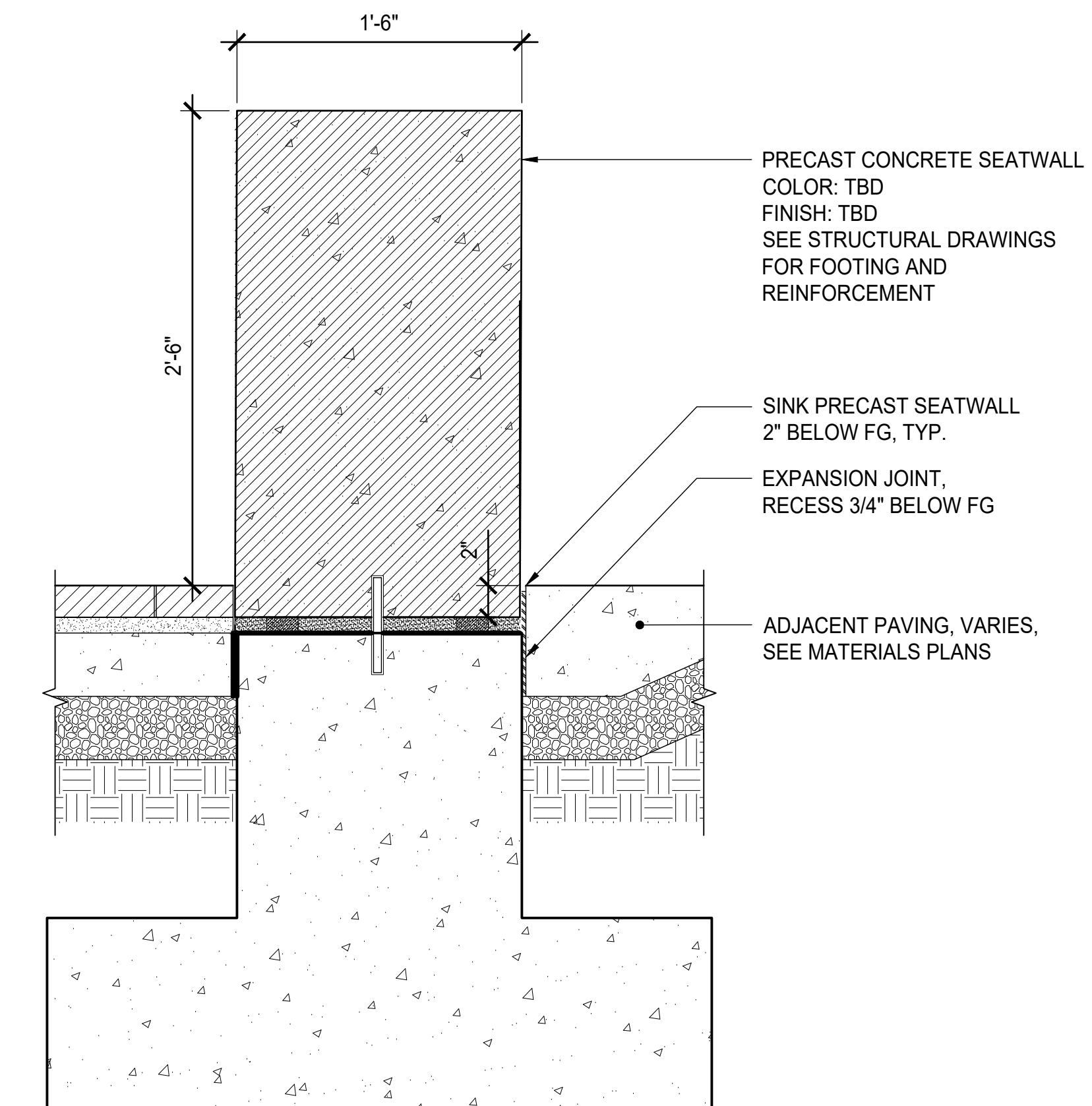

**C** CIP CONCRETE ACCENT WALL  
1'-0" 1'-4" 1'-8" 1'-4" TYPICAL SECTION

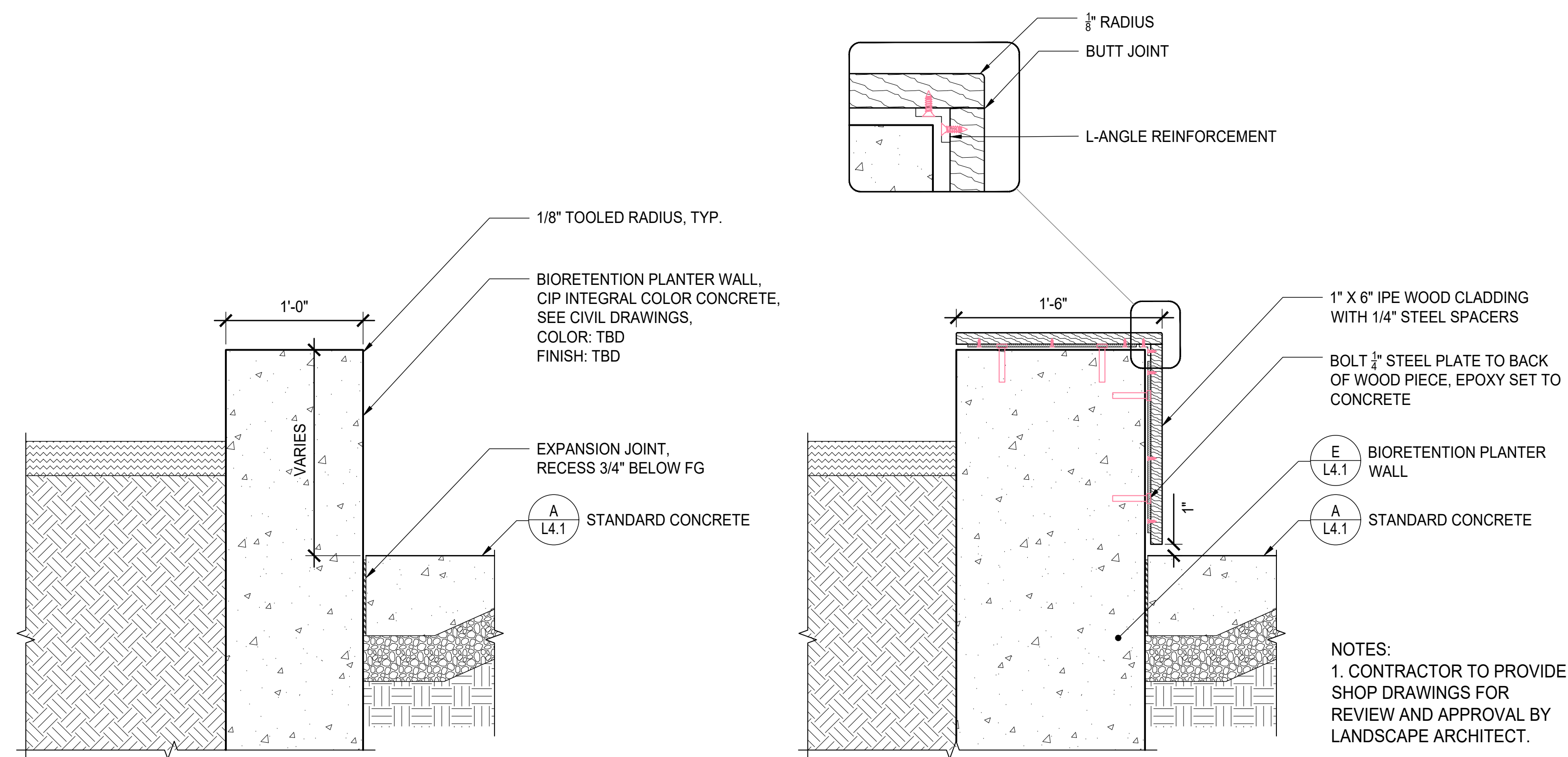

**D** BIORETENTION PLANTER WALL  
1'-0" 1'-4" 1'-8" 1'-4" TYPICAL SECTION

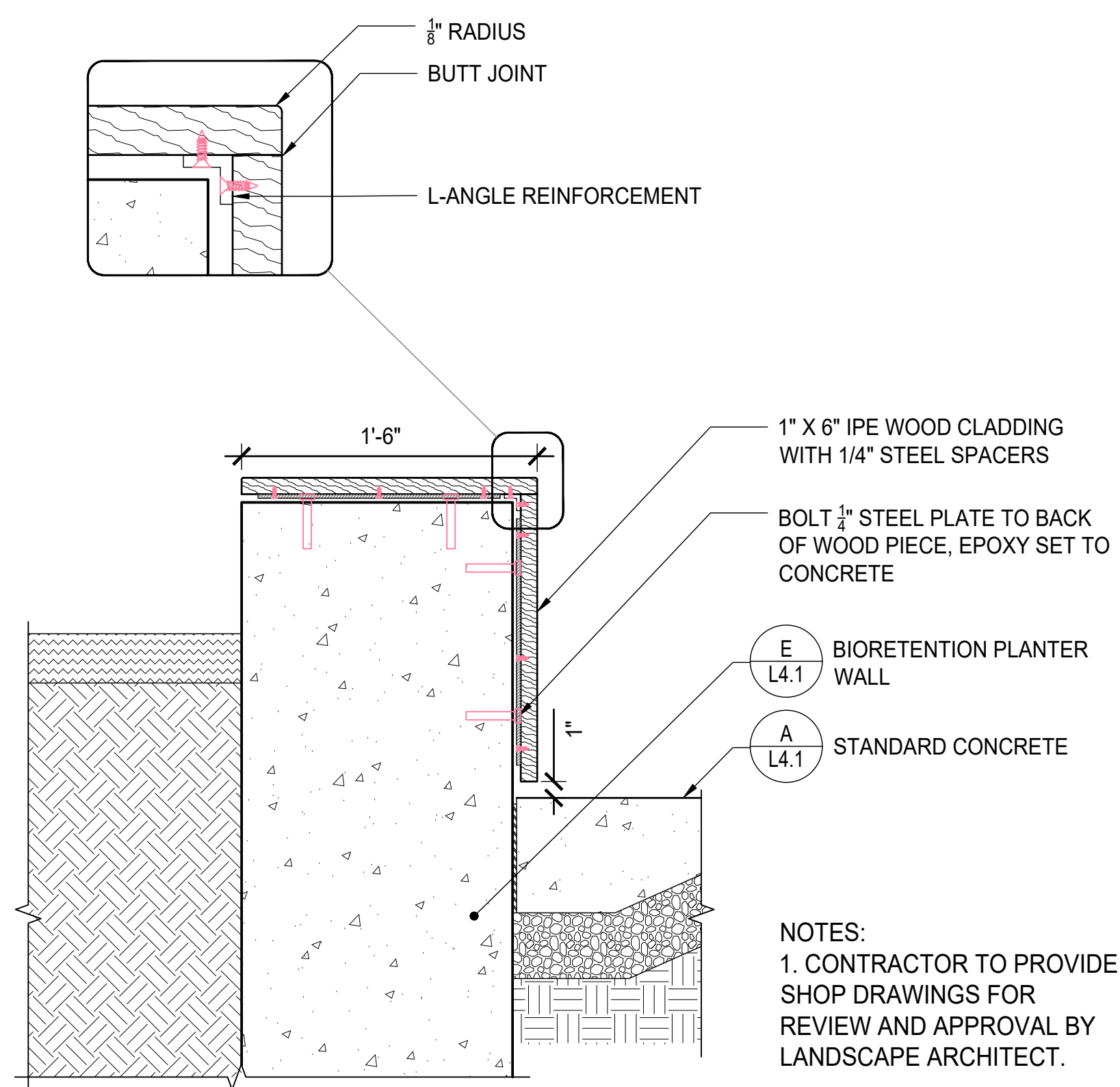

**E** WOOD CLAD SEATWALL  
1'-0" 1'-4" 1'-8" 1'-4" TYPICAL SECTION

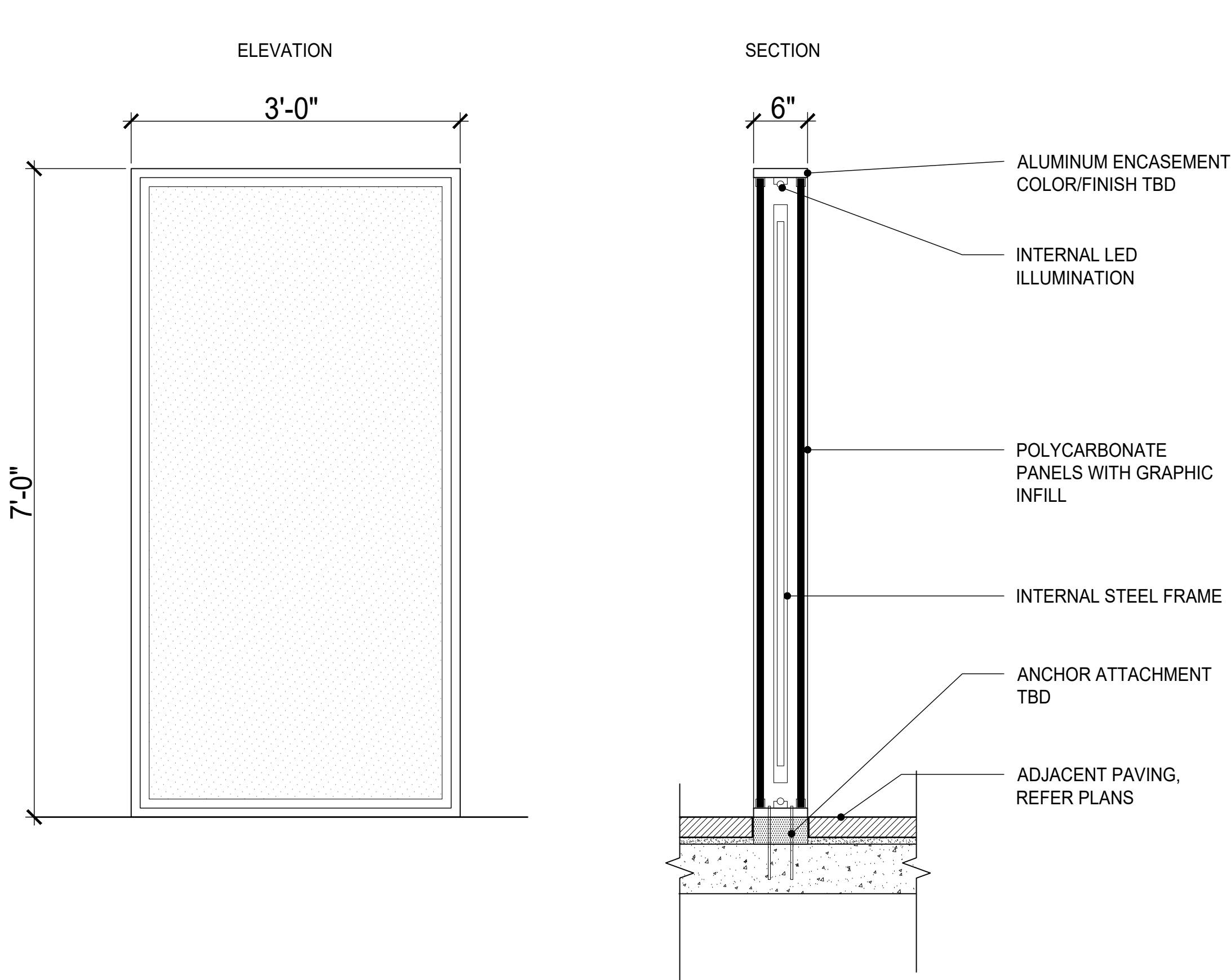

**F** ILLUMINATED GRAPHIC PANEL - PLAZA  
1'-0" 1'-6" 1'-11" 1'-2" TYPICAL SECTION

Consulted by: EWINGCOLE  
**CONSULTANTS**  
CIVIL SITE ENGINEERS  
59A TIGER CREEK ROAD  
2 FLOOR SUITE 2000  
ROCKVILLE, MD 20850  
Phone: 301-948-3333  
LAND PLANNERS & LANDSCAPE ARCHITECTS:  
WOLF  
405 South Lorton Alley  
COLUMBIA, MD 21046  
Phone: 410-271-2700  
STRUCTURAL ENGINEERS:  
FABRY ENGINEERING, INC.  
815 Light Street  
Baltimore, MD 21202  
Phone: 410-511-1881  
MEPP ENGINEERS:  
JENKINS ENGINEERING, INC.  
8517 Forest Road  
Newport, MD 21088  
Phone: 410-511-1881  
SUSTAINABILITY CONSULTANTS:  
LOWE PARTNERSHIPS, LLC  
10000 Green  
Baltimore, MD 21286  
Phone: 410-681-8100

KEY PLAN

PRINCIPAL  
ANDY KNIGHT, PLA  
PROJECT MANAGER  
RICK ESPE, PLA  
Professional Certification: I certify that these documents were prepared or approved by me, and that I am a duly licensed landscape architect under the laws of the State of Maryland.  
License No: 01-4189 Expiration Date: 01/26/23

NO.	BY	DESCRIPTION	DATE

**SITE PLAN AMENDMENT G:**  
**81995045G**  
**9800 MEDICAL CENTER DRIVE**

**SITE PLAN 81995045G**

**DEVELOPER'S CERTIFICATE**  
The Undersigned agrees to execute all the features of the Site Plan Approval No. 81995045G, including Approval Conditions, Development Program and Certified Site Plan.  
Developer's Name: ARE-Maryland No.24, LLC. William DePippo  
Company Contact Person  
Address: 946 Clopper Road, Gaithersburg, MD 20878  
Phone: 301-947-1770  
Signature: \_\_\_\_\_

NO. BY DESCRIPTION DATE

**ALEXANDRIA**  
ALEXANDRIA REAL ESTATE EQUITIES, INC  
9800 MEDICAL CENTER DRIVE  
BUILDING E & PARKING DECK  
ROCKVILLE, MD 20850

DRAWN BY: DB DATE: 02-19-2021  
PROJECT NO.: SCALE:  
DRAWING NAME:  
DETAILS  
FLOOR/SECTION/PHASE: DD DRAWING NO.: L4.5