

PLANNING DEPARTMENT USE ONLY (E-PLANS)

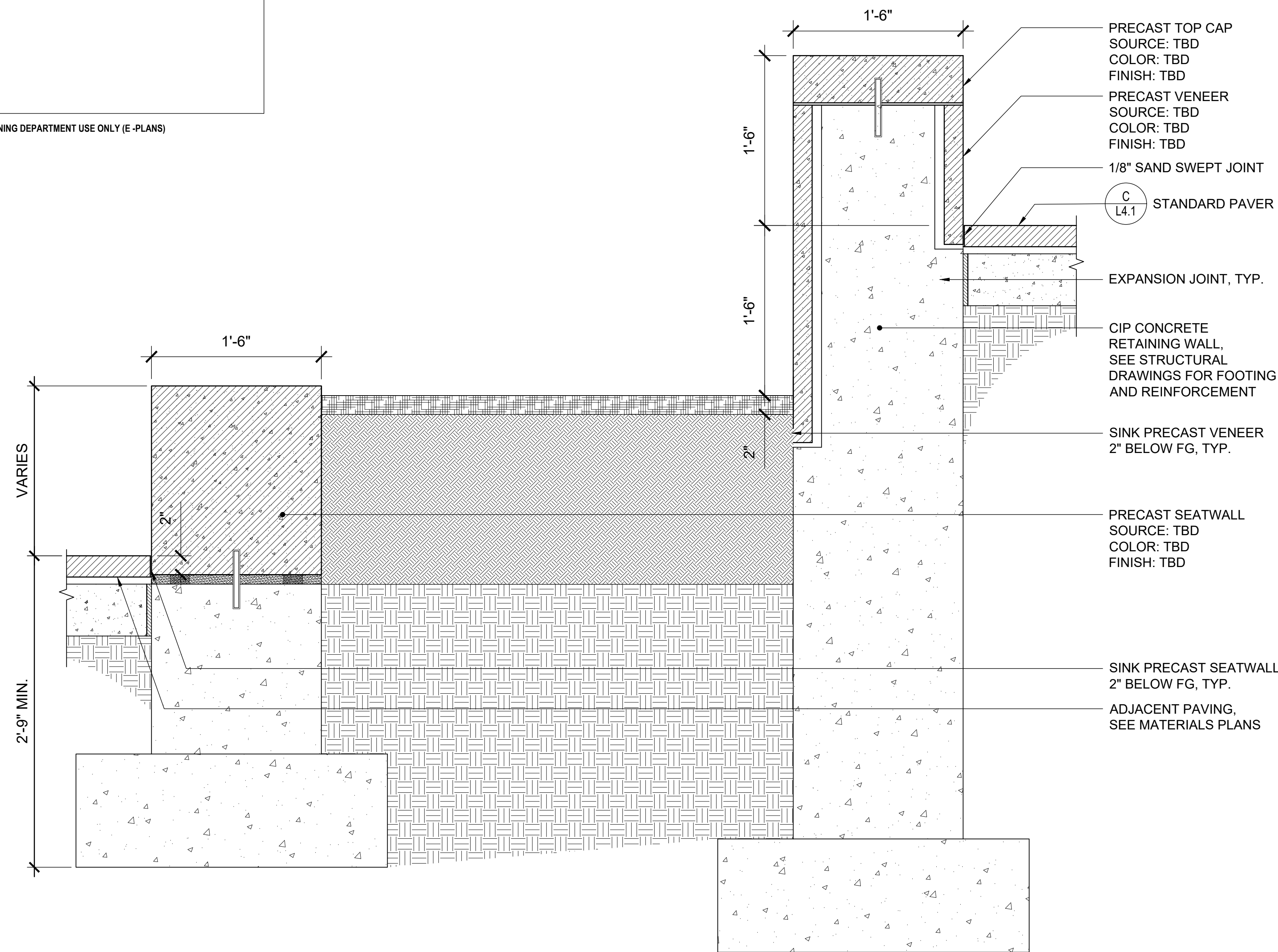

A PLANTER TERRACE WALL
1'-0" 1'-4" 1'-8" 1'-12" TYPICAL SECTION

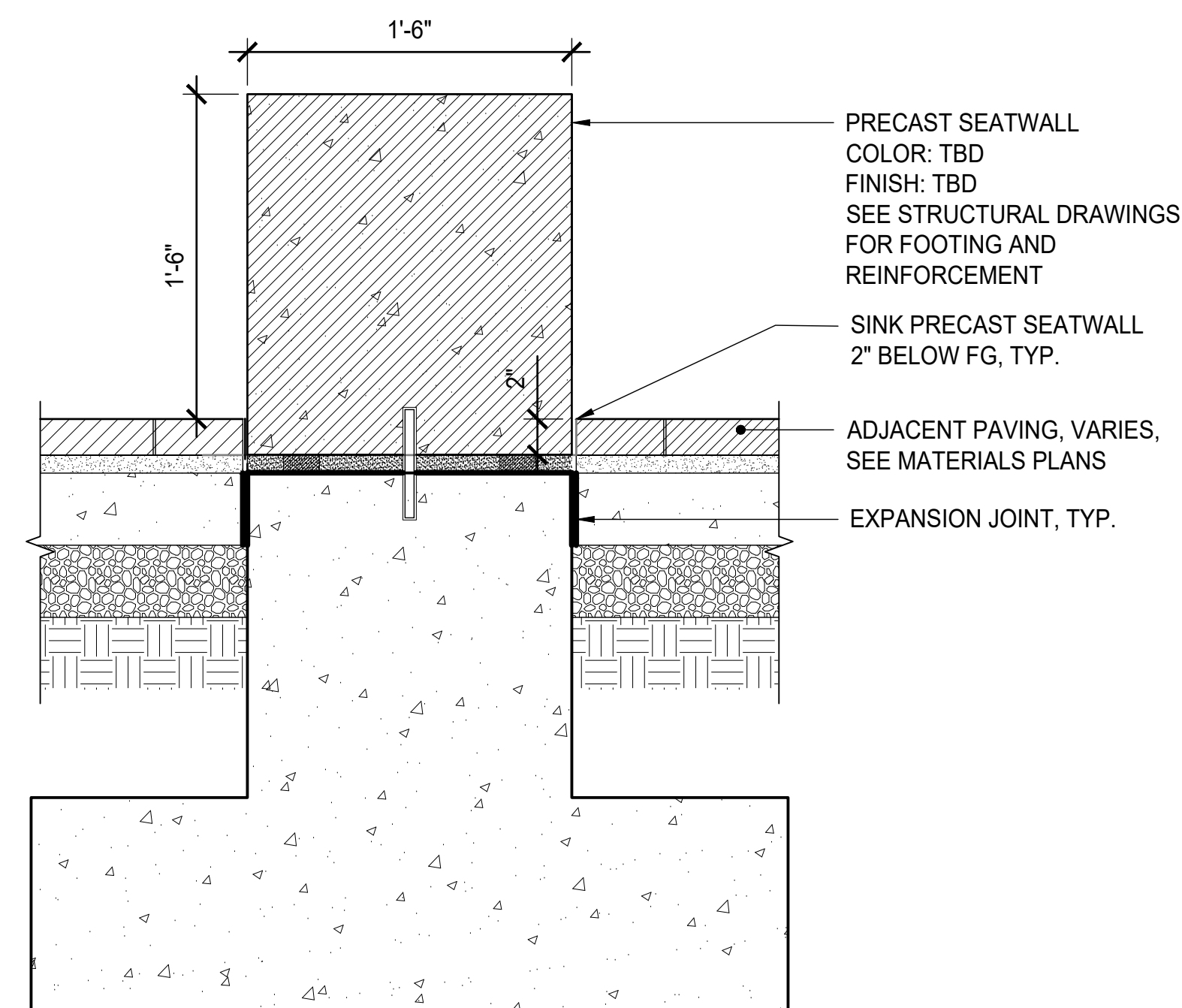

B PRECAST CONCRETE SEATWALL
1'-0" 1'-4" 1'-8" 1'-12" TYPICAL SECTION

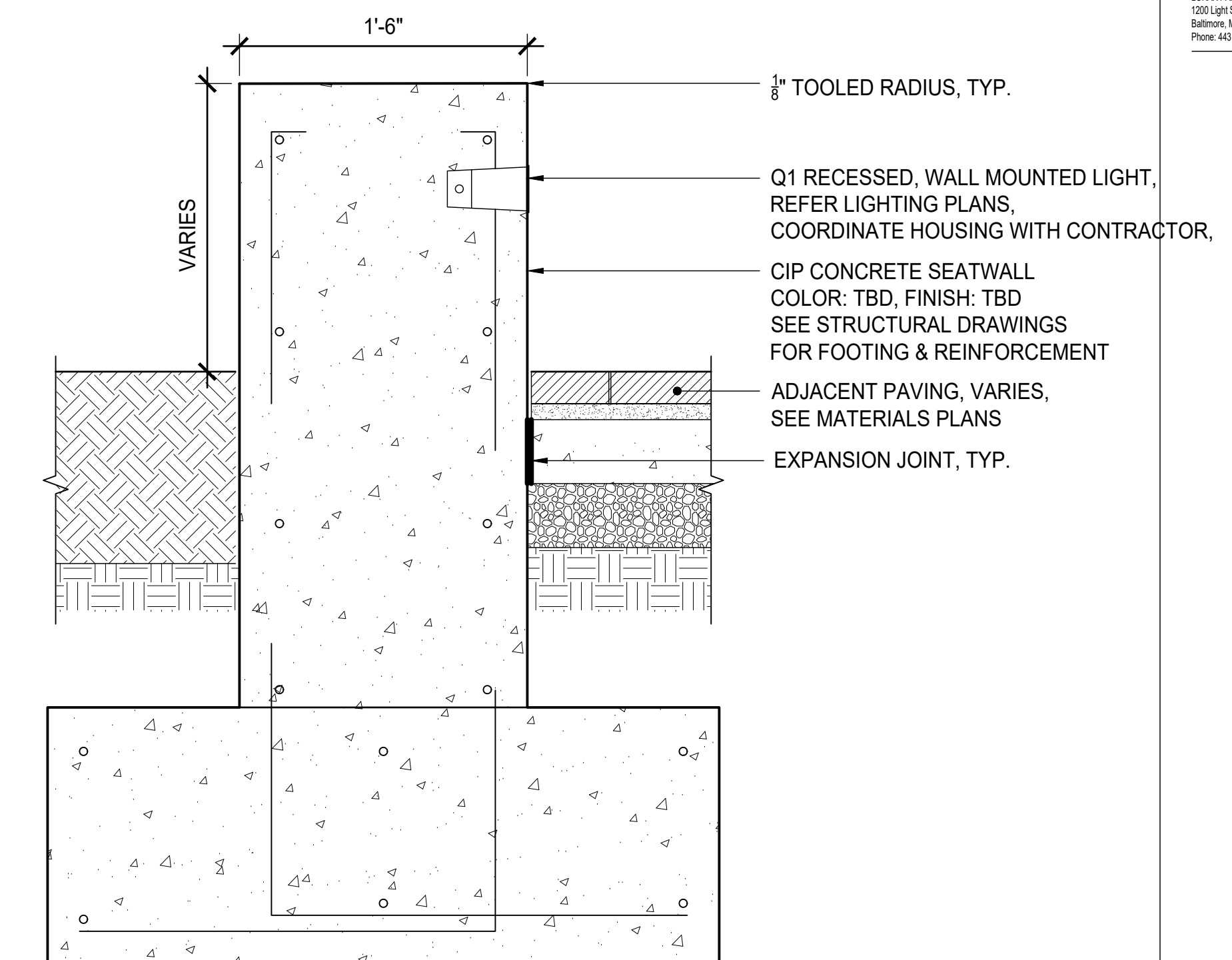

C CIP CONCRETE SEATWALL
1'-0" 1'-4" 1'-8" 1'-12" TYPICAL SECTION

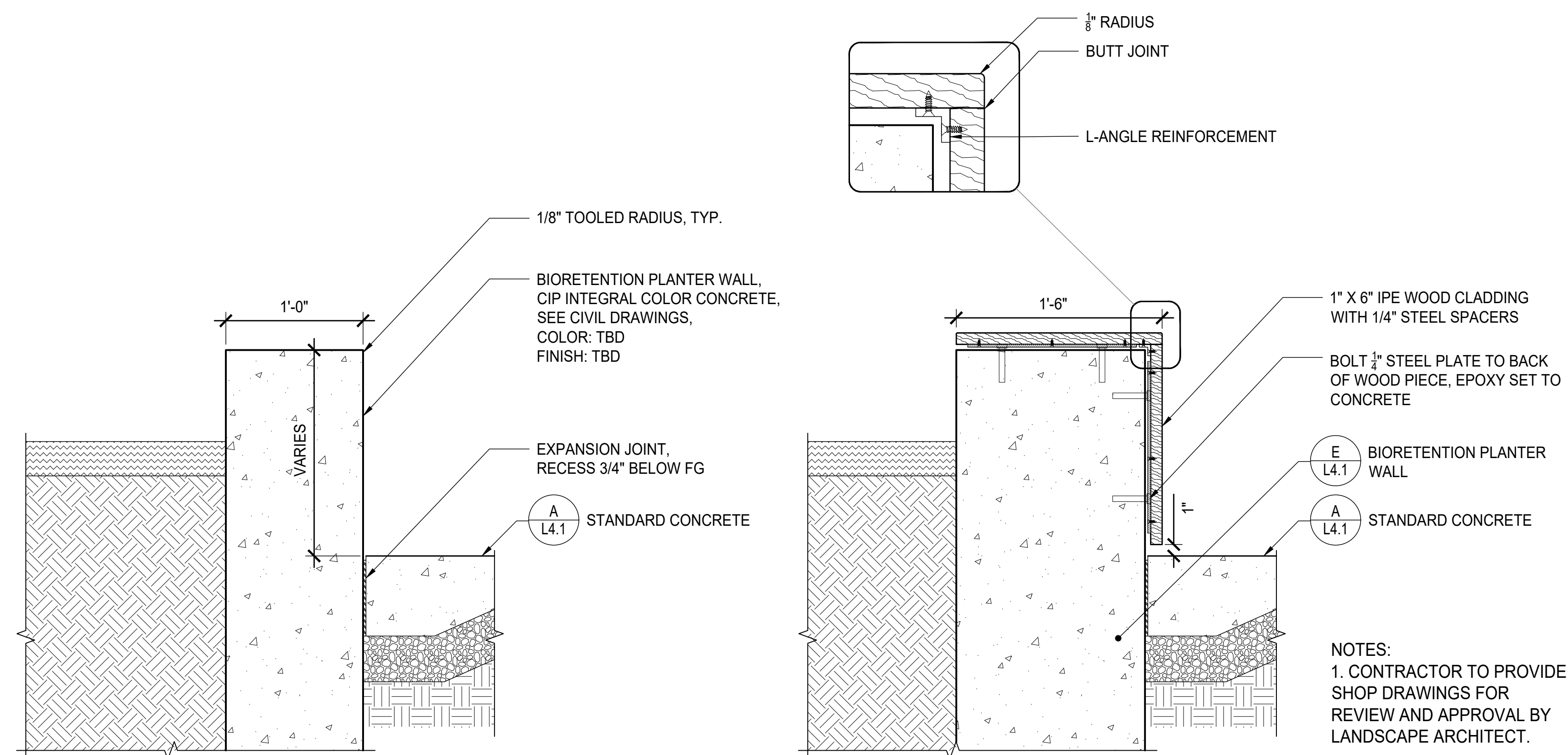

D BIORETENTION PLANTER WALL
1'-0" 1'-4" 1'-8" 1'-12" TYPICAL SECTION

E WOOD CLAD SEATWALL
1'-0" 1'-4" 1'-8" 1'-12" TYPICAL SECTION

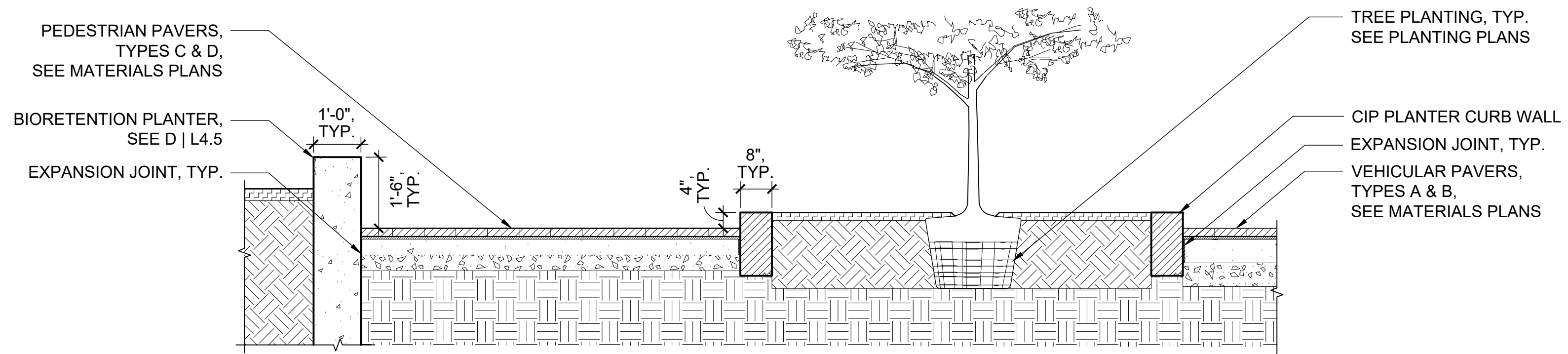

F PLANTER CURB WALL
1'-0" 1'-1" 1'-2" 1'-4" SECTION

SITE PLAN AMENDMENT G:
81995045G
9800 MEDICAL CENTER DRIVE

SITE PLAN 81995045G

DEVELOPER'S CERTIFICATE
The Undersigned agrees to execute all the features of the Site Plan Approval No. 81995045G, including Approval Conditions, Development Program and Certified Site Plan.
Developer's Name: ARE-Maryland No.24, LLC, William DePippo
Company Contact Person
Address: 946 Clopper Road, Gaithersburg, MD 20878
Phone: 301-947-1770
Signature: _____

PRINCIPAL
ANDY KNIGHT, PLA
PROJECT MANAGER
RICK ESPE, PLA

Professional Certification: I certify that these documents were prepared or approved by me, and that I am a duly licensed landscape architect under the laws of the State of Maryland.
License No: 01-4189 Expiration Date: 01/26/23

REVISIONS

NO. BY DESCRIPTION DATE



ALEXANDRIA
ALEXANDRIA REAL ESTATE EQUITIES, INC

**9800 MEDICAL CENTER DRIVE
BUILDING E & PARKING DECK**

ROCKVILLE, MD 20850

DRAWN BY DB DATE 02-19-2021

PROJECT NO. SCALE

DRAWING NAME

DETAILS

FLOOR/SECTION/PHASE DRAWING NO.

DD **L4.5**