

PLANNING DEPARTMENT USE ONLY (E-PLANS)

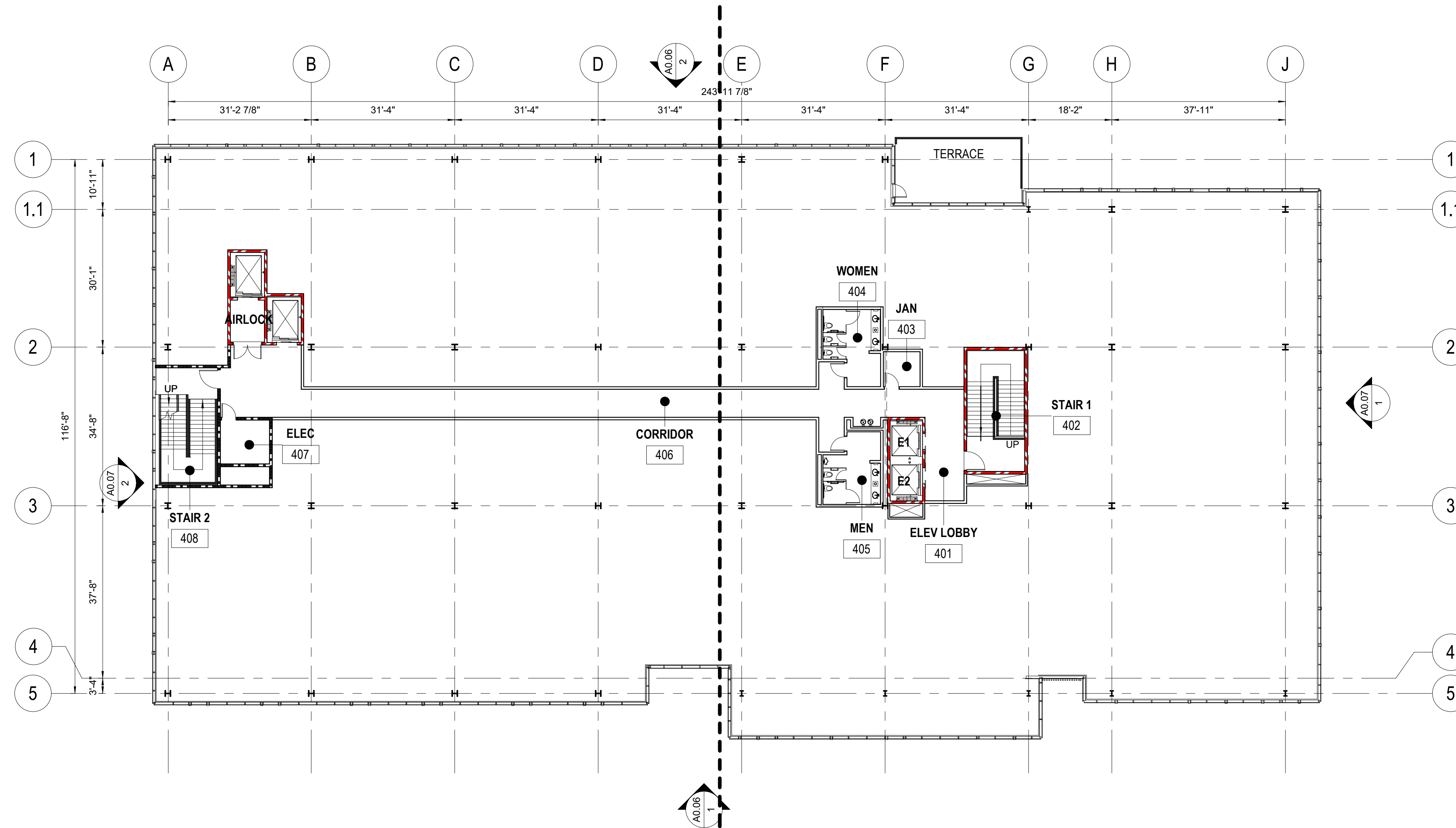

2 SITE PLAN AMENDMENT - BUILDING E - FOURTH FLOOR PLAN  
1/16" = 1'-0"

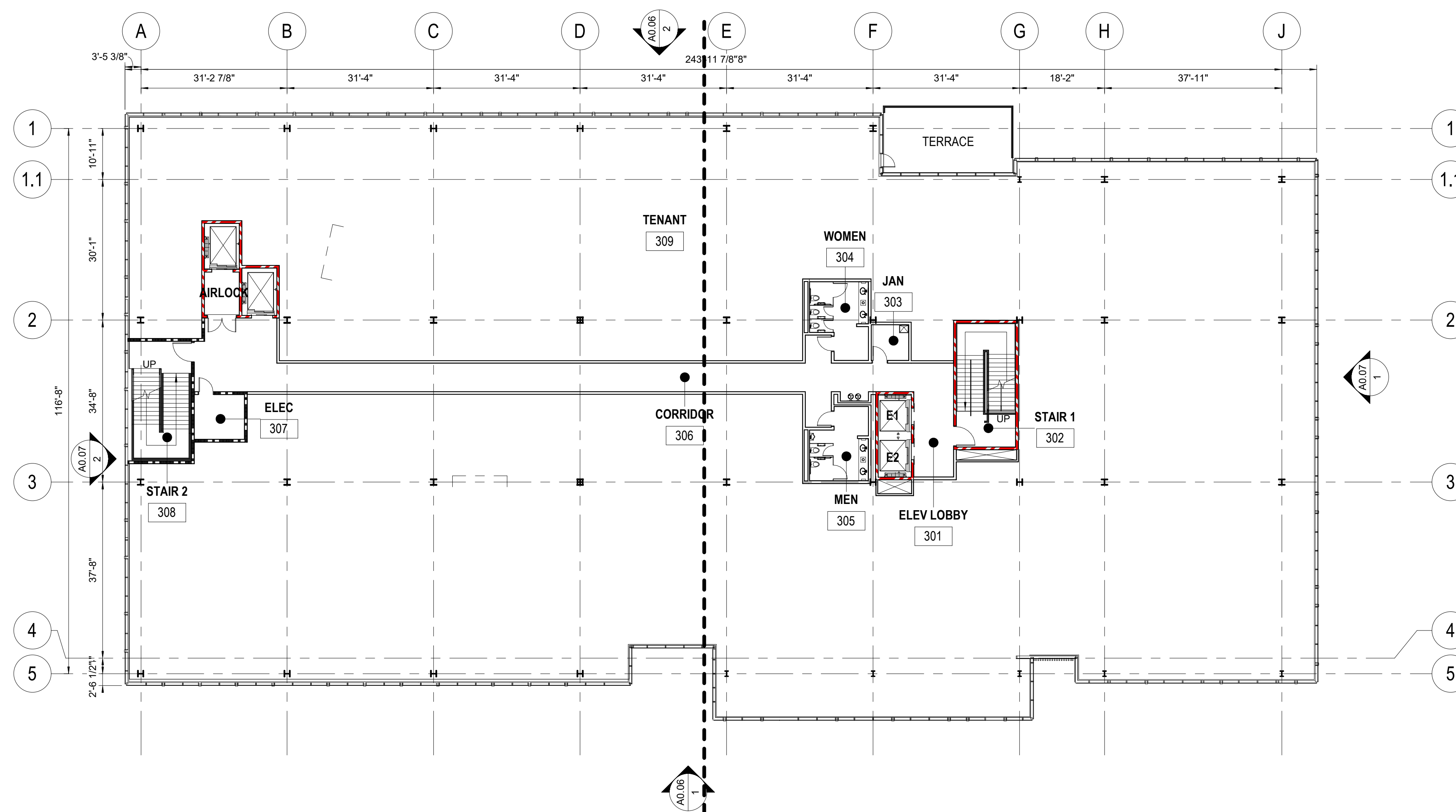

1 SITE PLAN AMENDMENT - BUILDING E - THIRD FLOOR PLAN  
1/16" = 1'-0"

**SITE PLAN 81995045G**

**DEVELOPER'S CERTIFICATE**

The Undersigned agrees to execute all the features of the Site Plan Approval No. 81995045G, including Approval Conditions, Development Program and Certified Site Plan.

Developer's Name: ARE-Maryland No.24.LLC William DePippo  
Company Contact Person

Address: 946 Clopper Road, Gaithersburg, MD 20878

Phone: 301-947-1770

Signature: \_\_\_\_\_

2/24/2021 10:30:08 AM C:\Revit\Load Files\20200550\_030\_CENTRAL\_BUILDING E\_singhman\MLV.rvt

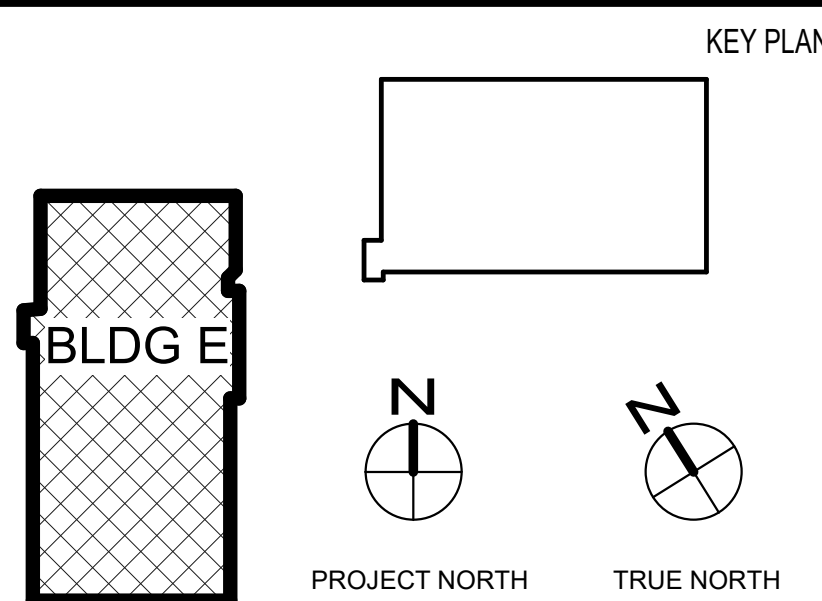

NO.	BY	DESCRIPTION

DATE	CONSULTANTS

**CIVIL SITE ENGINEERS:**  
SOLITEX ENGINEERING  
2 Riverchase Plaza, Suite 100  
Rockville, MD 20850  
Phone: 301-948-2790

**LAND PLANNERS & LANDSCAPE ARCHITECTS:**  
MCKE  
452 South Ludlow Alley  
Columbia, OH 43219  
Phone: 614-621-2790

**STRUCTURAL ENGINEERS:**  
FACENT ASSOCIATES, INC.  
810 Light Street  
Baltimore, MD 21201  
Phone: 410-781-1999

**MERIP ENGINEERS:**  
JENNIFER ENGINEERING, INC.  
8833 D Baker Road  
Nottingham, MD 21236  
Phone: 410-870-1300

**SUSTAINABILITY CONSULTANTS:**  
LORAX PARTNERSHIPS, LLC  
1220 Light Street  
Baltimore, MD 21201  
Phone: 410-449-0319

PRINCIPAL  
WILLIAM A.L. GAUDREAU  
PROJECT MANAGER  
RICH WILLIAMS

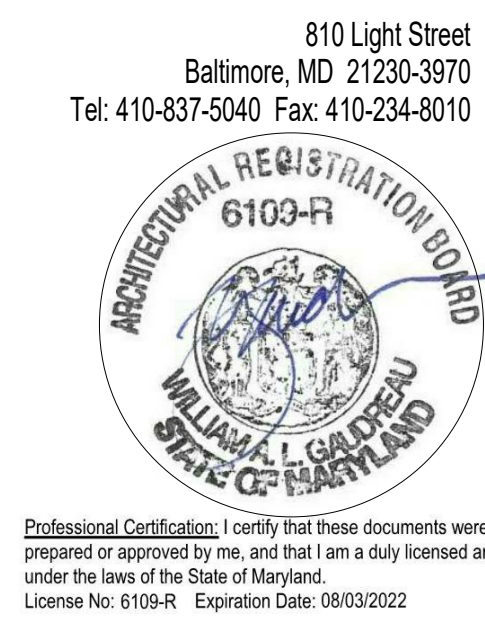

**EWING COLE**

Copyright ©2021 by EWINGCOLE

PROJECT NO. 20200550 SCALE As indicated

DRAWING NAME BUILDING E - FLOOR PLANS

**ALEXANDRIA REAL ESTATE EQUITIES**

9800 MEDICAL CENTER DRIVE,  
BUILDING E & PARKING DECK

ROCKVILLE, MD 20850

DRAWN BY CT/SN DATE 01-19-2021

FLOOR/SECTION PHASE DRAWING NO.

DD A0.02