

PLANNING DEPARTMENT USE ONLY (E-PLANS)

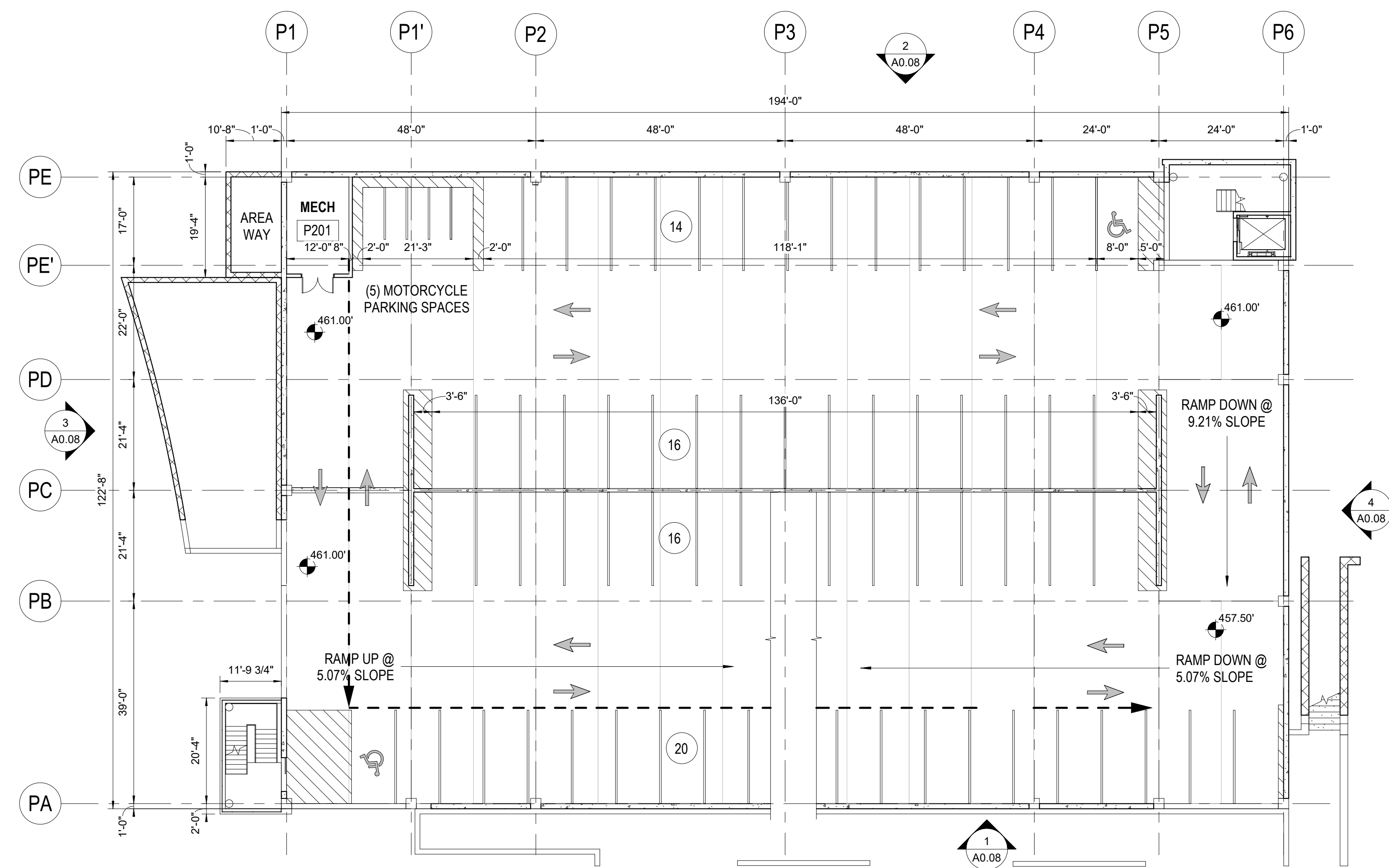

2 SITE PLAN AMENDMENT - PARKING GARAGE - P2 LEVEL PLAN
1/16" = 1'-0"

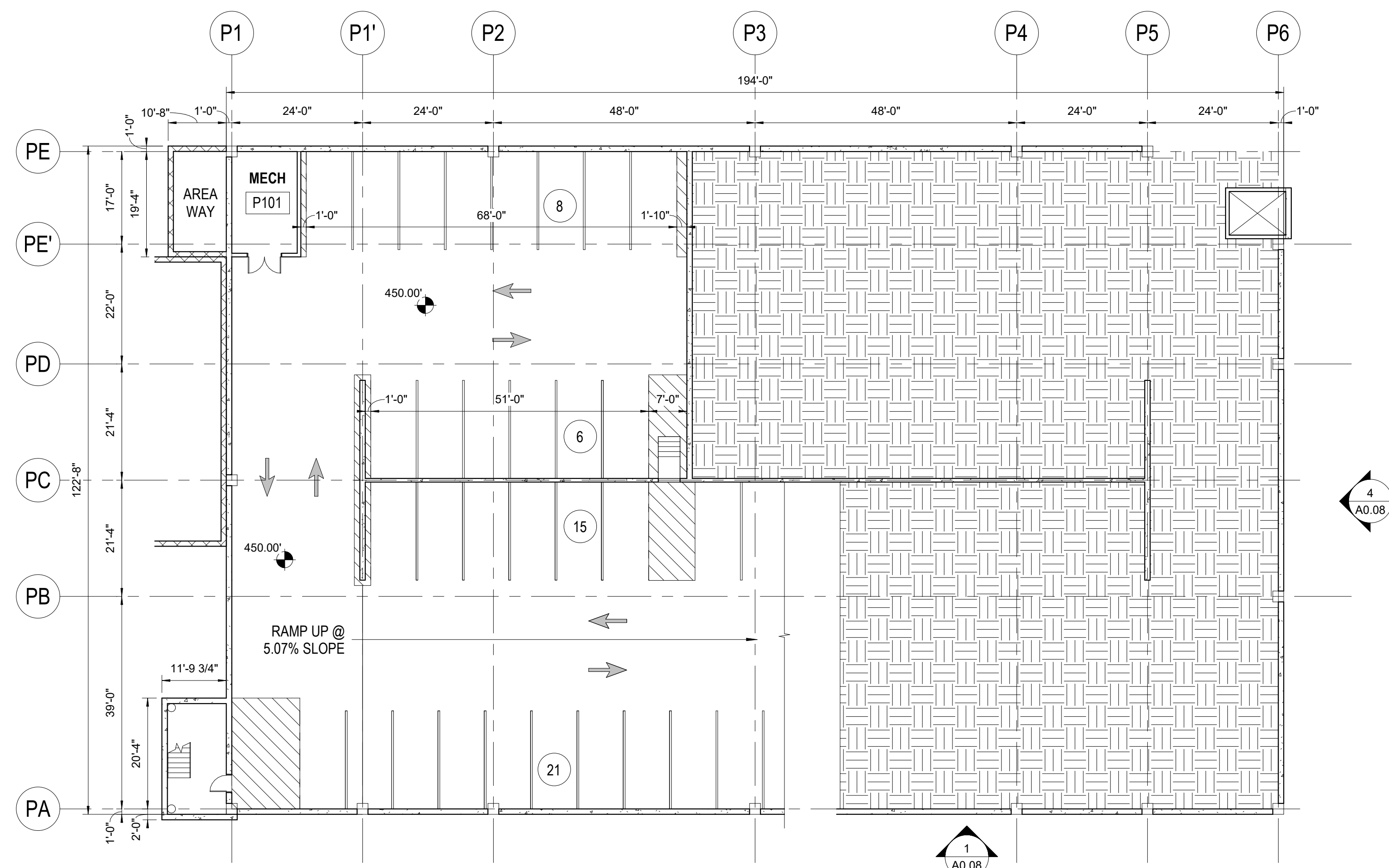

1 SITE PLAN AMENDMENT - PARKING GARAGE - P1 LEVEL PLAN
1/16" = 1'-0"

SITE PLAN 81995045G

DEVELOPER'S CERTIFICATE

The Undersigned agrees to execute all the features of the Site Plan Approval No. 81995045G, including Approval Conditions, Development Program and Certified Site Plan.

Developer's Name: ARE-Maryland No.24.LLC William DePippo
Company Contact Person

Address: 946 Clopper Road, Gaithersburg, MD 20878

Phone: 301-947-1770

Signature: _____

2/24/2021 10:02:24 AM C:\Revised\Files\20200550_A0_CENTRAL_PARKING GARAGE_#mode\$T12.dwg

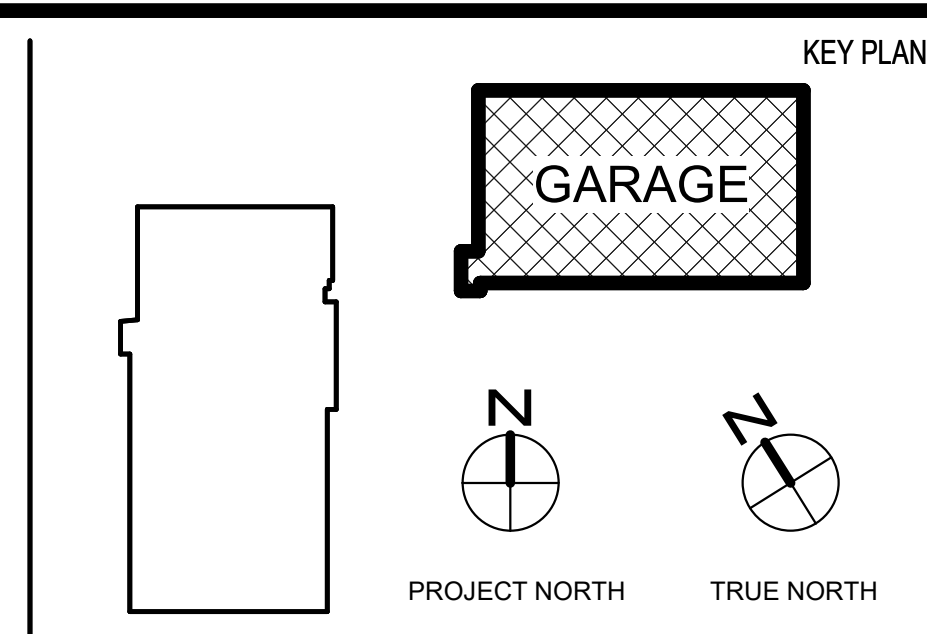

NO.	BY	DESCRIPTION	DATE	CONSULTANTS

REVISIONS

CIVIL SITE ENGINEERS:
SOLTESZ ENGINEERING
2 Riverchase Plaza, Suite 100
Rockville, MD 20850
Phone: 301-948-2700

LAND PLANNERS & LANDSCAPE ARCHITECTS:
MCK
452 South Ludlow Alley
Columbia, OH 43219
Phone: 614-621-2700

STRUCTURAL ENGINEERS:
FACENT ASSOCIATES, INC.
810 Light Street
Baltimore, MD 21201
Phone: 410-781-1699

MEPP ENGINEERS:
JEANERICK ENGINEERING, INC.
8033 D'Neale Road
Nethersham, MD 21228
Phone: 410-670-1300

SUSTAINABILITY CONSULTANTS:
LORAX PARTNERSHIPS, LLC
1200 Light Street
Baltimore, MD 21201
Phone: 410-448-0310

PRINCIPAL
WILLIAM A.L. GAUDREAU
PROJECT MANAGER
RICH WILLIAMS

810 Light Street
Baltimore, MD 21201-3970
Tel: 410-837-5040 Fax: 410-234-8010

APPROVED FOR THE STATE OF MARYLAND
6103-R

Professional Certification: I certify that these documents were prepared or approved by me, and that I am a duly licensed architect under the laws of the State of Maryland.
License No: 6103-R Expiration Date: 08/03/2022

EWING COLE

Coverage ©2021 by EWINGCOLE

PROJECT NO. 20200550 SCALE 1/16" = 1'-0"
DRAWING NAME PARKING GARAGE - FLOOR PLANS

ALEXANDRIA REAL ESTATE EQUITIES

9800 MEDICAL CENTER DRIVE,
PARKING DECK
ROCKVILLE, MD 20850

DRAWN BY Author DATE 02/19/21
FLOOR/SECTION PHASE DRAWING NO. A0.04