

NOTE:
TREES STARTING WITH "#100" SERIES
ARE FOR CITY OF TAKOMA PARK TREE
PROTECTION PERMITTING PURPOSES
ONLY.

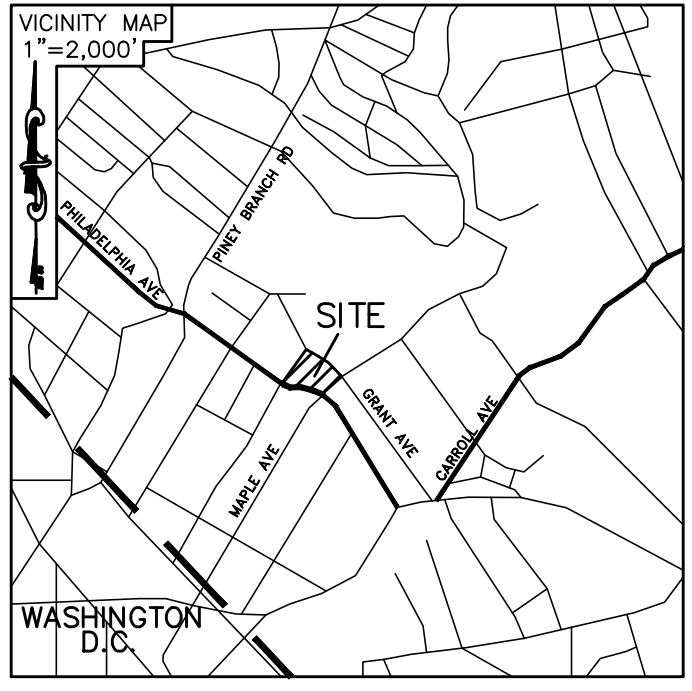

ADTEK
CIVIL STRUCTURAL SPECIALTY ENGINEERING
150 South East Street, Suite 201
Frederick, Maryland 20701
Phone: 301-662-4406
www.ADTEKengineers.com

STANDARD TREE SAVE NOTES

INSPECTIONS
All field inspections must be requested by the applicant.
Field Inspections must be conducted as follows:
Plans without Planting Requirements
1. After the limits of disturbance have been staked and flagged, but before any clearing or grading begins.
2. After necessary stress reduction measures have been completed and protection measures have been installed, but before any clearing and grading begin and before release of the building permit.
3. After completion of all construction activities, but before removal of tree protection fencing, to determine the level of compliance with the provision of the forest conservation.
Additional Requirements for Plans with Planting Requirements

Tree Summary 7"±						
Tree #	Species (Scientific Name)	Species (Common Name)	D.B.H. (inches)	Tree Condition	Comments	Disposition
1	QUERCUS PHELLOS	WILLOW OAK	29	FAIR	GIRDLED & EXPOSED ROOTS	REMOVE
2	QUERCUS PHELLOS	WILLOW OAK	39.5	FAIR	BROKEN BRANCHES, GIRDLED ROOTS	REMOVE
3	QUERCUS PRINUS	CHESTNUT OAK	41	FAIR	ROOT GIRDLING	SAVE & PROTECT
4	QUERCUS RUBRA	RED OAK	29	GOOD		SAVE & PROTECT
5	QUERCUS RUBRA	RED OAK	40	GOOD	EXPOSED ROOTS	SAVE & PROTECT
6	QUERCUS PRINUS	CHESTNUT OAK	26	FAIR	DEAD BRANCHES. SPLIT @ 5'	SAVE & PROTECT
7	QUERCUS RUBRA	RED OAK	35	GOOD		SAVE & PROTECT
8	QUERCUS RUBRA	RED OAK	28	GOOD	EXPOSED ROOTS	SAVE & PROTECT
9	ACER SACCHARINUM	SILVER MAPLE	28.27	GOOD	SPLIT @ GROUND	SAVE & PROTECT
10	QUERCUS STELLATA	POST OAK	28	GOOD	OHV	SAVE & PROTECT
11	QUERCUS PHELLOS	WILLOW OAK	39	GOOD	EXPOSED ROOTS	SAVE & PROTECT
100	PLATANUS OCCIDENTALIS	SYCAMORE	20	GOOD		REMOVE
101	QUERCUS PHELLOS	WILLOW OAK	19.5	GOOD	EXPOSED ROOTS	REMOVE
102	GLEDITSIA TRIACANTHOS	HONEY LOCUST	11	GOOD		REMOVE
103	PICEA ABIES	NORWAY SPRUCE	22	FAIR	HEAVY WOODPECKER DAMAGE	REMOVE
104	QUERCUS ALBA	WHITE OAK	12	GOOD		SAVE & PROTECT
105	QUERCUS ALBA	WHITE OAK	13	GOOD		SAVE & PROTECT
106	ROBINIA PSEUDOACACIA	BLACK LOCUST	12	GOOD		SAVE & PROTECT
107	ROBINIA PSEUDOACACIA	BLACK LOCUST	12.8	GOOD	SPLIT @ GROUND	SAVE & PROTECT
108	ILEX OPACA	HOLLY	11.6	GOOD	SPLIT @ 1'	SAVE & PROTECT
109	QUERCUS ALBA	WHITE OAK	15	GOOD		SAVE & PROTECT
110	PINUS STROBUS	WHITE PINE	15	GOOD	VINES	SAVE & PROTECT
111	PINUS STROBUS	WHITE PINE	11.17	GOOD	SPLIT @ 1.5'	SAVE & PROTECT
112	QUERCUS PHELLOS	WILLOW OAK	10	FAIR	HEAVY VINE	SAVE & PROTECT
113	QUERCUS PRINUS	CHESTNUT OAK	10	GOOD	VINES	SAVE & PROTECT
114	PINUS STROBUS	WHITE PINE	18	GOOD		SAVE & PROTECT
115	GLEDITSIA TRIACANTHOS	HONEY LOCUST	10	GOOD		REMOVE
116	QUERCUS RUBRA	RED OAK	10	GOOD		REMOVE
117	QUERCUS RUBRA	RED OAK	11	GOOD		REMOVE
118	GLEDITSIA TRIACANTHOS	HONEY LOCUST	10	GOOD		REMOVE

* BOLD TYPE DENOTES SPECIMEN TREES

Condition Scoring System	
No Apparent Problems	Excellent
Minor Problems	Good
Major Problems	Fair
Extreme Problems	Poor

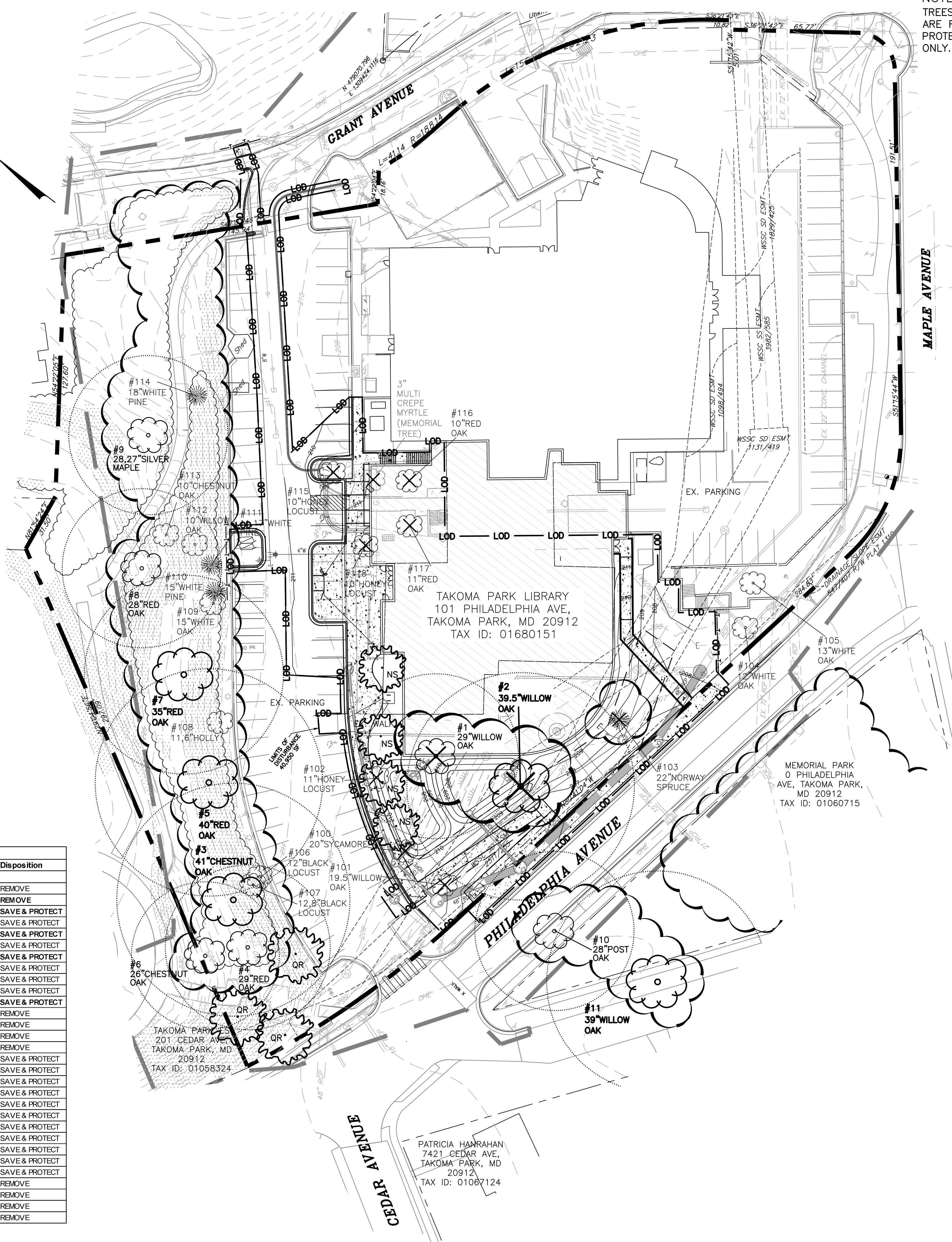

LEGEND

- EXISTING MEMORIAL TREE
- EXISTING TREE 7-23.9" DBH
- #1 26" MAPLE EXISTING SIGNIFICANT TREE ≥24" AND <30" DBH WITH CRZ
- #1 26" MAPLE EXISTING SPECIMEN TREE ≥30" WITH CRZ
- EXISTING PROPERTY BOUNDARY
- EXISTING ADJ PROPERTY BOUNDARY
- EX. CONTOUR
- SLOPES ≥25%
- 1' SURVEY BOUNDARY SURVEY BOUNDARY
- 2' MNCPPC GIS TOPO
- TREE CANOPY EXTENT (NOT FOREST)
- SCRUB/SHRUB AREA
- EXISTING EASEMENT BOUNDARY
- LOD — LOD — LIMITS OF DISTURBANCE
- T-T-T-T-T-T TREE PROTECTION FENCE
- X TREE TO BE REMOVED
- PROPOSED EASEMENT BOUNDARY
- PROPOSED BUILDING ADDITION
- PROPOSED MITIGATION CANOPY TREE

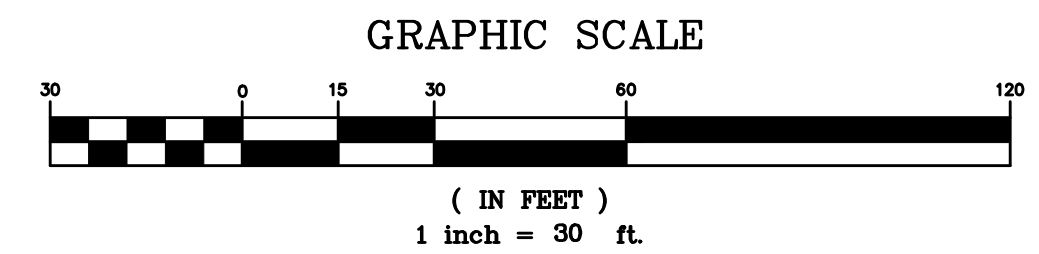

NORTON LAND DESIGN
LANDSCAPE ARCHITECTURE + ENVIRONMENTAL PLANNING
5146 DORSEY HALL DRIVE, 2ND FLOOR ELLICOTT CITY, MD 21042
BALT. 443.542.9199 WWW.NORTONLANDDESIGN.COM

CERTIFICATION OF QUALIFIED PROFESSIONAL
I HEREBY CERTIFY THAT THE PLAN SHOWN HEREON HAS BEEN PREPARED IN ACCORDANCE WITH MARYLAND STATE, MNC&PC AND MONTGOMERY COUNTY FOREST CONSERVATION LAWS.

3.8.2021
DATE

MICHAEL A. NORTON
MDNR / COMAR 08.19.06.01
QUALIFIED PROFESSIONAL

WATER CLASS	WATERSHED	FEMA FLOODPLAIN MAP PANEL #
TRIBUTARY	SLIGO CREEK	24031C0460D
TAX MAP	200 SHEET	ADC MAP PAGE
JN342	209NW01	37 GRID D-12
SCALE	DATE	PROJ. NO.
AS SHOWN	MARCH 2021	16-127
DRAWN BY:	BP	CHECKED BY:
DATE	MARCH 16, 2021	PROJECT NUMBER:
SHEET NO.	1 OF 2	DRAWING NUMBER:
		L-1.1

TAKOMA PARK LIBRARY RENOVATION
101 PHILADELPHIA AVE
TAKOMA PARK, MARYLAND
MONTGOMERY COUNTY

TREE SAVE PLAN
SHEET 1 OF 2
DRAWING NUMBER: L-1.1