

MSS UTILITY
Call Miss Utility at 1-800-251-7777, 48 hours prior to the start of work. The contractor must notify all public utility companies with underground facilities in the area of proposed excavation and have those facilities located by the utility companies prior to commencing excavation. The contractor is responsible for compliance with requirements of Chapter 28A of the Montgomery County Code.

DEVELOPER'S CERTIFICATE - GREENTREE FARM
The undersigned agrees to provide all the terms of the Agreement Final Forest Conservation Plan No. 12009010 including, financial bonding, third-party maintenance and all other application agreements.
Developer's Name: Greentree Farm, LLC
Contact Person or Owner: John H. Hinkle
Address: 13300 Whitlog Square Road, Silver Spring, MD 20904
Phone # and Email: 301-544-8888
Signature: John H. Hinkle

LEGEND:

CANOPY COVERAGE	
CRITICAL ROOT ZONE	
EXISTING BUILDING	
EXISTING CATEGORY I CONSERVATION EASEMENT	
FOREST TO BE CLEARED	
FOREST RETENTION AREA	
LIMITS-OF-DISTURBANCE	
MITIGATION TREE PLANTING	
ON-SITE FOREST	
PROPERTY LINE	
PERMANENT FOREST PROTECTION SIGN	
ROOT PRUNING	
SIGNIFICANT / SPECIMEN TREE	
SIGNIFICANT / SPECIMEN TREE TO BE REMOVED	
SOILS SERIES DIVIDE	
STREAM BUFFER	
TREE PROTECTION FENCE	
TREE PROTECTION SIGN	

- LIST OF AMENDMENT ITEMS**
- The addition of two new barns and associated improvements was added to the plan. The remainder which has an address of 17300 White Stone Road.
 - The plan was revised to show that the main house and guest house on the site are to be demolished and new homes are to be built to replace them.
 - New limits of disturbance (LOD) areas were added to the plan on the farm buildings at 13300 White Stone Road. The new barns, demolition and replacement homes, and associated site improvements including septic fields.
 - The FCP was revised to include the new LOD areas shown on 17300 White Stone Road in the net lot area. The areas were previously included in the area excluded from the plan for agricultural uses.
 - The notes below the FCP worksheet were updated to show how the additional information requirement will be met.
 - The plan and tree list were revised to propagate removal of ST-25 which falls within the LOD area added to the plan.



FINAL FOREST CONSERVATION PLAN
GREENTREE FARM
(WSSC Grid Sheet 228NW17; Tax Map DU 13)
Montgomery County, Maryland

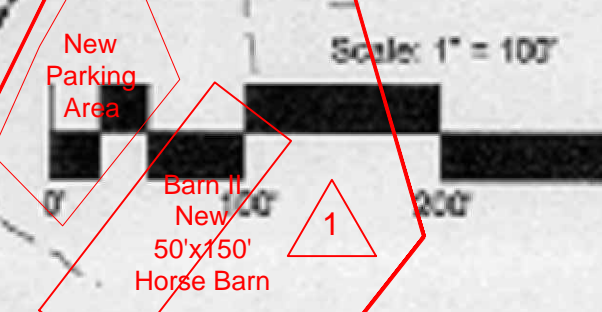

APPROVED
JUN 17 2016
MONTGOMERY COUNTY
DEPARTMENT OF PERMITS
05-29-2016

THE MARYLAND-NATIONAL CAPITAL PARK AND PLANNING COMMISSION
Final Forest Conservation Plan
APPROVAL
Plan No. 12009010
Signature: [Signature] Date: [Date]

RECORDED
JUN 17 2016
MONTGOMERY COUNTY
DEPARTMENT OF PERMITS

Denning & Associates, Inc.
Land Planning Consultants
10000 Rockville Pike, Suite 300
Rockville, MD 20850
(301) 948-6000

D&A

date: 05/15/2015
scale: 1" = 100'



HANDOVER
PLAT NO. 20826