

- SITE PLAN AMENDMENT #82017017B REVISIONS:**
- ▲ MINOR MODIFICATIONS TO STREET GRADE, LAYOUT AND MATERIALS;
 - ▲ MINOR MODIFICATIONS TO SIDEWALK LAYOUT AND MATERIALS;
 - ▲ MINOR MODIFICATIONS TO SITE LANDSCAPING, OPEN SPACE AND SWM FACILITIES;
 - ▲ MINOR MODIFICATIONS TO LOT LAYOUT;
 - 5. CREATION OF TWO NEW PHASES, 2A AND 2B (FORMERLY PHASE 2); AND
 - 6. SMALL EXPANSION AND MINOR MODIFICATIONS TO CLUBHOUSE.

ILLUMINATION LEVELS NOTE

ILLUMINATION LEVELS SHOWN IN LUX NOT FOOT-CANDLES (fc) ON PHOTOMETRIC PLAN BECAUSE MAJORITY OF SITE ROADS ARE CURVED AND IES HAS CONVERSIONS BASED ON ROAD REFLECTANCE TO GO TO LUX.

ONE (1) FOOT-CANDLE EQUALS 10.764 LUX; HOWEVER, A 1:10 CONVERSION IS TYPICAL IN LIGHTING INDUSTRY.

- LEGEND**
- SITE LIMITS
 - PUBLIC STREET RIGHT OF WAY
 - LOT LINES
 - EASEMENTS
 - CONCRETE OR PAVER WALK
SEE SITE MATERIALS EXHIBIT ON SHEET 18
 - NATURAL SURFACE TRAIL
 - PUBLIC STREETS
 - PRIVATE STREETS, LANES AND ALLEYS
SEE SITE MATERIALS EXHIBIT ON SHEET 18
 - WATER
 - SEWER
 - STORM DRAIN
 - EXISTING CONTOURS
 - PROPOSED CONTOURS
 - LOD
 - LIMIT OF DISTURBANCE
 - STREAMS
 - WETLANDS
 - WETLANDS BRL
 - STREAM VALLEY BUFFER (SVB)
 - FOREST CONSERVATION EASEMENT
 - EXISTING TREE CANOPY, HEDGEROW
 - PROPOSED TREE CANOPY, HEDGEROW
 - MAILBOX CLUSTER
SEE HARDSCAPE DETAILS ON SHEET 39
 - BENCH TYPE #8
SEE HARDSCAPE DETAILS ON SHEET 39
 - TRASH CAN
SEE HARDSCAPE DETAILS ON SHEET 39
 - SCULPTURES AND LOW TABLES
SEE HARDSCAPE DETAILS ON SHEET 38
 - PUBLIC/PRIVATE ADA ACCESSIBLE RAMP AT ALL SIDEWALKS/PATHS CONNECTING TO A CURBED STREET
SEE RAMP DETAILS ON SHEET 16

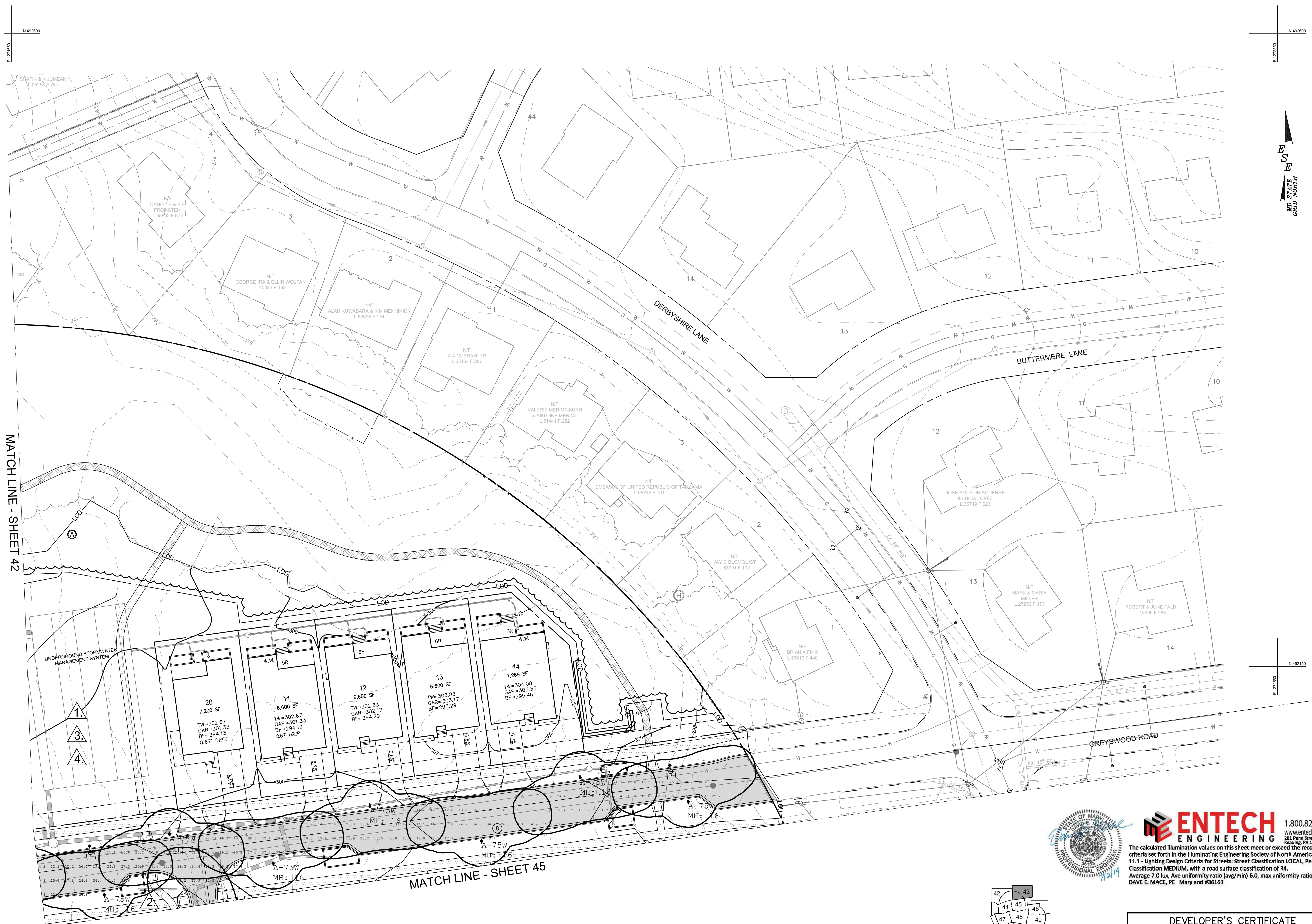

MATCH LINE - SHEET 45

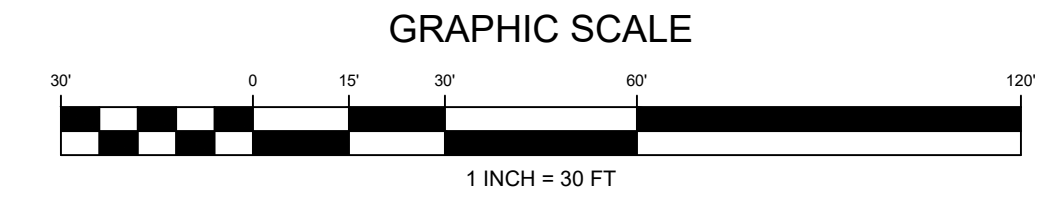

NOTE: MINOR MODIFICATIONS TO THE LIMITS OF DISTURBANCE SHOWN ON THE SITE PLAN WITHIN THE PUBLIC RIGHT-OF-WAY FOR UTILITY CONNECTIONS MAY BE DONE DURING THE REVIEW OF THE RIGHT-OF-WAY PERMIT DRAWINGS BY THE DEPARTMENT OF PERMITTING SERVICES.

NOTE: ARCHITECTURAL FOOTPRINTS ARE SHOWN FOR ILLUSTRATIVE PURPOSES ONLY. FINAL ARCHITECTURES AND BUILDING HEIGHT SHALL BE DETERMINED AT BUILDING PERMIT.

NOTE: M-INPPC STAFF MUST INSPECT ALL TREE-SAVE AREAS AND PROTECTION DEVICES BEFORE CLEARING AND GRADING.

NOTE: UTILITIES SHOWN ARE FOR INFORMATIONAL PURPOSES AND ARE SUBJECT TO CHANGE AT FINAL ENGINEERING.



ENTECH ENGINEERING 1.800.825.1372
www.ientech.com
292 Palm Street, Suite 3
Baltimore, MD 21201

The calculated illumination values on this sheet meet or exceed the recommended criteria set forth in the Illuminating Engineering Society of North America RP-8-18 Table 11.1 - Lighting Design Criteria for Streets: Street Classification LOCAL, Pedestrian Activity Classification MEDIUM, with a road surface classification of RA.

Average 7.0 lux, Ave uniformity ratio (avg/min) 6.0, max uniformity ratio (max/min) 10.0.
DAVE E. MACE, PE Maryland #36163

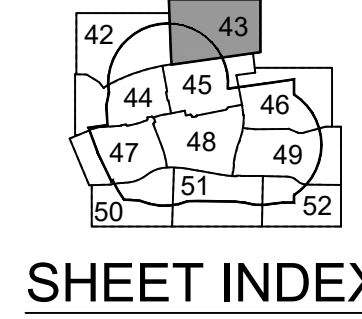

DEVELOPER'S CERTIFICATE

The undersigned agrees to execute all the features of the Site Plan Approval No. 82017017B, including Approval Conditions, Development Program, and Certified Site Plan.

Developer: WCTL AMALYN LLC Jeff Driscoll
Company Contact Person

Address: 6731 COLUMBIA GATEWAY DRIVE, SUITE 120 COLUMBIA MD 21046

Phone: 410-872-9105

Signature: _____

**08-BLL-82017017B-021
SITE PLAN #82017017B**

ESE CONSULTANTS
ENGINEERING • PLANNING • SURVEYING • ENVIRONMENTAL

ESE Consultants, Inc.
7164 Columbia Gateway Drive • Suite 230 • Columbia, MD 21046
T: 410-872-9105

| REVISED: | DATE: | REVISED: | DATE: |
|--------------------------------|---------|----------|-------|
| SITE PLAN #82017017B AMENDMENT | 10/2021 | | |

PROFESSIONAL CERTIFICATION

I HEREBY CERTIFY THAT THESE DOCUMENTS WERE PREPARED OR APPROVED BY ME, AND THAT I AM A DULY LICENSED PROFESSIONAL ENGINEER UNDER THE LAWS OF THE STATE OF MARYLAND.

51668
LICENSE NO.
01/19/2025
EXPIRATION DATE

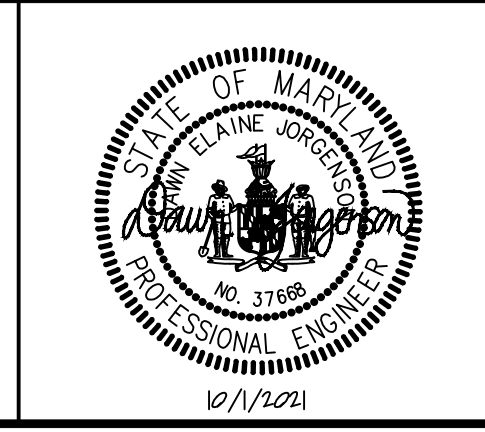

APPLICANT:
TOLL MD VII LIMITED PARTNERSHIP
c/o TOLL BROS., INC.
7164 COLUMBIA GATEWAY DRIVE, SUITE 230
COLUMBIA, MARYLAND 21046
ATTN: MR. MATT CAPECE
PHONE: 410-872-9105
FAX: 410-872-9141

MISS UTILITY NOTE

INFORMATION CONCERNING EXISTING UNDERGROUND UTILITIES WAS OBTAINED FROM AVAILABLE RECORDS. THE CONTRACTOR MUST DETERMINE THE EXACT LOCATION AND ELEVATION OF ALL EXISTING UTILITIES AND UTILITY CROSSINGS BY DIGGING TEST PITS BY HAND, WELL IN ADVANCE OF THE START OF EXCAVATION. CONTACT "MISS UTILITY" AT 1-800-257-7777, 48 HOURS PRIOR TO THE START OF EXCAVATION. IF CLEARANCES ARE LESS THAN SHOWN ON THIS PLAN OR TWELVE (12) INCHES, WHICHEVER IS LESS, CONTACT THE ENGINEER AND THE UTILITY COMPANY BEFORE PROCEEDING WITH CONSTRUCTION. CLEARANCES LESS THAN NOTED MAY REQUIRE REVISIONS TO THIS PLAN.

**PHOTOMETRIC PLAN
AMALYN BETHESDA**

PARCEL N 495, PLAT 16552 L.34166 F.342
ELECTION DISTRICT NO. 7 BETHESDA, MONTGOMERY COUNTY, MARYLAND
WSSC MAP 212 NW 07, GRID B4-6 & C4-6
TAX MAP GP 342, GRID GP 42

| | |
|------------|----------------|
| GATE: | SEPTEMBER 2018 |
| DESIGN: | DRAWN: |
| SCALE: | 1" = 30' |
| JOB NO.: | 3891 |
| SHEET NO.: | 43 OF 60 |