

9 PLANTER WALL ON STRUCTURE
1" = 1'-0"

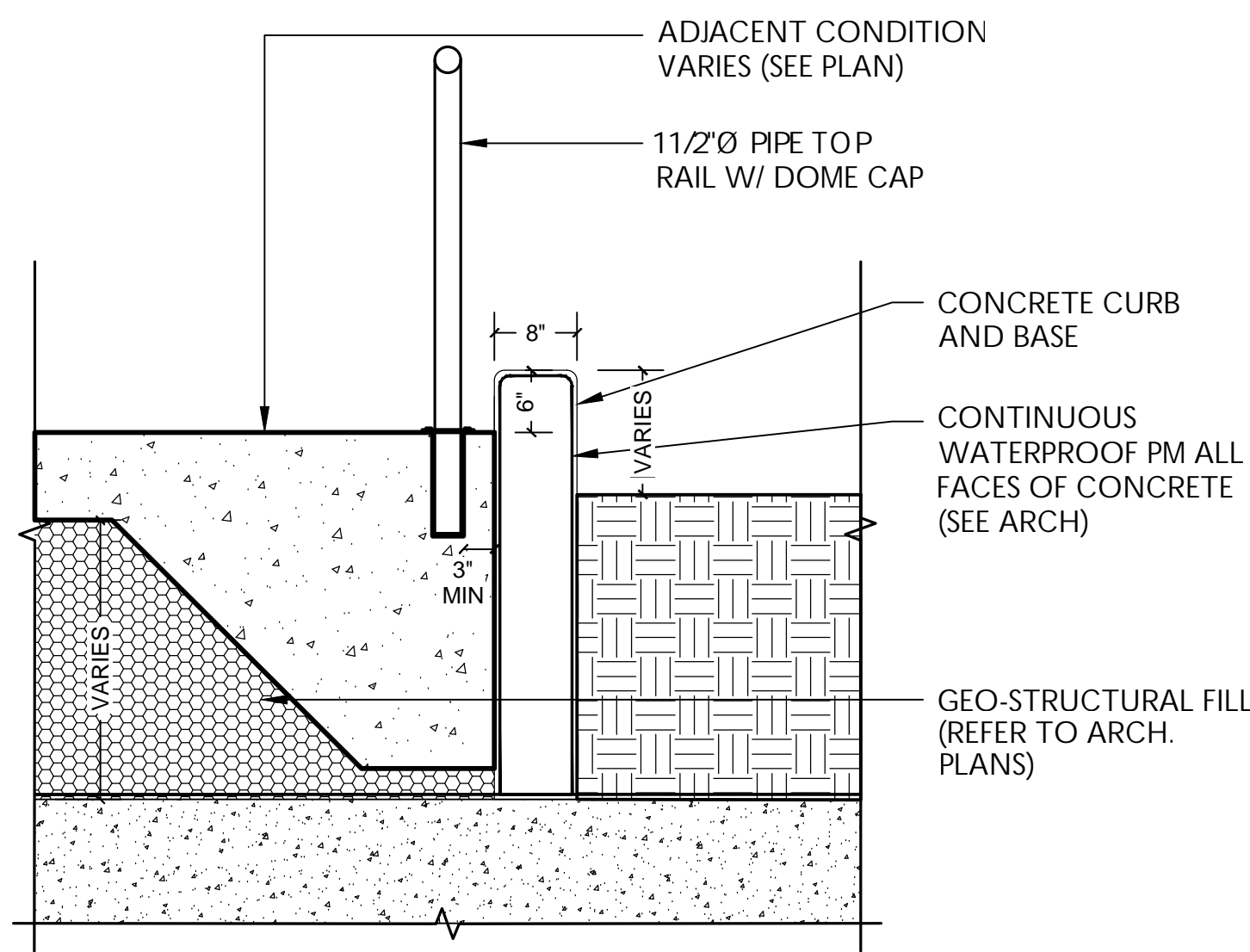

10 CURB WALL AT STAIRS
3/4" = 1'-0"

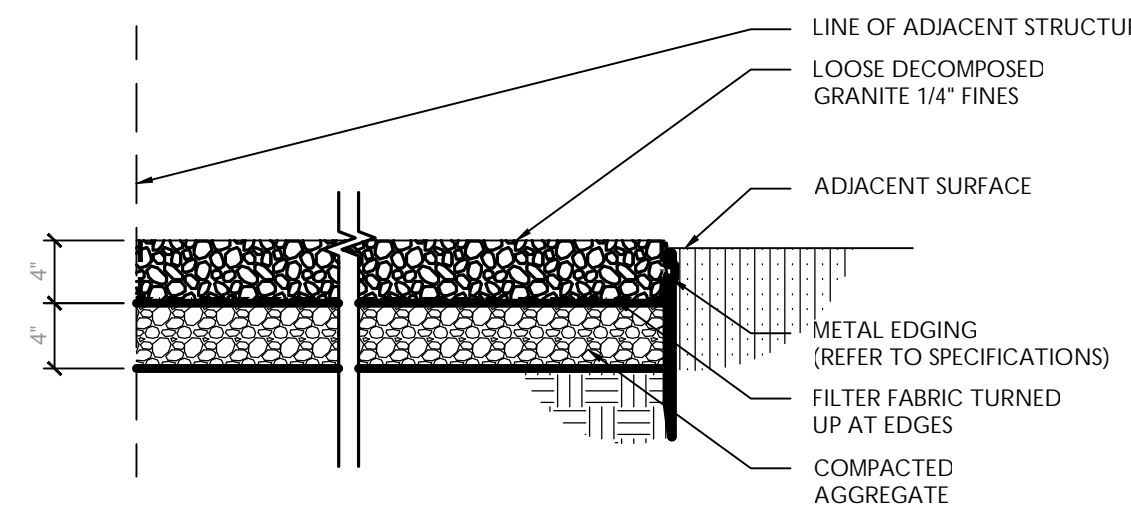

11 AGGREGATE / STONE AREA
1" = 1'-0"

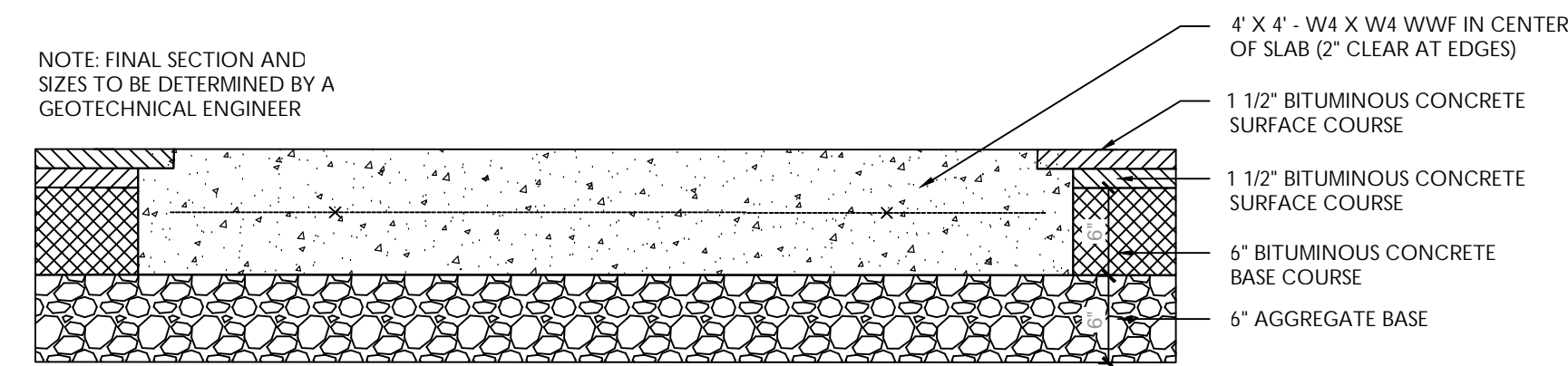

NOTE: FINAL SECTION AND SIZES TO BE DETERMINED BY A GEOTECHNICAL ENGINEER

NOTES:
1. FINAL ADJUSTMENTS TO THE PAVEMENT DESIGN SECTIONS MAY BE REQUIRED BASED ON RESULTS OF CORE TEST TAKEN ON THE PAVEMENT SUBGRADE SOILS AT THE TIME OF CONSTRUCTION. THE ASPHALT CONCRETE BASE COURSE SHOULD BE IN ACCORDANCE WITH THE APPLICABLE MARYLAND STATE HIGHWAY ADMINISTRATION SPECIFICATIONS.
2. FOLLOW MANUFACTURER'S RECOMMENDATIONS FOR SEALING GROOVES.

12 CONCRETE PAVING - LOADING DOCK
1" = 1'-0"

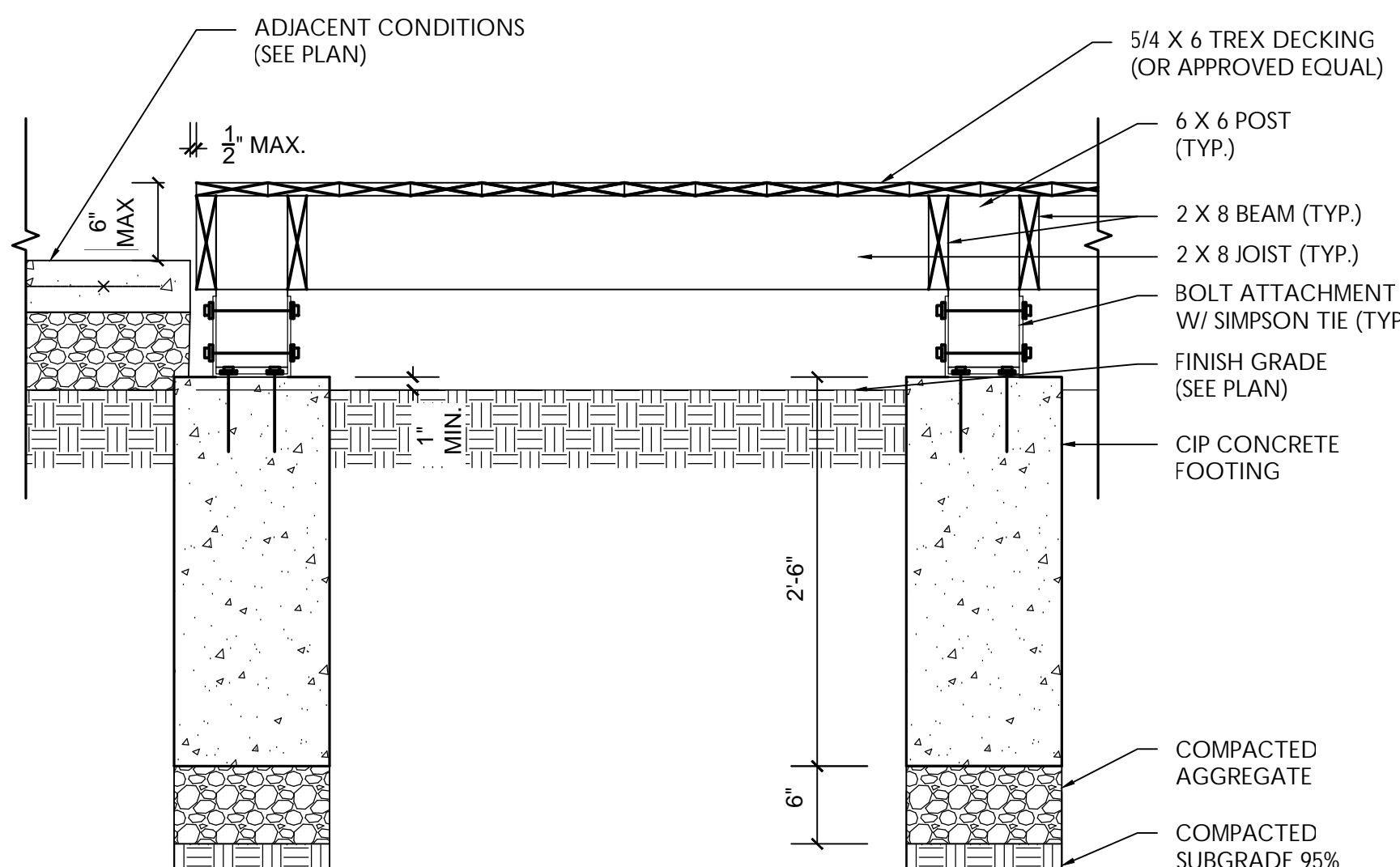

13 DECK ON GRADE
1" = 1'-0"

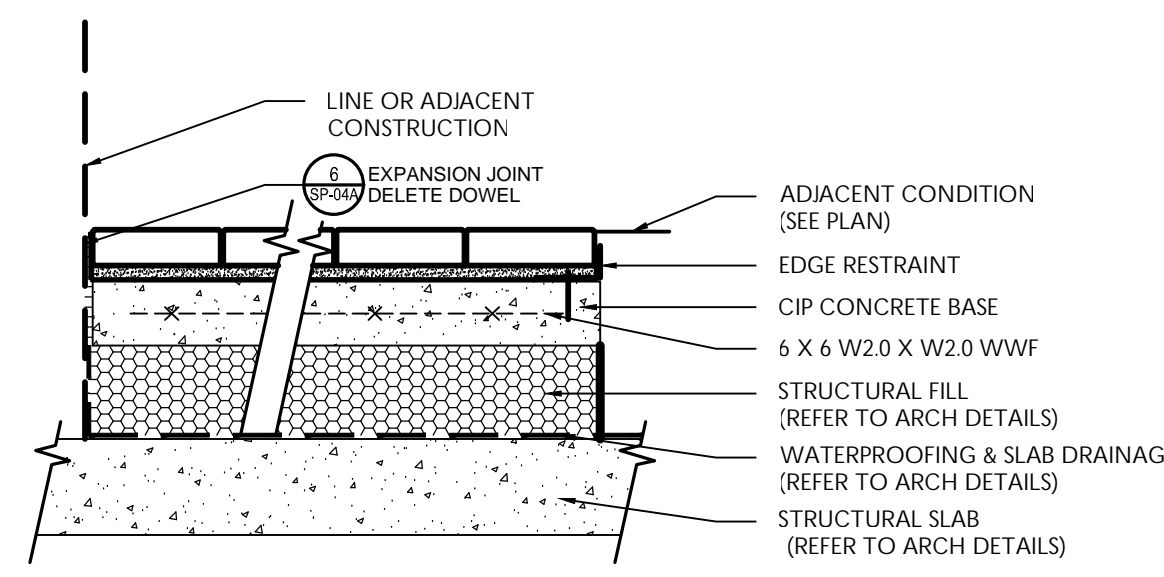

NOTES:
1. EDGE RESTRAINT: 3/4" x 1/4" GALVANIZED STEEL ANGLE ATTACHED TO TOP OF SLAB W/ EXPANSION ANCHORS. MIN. 24" O.C. INSTALL PAVER COURSES IN STRAIGHT LINES AND TRUE ARCS AND TANGENTS.
2. FOR ALL CUTS, REPLICATE EDGE CONDITION OF UNCLUT UNIT.
3. INSTALL CUT UNITS MIN. 10 UNITS FROM ENDS OF COURSE. CUT UNITS LESS THAN 4 PAVEMENT DIMENSION ARE PROHIBITED. REMOVE CUT UNIT AND 2 ADJACENT UNITS. INSTALL 3 EQUAL CUT UNITS.
4. FOR RADIAL COURSES, INSTALL SYMMETRICALLY CUT UNITS AT REGULAR INTERVALS. CUT EACH UNIT FOR SMALLER RADII AND AS DIRECTED BY ARCHITECT.

5 UNIT PAVING ON STRUCTURE
1" = 1'-0"

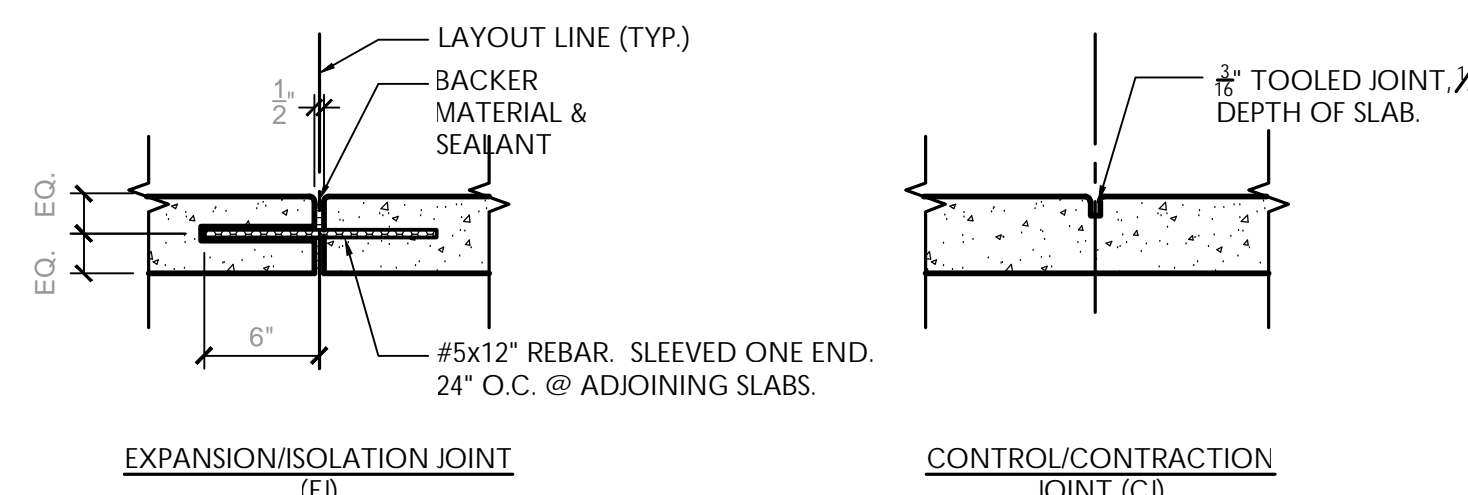

NOTES:
1. INSTALL CONTROL JOINTS AT EQUAL INTERVALS OF 5'-0" UNLESS OTHERWISE INDICATED.
2. INSTALL EXPANSION JOINTS @ 20'-0" INTERVALS MAX., UNLESS OTHERWISE INDICATED, AND WHERE SLAB MEETS ANY ADJACENT STRUCTURE.
3. TOOL ALL EXPOSED EDGES W/ 1/4" RADIUS.
4. RECESS EXPANSION JOINTS 1/2" BELOW FINISH GRADE.
5. SAWCUT JOINTS ARE PROHIBITED.

6 EXPANSION AND CONTROL JOINTS (PEDESTRIAN SIDEWALK)
1" = 1'-0"

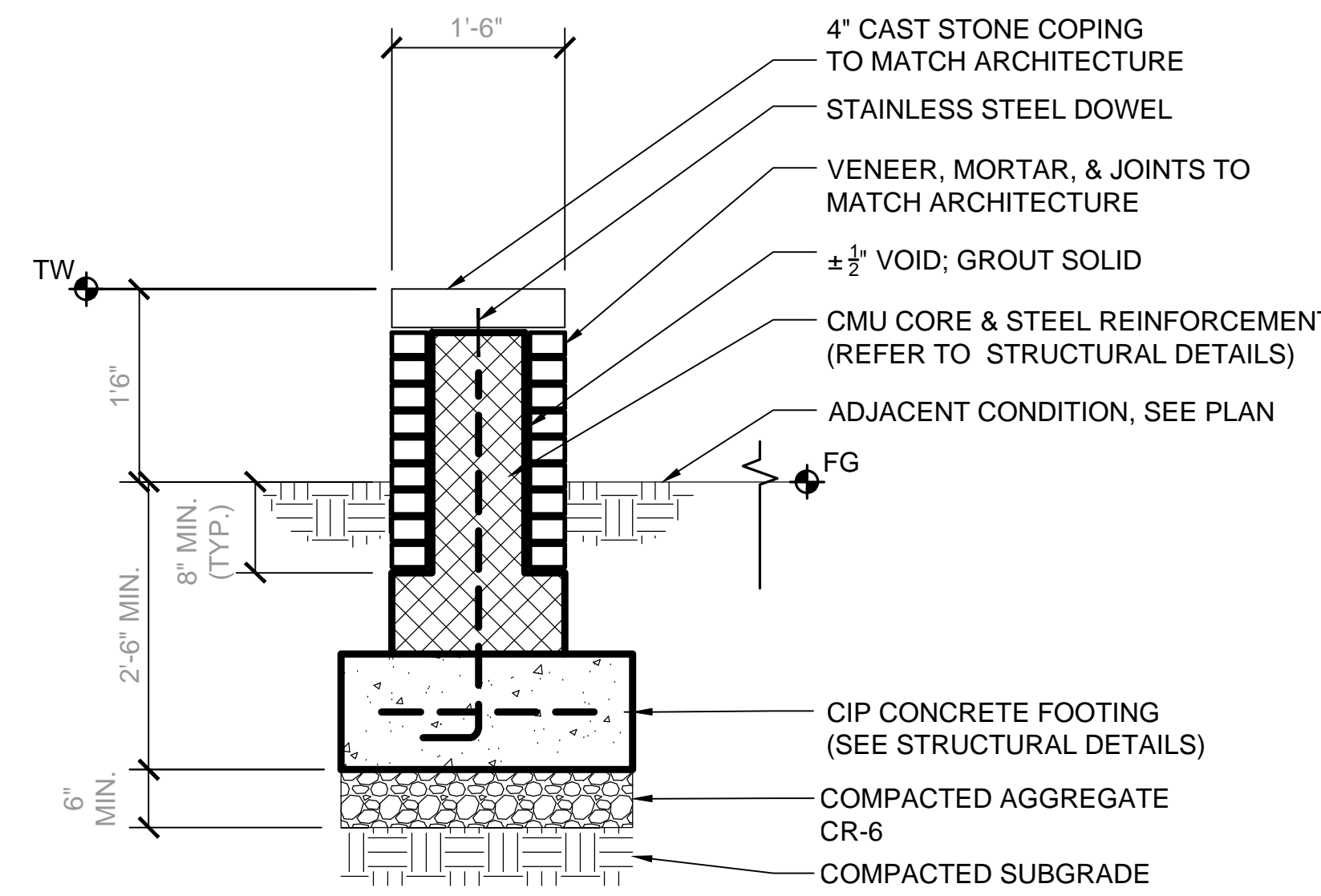

7 FREE-STANDING SEAT WALL ON GRADE
3/4" = 1'-0"

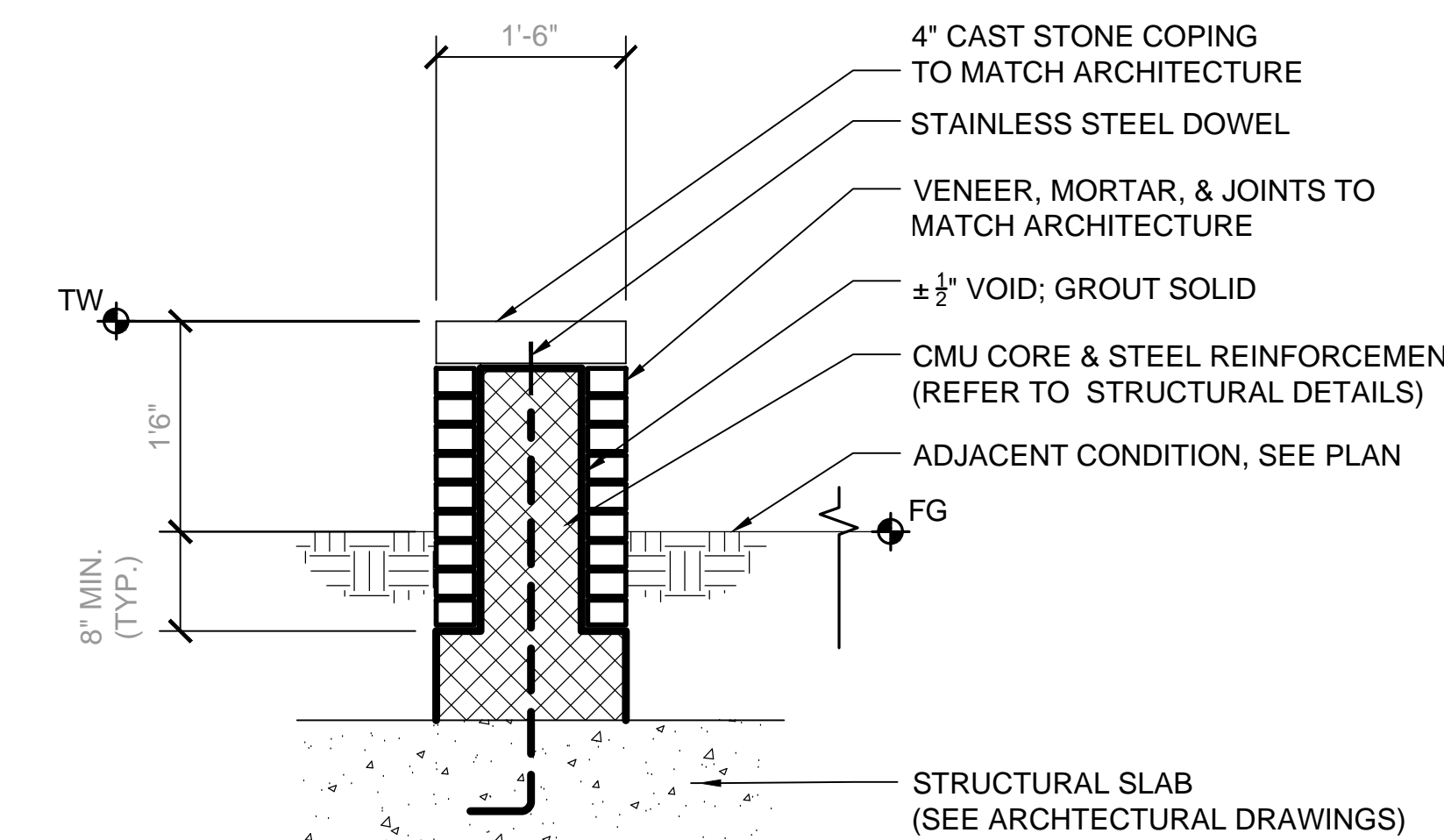

8 FREE-STANDING SEAT WALL ON STRUCTURE
3/4" = 1'-0"

LIST OF AMENDMENT ITEMS:

- RE-DESIGNED AREA 1C, LOCATED AT CLOVERLEAF CENTER SUBDIVISION LOTS 2.3 & 4, BLOCK A - FOR NEWLY PROPOSED BUILDING C1, C2, D, E, G, & H.
- ADDED NEW SHEET PER AMENDMENT.
- NO SHEET CHANGE.
- REVISED DEVELOPMENT PROGRAM AND BUILDING USES.
- REVISED DEVELOPMENT DATA TABLE AND/OR NOTES.
- RE-SUBDIVISION OF LOTS.
- REVISED ARCHITECTURE.
- REVISED LANDSCAPE/LIGHTING LAYOUT AND ASSOCIATED PLANTING SCHEDULES.
- REVISED UTILITY / WATER & SEWER LAYOUT CONNECTION FOR EACH PROPOSED BUILDING.
- REVISED SITE PLAN SHEET NUMBERS TO ACCOUNT FOR NEW SHEETS ADDED PER AMENDMENT.
- REVISED SHEET MATCH LINES PER REVISED LAYOUT.
- REVISED AMENITY AND PROGRAMMED SPACES AROUND NEW PROPOSED BUILDINGS.
- REVISED DEVELOPMENT PHASING.
- ADD / REMOVED DETAILS PER PROPOSED AMENDMENT.

2

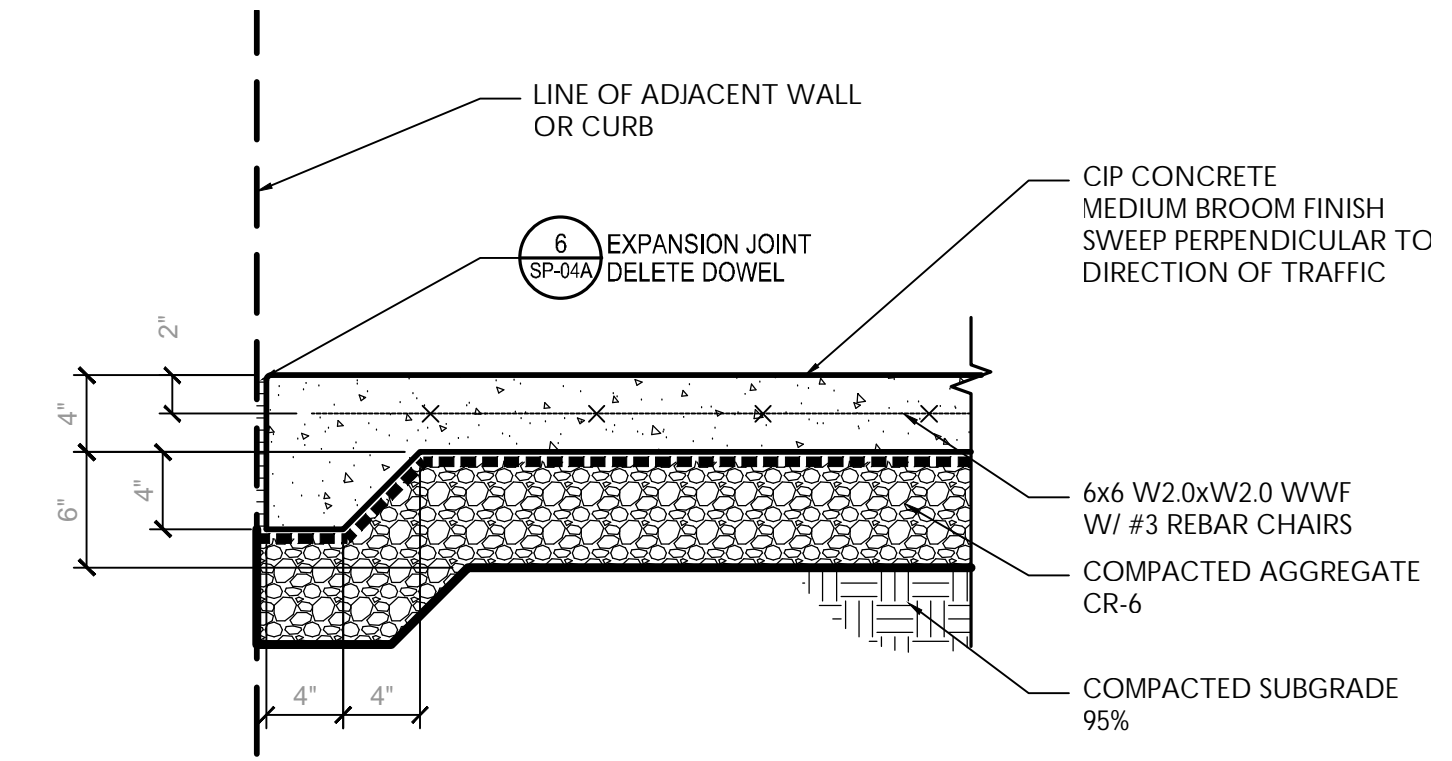

NOTES:
1. SIDEWALK AT VEHICULAR CROSSING SHALL BE A MINIMUM 7" THICK CONCRETE.

1 CONCRETE PAVING (PEDESTRIAN SIDEWALK)
1" = 1'-0"

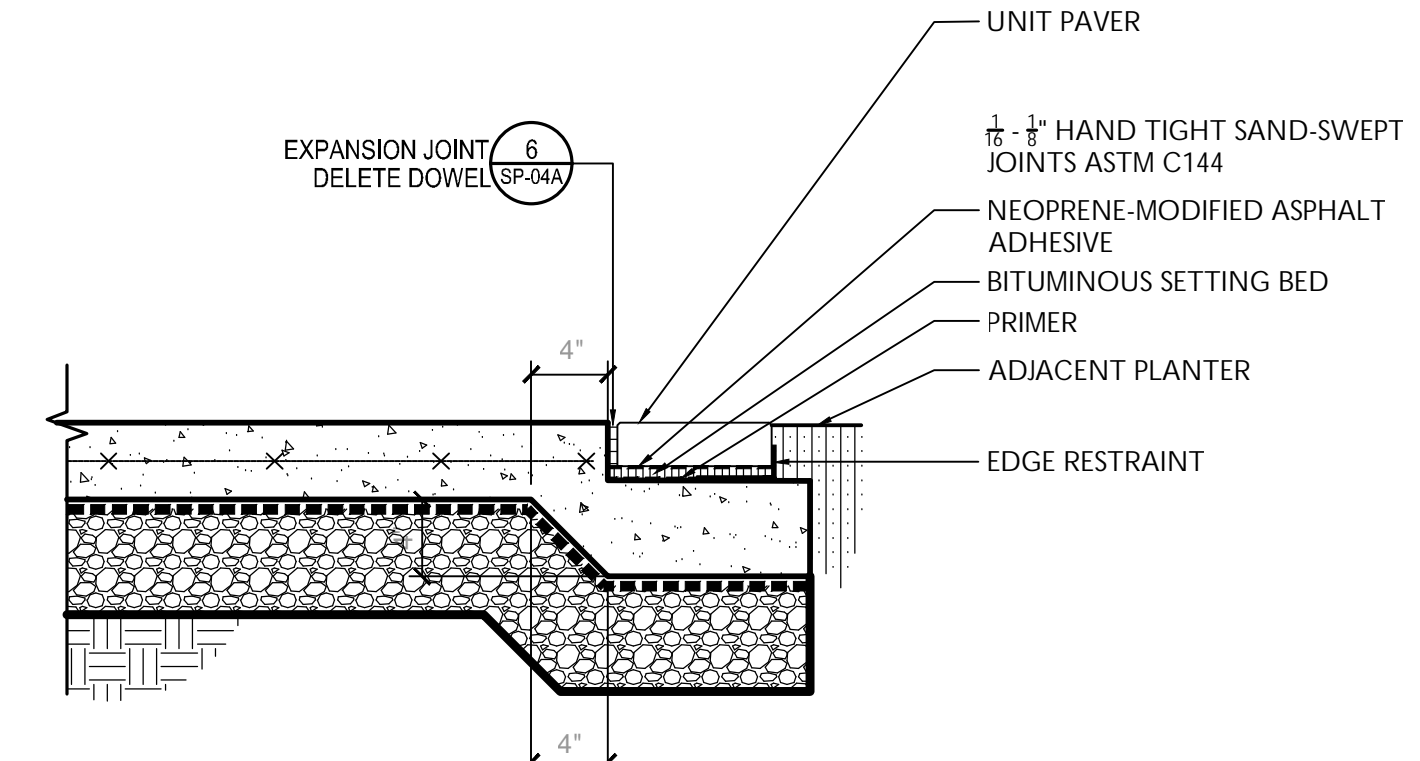

2 UNIT PAVING BAND
1" = 1'-0"

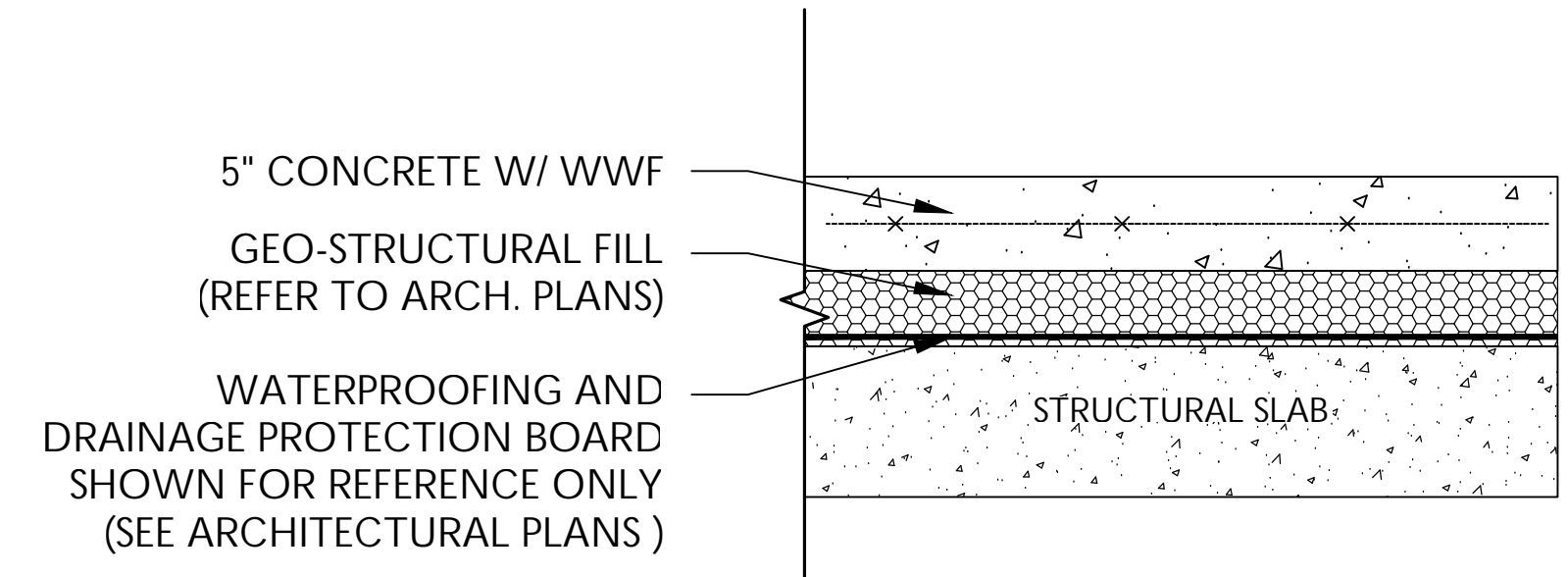

3 CONCRETE PAVING ON STRUCTURE
1" = 1'-0"

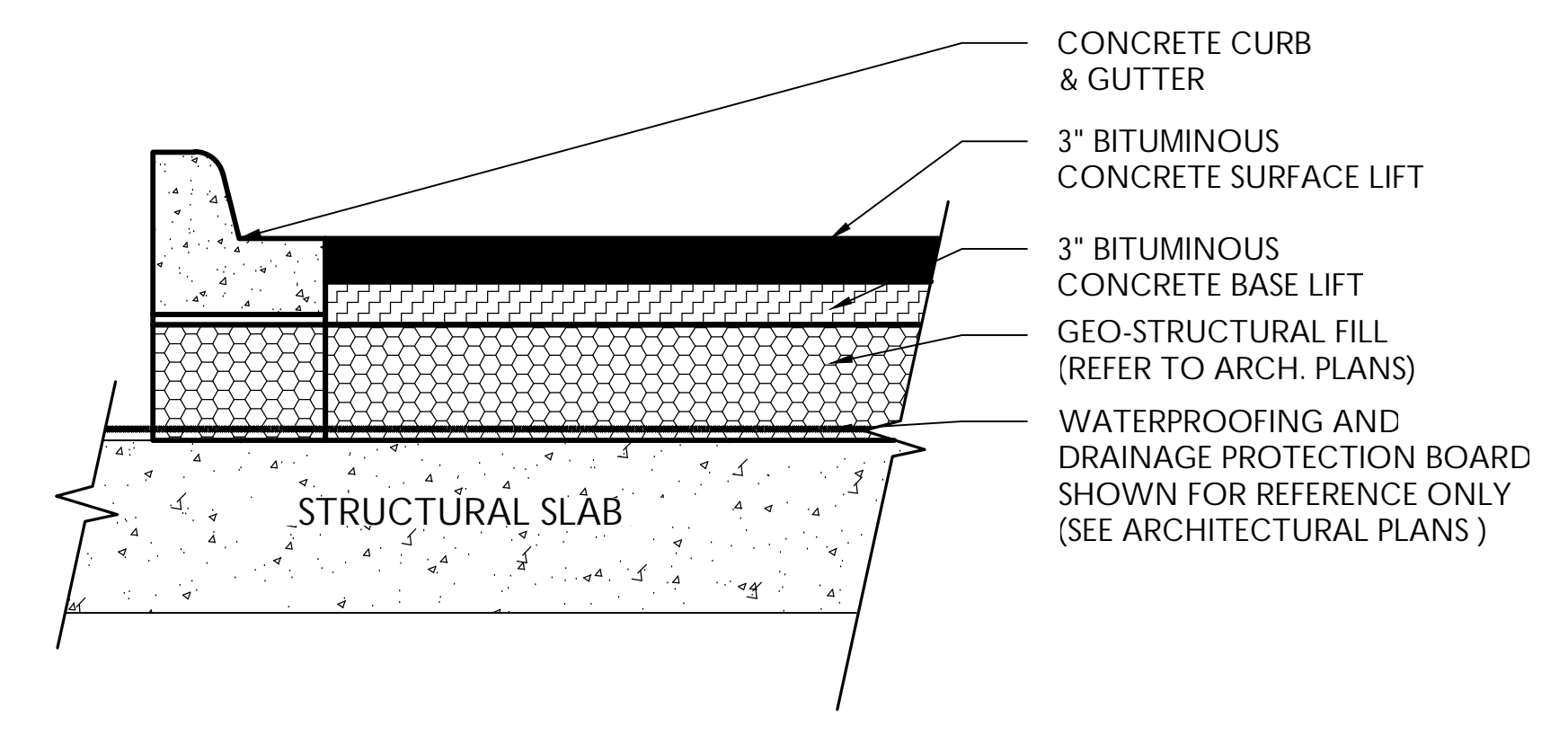

4 PAVEMENT SECTION OVER TOP STRUCTURE
1-1/2" = 1'-0"

Developer's Certificate
The Undersigned agrees to execute all the features of the Site Plan Approval No. 20210229 including Approval Conditions, Development Program, and Certified Site Plan.

Developer: Shamit Development Company Pradip Ghosh Contact Person

Address: 4495 Montgomery Road, Ellicott City, MD 21043

Phone: (443) 802-9077

Signature: Pradip Ghosh

Preliminary Not For Construction

1981 Century Boulevard, Suite 200, Germantown, Maryland 20854
Ph: 301.948.4700 (Dial), Fx: 301.948.6256, www.rodgers.com
DESIGN TEAM
Owner / Developer: **Shamit Development**
4495 Montgomery Road
Ellicott City, Maryland 21043
443.802.9077
Attn: Pradip Ghosh

Legal: **Lerch, Early & Brewer**
7600 Wisconsin Avenue
Suite 700
Bethesda, Maryland 20814
301.986.1300
Attn: Patrick O'Neil

Land Planning / Landscape Architect / Civil Engineering
Rodgers Consulting, Inc.
19847 Century Boulevard
Suite 200
Germantown, Maryland 20878
301.948.4700
Attn: Robert Graham

Architect: **Daniel Ball & Associates**
5513 Twin Knolls Road
Suite 216
Columbia, Maryland 21045
301.840.1100
Attn: Dan Ball

Traffic: **Symetra Design**
777 15th Street, NW
12th Floor
Washington, D.C. 20005
202.370.6000
Attn: Nicole White

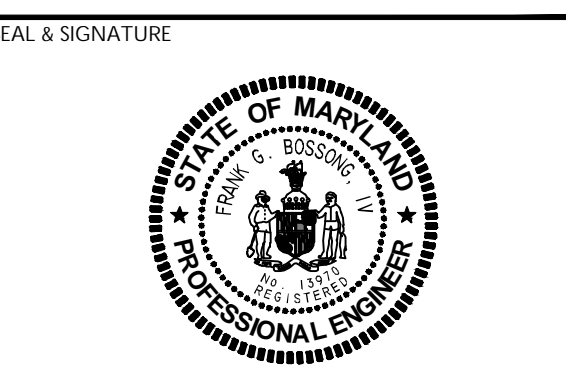

PROFESSIONAL CERTIFICATION
I hereby certify that these documents were prepared or approved by me and that I am a duly licensed professional engineer under the laws of the State of Maryland. License No. 13918, Expiration Date 6/1/22.

SEAL & SIGNATURE

CENTURY
Site Plan Amendment F
#82003007F

Cloverleaf Center, Parcels Z & AA
Montgomery County, Maryland, Clarksburg Election District 2

KEY PLAN

ISSUE DATE	DESCRIPTION
2021.10.29	MANPCPC - Initial Submission

REVISIONS NO.	DATE	DESCRIPTION

PROJECT NUMBER: 1252A1
DATE: 2021.10.29
SCALE: AS SHOWN
DRAWING TITLE: Details
DRAWING NUMBER: SP-04A