

**LIST OF AMENDMENT ITEMS:**

1. RE-DESIGNED AREA 1C, LOCATED AT CLOVERLEAF CENTER SUBDIVISION LOTS 2,3, & 4, BLOCK A - FOR NEWLY PROPOSED BUILDINGS D, E, G, & H AND FUTURE C1/C2 PAD SITE.
2. ADDED NEW SHEET PER AMENDMENT
3. NO SHEET CHANGE
4. REVISED DEVELOPMENT PROGRAM AND BUILDING USES.
5. REVISED DEVELOPMENT DATA TABLE AND/OR NOTES
6. RE-SUBDIVISION OF LOTS.
7. REVISED ARCHITECTURE.
8. REVISED LANDSCAPE/ LIGHTING LAYOUT AND ASSOCIATED PLANTING SCHEDULES.
9. REVISED UTILITY / WATER & SEWER LAYOUT CONNECTION FOR EACH PROPOSED BUILDING.
10. REVISED SITE PLAN SHEET NUMBERS TO ACCOUNT FOR NEW SHEETS ADDED PER AMENDMENT.
11. REVISED SHEET MATCH LINES PER REVISED LAYOUT.
12. REVISED AMENITY AND PROGRAMMED SPACES AROUND NEW PROPOSED BUILDINGS.
13. REVISED DEVELOPMENT PHASING.
14. ADD / REMOVED DETAILS PER PROPOSED AMENDMENT.

2

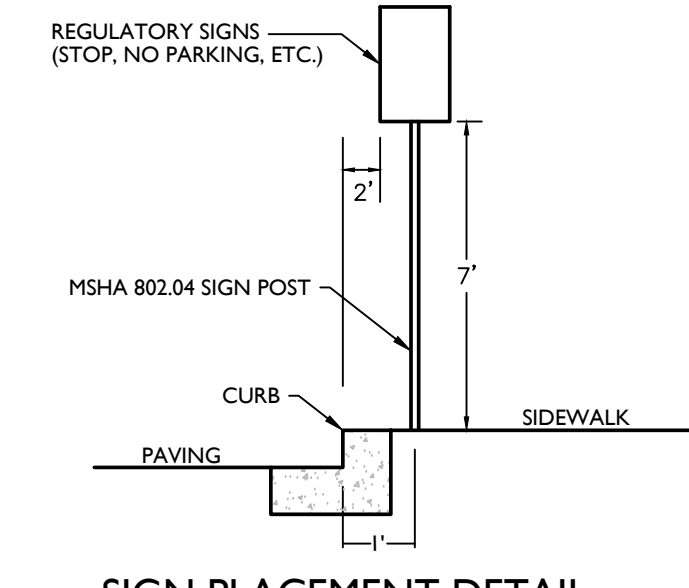

**SIGN PLACEMENT DETAIL**  
N.T.S.

- NOTES:**
1. ALL SIGNS AND MARKINGS SHALL BE IN CONFORMANCE WITH THE MARYLAND MANUAL ON UNIFORM TRAFFIC CONTROL DEVICES.
  2. ALL SIGNS TO BE PLACED ON METAL POSTS (BREAK-AWAY).

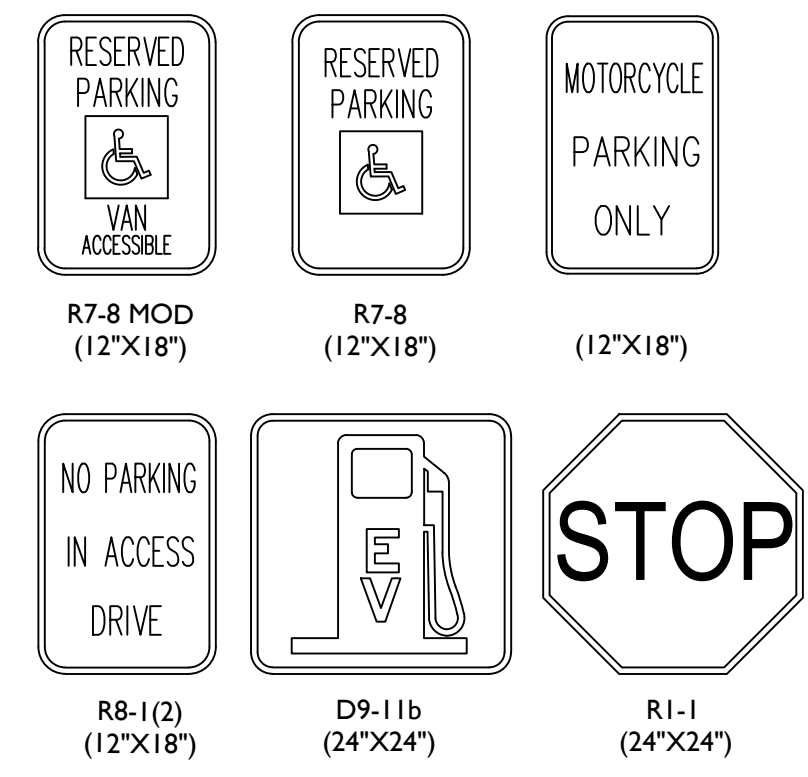

1 **SIGN AND SIGN PLACEMENT DETAIL**  
NTS

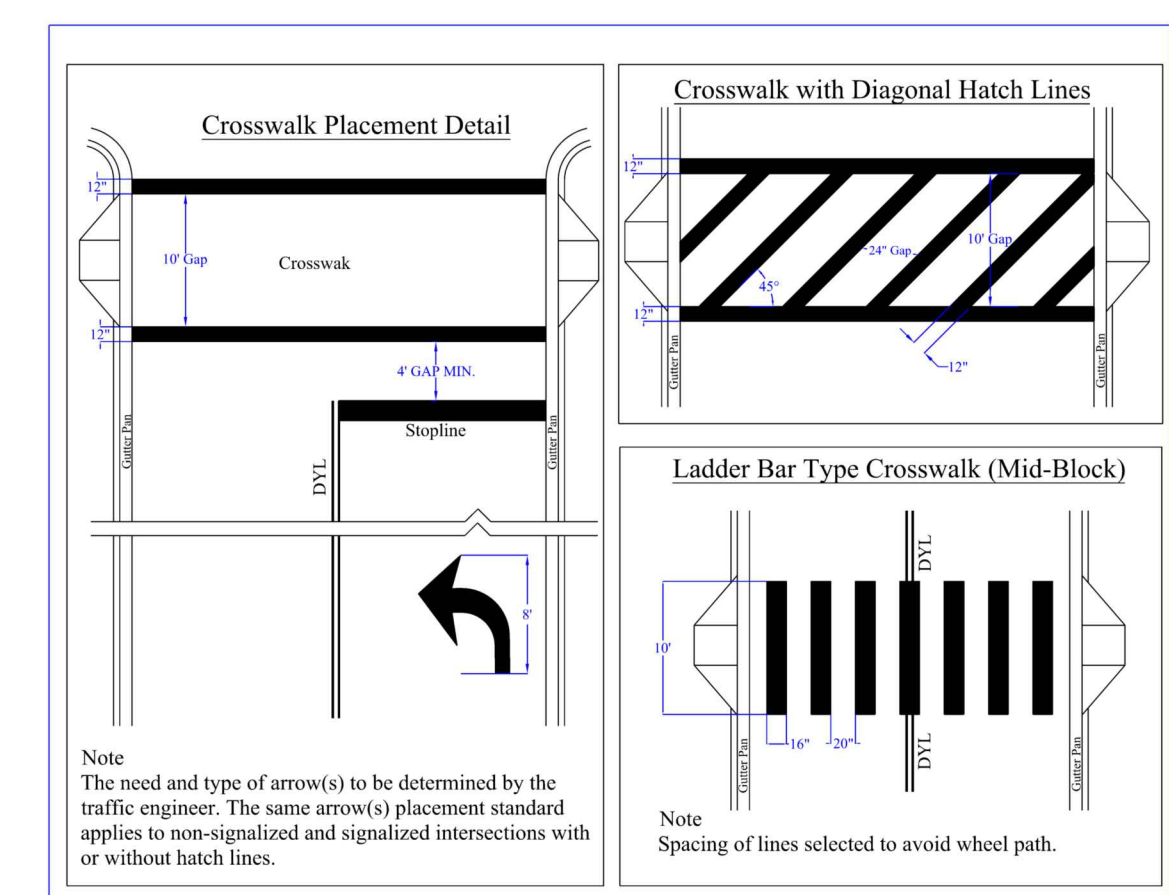

**GENERAL NOTES**

Crosswalks are to be Centered on the Handicap Ramps unless otherwise noted.  
Standard and Diagonal Crosswalk Lines are 12" Solid White Lines.  
Crosswalk and Stoplines Should Start End at the Curb Face.  
Ladder Bar Crosswalk Lines are 16" Solid White Lines.  
Stoplines are Solid White Lines.  
- 16" for Non-signalized Intersections  
- 24" for Signalized Intersections  
Arrows are 8" White Thermoplastic or Heat Applied Preformed Thermoplastic Material.  
DYL (Double Yellow Center Lines) are 5" Yellow Lines.

Number	Revision	Date	Appr	Date	Traffic Engineering and Operations Montgomery County Maryland
				Dec, 2004	
				Design BY SK	Crosswalk, Stopline and Arrow Placement Standards
				Drawn By SK	
				Scale None	Approved - Chief, Traffic Operations Section Drawing Number: 1 of 1

2 **ROAD MARKING DETAIL**  
NTS

**Developer's Certificate**  
The Undersigned agrees to execute all the features of the Site Plan Approval No. 20230516 including Approval Conditions, Development Program, and Certified Site Plan.

Developer: Shamit Development Company      Pradip Ghosh Contact Person

Address: 4495 Montgomery Road, Ellicott City, MD 21043

Phone: (443) 802-9077

Signature: Pradip Ghosh

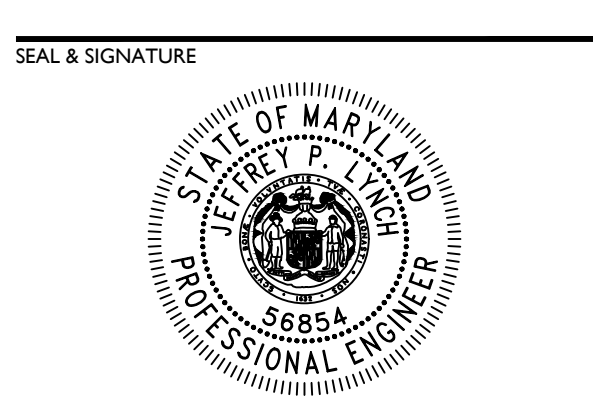

**PROFESSIONAL CERTIFICATION**  
I hereby certify the above documents were prepared or approved by me, and that I am a duly licensed professional engineer under the laws of the State of Maryland License No. 5854, Expiration Date: 12/31/24

**CENTURY**  
**Site Plan Amendment F**  
**#82003007F**  
 Cloverleaf Center, Parcels Z & AA  
 Montgomery County, Maryland, Clarksburg Election District 2

KEY PLAN

ISSUE DATE	DESCRIPTION
2021.10.29	M-NCPPC - Initial Submission
2021.11.30	M-NCPPC - In-Take Submission
2022.04.14	M-NCPPC - Post DRC Submission
2023.05.31	M-NCPPC - 2nd Post DRC Submission

REVISIONS NO	DATE	DESCRIPTION
--------------	------	-------------

PROJECT NUMBER	1252A1
DATE	2023.05.16
SCALE	AS SHOWN
DRAWING TITLE	Details