

COMBINED BASEMENT FLOOR PLAN FOR BUILDINGS H AND I

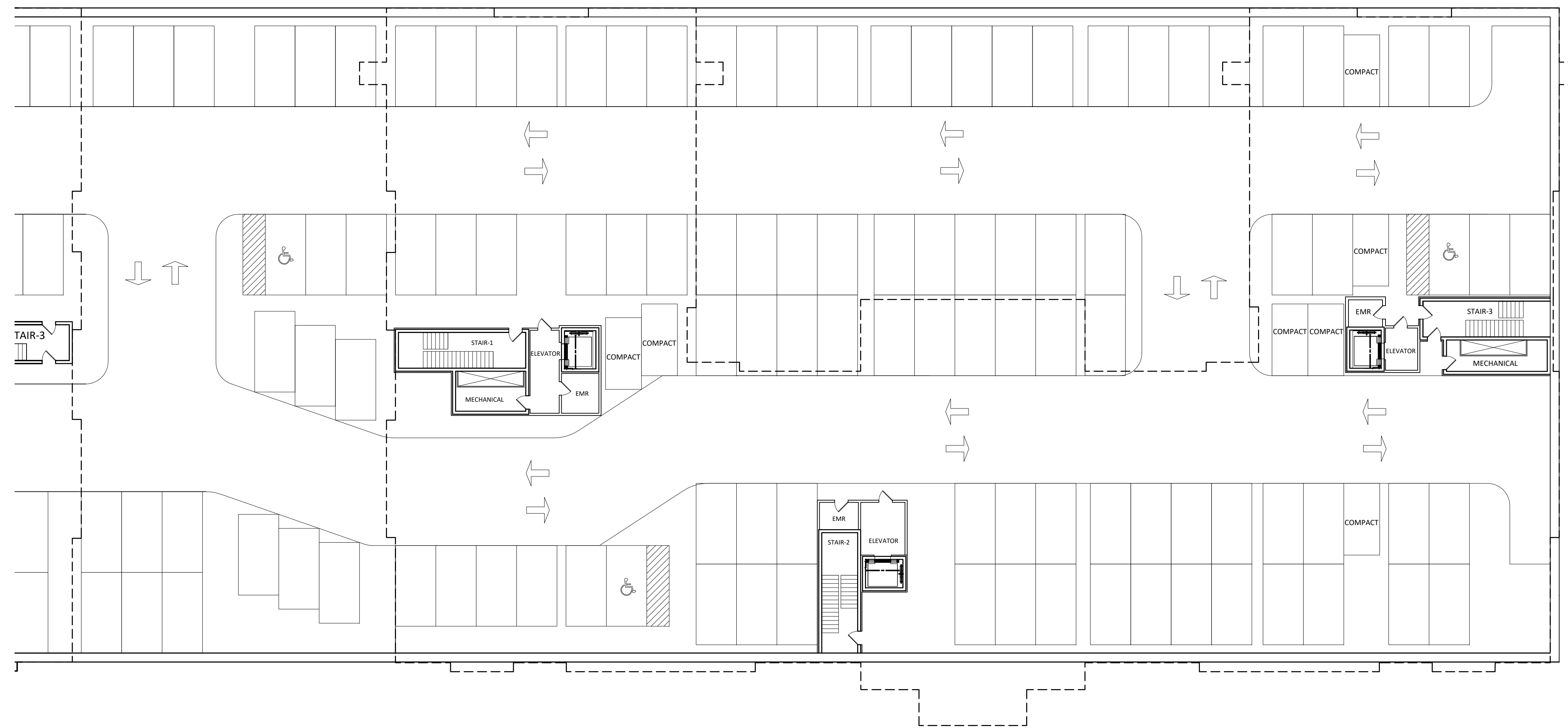

BASEMENT FLOOR PLAN-BUILDING H

SCALE: 0 5 FEET 10 FEET 20 FEET

COUNTY STAMP

ARCHITECT  
**d b a**  
**DANIEL BALL & ASSOCIATES**  
 ARCHITECTS + PLANNERS  
 5512 TWIN KNOLLS ROAD  
 SUITE 2110  
 COLUMBIA, MD. 21045  
 PHONE: (410) 719-0408  
 WWW: DBA-ARCH.NET  
 ©Copyright 2020

SEAL

Professional Certification:  
 I certify that these documents were prepared or approved by me, and that I am a duly Licensed Architect under the laws of the State of Maryland.  
 License number: 3731  
 Expiration Date: 5/31/2022

PROJECT  
 CENTURY LOTS 2,3, AND 4  
 RESIDENTIAL- H

SHEET TITLE  
 BASEMENT FLOOR PLAN

REV. NO.	DATE	DESCRIPTION

ORIGINAL ISSUE DATE	DRAWN BY <b>AM</b>
SCALE <b>AS NOTED</b>	CHECKED BY <b>AW</b>
SHEET NO. <b>A3.1</b>	