

COMBINED BASEMENT FLOOR PLAN FOR BUILDINGS H AND I

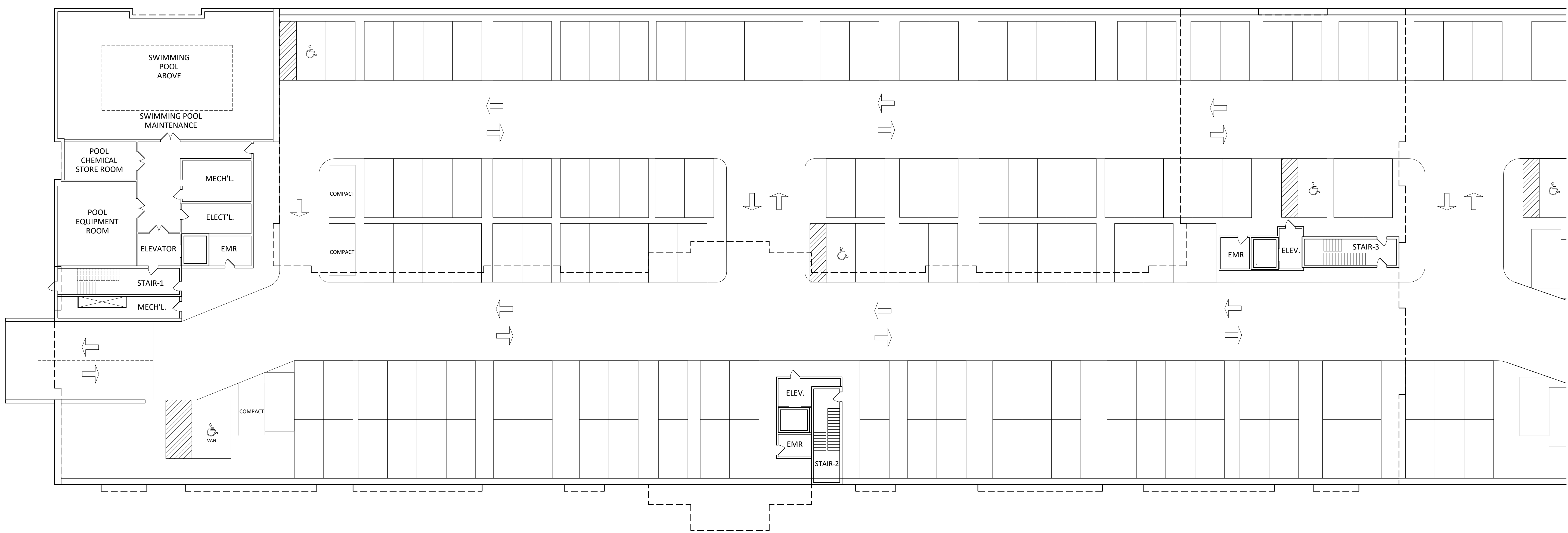

BASEMENT FLOOR PLAN-BUILDING I

SCALE: 0 5 FEET 10 FEET 20 FEET

COUNTY STAMP

ARCHITECT
d b a
 DANIEL BALL &
 ASSOCIATES
 ARCHITECTS + PLANNERS
 5512 TWIN KNOLLS ROAD
 SUITE 2110
 COLUMBIA, MD. 21045
 PHONE: (410) 719-0408
 WWW: DBA-ARCH.NET
 ©Copyright 2020

SEAL

Professional Certification:
 I certify that these documents were
 prepared or approved by me, and that I am
 a duly Licensed Architect under the laws of
 the State of Maryland.
 License number: 3731
 Expiration Date: 5/31/2022

PROJECT
 CENTURY LOTS 2,3, AND 4
 RESIDENTIAL-I

SHEET TITLE
 BASEMENT FLOOR PLAN

REV. NO.	DATE	DESCRIPTION

ORIGINAL ISSUE DATE	DRAWN BY AM
SCALE AS NOTED	CHECKED BY AW
SHEET NO. A3.1	